

NO. OF COPIES RECEIVED	6
DISTRIBUTION	
SANTA FE	1
FILE	1
U.S.G.S.	2
LAND OFFICE	
OPERATOR	2

NEW MEXICO OIL CONSERVATION COMMISSION  
 APPROVAL VALID  
 FOR 90 DAYS UNLESS  
 DRILLING COMMENCED,

EXPIRES 5-30-78

30-039-21657  
 Form C-101  
 Revised 1-1-65

5A. Indicate Type of Lease	
STATE <input type="checkbox"/>	FEE <input checked="" type="checkbox"/>
5. State Oil & Gas Lease No.	

### APPLICATION FOR PERMIT TO DRILL, DEEPEN, OR PLUG BACK

1a. Type of Work		7. Unit Agreement Name	
b. Type of Well DRILL <input checked="" type="checkbox"/> DEEPEN <input type="checkbox"/> PLUG BACK <input type="checkbox"/> OIL WELL <input checked="" type="checkbox"/> GAS WELL <input type="checkbox"/> OTHER <input type="checkbox"/> SINGLE ZONE <input checked="" type="checkbox"/> MULTIPLE ZONE <input type="checkbox"/>		8. Farm or Lease Name Shipley	
2. Name of Operator ODESSA NATURAL CORPORATION Att: John Strojek		9. Well No. 2	
3. Address of Operator P. O. Box 3908, Odessa, Texas 79760		10. Field and Pool, or Wildcat Chacon Dakota Associated Pool	
4. Location of Well UNIT LETTER <u>G</u> LOCATED <u>1840</u> FEET FROM THE <u>North</u> LINE AND <u>1840</u> FEET FROM THE <u>East</u> LINE OF SEC. <u>33</u> TWP. <u>24N</u> RGE. <u>3W</u> NMPM		12. County Rio Arriba	
19. Proposed Depth 7570'		19A. Formation Dakota	
20. Rotary or C.T. Rotary		21. Elevations (Show whether DF, RT, etc.) 7050'GR, 7063'DF, 7064KB	
21A. Kind & Status Plug. Bond Statewide		21B. Drilling Contractor Aztec Well Servicing	
22. Approx. Date Work will start 4-1-78			

### PROPOSED CASING AND CEMENT PROGRAM

SIZE OF HOLE	SIZE OF CASING	WEIGHT PER FOOT	SETTING DEPTH	SACKS OF CEMENT	EST. TOP
12-1/4"	8-5/8"	24.0	350'	350	Surface
7-7/8"	4-1/2"	10.50 & 11.60	7570'	To be determined	

It is proposed to drill this well with rotary tools, using oil base mud as circulation medium, through the Dakota Formation. Possible productive zones in the Dakota Formation will be completed. Production casing will be cemented in such a manner as to protect the Pictured Cliffs formation.

### Estimated Formation Tops

Pictured Cliffs	3000'	Greenhorn	7090'
Cliff House	4570'	Graneros	7250'
Gallup	6110'	Dakota	

The NE/4 Section 33 is dedicated to this well.

Natural gas produced from well will be committed.

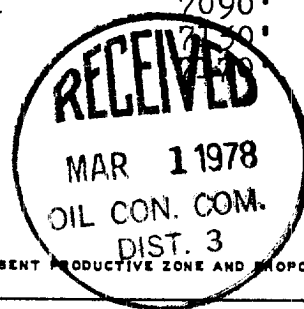

IN ABOVE SPACE DESCRIBE PROPOSED PROGRAM; IF PROPOSAL IS TO DEEPEN OR PLUG BACK, GIVE DATA ON PRESENT PRODUCTIVE ZONE AND PROPOSED NEW PRODUCTIVE ZONE. GIVE BLOWOUT PREVENTER PROGRAM, IF ANY.

I hereby certify that the information above is true and complete to the best of my knowledge and belief.

For: ODESSA NATURAL CORPORATION President, Walsh Engineering  
 Signed Ewell N. Walsh Title & Production Corporation Date 2-27-78  
 (This space for State Use) P. E.

APPROVED BY [Signature] TITLE SUPERVISOR DIST. #3 DATE 1-1-78  
 CONDITIONS OF APPROVAL, IF ANY:

**NEW MEXICO OIL CONSERVATION COMMISSION  
WELL LOCATION AND ACREAGE DEDICATION PLAT**

Form C-102  
Supersedes C-128  
Effective 1-1-65

All distances must be from the outer boundaries of the Section.

Operator <b>Odessa Natural Corporation</b>			Lease <b>Shipley</b>		Well No. <b>2</b>
Unit Letter <b>G</b>	Section <b>33</b>	Township <b>24N</b>	Range <b>3W</b>	County <b>Rio Arriba</b>	
Actual Footage Location of Well:					
<b>1840</b> feet from the <b>North</b> line and		<b>1840</b> feet from the <b>East</b> line			
Ground Level Elev. <b>7050</b>	Producing Formation <b>Dakota</b>	Pool <b>Chacon Dakota Associated Pool</b>		Dedicated Acreage: <b>160</b> Acres	

1. Outline the acreage dedicated to the subject well by colored pencil or hachure marks on the plat below.
2. If more than one lease is dedicated to the well, outline each and identify the ownership thereof (both as to working interest and royalty).
3. If more than one lease of different ownership is dedicated to the well, have the interests of all owners been consolidated by communitization, unitization, force-pooling, etc?

☐ Yes    ☐ No    If answer is "yes," type of consolidation \_\_\_\_\_

If answer is "no," list the owners and tract descriptions which have actually been consolidated. (Use reverse side of this form if necessary.) \_\_\_\_\_

No allowable will be assigned to the well until all interests have been consolidated (by communitization, unitization, forced-pooling, or otherwise) or until a non-standard unit, eliminating such interests, has been approved by the Commission.

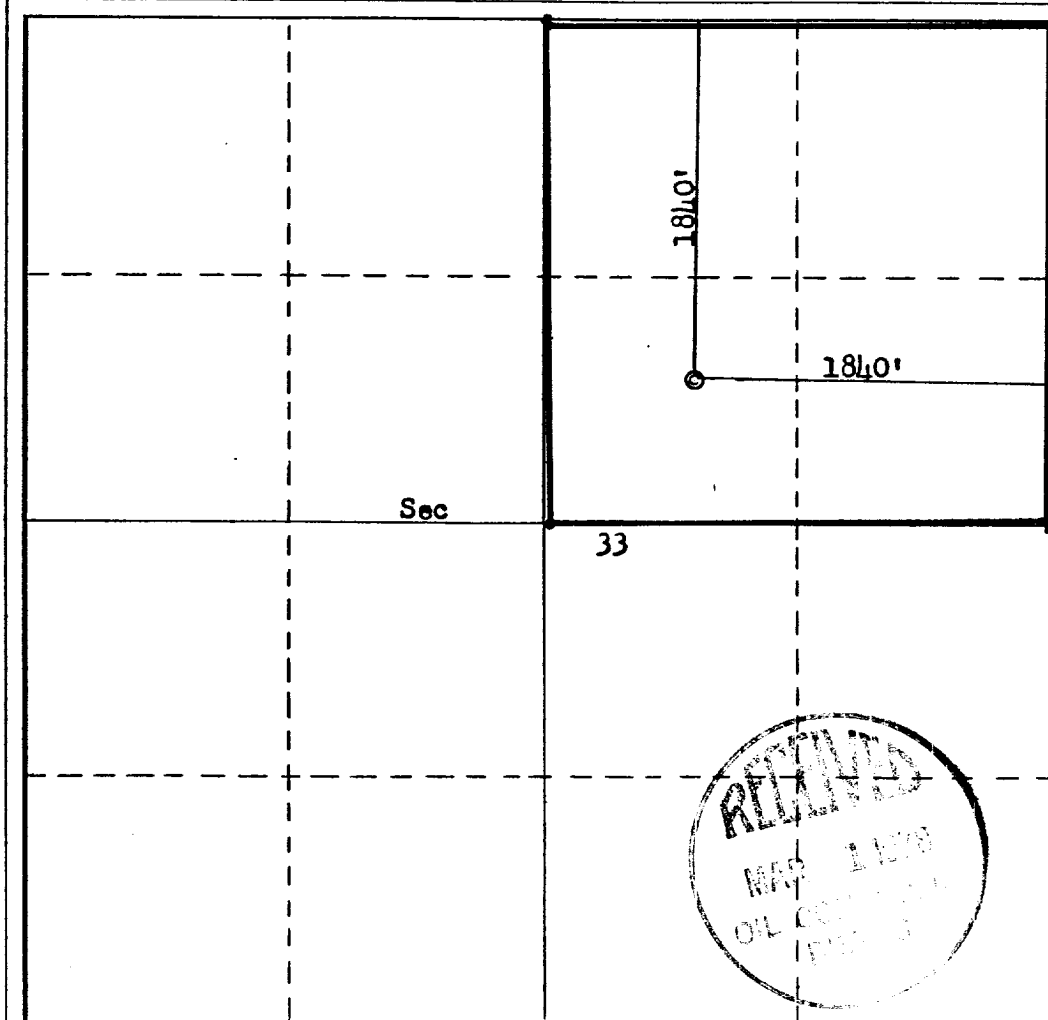

**CERTIFICATION**

I hereby certify that the information contained herein is true and complete to the best of my knowledge and belief.

For: **ODESSA NATURAL CORPORATION**

*Ewell N. Walsh*

**Ewell N. Walsh, P. E.**

Position

**President**

Company

**Walsh Engineering & Production Corp.**

Date

**2-27-78**

I hereby certify that the well location shown on this plat was plotted from field notes of actual surveys made by me or under my supervision, and that the same is true and correct to the best of my knowledge and belief.

Date Surveyed

**February 21, 1978**

Registered Professional Engineer and/or Land Surveyor

*Fred B. Kerr Jr.*

**Fred B. Kerr Jr.**

Certificate No.

**3950**

