

MEXICO OIL CONSERVATION COMMISSION
WELL LOCATION AND ACREAGE DEDICATION LAT

Form C-102
Supersedes C-128
Effective 1-4-65

All distances must be from the outer boundaries of the Section.

| | | | | | |
|---|--------------------------------------|------------------------|--|-----------------------------|--|
| Operator EPX Company | | | Lease Little-Federal 29 | | Well No. 3 |
| Unit Letter L | Section 29 | Township 24N | Range 3W | County Rio Arriba | |
| Actual Footage Location of Well: 1650 feet from the South line and 790 feet from the West line | | | | | |
| Ground Level Elev. 7077 | Producing Formation Dakota | | Pool Chacon Dakota Associated Pool | | Dedicated Acreage: 320 Acres |

1. Outline the acreage dedicated to the subject well by colored pencil or hachure marks on the plat below.
2. If more than one lease is dedicated to the well, outline each and identify the ownership thereof (both as to working interest and royalty).
3. If more than one lease of different ownership is dedicated to the well, have the interests of all owners been consolidated by communitization, unitization, force-pooling, etc?

☐ Yes ☐ No If answer is "yes," type of consolidation _____

If answer is "no," list the owners and tract descriptions which have actually been consolidated. (Use reverse side of this form if necessary.) _____

No allowable will be assigned to the well until all interests have been consolidated (by communitization, unitization, forced-pooling, or otherwise) or until a non-standard unit, eliminating such interests, has been approved by the Commission. REISSUED TO SHOW OPERATOR & DEDICATION CHANGE 4/18/83

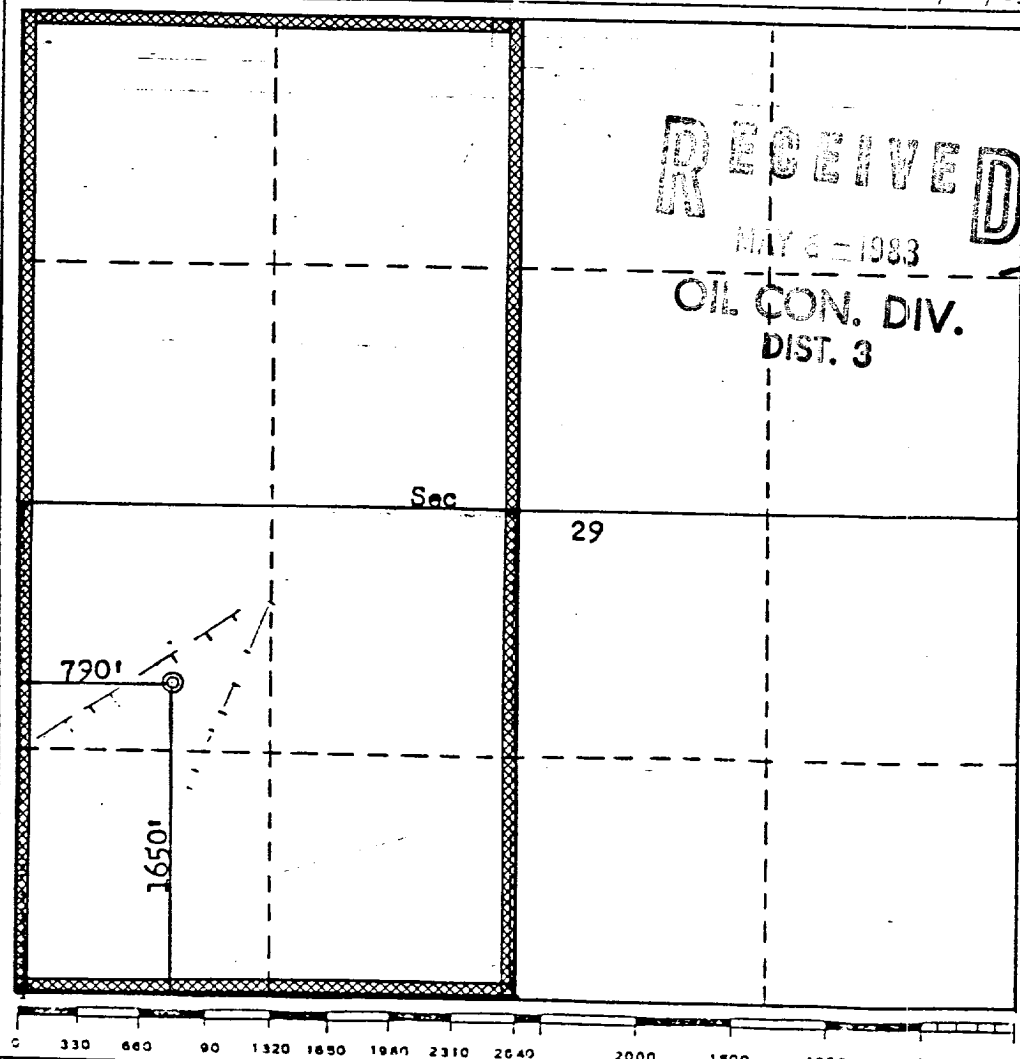

CERTIFICATION

I hereby certify that the information contained herein is true and complete to the best of my knowledge and belief.

D. G. Brisco

Name _____

Position **Drilling Clerk**

Company **EPX Company**

Date **April 21, 1983**

I hereby certify that the well location shown on this plat was plotted from field notes of actual surveys made by me or under my supervision, and that the same is true and correct to the best of my knowledge and belief.

Date Surveyed _____

February 21, 1978

Registered Professional Engineer and/or Land Surveyor

Fred B. Kerr Jr.

Certificate No. _____

3950

UNITED STATES
DEPARTMENT OF THE INTERIOR
GEOLOGICAL SURVEY

Form Approved.
Budget Bureau No. 42-R1424

SUNDRY NOTICES AND REPORTS ON WELLS

(Do not use this form for proposals to drill or to deepen or plug back to a different reservoir. Use Form 9-331-C for such proposals.)

1. oil ☐ gas ☒ other ☐

2. NAME OF OPERATOR

EPX Company

3. ADDRESS OF OPERATOR

PO Box 4289, Farmington, NM 87499

4. LOCATION OF WELL (REPORT LOCATION CLEARLY. See space 17 below.)

1850 S, 790 W

AT SURFACE:

AT TOP PROD. INTERVAL:

AT TOTAL DEPTH:

16. CHECK APPROPRIATE BOX TO INDICATE NATURE OF NOTICE, REPORT, OR OTHER DATA

REQUEST FOR APPROVAL TO:

TEST WATER SHUT-OFF ☐

FRACTURE TREAT ☐

SHOOT OR ACIDIZE ☐

REPAIR WELL ☐

PULL OR ALTER CASING ☐

MULTIPLE COMPLETE ☐

CHANGE ZONES ☐

ABANDON* Change Dedication (other) ☐

SUBSEQUENT REPORT OF

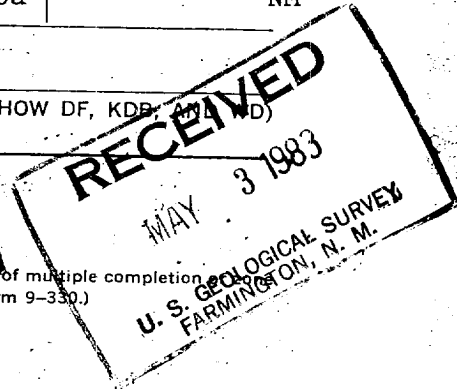
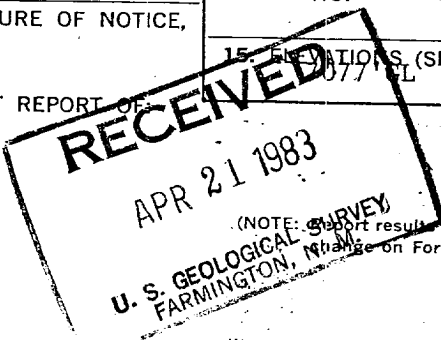

(NOTE: Report results of multiple completion change on Form 9-330.)

17. DESCRIBE PROPOSED OR COMPLETED OPERATIONS (Clearly state all pertinent details, and give pertinent dates, including estimated date of starting any proposed work. If well is directionally drilled, give subsurface locations and measured and true vertical depths for all markers and zones pertinent to this work.)*

Attached is a revised C-102 in order to comply with the New Mexico Oil Conservation Division pool rules for the Chacon Dakota Associated Pool. Note the acreage dedication change from the SW/4 to the W/2.

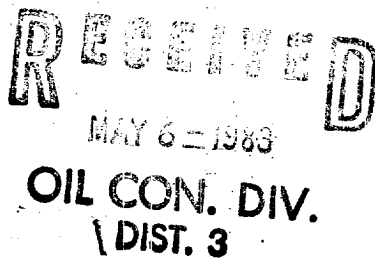

Subsurface Safety Valve: Manu. and Type _____ Set @ _____ Ft.

18. I hereby certify that the foregoing is true and correct.

SIGNED Ray W. Sink TITLE Project Drilling Engineer DATE April 19, 1983

(This space for Federal or State office use)

APPROVED BY _____ TITLE _____ DATE _____

CONDITIONS OF APPROVAL, IF ANY:

MAY 0 1983

*See Instructions on Reverse Side

NMOCC

FARMINGTON, N.M.