

OKed

Form C-101
Supersedes C-128
Effective 1-1-65

NEW MEXICO OIL CONSERVATION COMMISSION
WELL LOCATION AND ACREAGE DEDICATION PLAT

All distances must be from the outer boundaries of the Section

Operator Odessa Natural Corporation			Lease ARCO-Little-Federal 29		Well No. 2
Unit Letter H	Section 29	Township 24N	Range 3W	County Rio Arriba	
Actual Portage Location of Well:					
1850		feet from the North		line and 790	
				feet from the East	
				line	
Ground Level Elev. 7031	Producing Formation Dakota		Pool		Dedicated Acreage: Acres

1. Outline the acreage dedicated to the subject well by colored pencil or hachure marks on the plat below.
2. If more than one lease is dedicated to the well, outline each and identify the ownership thereof (both as to working interest and royalty).
3. If more than one lease of different ownership is dedicated to the well, have the interests of all owners been consolidated by communitization, unitization, force-pooling, etc?

☒ Yes ☐ No If answer is "yes," type of consolidation Communitization Agreement

If answer is "no," list the owners and tract descriptions which have actually been consolidated. (Use reverse side of this form if necessary.) _____

No allowable will be assigned to the well until all interests have been consolidated (by communitization, unitization, forced-pooling, or otherwise) or until a non-standard unit, eliminating such interests, has been approved by the Commission.

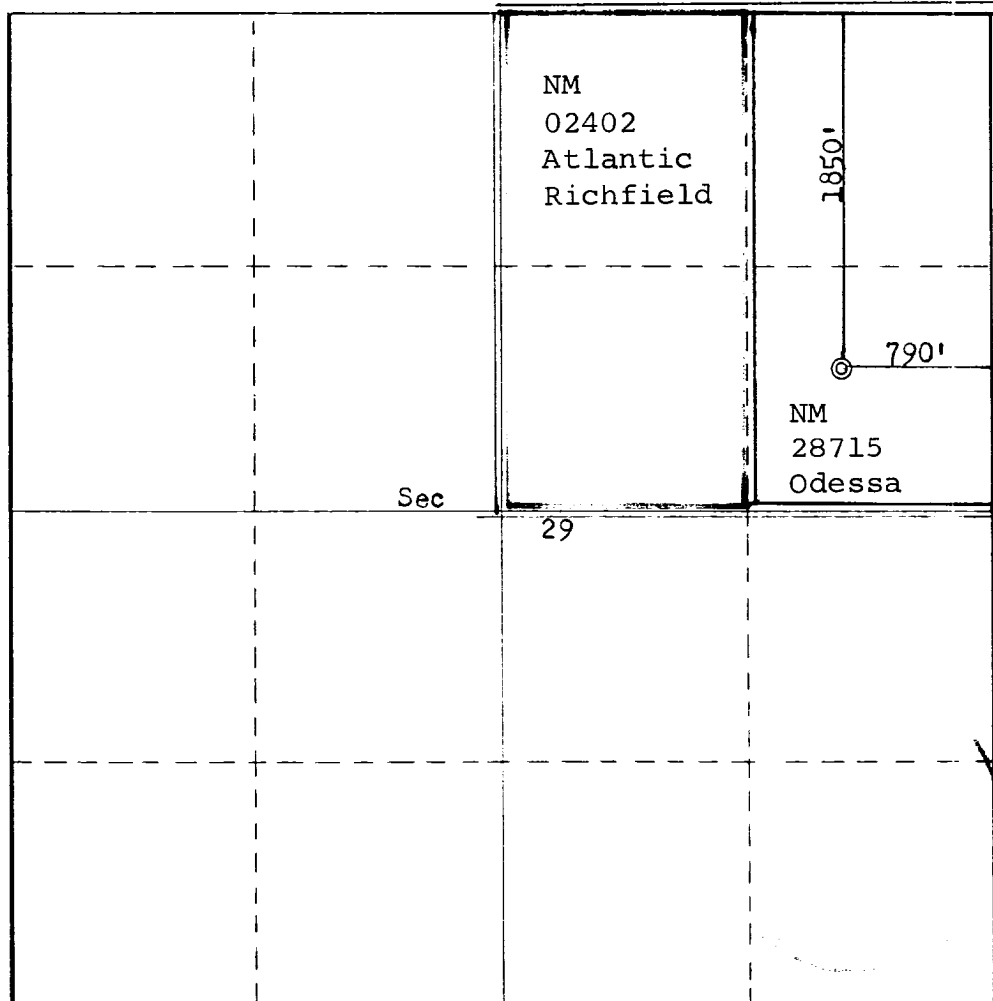

CERTIFICATION

I hereby certify that the information contained herein is true and complete to the best of my knowledge and belief.
FOR: Odessa Natural Corp.

Ewell N. Walsh

Name
Ewell N. Walsh, P.E.

Position
President

Company **Walsh Engineering & Prod. Corp.**

Date
9/7/78

I hereby certify that the well location shown on this plat was plotted from field notes of actual surveys made by me or under my supervision, and that the same is true and correct to the best of my knowledge and belief.

Date Surveyed

February 21, 1978

Registered Professional Engineer and/or Land Surveyor

Fred B. Kerr Jr.

Fred B. Kerr Jr.

Certificate No.

3950

0 330 660 990 1320 1650 1980 2310 2640 2970 3300 3630 3960 4290 4620 4950 5280 5610 5940 6270 6600