

N.M. 20113 nmg.  
02402 SW/4

UNITED STATES  
DEPARTMENT OF THE INTERIOR  
GEOLOGICAL SURVEY

**SUNDRY NOTICES AND REPORTS ON WELLS**

(Do not use this form for proposals to drill or to deepen or plug back to a different reservoir. Use Form 9-331-C for such proposals.)

1. oil well ☐ gas well ☒ other ☐  
2. NAME OF OPERATOR  
EPX Company  
3. ADDRESS OF OPERATOR  
PO Box 4289, Farmington, NM 87499  
4. LOCATION OF WELL (REPORT LOCATION CLEARLY. See space 17 below.)  
1850 S, 1850 W  
AT SURFACE:  
AT TOP PROD. INTERVAL:  
AT TOTAL DEPTH:

16. CHECK APPROPRIATE BOX TO INDICATE NATURE OF NOTICE, REPORT, OR OTHER DATA

REQUEST FOR APPROVAL TO:

TEST WATER SHUT-OFF ☐  
FRACTURE TREAT ☐  
SHOOT OR ACIDIZE ☐  
REPAIR WELL ☐  
PULL OR ALTER CASING ☐  
MULTIPLE COMPLETE ☐  
CHANGE ZONES ☐  
ABANDON\* Change Dedication (other) ☐

SUBSEQUENT REPORT OF:

☐  
☐  
☐  
☐  
☐  
☐  
☐  
☐

17. DESCRIBE PROPOSED OR COMPLETED OPERATIONS: (Clearly state all pertinent details, and give pertinent dates, including estimated date of starting any proposed work. If well is directionally drilled, give subsurface locations and measured and true vertical depths for all markers and zones pertinent to this work.)\*

Attached is a revised C-102 in order to comply with the New Mexico Oil Conservation Division pool rules for the Chacon Dakota Associated Pool. Note the acreage dedication change from the SW/4 to the W/2.

5. LEASE  
NM 02402  
6. IF INDIAN, ALLOTTEE OR TRIBE NAME  
7. UNIT AGREEMENT NAME  
8. FARM OR LEASE NAME  
ARCO Little Federal 32  
9. WELL NO.  
3  
10. FIELD OR WILDCAT NAME  
Chacon Dakota Associated Pool  
11. SEC., T., R., M., OR BLK. AND SURVEY OR AREA  
Section 32, T-24-N, R-3-W, NMPM  
12. COUNTY OR PARISH  
Rio Arriba  
13. STATE  
NM  
14. API NO.  
15. ELEVATIONS (SHOW DF, KDB, AND WD)  
7217 DF

RECEIVED  
APR 21 1983

U. S. GEOLOGICAL SURVEY  
FARMINGTON, N. M.

RECEIVED  
MAY 3 1983

U. S. GEOLOGICAL SURVEY  
FARMINGTON, N. M.

Subsurface Safety Valve: Manu. and Type \_\_\_\_\_ Set @ \_\_\_\_\_ Ft.

18. I hereby certify that the foregoing is true and correct.

SIGNED Larry W. [Signature] TITLE Project Drilling Engineer DATE April 19, 1983

(This space for Federal or State office use)

APPROVED BY \_\_\_\_\_ TITLE \_\_\_\_\_ DATE \_\_\_\_\_  
CONDITIONS OF APPROVAL, IF ANY:

\*See Instructions on Reverse Side

MAY 07 1983

NMOCC

~~FARMINGTON COPY~~

**NEW MEXICO OIL CONSERVATION COMMISSION  
WELL LOCATION AND ACREAGE DEDICATION PLAT**

Form C-102  
Supersedes C-128  
Effective 1-1-65

All distances must be from the outer boundaries of the Section.

|   |                                      |                            |  |                             |  |
|---|--------------------------------------|----------------------------|--|-----------------------------|--|
| Operator<br><b>EPX Company</b>                      |                                      |                            | Lease<br><b>ARCO-Little-Federal 32</b> |                             | Well No.<br><b>3</b>                   |
| Unit Letter<br><b>K</b>                             | Section<br><b>32</b>                 | Township<br><b>24N</b>     | Range<br><b>3W</b>                     | County<br><b>Rio Arriba</b> |  |
| Actual Footage Location of Well:                    |                                      |                            |  |                             |  |
| <b>1850</b>   |                                      | feet from the <b>South</b> | line and                               | <b>1850</b>                 | feet from the <b>West</b> line         |
| Ground Level Elev.<br><b>7204</b>                   | Producing Formation<br><b>Dakota</b> |                            | Pool <b>Chacon Dakota</b>              |                             | Dedicated Acreage:<br><b>320</b> Acres |
| Associated Pool <input checked="" type="checkbox"/> |                                      |                            |  |                             |  |

1. Outline the acreage dedicated to the subject well by colored pencil or hachure marks on the plat below.
2. If more than one lease is dedicated to the well, outline each and identify the ownership thereof (both as to working interest and royalty).
3. If more than one lease of different ownership is dedicated to the well, have the interests of all owners been consolidated by communitization, unitization, force-pooling, etc?

☐ Yes   ☐ No   If answer is "yes," type of consolidation \_\_\_\_\_

If answer is "no," list the owners and tract descriptions which have actually been consolidated. (Use reverse side of this form if necessary.) \_\_\_\_\_

No allowable will be assigned to the well until all interests have been consolidated (by communitization, unitization, forced-pooling, or otherwise) or until a non-standard unit, eliminating such interests, has been approved by the Commission. REISSUED TO SHOW OPERATOR & DEDICATION CHANGE 4/18/83

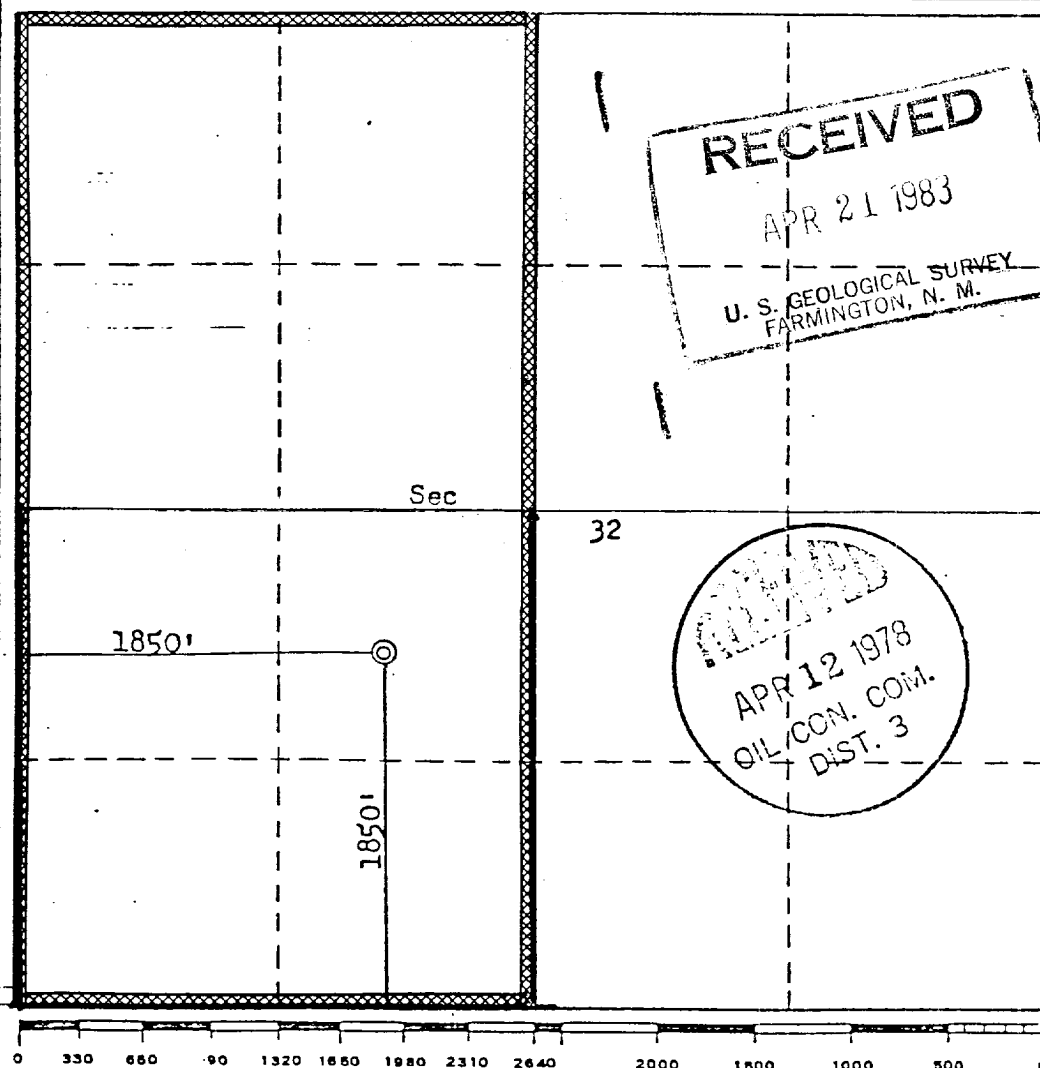

**CERTIFICATION**

I hereby certify that the information contained herein is true and complete to the best of my knowledge and belief.

*D. G. Brisco*  
Name \_\_\_\_\_

Drilling Clerk  
Position \_\_\_\_\_

EPX Company  
Company \_\_\_\_\_

April 21, 1983  
Date \_\_\_\_\_

I hereby certify that the well location shown on this plat was plotted from field notes of actual surveys made by me or under my supervision, and that the same is true and correct to the best of my knowledge and belief.

Date Surveyed \_\_\_\_\_

April 1978  
Registered Professional Engineer and/or Land Surveyor

*Fred B. Kerr*  
Certificate No. \_\_\_\_\_

B. KERR, P.E.  
3950