

UNITED STATES
DEPARTMENT OF THE INTERIOR
GEOLOGICAL SURVEY

30-039-21840

APPLICATION FOR PERMIT TO DRILL, DEEPEN, OR PLUG BACK

1a. TYPE OF WORK
DRILL DEEPEN PLUG BACK

b. TYPE OF WELL
OIL WELL GAS WELL OTHER
SINGLE ZONE MULTIPLE ZONE

2. NAME OF OPERATOR
Continental Oil Company

3. ADDRESS OF OPERATOR
Box 460, Hobbs, N.M. 88240

4. LOCATION OF WELL (Report location clearly and in accordance with any State requirements.)*
At surface: 990' FSL + 1650' FEL
At proposed prod. zone: Same

14. DISTANCE IN MILES AND DIRECTION FROM NEAREST TOWN OR POST OFFICE*

15. DISTANCE FROM PROPOSED* LOCATION TO NEAREST PROPERTY OR LEASE LINE, FT. (Also to nearest drig. unit line, if any)

16. NO. OF ACRES IN LEASE
2563.60

17. NO. OF ACRES ASSIGNED TO THIS WELL
5. Blanco-PC-160; Blanco-MV-320

18. DISTANCE FROM PROPOSED LOCATION* TO NEAREST WELL, DRILLING, COMPLETED, OR APPLIED FOR, ON THIS LEASE, FT.

19. PROPOSED DEPTH
6400'

20. ROTARY OR CABLE TOOLS
Rotary

21. ELEVATIONS (Show whether DF, RT, GR, etc.)
7247' GR

22. APPROX. DATE WORK WILL START*
10-1-78

PROPOSED CASING AND CEMENTING PROGRAM

SIZE OF HOLE	SIZE OF CASING	WEIGHT PER FOOT	SETTING DEPTH	QUANTITY OF CEMENT
12 1/2"	Now 8 3/8"	24	500'	310 SX Circ.
7 7/8"	Now 6 1/2"	15.5	6,400'	490 SX

IT IS Proposed to drill a straight hole to a total depth of 6400' and complete as a dual gas well in The South Blanco Pictured Cliffs and The Blanco Mesa Verde.

See attached for the Mud and B.O.P. Programs.
See attached Proposed Well Plan for formation tops, logging, etc.

Acroage is dedicated to a gas purchaser

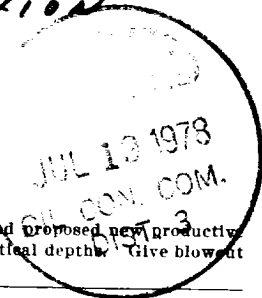

IN ABOVE SPACE DESCRIBE PROPOSED PROGRAM: If proposal is to deepen or plug back, give data on present productive zone and proposed new productive zone. If proposal is to drill or deepen directionally, give pertinent data on subsurface locations and measured and true vertical depths. Give blowout preventer program, if any.

SIGNED Wm. A. Butterfield TITLE ADMIN. SURV. DATE 7-13-78

PERMIT NO. _____ APPROVAL DATE _____

APPROVED BY W. Frank TITLE _____
CONDITIONS OF APPROVAL, IF ANY: _____

RECEIVED
JUL 17 1978

*See Instructions On Reverse Side

U. S. GEOLOGICAL SURVEY
DURANGO, COLO.

15GS2Dyman (6) Gas co. N.M., EXXON, MJL, BEA F, 16(2)

NEW MEXICO OIL CONSERVATION COMMISSION
WELL LOCATION AND ACREAGE DEDICATION PLAT

Form C-102
Supersedes C-128
Effective 1-1-65

All distances must be from the outer boundaries of the Section.

Operator CONTINENTAL OIL COMPANY			Lease AXI Apache N			Well No. 15		
Dist Letter 0	Section 11	Township 25N	Range LW	County Rio Arriba				
Actual Postage Location of Well: 990 feet from the South line and 1650 feet from the East line								
Ground Level Elev. 7247	Producing Formation Pictured Cliffs		Pool South Blanco			Dedicated Acreage: 160 Acres		

1. Outline the acreage dedicated to the subject well by colored pencil or hachure marks on the plat below.
2. If more than one lease is dedicated to the well, outline each and identify the ownership thereof (both as to working interest and royalty).
3. If more than one lease of different ownership is dedicated to the well, have the interests of all owners been consolidated by communitization, unitization, force-pooling, etc?

Yes No If answer is "yes," type of consolidation _____

If answer is "no," list the owners and tract descriptions which have actually been consolidated. (Use reverse side of this form if necessary.) _____

No allowable will be assigned to the well until all interests have been consolidated (by communitization, unitization, forced-pooling, or otherwise) or until a non-standard unit, eliminating such interests, has been approved by the Commission.

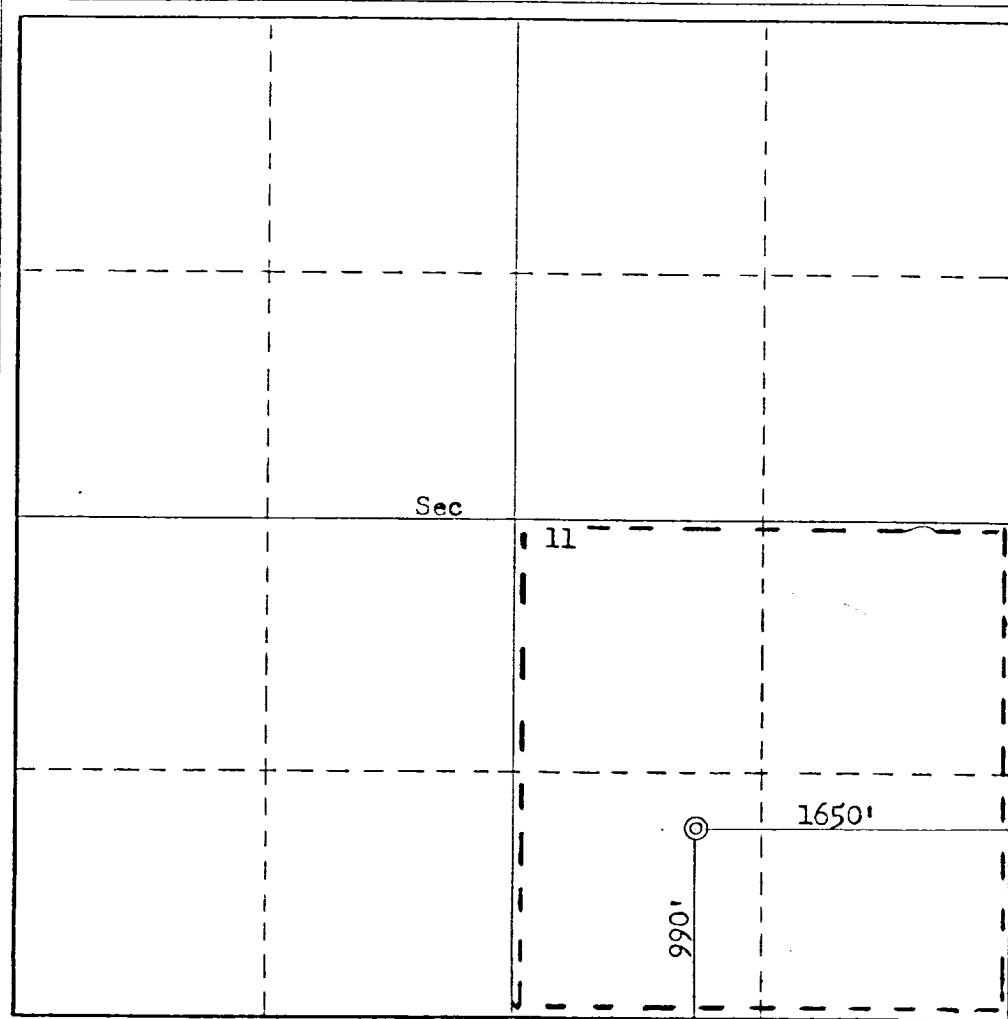

CERTIFICATION

I hereby certify that the information contained herein is true and complete to the best of my knowledge and belief.

Name
Wm. A. Butterfield
Position
Admin. Supv.
Company
CONTINENTAL OIL CO.
Date
JULY 13, 1978

I hereby certify that the well location shown on this plat was plotted from field notes of actual surveys made by me or under my supervision, and that the same is true and correct to the best of my knowledge and belief.

Date Surveyed
January 10, 1978
Registered Professional Engineer
and/or Land Surveyor
Fred B. Kerr Jr.
Certificate No.
3950

