

UNITED STATES  
DEPARTMENT OF THE INTERIOR  
GEOLOGICAL SURVEY

## APPLICATION FOR PERMIT TO DRILL, DEEPEN, OR PLUG BACK

1a. TYPE OF WORK  
DRILL ☒ DEEPEN ☐ PLUG BACK ☐

b. TYPE OF WELL  
OIL WELL ☒ GAS WELL ☐ OTHER ☐ SINGLE ZONE ☒ MULTIPLE ZONE ☐

2. NAME OF OPERATOR  
Petroleum Corporation of Texas Attn: Fred Dueser

3. ADDRESS OF OPERATOR  
P.O. Box 911 Breckenridge, Texas 76024

4. LOCATION OF WELL (Report location clearly and in accordance with any State requirements.)  
At surface 990' FNL, 1850' FEL  
At proposed prod. zone Same

14. DISTANCE IN MILES AND DIRECTION FROM NEAREST TOWN OR POST OFFICE\*  
Not Applicable

15. DISTANCE FROM PROPOSED\* LOCATION TO NEAREST PROPERTY OR LEASE LINE, FT. (Also to nearest drlg. unit line, if any) 990'

16. NO. OF ACRES IN LEASE 120 Ac

17. NO. OF ACRES ASSIGNED TO THIS WELL 160

18. DISTANCE FROM PROPOSED\* LOCATION TO NEAREST WELL, DRILLING, COMPLETED, OR APPLIED FOR, ON THIS LEASE, FT. 7650'

19. PROPOSED DEPTH 7650'

20. ROTARY OR CABLE TOOLS Rotary

21. ELEVATIONS (Show whether DF, RT, GR, etc.) 7116' GL

22. APPROX. DATE WORK WILL START\* 11-1-78

5. LEASE DESIGNATION AND SERIAL NO. 30-039-21885  
SF - 081347

6. IF INDIAN, ALLOTTEE OR TRIBE NAME

7. UNIT AGREEMENT NAME

8. FARM OR LEASE NAME Federal 1

9. WELL NO. 2

10. FIELD AND POOL, OR WILDCAT Chacon Dakota Associated Pool ext.

11. SEC., T., R., M., OR BLK. AND SURVEY OR AREA Sec. 32-T24N-R3W N.M.P.M.

12. COUNTY OR PARISH Rio Arriba

13. STATE N.M.

## PROPOSED CASING AND CEMENTING PROGRAM

SIZE OF HOLE	SIZE OF CASING	WEIGHT PER FOOT	SETTING DEPTH	QUANTITY OF CEMENT
12-1/4"	8-5/8"	24.0	350'	350 Sacks
7-7/8"	4-1/2"	10.50&11.60	7650'	To be determined

It is proposed to drill this well with rotary tools, using oil base mud as circulation medium, through the Dakota Formation. Possible productive zones in the Dakota Formation will be completed. Production casing will be cemented in such a manner as to protect the Pictured Cliffs Formation.

## Estimated Formation Tops

Pictured Cliffs	3080'	Green horn	7170'
Cliff House	4650'	Graneros	7230'
Gallup	6190'	Dakota	7250'

The NE/4 Section 32 is dedicated to this well.

The natural gas produced from this well is not committed.

IN ABOVE SPACE DESCRIBE PROPOSED PROGRAM: If proposal is to deepen or plug back, give data on present productive zone and proposed new productive zone. If proposal is to drill or deepen directionally, give pertinent data on subsurface locations and measured and true vertical depths. Give blowout preventer program, if any.

24. For: Odessa Natural Corporation  
SIGNED Ewell N. Walsh, P.E. TITLE President, Walsh Engin. & Production Corp. DATE 8-29-78  
(This space for Federal or State office use)

PERMIT NO. \_\_\_\_\_ APPROVAL DATE \_\_\_\_\_

APPROVED BY \_\_\_\_\_ TITLE \_\_\_\_\_  
CONDITIONS OF APPROVAL, IF ANY: \_\_\_\_\_

ok Frank

\*See Instructions On Reverse Side

RECEIVED  
AUG 31 1978  
U. S. GEOLOGICAL SURVEY  
DRAFTING, GCLD.

# WELL LOCATION AND ACREAGE DEDICATION PLAT

Form 0-10  
Supersedes 0-10  
Effective 1-1-77

All distances must be from the outer boundaries of the Section

Operator <b>PETROLEUM CORPORATION OF TEXAS</b>			Lease <b>FEDERAL 1</b>		Well No. <b>2</b>
Unit Letter <b>B</b>	Section <b>32</b>	Township <b>24N</b>	Range <b>3W</b>	County <b>RIO ARriba</b>	
Actual Footage Location of Well: <b>990</b> feet from the <b>North</b> line and <b>1850</b> feet from the <b>East</b> line					
Ground Level Elev. <b>7116</b>	Producing Formation <b>Dakota</b>	Pool <b>Chacon Dakota Associated</b>	Dedicated Acreage <b>160</b> Acres		

1. Outline the acreage dedicated to the subject well by colored pencil or hatchure marks on the plat below.
2. If more than one lease is dedicated to the well, outline each and identify the ownership thereof (both as to working interest and royalty). Working interest to be determined by Force Pooling Order.  
Royalty - Both Leases, U. S. Government.
3. If more than one lease of different ownership is dedicated to the well, have the interests of all owners been consolidated by communitization, unitization, force-pooling, etc?

☐ Yes ☒ No If answer is "yes," type of consolidation Future Force Pooling

If answer is "no," list the owners and tract descriptions which have actually been consolidated. (Use reverse side of this form if necessary.)

No allowable will be assigned to the well until all interests have been consolidated (by communitization, unitization, forced-pooling, or otherwise) or until a non-standard unit, eliminating such interests, has been approved by the Commission.

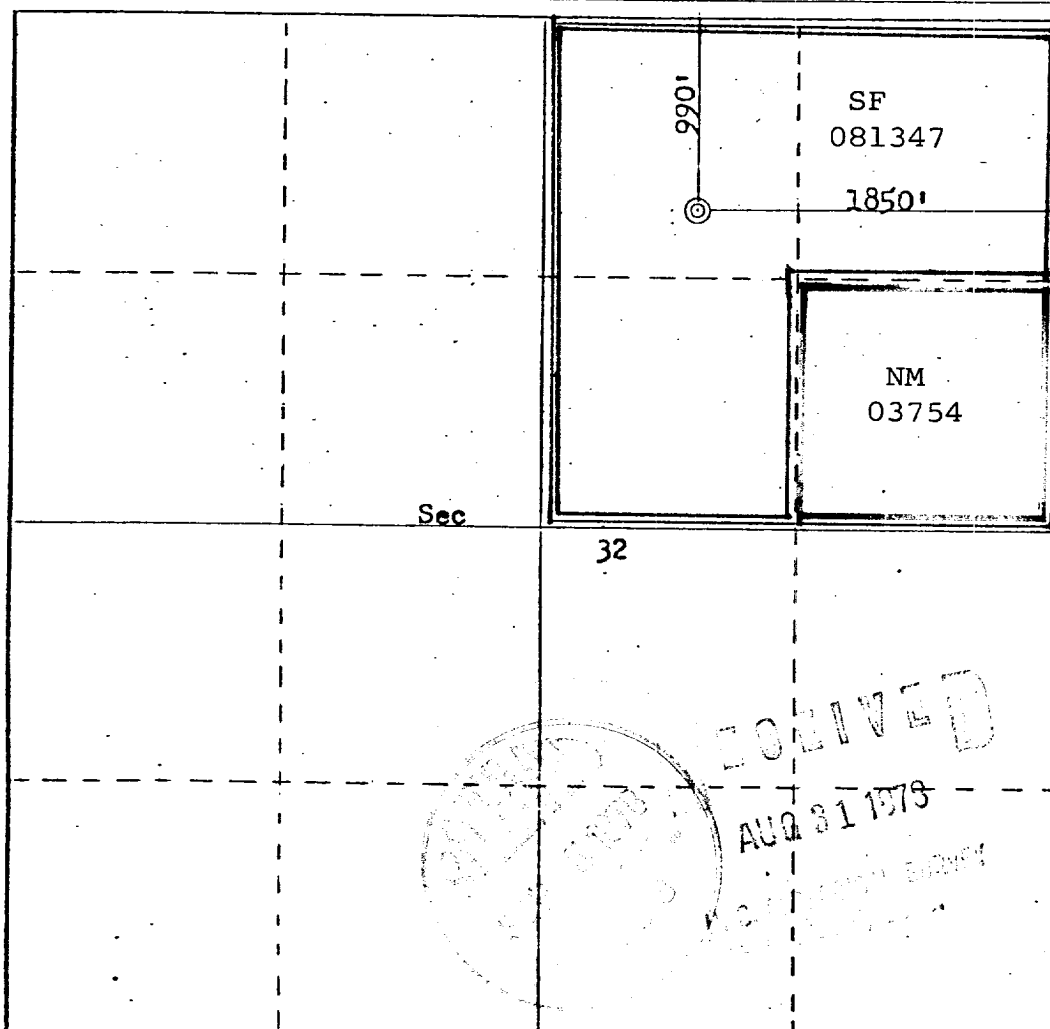

## CERTIFICATION

I hereby certify that the information contained herein is true and complete to the best of my knowledge and belief.  
For: Petroleum Corp. of Texas

Name Ewell N. Walsh P.E.

Position President, Walsh Engrng.

Company & Production Corp.

Date Aug. 29, 1978

I hereby certify that the well location shown on this plat was plotted from field notes of actual surveys made by me or under my supervision, and that the same is true and correct to the best of my knowledge and belief.

Date Surveyed August 25, 1978

Registered Professional Engineer and Surveyor  
Frederick B. Kerr Jr.

Certified by the State of Texas  
3950 B. KERR JR.

