

NEW MEXICO OIL CONSERVATION COMMISSION

WELL LOCATION AND ACERAGE DEDICATION PLAT

All distances must be from the outer boundaries of the Section

Operator SCHALK DEVELOPMENT COMPANY		Lease SCHALK 41		Well No. #1A
Unit Letter P	Section 16	Township 25 NORTH	Range 3 WEST	County RIO ARriba
Actual Footage Location of Well: 790 feet from the SOUTH line and 790 feet from the EAST line				
Ground Level Elev 7335	Producing Formation MV	Pool Blanca	Dedicated Acreage: 44 3/4 Acres	

1. Outline the acreage dedicated to the subject well by colored pencil or hatchure marks on the plat below.
2. If more than one lease is dedicated to the well, outline each and identify the ownership thereof (both as to working interest and royalty),
3. If more than one lease of different ownership is dedicated to the well, have the interests of all owners been consolidated by communization, unitization, force-pooling, etc?

() Yes () No If answer is "yes," type of consolidation _____

If answer is "no," list the owners and tract descriptions which have actually consolidated. (Use reverse side of this Form if necessary.) _____

No allowable will be assigned to the well until all interests have been consolidated (by communization, unitization, forced-pooling, or otherwise) or until a non standard unit, eliminating such interests, has been approved by the Commission.

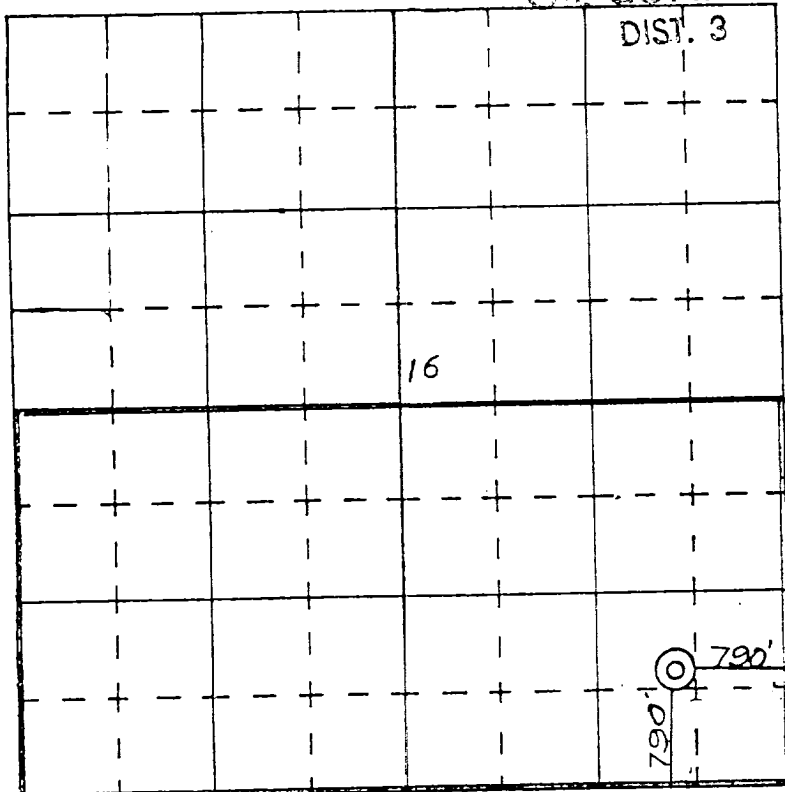

SCALE—4 INCHES EQUALS 1 MILE

SAN JUAN ENGINEERING COMPANY, FARMINGTON, N. M.

CERTIFICATION

I hereby certify that the information contained herein is true and complete to the best of my knowledge and belief.

Name _____

Steve Schalk
Position

Agent
Company

SCHALK DEVELOPMENT CO.
Date

12/6/83

I hereby certify that the well location shown on this plat was plotted from field notes of actual surveys made by me or under my supervision, and that the same is true and correct to the best of my knowledge and belief.

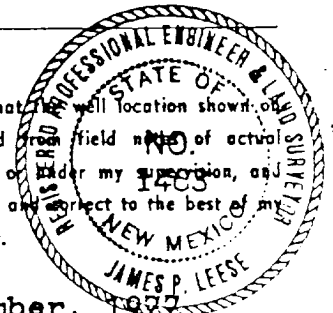

28 November, 1983

Date Surveyed

Registered Professional Engineer
and/or Land Surveyor James P. Leese

1463
Certificate No.