

NEW MEXICO OIL CONSERVATION COMMISSION
WELL LOCATION AND ACREAGE DEDICATION AT

Form C-102
Supersedes C-128
Effective 1-1-65

All distances must be from the outer boundaries of the Section.

Operator Schalk Development Co.		Lease SCHALK		43		Well No. 2
Well Letter A	Section 34	Township 25 NORTH	Range 3 WEST	County RIO ARriba		
Actual Footage Location of Well:						
790 feet from the NORTH line and		790 feet from the EAST line				
Sound Level Elev. 7213	Producing Formation Mesa Verde	Pool Chavira	Dedicated Acreage: 160		Acres	

1. Outline the acreage dedicated to the subject well by colored pencil or hachure marks on the plat below.
2. If more than one lease is dedicated to the well, outline each and identify the ownership thereof (both as to working interest and royalty).
3. If more than one lease of different ownership is dedicated to the well, have the interests of all owners been consolidated by communitization, unitization, force-pooling, etc?

☐ Yes ☐ No If answer is "yes," type of consolidation _____

If answer is "no," list the owners and tract descriptions which have actually been consolidated. (Use reverse side of this form if necessary.) _____

No allowable will be assigned to the well until all interests have been consolidated (by communitization, unitization, forced-pooling, or otherwise) or until a non-standard unit, eliminating such interests, has been approved by the Commission.

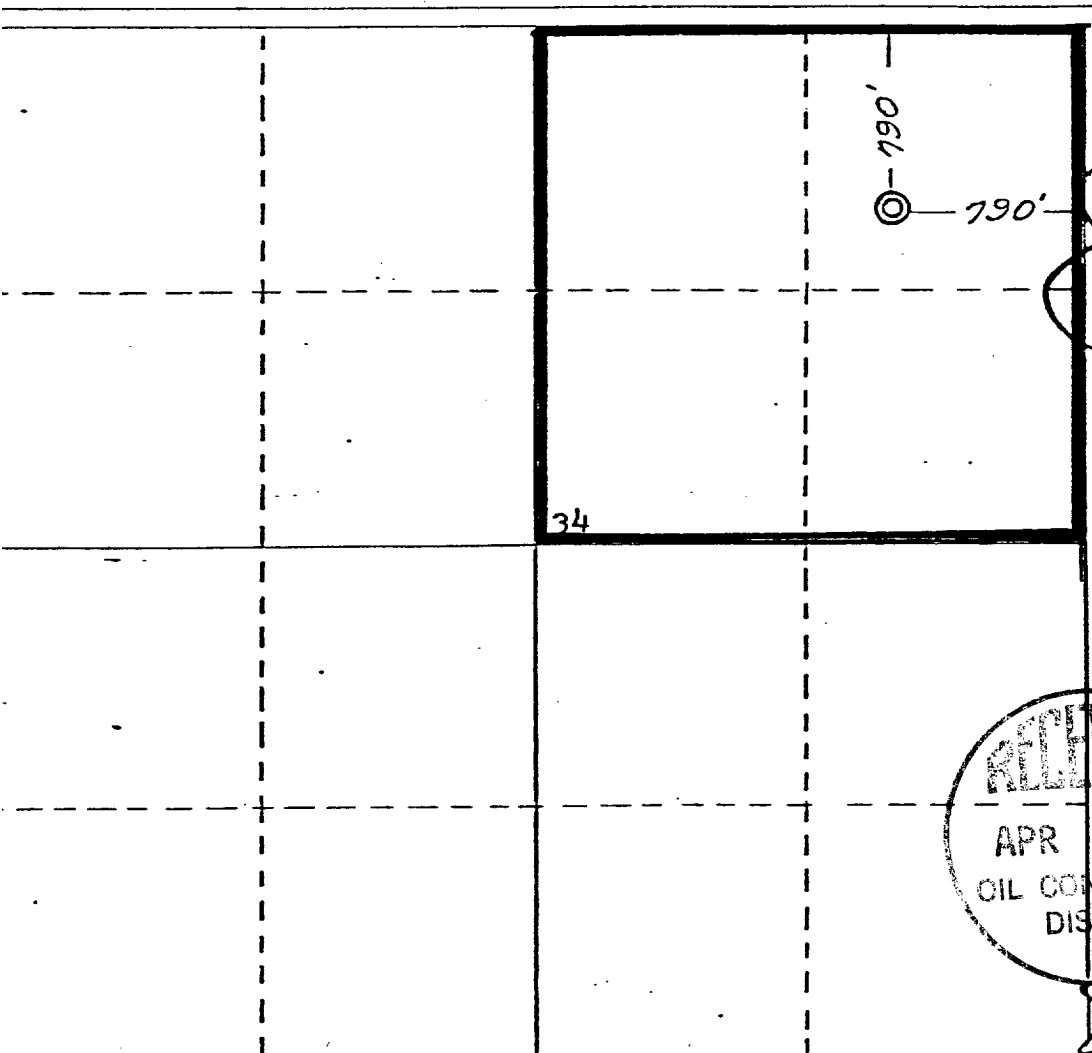

CERTIFICATION

I hereby certify that the information contained herein is true and complete to the best of my knowledge and belief.

Name
John E. Schalk
Position
Managing Partner
Company
Schalk Development Co.
Date
10/06/78

I hereby certify that the information shown on this plat was plotted from field notes of actual surveys made by me or under my supervision, and I believe it to be true and correct to the best of my knowledge and belief.

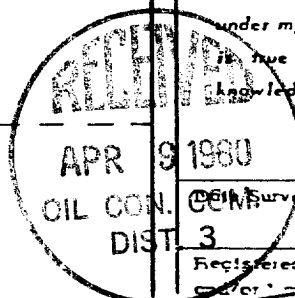

Surveyed
25 September 1978
Registered Professional Engineer
James P. Leese

Certificate No.
1463

190 1320 1650 1980 2310 2640 2970 3300 3630 3960 4290 4620 4950 5280 5610 5940 6270 6600