

All distances must be from the outer boundaries of the Section

Operator Amoco Production Co.		Lease Jicarilla Contract 148		Well No. 17
Unit Letter I	Section 15	Township 25N	Range 5W	County Rio Arriba
Actual Wellbore Location of Well:				
1520	feet from the South	line and	870	feet from the East line
Ground Level Elev. 6888	Producing Formation Dakota	Pool Basin Dakota	Dedicated Acreage: 1.60 (JT/17Y) Acres	

1. Outline the acreage dedicated to the subject well by colored pencil or hatchure marks on the plat below.
2. If more than one lease is dedicated to the well, outline each and identify the ownership thereof (both as to working interest and royalty).
3. If more than one lease of different ownership is dedicated to the well, have the interests of all owners been consolidated by communitization, unitization, force-pooling, etc?

☐ Yes ☐ No If answer is "yes," type of consolidation \_\_\_\_\_

If answer is "no," list the owners and tract descriptions which have actually been consolidated. (Use reverse side of this form if necessary.) \_\_\_\_\_

No allowable will be assigned to the well until all interests have been consolidated (by communitization, unitization, forced-pooling, or otherwise) or until a non-standard unit, eliminating such interests, has been approved by the Division.

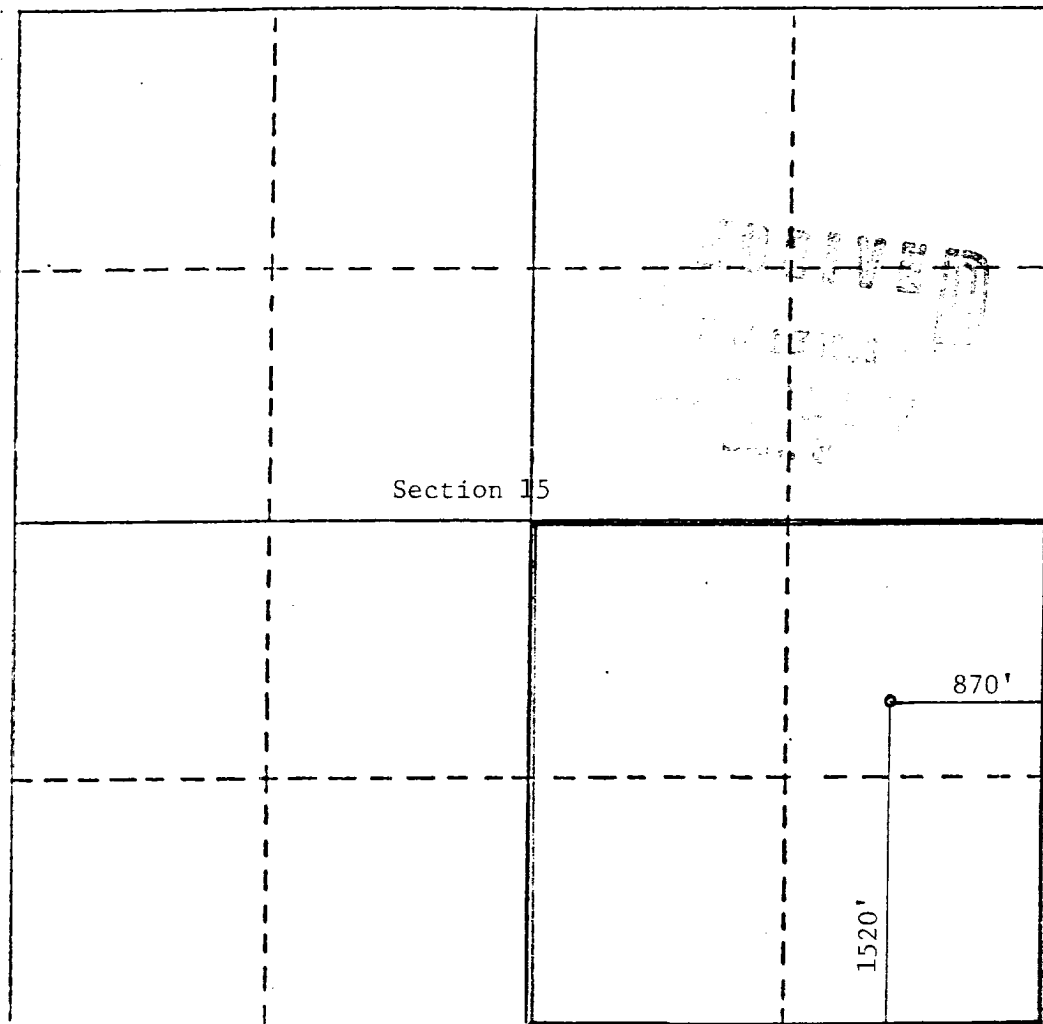

CERTIFICATION

I hereby certify that the information contained herein is true and complete to the best of my knowledge and belief.

*B. D. Shaw*

Name  
B. D. Shaw  
Position  
Adm. Supervisor  
Company  
Amoco Production Co.  
Date  
5-13-86

I hereby certify that the well location shown on this plat was plotted from field notes of actual surveys made by me or under my supervision, and that the same is true and correct to the best of my knowledge and belief.

Date Surveyed  
Registered Professional Engineer  
and/or Land Surveyor

Certificate No.