

UNITED STATES
DEPARTMENT OF THE INTERIOR
GEOLOGICAL SURVEY

SUNDRY NOTICES AND REPORTS ON WELLS

(Do not use this form for proposals to drill or to deepen or plug back to a different reservoir. Use Form 9-331-C for such proposals.)

1. oil ☒ gas ☐ other ☐
well well

2. NAME OF OPERATOR
Amoco Production Company

3. ADDRESS OF OPERATOR
501 Airport Drive Farmington, NM 87401

4. LOCATION OF WELL (REPORT LOCATION CLEARLY. See space 17 below.)
AT SURFACE: 1850' FNL x 1590' FWL, Section 23,
AT TOP PROD. INTERVAL: Same T25N, R5W
AT TOTAL DEPTH: Same

16. CHECK APPROPRIATE BOX TO INDICATE NATURE OF NOTICE, REPORT, OR OTHER DATA

REQUEST FOR APPROVAL TO:

TEST WATER SHUT-OFF ☐
FRACTURE TREAT ☐
SHOOT OR ACIDIZE ☐
REPAIR WELL ☐
PULL OR ALTER CASING ☐
MULTIPLE COMPLETE ☐
CHANGE ZONES ☒
ABANDON* ☐
(other) ☐

SUBSEQUENT REPORT OF:

☐
☐
☐
☐
☐
☐
☐
☐

(NOTE: Report results of multiple completion or zone change on Form 9-330.)

17. DESCRIBE PROPOSED OR COMPLETED OPERATIONS (Clearly state all pertinent details, and give pertinent dates, including estimated date of starting any proposed work. If well is directionally drilled, give subsurface locations and measured and true vertical depths for all markers and zones pertinent to this work.)*

Due to the Basin Dakota field being unproductive to complete the subject well in the Otero Gallup field.

The proposed plan to plug the Basin Dakota formation is as follows:

- 1) Set cement retainer at 7300'.
- 2) Squeezed off perfs with 100 sx class "B" Neat cement.
- 3) Pressure test casing to 5000 PSI.

Subsurface Safety Valve: Manu. and Type _____

18. I hereby certify that the foregoing is true and correct

SIGNED _____ TITLE Dist. Adm. Supvr DATE 1-22-80

(This space for Federal or State office use)

APPROVED
CONDITIONS OF APPROVAL, IF ANY:

TITLE _____ DATE _____

JAN 28 1980

CARL A. BARRICK

ACTING DISTRICT ENGINEER

*See Instructions on Reverse Side

JAN 24 1980

oh Fack

All distances must be from the outer boundaries of the Section.

Operator Amoco Production Company			Lease Jicarilla Contract 148		Well No. 18
Unit Letter F	Section 23	Township 25N	Range 5W	County Rio Arriba	
Actual Footage Location of Well:					
1850	feet from the North	line and	1590	feet from the West	line
Ground Level Elev. 6815	Producing Formation Gallup		Pool Otero Gallup		Dedicated Acreage 40 Acres

1. Outline the acreage dedicated to the subject well by colored pencil or hatchure marks on the plat below.
2. If more than one lease is dedicated to the well, outline each and identify the ownership thereof (both as to working interest and royalty).
3. If more than one lease of different ownership is dedicated to the well, have the interests of all owners been consolidated by communitization, unitization, force-pooling, etc?

☐ Yes ☐ No If answer is "yes," type of consolidation _____

If answer is "no," list the owners and tract descriptions which have actually been consolidated. (Use reverse side of this form if necessary.) _____

No allowable will be assigned to the well until all interests have been consolidated (by communitization, unitization, forced-pooling, or otherwise) or until a non-standard unit, eliminating such interests, has been approved by the Division.

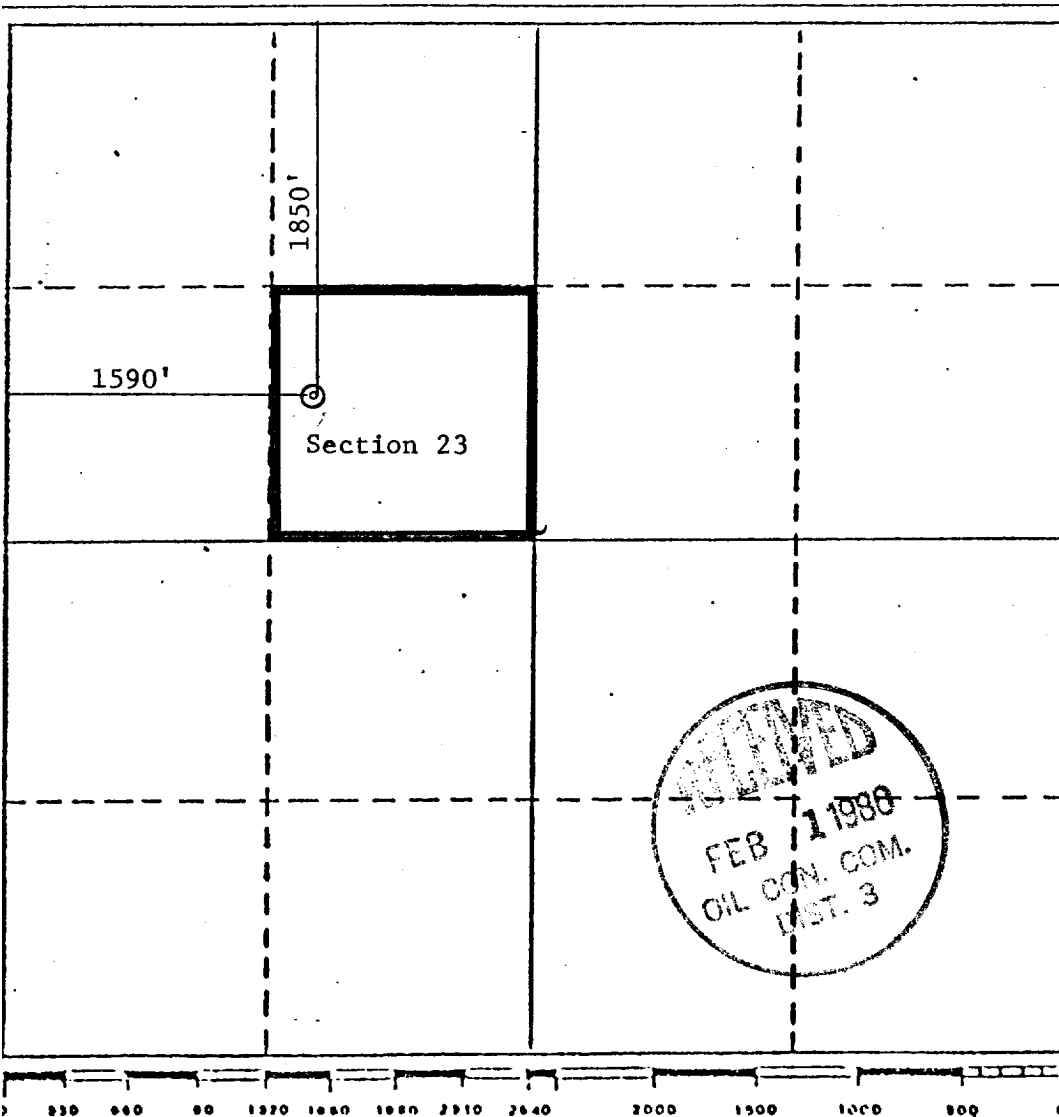

CERTIFICATION

I hereby certify that the information contained herein is true and complete to the best of my knowledge and belief.

B. E. Fackrell

Name
B. E. Fackrell

Position
District Engineer

Company
Amoco Production Company

Date
January 31, 1980

I hereby certify that the well location shown on this plat was plotted from field notes of actual surveys made by me or under my supervision, and that the same is true and correct to the best of my knowledge and belief.

Date Surveyed
November 30, 1978

Registered Professional Engineer and/or Land Surveyor
Original signed by Fred B. Kerr, Jr.

Certificate No.
3950