

ROBERT L. BAYLESS

PETROLEUM CLUB PLAZA BUILDING

P. O. BOX 1541

FARMINGTON, NEW MEXICO 87401

October 23, 1979

State of New Mexico  
Energy & Minerals Department  
Oil & Gas Conservation Division  
P.O. Box 2088  
Santa Fe, NM 87501

Gentlemen:

Please consider this our request for a Forced Pool hearing covering a proposed Pictured Cliff formation gas well to be drilled in the SW/4 of Section 27, T24N, R2W, Rio Arriba County, New Mexico. As the attached plat indicates, we control the oil and gas operating rights on all the quarter section with the exception of the SW 40 acre tract, which is owned by Paul and Marie Brown of Lindrith, New Mexico (with a mailing address of Regina, New Mexico).

We request that we be named to drill the proposed Pictured Cliff gas well with the pooling of interest to cover from the surface of the ground to the base of the Pictured Cliff formation. Paul and Marie Brown have refused to lease to us and we request that we be allowed to recover the drilling, completing and operating costs attributable to this tract with a penalty factor of 200%.

In order that we may drill this well before winter, we request the hearing be set as soon as possible. The U.S.G.S. has requested the well be drilled as the NW 40 acre tract has U.S.A. minerals and there is presently a Pictured Cliff formation gas well located as a direct offset to the North, namely the NW/4 Section 27, T24N, R2W.

Yours truly,

MERRION & BAYLESS

By   
ROBERT L. BAYLESS

RLB/eh

Enclosure (1)

✓xc: NMOCC, Aztec

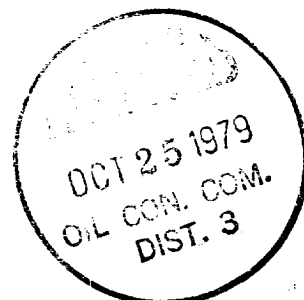

NEW MEXICO OIL CONSERVATION COMMISSION  
WELL LOCATION AND ACREAGE DEDICATION - LAT

Form C-102  
Supersedes C-128  
Effective 1-1-65

All distances must be from the outer boundaries of the Section.

|                                                 |                                               |                                            |                                  |                             |                      |
|-------------------------------------------------|-----------------------------------------------|--------------------------------------------|----------------------------------|-----------------------------|----------------------|
| Operator<br><b>MERRION &amp; BAYLESS</b>        |                                               |                                            | Lease<br><b>East Lindrith</b>    |                             | Well No.<br><b>5</b> |
| Unit Letter<br><b>L</b>                         | Section<br><b>27</b>                          | Township<br><b>24N</b>                     | Range<br><b>2W</b>               | County<br><b>RIO ARriba</b> |                      |
| Actual Footage Location of Well:                |                                               |                                            |                                  |                             |                      |
| <b>1600</b> feet from the <b>South</b> line and |                                               | <b>1000</b> feet from the <b>West</b> line |                                  |                             |                      |
| Ground Level Elev.<br><b>7225</b>               | Producing Formation<br><b>Pictured Cliffs</b> | Pool<br><b>South Blanco</b>                | Dedicated Acreage:<br><b>160</b> |                             | Acres                |

1. Outline the acreage dedicated to the subject well by colored pencil or hachure marks on the plat below.
2. If more than one lease is dedicated to the well, outline each and identify the ownership thereof (both as to working interest and royalty).
3. If more than one lease of different ownership is dedicated to the well, have the interests of all owners been consolidated by communitization, unitization, force-pooling, etc?

☐ Yes ☒ No If answer is "yes," type of consolidation \_\_\_\_\_

If answer is "no," list the owners and tract descriptions which have actually been consolidated. (Use reverse side of this form if necessary.) Will be communitized.

No allowable will be assigned to the well until all interests have been consolidated (by communitization, unitization, forced-pooling, or otherwise) or until a non-standard unit, eliminating such interests, has been approved by the Commission.

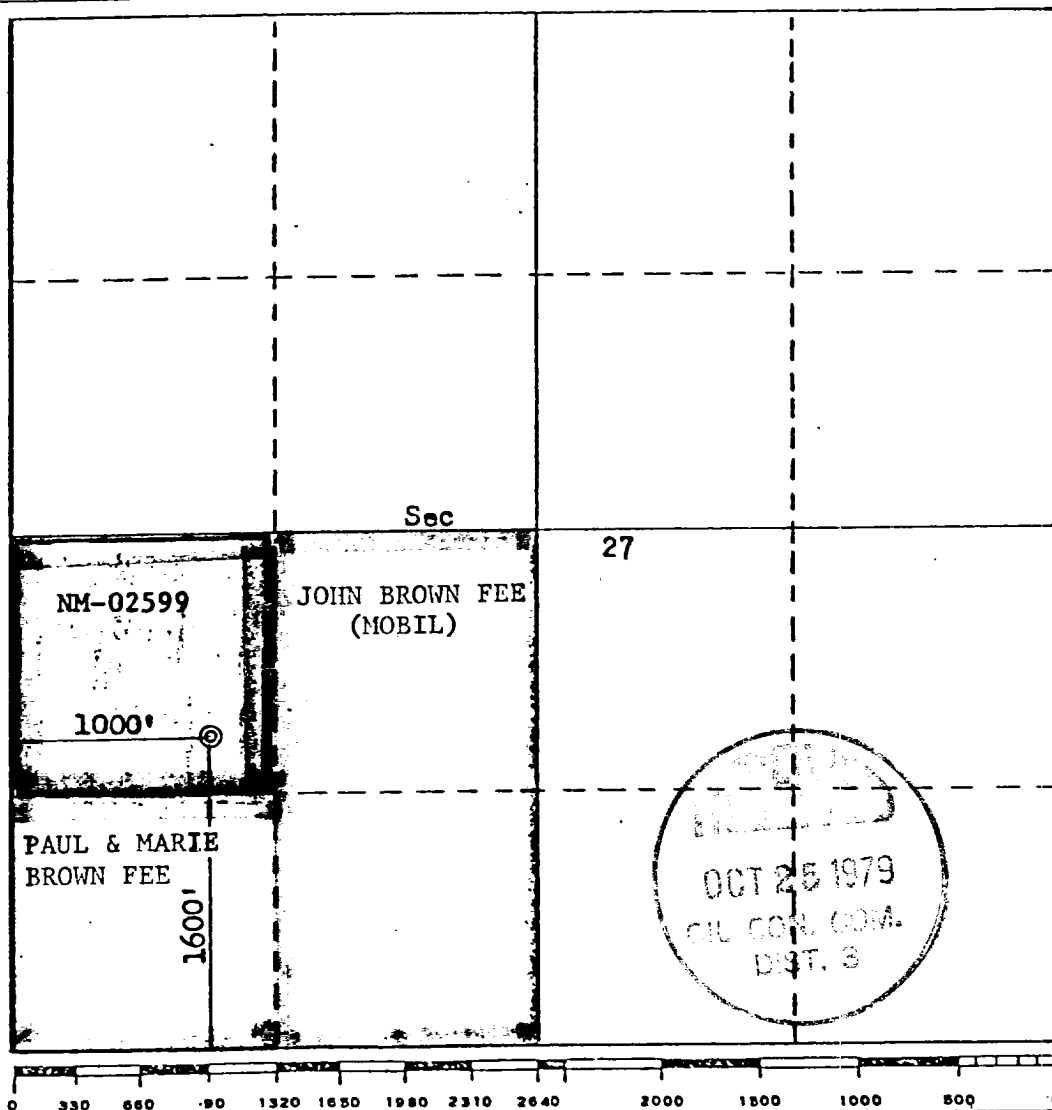

**CERTIFICATION**

I hereby certify that the information contained herein is true and complete to the best of my knowledge and belief.

Name  
**J. Gregory Merrion**  
Position  
**Co-Owner**  
Company  
**Merrion & Bayless**  
Date  
**April 18, 1979**

I hereby certify that the well location shown on this plat was plotted from field notes of actual surveys made by me or under my supervision, and that the same is true and correct to the best of my knowledge and belief.

Date Surveyed  
**September 24, 1978**  
Registered Professional Engineer and/or Land Surveyor  
**Fred B. Kerr Jr.**  
Certificate No. **3955**