

UNITED STATES  
DEPARTMENT OF THE INTERIOR  
GEOLOGICAL SURVEY

APPLICATION FOR PERMIT TO DRILL, DEEPEN, OR PLUG BACK

1a. TYPE OF WORK DRILL ☒ DEEPEN ☐ PLUG BACK ☐

b. TYPE OF WELL  
OIL WELL ☐ GAS WELL ☒ OTHER ☐ SINGLE ZONE ☐ MULTIPLE ZONE ☒

2. NAME OF OPERATOR  
Energy Reserves Group, Inc.

3. ADDRESS OF OPERATOR  
PO Box 3280 Casper, Wyoming 82602

4. LOCATION OF WELL (Report location clearly and in accordance with any State requirements.)\*  
At surface  
2326' FNL 1840' FWL (SE/NW)  
At proposed prod. zone

14. DISTANCE IN MILES AND DIRECTION FROM NEAREST TOWN OR POST OFFICE\*  
Approximately 15 miles East from Counselors Trading Post

15. DISTANCE FROM PROPOSED\* LOCATION TO NEAREST PROPERTY OR LEASE LINE, FT. (Also to nearest drlg. unit line, if any) 3440'  
16. NO. OF ACRES IN LEASE 2515.80

18. DISTANCE FROM PROPOSED LOCATION\* TO NEAREST WELL, DRILLING, COMPLETED, OR APPLIED FOR, ON THIS LEASE, FT. 1964'  
19. PROPOSED DEPTH 4000'

21. ELEVATIONS (Show whether DF, RT, GR, etc.)  
6773' Gr. (Ungraded)

23. PROPOSED CASING AND CEMENTING PROGRAM

SIZE OF HOLE	SIZE OF CASING	WEIGHT PER FOOT	SETTING DEPTH	QUANTITY OF CEMENT
12 1/4"	8 5/8"	24#	250'±	150 sx.
7 7/8"	5 1/2"	14#	4000'±	250 sx.

Energy Reserves Group, Inc. proposes to drill the above referenced well with rotary tools from surface to T.D. It is anticipated that the Blanco Pictured Cliffs and Otero Chacra formations will be gas productive. No cores or DST's are planned. Copies of all logs will be furnished upon completion of the well.

*gas is indicated*

IN ABOVE SPACE DESCRIBE PROPOSED PROGRAM: If proposal is to deepen or plug back, give data on present productive zone and proposed new productive zone. If proposal is to drill or deepen directionally, give pertinent data on subsurface locations and measured and true vertical depths. Give blowout preventer program, if any.

24. SIGNED *[Signature]* TITLE Field Services Administrator DATE 5-24-79

(This space for Federal or State office use)

PERMIT NO. \_\_\_\_\_ APPROVAL DATE \_\_\_\_\_

APPROVED BY \_\_\_\_\_ TITLE \_\_\_\_\_ DATE \_\_\_\_\_

CONDITIONS OF APPROVAL, IF ANY:

*ok Ench*

*Write NWU both zones  
10. T. 2. S. 4. E.*

\*See Instructions On Reverse Side

30-039-22093

5. LEASE DESIGNATION AND SERIAL NO.  
Jicarilla 35

6. IF INDIAN, ALLOTTEE OR TRIBE NAME  
Jicarilla Apache

7. UNIT AGREEMENT NAME

8. FARM OR LEASE NAME  
Jicarilla 35

9. WELL NO.  
7

10. FIELD AND TOOL, OR WILDCAT  
Blanco Pictured Cliffs  
South Otero Chacra *ext*

11. SEC., T., R., M., OR BLK. AND SURVEY OR AREA  
Sec. 1, T24N-R5W

12. COUNTY OR PARISH  
Rio Arriba  
13. STATE  
New Mexico

17. NO. OF ACRES ASSIGNED TO THIS WELL  
~~160~~ 189.05

20. ROTARY OR CABLE TOOLS  
Rotary

22. APPROX. DATE WORK WILL START\*  
July, 1979



NEW MEXICO OIL CONSERVATION COMMISSION  
WELL LOCATION AND ACREAGE DEDICATION PLAT

Form C-102  
Supersedes C-128  
Effective 1-1-65

All distances must be from the outer boundaries of the Section.

Operator <b>Energy Reserves Group, Inc.</b>			Lease <b>X Jicarilla 35</b>		Well No. <b>X 7</b>
Unit Letter <b>Lot 11</b>	Section <b>1</b>	Township <b>24 North</b>	Range <b>5 West</b>	County <b>Rio Arriba</b>	
Actual Footage Location of Well: <b>2326</b> feet from the <b>North</b> line and <b>1840</b> feet from the <b>West</b> line					
Ground Level Elev. <b>6773</b>	Producing Formation <b>X Blanco Chert</b>		Pool <b>X P. Chert - Chaco</b>	Dedicated Acreage: <b>X 160 189.05</b>	

- Outline the acreage dedicated to the subject well by colored pencil or hachure marks on the plat below.
- If more than one lease is dedicated to the well, outline each and identify the ownership thereof (both as to working interest and royalty).
- If more than one lease of different ownership is dedicated to the well, have the interests of all owners been consolidated by communitization, unitization, force-pooling, etc?

☐ Yes ☐ No If answer is "yes," type of consolidation \_\_\_\_\_

If answer is "no," list the owners and tract descriptions which have actually been consolidated. (Use reverse side of this form if necessary.) \_\_\_\_\_

No allowable will be assigned to the well until all interests have been consolidated (by communitization, unitization, forced-pooling, or otherwise) or until a non-standard unit, eliminating such interests, has been approved by the Commis-

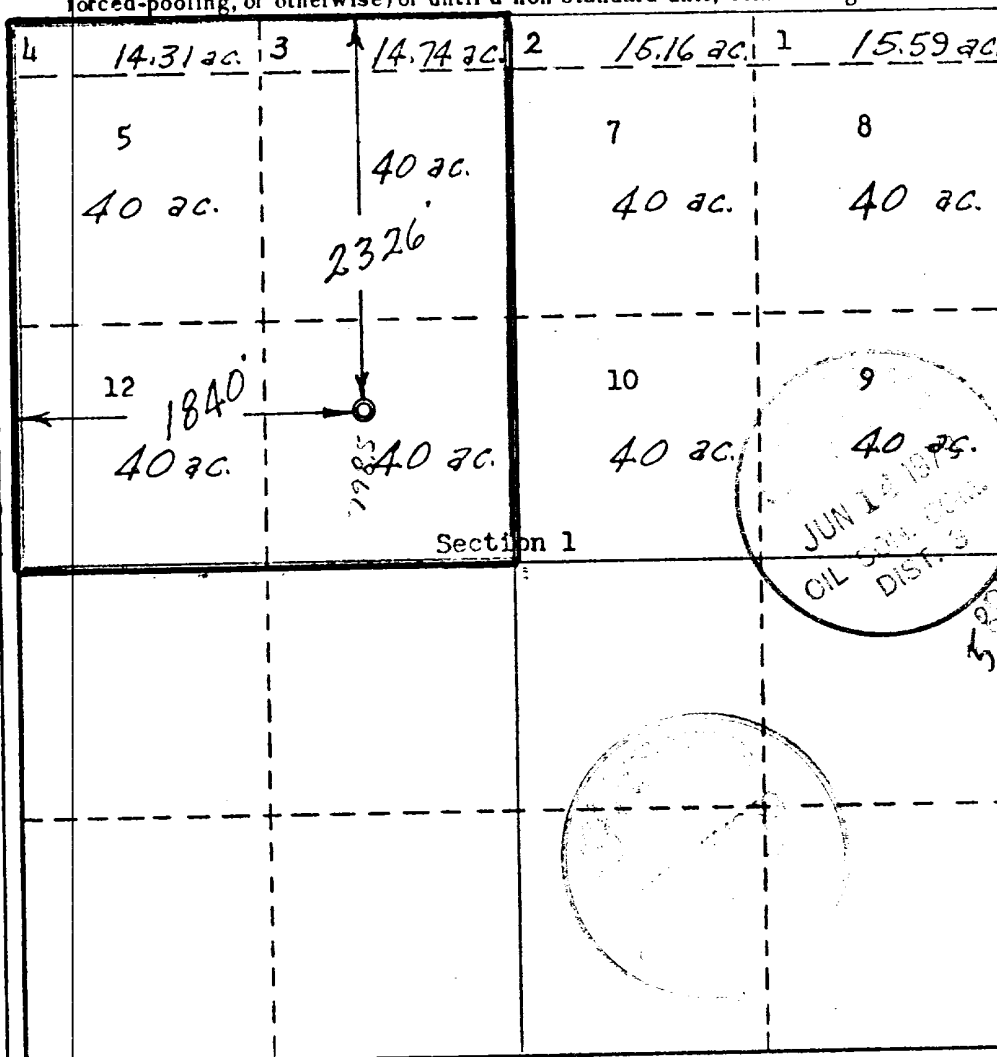

CERTIFICATION

I hereby certify that the information contained herein is true and complete to the best of my knowledge and belief.

Name  
**William H. Hoo**  
Position  
**Field Surveyor**  
Company  
**Energy Reserves Group**  
Date  
**6-5-79**

I hereby certify that the well location shown on this plat was plotted from field notes of actual surveys made by me or under my supervision, and that the same is true and correct to the best of my knowledge and belief.

Date Surveyed  
**May 7, 1979**  
Registered Professional Engineer and Land Surveyor  
**W. H. HOO**  
Certificate No.  
**3084**

