

UNITED STATES
DEPARTMENT OF THE INTERIOR
GEOLOGICAL SURVEY

APPLICATION FOR PERMIT TO DRILL, DEEPEN, OR PLUG BACK

1a. TYPE OF WORK

DRILL ☐DEEPEN ☒PLUG BACK ☐

b. TYPE OF WELL

OIL
WELL ☐GAS
WELL ☐

OTHER

SINGLE
ZONE ☒MULTIPLE
ZONE ☐

2. NAME OF OPERATOR

Energy Reserves Group, Inc.

3. ADDRESS OF OPERATOR

Box 3280 Casper, Wyoming 82602

4. LOCATION OF WELL (Report location clearly and in accordance with any State requirements.*)

At surface

F At proposed prod. zone 2326' FNL & 1840' FWL (SE/NW)

14. DISTANCE IN MILES AND DIRECTION FROM NEAREST TOWN OR POST OFFICE*

Approximatel 15 miles east from Counselor Trading Post

15. DISTANCE FROM PROPOSED*

LOCATION TO NEAREST
PROPERTY OR LEASE LINE, FT.
(Also to nearest drlg. unit line, if any)

3440'

16. NO. OF ACRES IN LEASE

2515.80

17. NO. OF ACRES ASSIGNED
TO THIS WELL

40

18. DISTANCE FROM PROPOSED LOCATION*
TO NEAREST WELL, DRILLING, COMPLETED,
OR APPLIED FOR, ON THIS LEASE, FT.

1964'

19. PROPOSED DEPTH

6430'

20. ROTARY OR CABLE TOOLS

Rotary

21. ELEVATIONS (Show whether DF, RT, GR, etc.)

6773' Gr. (ungraded)

22. APPROX. DATE WORK WILL START*

August, 1979

23.

PROPOSED CASING AND CEMENTING PROGRAM

SIZE OF HOLE	SIZE OF CASING	WEIGHT PER FOOT	SETTING DEPTH	QUANTITY OF CEMENT
12 1/4"	8 5/8"	24#	350'±	Cement to surface
7 7/8"	5 1/2"	14# & 15.5#	6430'±	250 sx.

Approval is requested to change plans on the above referenced well. It is proposed to drill this well to the Gallup Formation @ 6430'. This well was originally scheduled and permitted to the Chacra @ 4000'.

(CHANGE PLANS)



IN ABOVE SPACE DESCRIBE PROPOSED PROGRAM: If proposal is to deepen or plug back, give data on present productive zone and proposed new productive zone. If proposal is to drill or deepen directionally, give pertinent data on subsurface locations and measured and true vertical depths. Give blowout preventer program, if any.

24.

SIGNED

TITLE Field Services Administ.

DATE July 30, 1979

(This space for Federal or State office use)

PERMIT NO.

APPROVAL DATE

APPROVED BY

TITLE

DATE

CONDITIONS OF APPROVAL, IF ANY:

State

*See Instructions On Reverse Side

~~GO TO DEEP WELL~~

NE EXICO OIL CONSERVATION COMMISSION
WELL LOCATION AND ACREAGE DEDICATION, LAT

Form C-102
Supersedes C-120
Effective 1-1-65

All distances must be from the outer boundaries of the Section.

Operator Energy Reserves Group, Inc.			Lease Jicarilla 35		Well No. 7
Unit Letter Lot 11	Section 1	Township 24 North	Range 5 West	County Rio Arriba	
Actual Footage Location of Well: 2326 feet from the North line and 1840 feet from the West line					
Ground Level Elev. 6773	Producing Formation Gallup		Pool Otero Gallup	Dedicated Acreage: 40 Acres	

1. Outline the acreage dedicated to the subject well by colored pencil or hachure marks on the plat below.

2. If more than one lease is dedicated to the well, outline each and identify the ownership thereof (both as to working interest and royalty).

3. If more than one lease of different ownership is dedicated to the well, have the interests of all owners been consolidated by communitization, unitization, force-pooling, etc?

☐ Yes ☐ No If answer is "yes," type of consolidation _____

If answer is "no," list the owners and tract descriptions which have actually been consolidated. (Use reverse side of this form if necessary.) _____

No allowable will be assigned to the well until all interests have been consolidated (by communitization, unitization, forced-pooling, or otherwise) or until a non-standard unit, eliminating such interests, has been approved by the Commis-

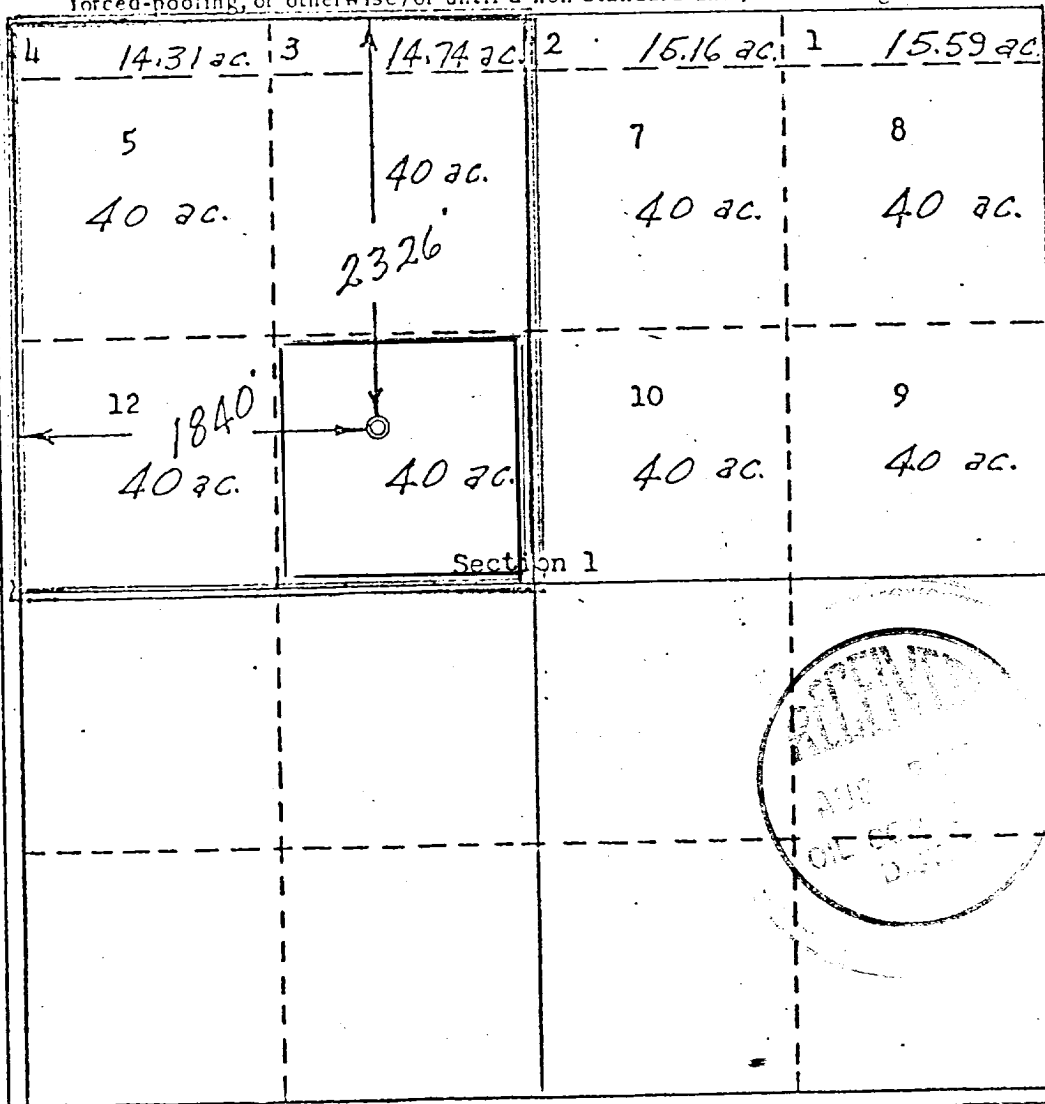

CERTIFICATION

I hereby certify that the information contained herein is true and complete to the best of my knowledge and belief.

Name
Position
Field Services Administrator
Company
Energy Reserves Group, Inc.
Date
July 30, 1979

I hereby certify that the well location shown on this plat was plotted from field notes of actual surveys made by me or under my supervision, and that the same is true and correct to the best of my knowledge and belief.

Date Surveyed
May 7, 1979
Registered Professional Engineer and Land Surveyor

Certificate No.

3051

Supplemental to Form 9-331C

1. The geologic name of the surface formation.

Undivided tertiary

2. The estimated tops of important geologic markers.

Kirtland	2600'	Mancos	5030'
Pictured Cliffs	2950'	Gallup	6000'
Chacra	3800'	T.D.	6430'
Cliff House	4230'		

3. The estimated depths at which anticipated water, oil, gas, or other mineral-bearing formations are expected to be encountered.

Pictured Cliffs @ 2950' & Chacra @ 3800' are expected to be gas bearing.
Gallup @ 6000'-6430' is expected to be oil bearing.

4. The proposed casing program, including the size, grade, and weight-per-foot of each string and whether new or used.

8 5/8" - k-55 - 24# - new
5 1/2" - k-55 - 14# & 15.5# - new and used

8. The testing, logging, fracing, and coring programs to be followed with provision made for required flexibility.

No coring is planned. No DST's are planned. Logs will consist of DIL - Gamma Ray - Density Neutron. Fracing will probably consist of a gel water frac.

9. Any anticipated abnormal pressures or temperatures expected to be encountered or potential hazards such as hydrogen sulfide gas, along with plans for mitigating such hazards.

No abnormal pressures or temperatures are anticipated. H₂S is not a potential problem in the Pictured Cliffs, Chacra, and Gallup formations.

10. The anticipated starting date and duration of the operations.

It is planned to commence operations as soon as regulatory approval is obtained and a rig becomes available. It is estimated it will take 15-20 days to drill, log, complete, and test this well.