

UNITED STATES
DEPARTMENT OF THE INTERIOR
GEOLOGICAL SURVEY

APPLICATION FOR PERMIT TO DRILL, DEEPEN, OR PLUG BACK

1a. TYPE OF WORK DRILL ☒ DEEPEN ☐ PLUG BACK ☐

b. TYPE OF WELL OIL WELL ☒ GAS WELL ☐ OTHER ☐ SINGLE ZONE ☒ MULTIPLE ZONE ☐

2. NAME OF OPERATOR
Energy Reserves Group, Inc.

3. ADDRESS OF OPERATOR
PO Box 3280 Casper, Wyoming 82602

4. LOCATION OF WELL (Report location clearly and in accordance with any State requirements.)*
At surface C 1261' FNL 1840' FWL (NE/NW)
At proposed prod. zone

14. DISTANCE IN MILES AND DIRECTION FROM NEAREST TOWN OR POST OFFICE*

Approximately 15 miles East from Counselors Trading Post

15. DISTANCE FROM PROPOSED LOCATION TO NEAREST PROPERTY OR LEASE LINE, FT. (Also to nearest drilg. unit line, if any) 1840'

18. DISTANCE FROM PROPOSED LOCATION TO NEAREST WELL, DRILLING COMPLETED, OR APPLIED FOR, ON THIS LEASE, FT. 1040'

21. ELEVATIONS (Show whether DF, RT, GR, etc.)

6779 Gr. (ungraded)

23. PROPOSED CASING AND CEMENTING PROGRAM

SIZE OF HOLE	SIZE OF CASING	WEIGHT PER FOOT	SETTING DEPTH	QUANTITY OF CEMENT
12 1/4"	8 5/8"	24#	500'±	cement to surface
7 7/8"	5 1/2"	14-15.5#	6600'±	250 sx.

Energy Reserves Group, Inc. proposes to drill the above referenced well with rotary tools from surface to T.D. It is anticipated that the Gallup formation @ 6170'-6500' will be oil productive. No cores or DST's are planned. Copies of all logs run will be furnished upon completion. A 10" series 600 or 900 dual ram BOP will be used.

30-039-32094
5. LEASE DESIGNATION AND SERIAL NO.

Jicarilla 35
6. IF INDIAN, ALLOTTEE OR TRIBE NAME

Jicarilla Apache
7. UNIT AGREEMENT NAME

8. FARM OR LEASE NAME

Jicarilla 35

9. WELL NO.

10

10. FIELD AND POOL, OR WILDCAT

Otero Gallup
11. SEC., T., R., M., OR B.L. AND SURVEY OR AREA

Sec. 2, T24N-R5W

12. COUNTY OR PARISH 13. STATE

Rio Arriba New Mexico

17. NO. OF ACRES ASSIGNED TO THIS WELL

40

20. ROTARY OR CABLE TOOLS

Rotray

22. APPROX. DATE WORK WILL START*

July-August, 1979

IN ABOVE SPACE DESCRIBE PROPOSED PROGRAM: If proposal is to deepen or plug back, give data on present productive zone and proposed new productive zone. If proposal is to drill or deepen directionally, give pertinent data on subsurface locations and measured and true vertical depths. Give blowout preventer program, if any.

24. SIGNED [Signature] TITLE Field Services Admn.

DATE 5-24-79

(This space for Federal or State office use)

PERMIT NO.

APPROVAL DATE

APPROVED BY

TITLE

DATE 7-31-1979

CONDITIONS OF APPROVAL, IF ANY:

[Signature]

*See Instructions On Reverse Side



**NEW MEXICO OIL CONSERVATION COMMISSION
WELL LOCATION AND ACREAGE DEDICATION PLAT**

Form C-102
Supersedes C-128
Effective 1-1-65

All distances must be from the outer boundaries of the Section.

Operator Energy Reserves Group, Inc.			Lease x Jicarilla 35		Well No. x 10
Unit Letter Lot 6	Section 2	Township 24 North	Range 5 West	County Rio Arriba	
Actual Footage Location of Well:					
1261 feet from the North line and		1840 feet from the West line			
Ground Level Elev. 6779	Producing Formation x Otero Gallup	Pool x Otero Gallup	Dedicated Acreage: x 40 Acres		

1. Outline the acreage dedicated to the subject well by colored pencil or hachure marks on the plat below.
2. If more than one lease is dedicated to the well, outline each and identify the ownership thereof (both as to working interest and royalty).
3. If more than one lease of different ownership is dedicated to the well, have the interests of all owners been consolidated by communitization, unitization, force-pooling, etc?

☐ Yes ☐ No If answer is "yes," type of consolidation _____

If answer is "no," list the owners and tract descriptions which have actually been consolidated. (Use reverse side of this form if necessary.) _____

No allowable will be assigned to the well until all interests have been consolidated (by communitization, unitization, forced-pooling, or otherwise) or until a non-standard unit, eliminating such interests, has been approved by the Commis-

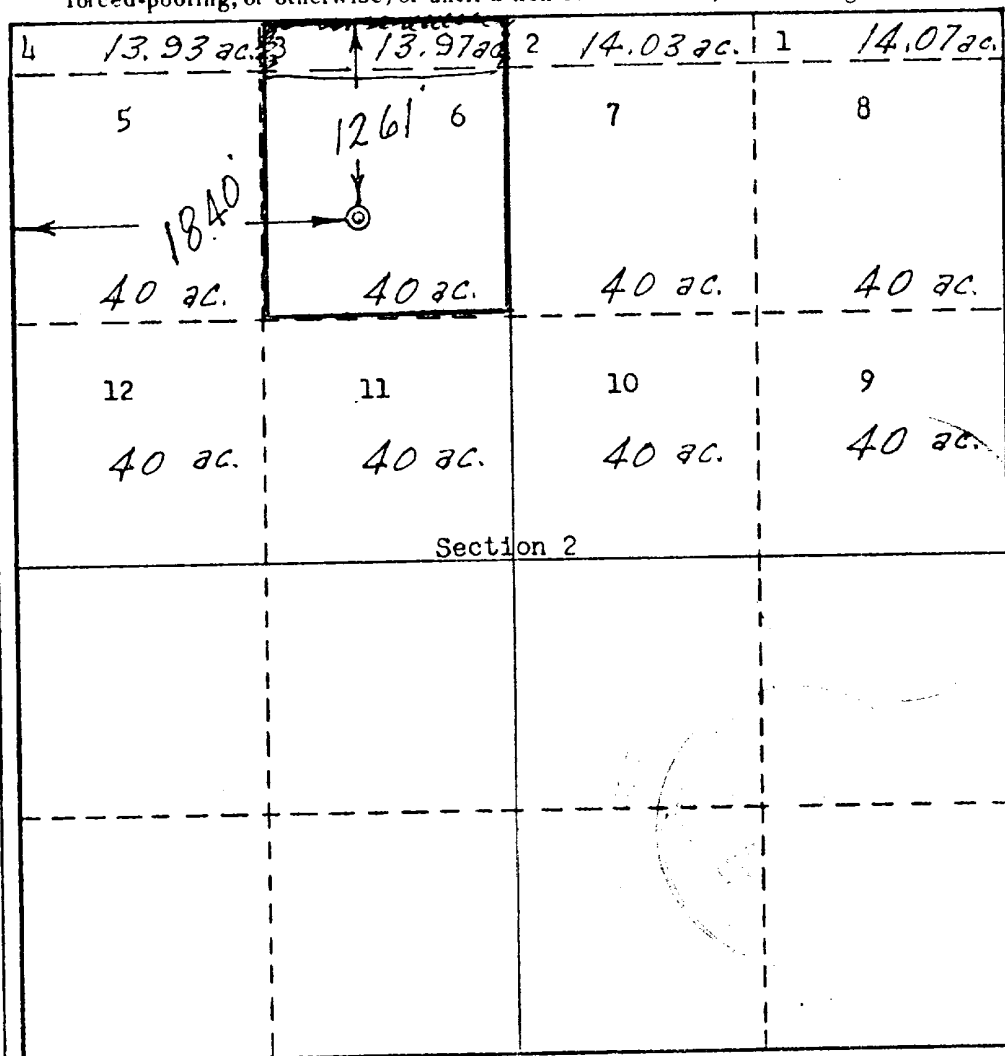

CERTIFICATION

I hereby certify that the information contained herein is true and complete to the best of my knowledge and belief.

Name **William H. Jones**
Position **Field Surveyor**
Company **Energy Reserves Group**
Date **6-5-79**

I hereby certify that the well location shown on this plat was plotted from field notes of actual surveys made by me or under my supervision, and that the same is true and correct to the best of my knowledge and belief.

Date Survey **May 8, 1979**
Registered Professional Engineer and Land Surveyor
Certificate No. **3084**

