

UNITED STATES
DEPARTMENT OF THE INTERIOR
GEOLOGICAL SURVEY

APPLICATION FOR PERMIT TO DRILL, DEEPEN, OR PLUG BACK

1A. TYPE OF WORK

DRILL ☒

DEEPEN ☐

PLUG BACK ☐

B. TYPE OF WELL

OIL WELL ☐

GAS WELL ☒

OTHER ☐

SINGLE ZONE ☐

MULTIPLE ZONE ☒

2. NAME OF OPERATOR

Energy Reserves Group, Inc.

3. ADDRESS OF OPERATOR

PO box 3280 Casper, Wyoming 82602

4. LOCATION OF WELL (Report location clearly and in accordance with any State requirements.)*

At surface

2301' FNL 1840' FWL (SE/NW)

At proposed prod. zone

14. DISTANCE IN MILES AND DIRECTION FROM NEAREST TOWN OR POST OFFICE*

Approximately 15 miles East from Counselors Trading Post

15. DISTANCE FROM PROPOSED*

LOCATION TO NEAREST PROPERTY OR LEASE LINE, FT. (Also to nearest drlg. unit line, if any)

1000'

18. DISTANCE FROM PROPOSED LOCATION*

TO NEAREST WELL, DRILLING, COMPLETED, OR APPLIED FOR, ON THIS LEASE, FT.

1040'

21. ELEVATIONS (Show whether DF, RT, GR, etc.)

6747 Gr. (Ungraded)

23.

PROPOSED CASING AND CEMENTING PROGRAM

SIZE OF HOLE	SIZE OF CASING	WEIGHT PER FOOT	SETTING DEPTH	QUANTITY OF CEMENT
12 1/4"	8 5/8"	24#	250'±	150 sx.
7 7/8"	5 1/2"	14#	4000'±	250 sx.

Energy Reserves Group, Inc. proposes to drill the above referenced well with rotary tools from surface to T.D. It is anticipated that the Blanco Pictured Cliffs and the Otero Chacra formations will be gas productive. No cores or DST's are planned. Copies of all logs will be furnished upon completion of the well.

gas is dedicated

IN ABOVE SPACE DESCRIBE PROPOSED PROGRAM: If proposal is to deepen or plug back, give data on present productive zone and proposed new productive zone. If proposal is to drill or deepen directionally, give pertinent data on subsurface locations and measured and true vertical depths. Give blowout preventer program, if any.

24.

SIGNED

[Signature]

TITLE Field Services Admn.

DATE 5-24-79

(This space for Federal or State office use)

PERMIT NO.

APPROVAL DATE

APPROVED BY

TITLE

DATE MAY 31 1979

CONDITIONS OF APPROVAL, IF ANY:

ok Frank

*See Instructions On Reverse Side

5. LEASE DESIGNATION AND SERIAL NO.

Jicarilla 35

6. IF INDIAN, ALLOTTEE OR TRIBE NAME

Jicarilla

7. UNIT AGREEMENT NAME

8. FARM OR LEASE NAME

Jicarilla 35

9. WELL NO.

11

10. FIELD AND POOL OIL WELL DATA

Blanco Pictured Cliffs
South Otero Chacra

11. SEC., T., R., M., OR BLK. AND SURVEY OR AREA

Sec.2, T24N-R5W

12. COUNTY OR PARISH

Rio Arriba

13. STATE

New Mexico

17. NO. OF ACRES ASSIGNED TO THIS WELL

~~460~~ 187.90

20. ROTARY OR CABLE TOOLS

Rotary

22. APPROX. DATE WORK WILL START*

July-August, 1979

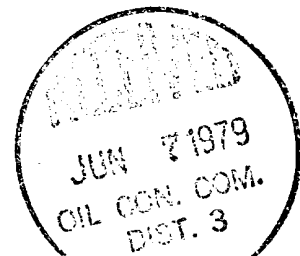

NEW MEXICO OIL CONSERVATION COMMISSION
WELL LOCATION AND ACREAGE DEDICATION PLAT

Form C-102
Supersedes C-128
Effective 1-1-65

All distances must be from the outer boundaries of the Section.

Operator Energy Reserves Group, Inc.		Lease X Jicarilla 35		Well No. X 11
Unit Letter Lot 11	Section 2	Township 24 North	Range 5 West	County Rio Arriba
Actual Footage Location of Well: 2301 feet from the North line and 1840 feet from the West line				
Ground Level Elev. 6747	Producing Formation Blanco Piedra Cliffs X South Open Chaco	Pool X P. Cliffs - Chaco ext	Dedicated Acreage: X 160187.90 acres	

1. Outline the acreage dedicated to the subject well by colored pencil or hachure marks on the plat below.
2. If more than one lease is dedicated to the well, outline each and identify the ownership thereof (both as to working interest and royalty).
3. If more than one lease of different ownership is dedicated to the well, have the interests of all owners been consolidated by communization, unitization, force-pooling, etc?

☐ Yes ☐ No If answer is "yes," type of consolidation _____

If answer is "no," list the owners and tract descriptions which have actually been consolidated. (Use reverse side of this form if necessary.) _____

No allowable will be assigned to the well until all interests have been consolidated (by communization, unitization, forced-pooling, or otherwise) or until a non-standard unit, eliminating such interests, has been approved by the Commis-

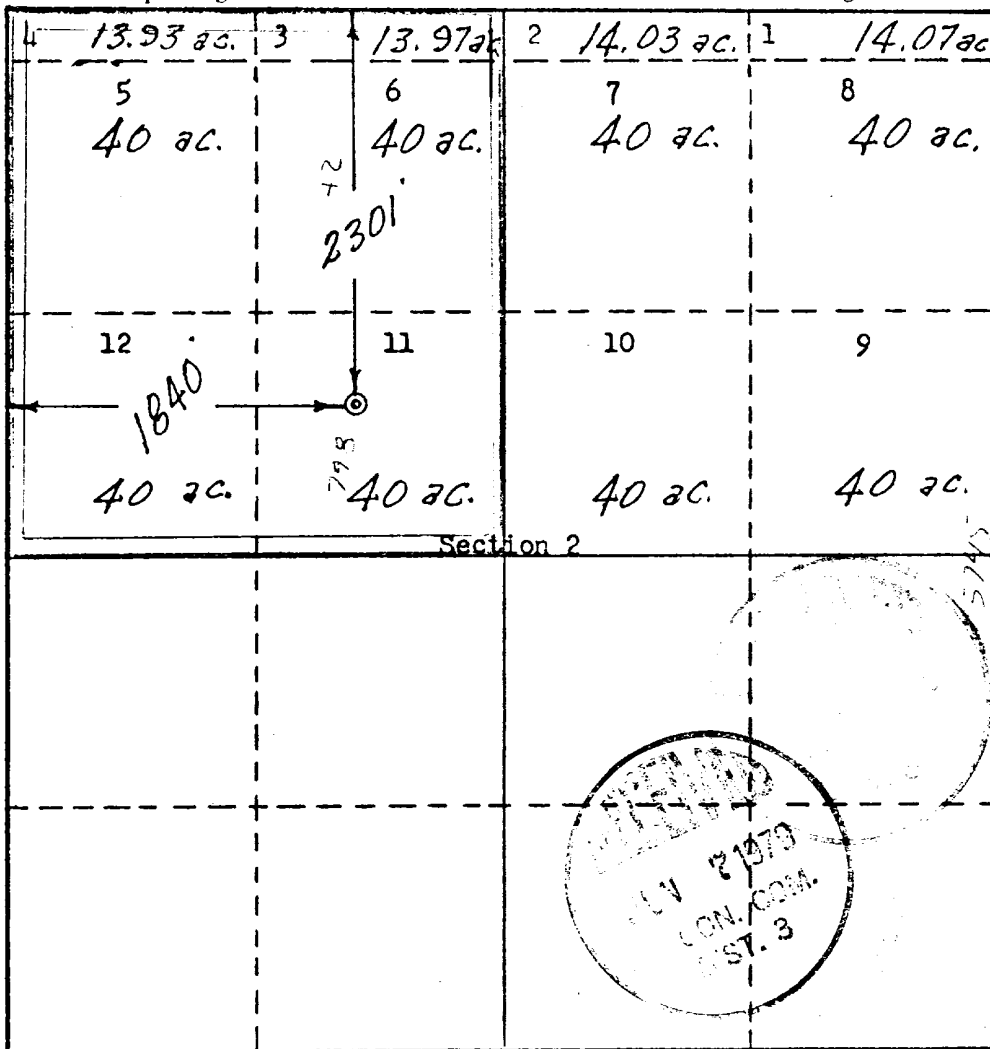

CERTIFICATION

I hereby certify that the information contained herein is true and complete to the best of my knowledge and belief.

Name
William J. Chas
Position
Field Services Asst.
Company
Energy Reserves Group
Date
6-5-79

I hereby certify that the well location shown on this plat was plotted from field notes of actual surveys made by me or under my supervision, and that the same is true and correct to the best of my knowledge and belief.

Date Surveyed
May 8, 1979
Registered Professional Engineer and Land Surveyor
Certificate No.
3234

