

UNITED STATES  
DEPARTMENT OF THE INTERIOR  
GEOLOGICAL SURVEY

## APPLICATION FOR PERMIT TO DRILL, DEEPEN, OR PLUG BACK

## 1a. TYPE OF WORK

DRILL ☒DEEPEN ☐PLUG BACK ☐

## b. TYPE OF WELL

OIL  
WELL ☒GAS  
WELL ☐

OTHER

SINGLE  
ZONE ☒MULTIPLE  
ZONE ☐

## 2. NAME OF OPERATOR

Mobil Oil Corporation

## 3. ADDRESS OF OPERATOR

Nine Greenway Plaza, Suite 2700, Houston, Texas 77046

## 4. LOCATION OF WELL (Report location clearly and in accordance with any State requirements.)\*

At surface

D 790' FNL &amp; 790' FWL, Sec. 28, T24N, R3W

At proposed prod. zone

Same as surface

## 14. DISTANCE IN MILES AND DIRECTION FROM NEAREST TOWN OR POST OFFICE\*

50 miles Southeast of Farmington

15. DISTANCE FROM PROPOSED\* LOCATION TO NEAREST PROPERTY OR LEASE LINE, FT.  
(Also to nearest drlg. unit line, if any)

2680' South

## 16. NO. OF ACRES IN LEASE

26,365.43

## 18. DISTANCE FROM PROPOSED LOCATION\* TO NEAREST WELL, DRILLING, COMPLETED, OR APPLIED FOR, ON THIS LEASE, FT. to proposed Well #2

## 19. PROPOSED DEPTH

8200'

## 17. NO. OF ACRES ASSIGNED TO THIS WELL

160

## 20. ROTARY OR CABLE TOOLS

Rotary

## 21. ELEVATIONS (Show whether DF, RT, GR, etc.)

6943' - Ground

## 22. APPROX. DATE WORK WILL START\*

September 1, 1979

## 23.

## PROPOSED CASING AND CEMENTING PROGRAM

SIZE OF HOLE	SIZE OF CASING	WEIGHT PER FOOT	SETTING DEPTH	QUANTITY OF CEMENT
17-1/2"	13-3/8"	48# H-40	0- 300'	1) Circulate to surface
12-1/4"	8-5/8"	24# K-55	0-2500' }	2) Circulate to surface
	8-5/8"	32# H-40	2500-3900' }	
7-7/8"	5-1/2"	15.5# K-55	0-7500' }	3) Circulate
	5-1/2"	17# K-55	7500-8200' }	

## Cementing Program

1) Class A with 2% CaCl<sub>2</sub>

(2) Class A with 6% gel tailed in with Neat cement.

3) Class H

## Mud Program

Depth	Type of Mud	Weight	Viscosity	pH	Water Loss
0-300'	Spud Mud	10.0	---	----	---
300-8200'	Fresh Water Gel	9.0	40	7-10	No Control

## Blowout Preventer Program

Attached

IN ABOVE SPACE DESCRIBE PROPOSED PROGRAM: If proposal is to deepen or plug back, give data on present productive zone and proposed new productive zone. If proposal is to drill or deepen directionally, give pertinent data on subsurface locations and measured and true vertical depths. Give blowout preventer program, if any.

## 24.

SIGNED A. D. Bond A. D. BondTITLE Regulatory EngineeringDATE August 3, 1979

(This space for Federal or State office use)

Coordinator II

U. S. GEOLOGICAL SURVEY  
FARMINGTON, N. M.

PERMIT NO. \_\_\_\_\_

APPROVAL DATE

APPROVED BY \_\_\_\_\_  
CONDITIONS OF APPROVAL, IF ANY:

TITLE

DATE

\*See Instructions On Reverse Side

NEW MEXICO OIL CONSERVATION COMMISSION  
WELL LOCATION AND ACREAGE DEDICATION PLAT

Form 7-1-1  
Supersedes 6-1-29  
Effective 1-1-51

All distances must be from the outer boundaries of the Section

Owner Mobil Oil Corporation			Location Lindrith Unit		Well No. 1
Section D	Range 28	Township 24N	Meridian 3W	County Rio Arriba	
Actual Surface Location of Well: 790 feet from the North line and 790 feet from the West line					
Ground Level Elev. 6943'	Producing Formation Dakota		Pool Chacon-Dakota Associated <i>ext</i>		Dedicated Acreage 160 Acres

1. Outline the acreage dedicated to the subject well by colored pencil or hatchure marks on the plat below.
2. If more than one lease is dedicated to the well, outline each and identify the ownership thereof (both as to working interest and royalty).
3. If more than one lease of different ownership is dedicated to the well, have the interests of all owners been consolidated by communitization, unitization, force-pooling, etc?

☒ Yes ☐ No If answer is "yes," type of consolidation Unitization

If answer is "no," list the owners and tract descriptions which have actually been consolidated. (Use reverse side of this form if necessary.)

No allowable will be assigned to the well until all interests have been consolidated (by communitization, unitization, forced-pooling, or otherwise) or until a non-standard unit, eliminating such interests, has been approved by the Commission.

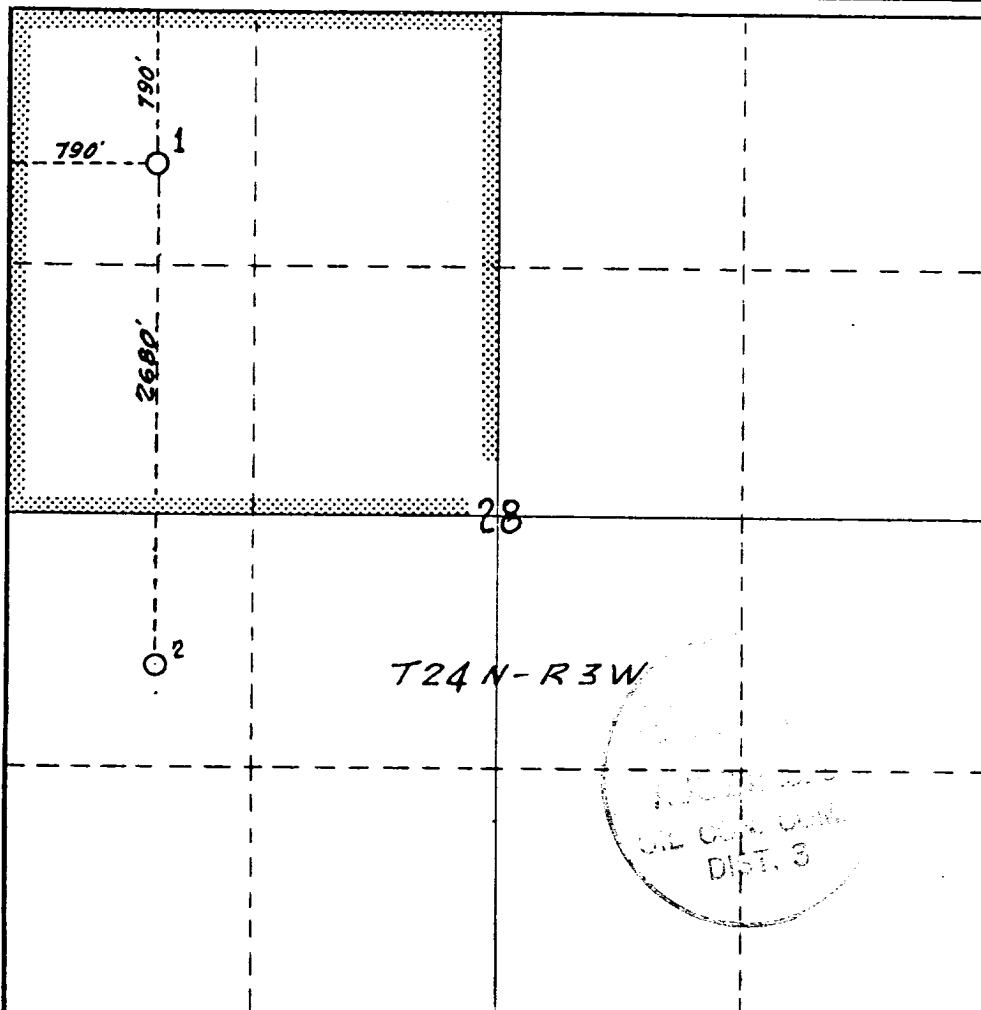

CERTIFICATION

I hereby certify that the information contained herein is true and complete to the best of my knowledge and belief.

*A. D. Bond*

Name  
A. D. Bond  
Position Regulatory  
Engineering Coordinator II

Company  
Mobil Oil Corporation

Date  
August 3, 1979

I hereby certify that the well location shown on this plat was plotted from field notes of actual survey made by me or under my supervision, and that the same is true and correct to the best of my knowledge and belief.

*H. A. Carson Jr.*

Date Surveyed  
July 11, 1979

Registered Professional Engineer  
and/or Land Surveyor

H. A. Carson, Jr.

Certificate No.  
5063

0 330 660 990 1320 1650 1980 2310 2640 2970 3300 3630 3960 4290 4620 4950 5280 5610 5940 6270 6600

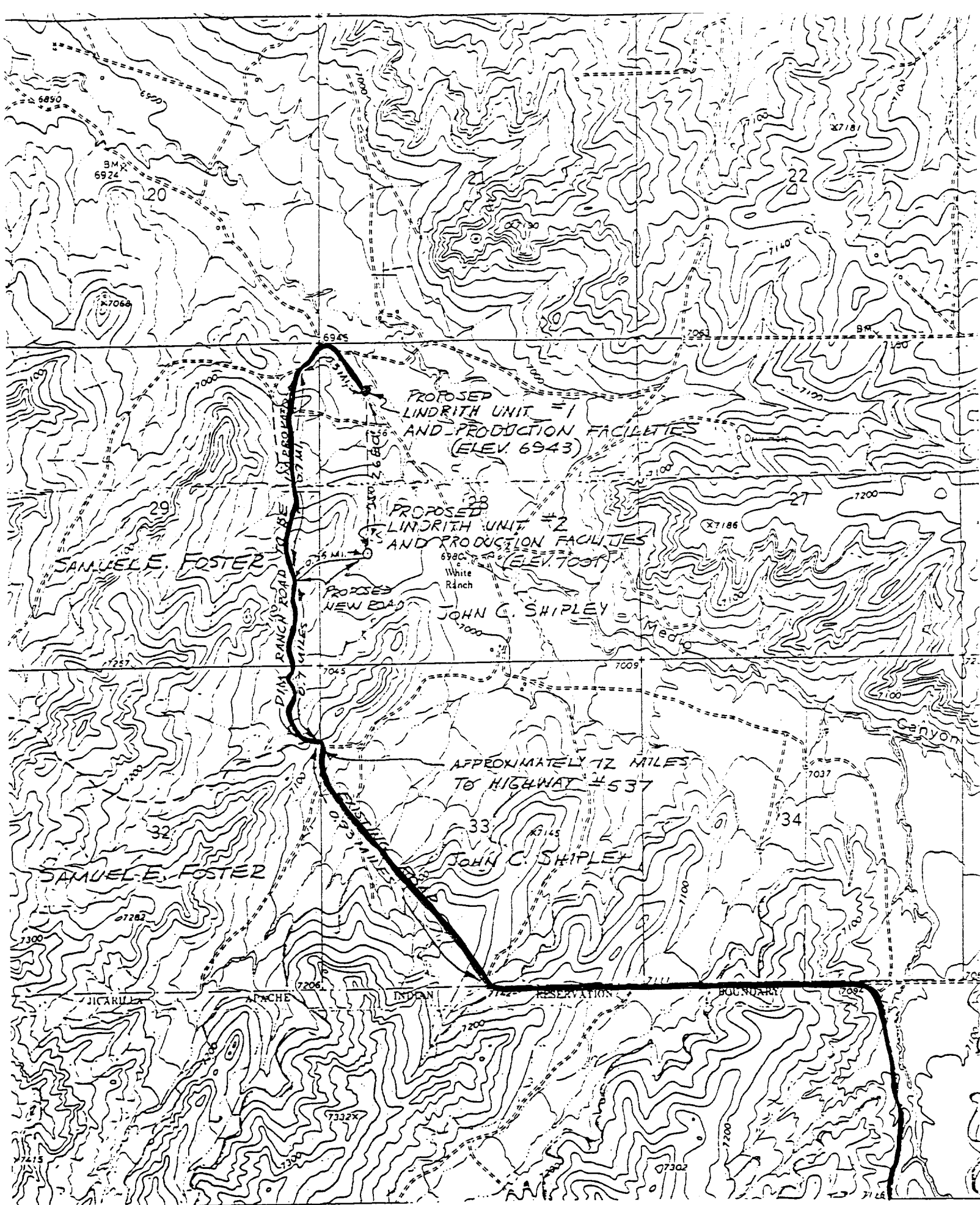

LINDRITH UNIT #1  
790' FWL AND 790' FNL  
SEC. 28 T-24-N R-3-W  
PIO APPIRA COUNTY

MAP "B"