

UNITED STATES
DEPARTMENT OF THE INTERIOR
GEOLOGICAL SURVEY

30-039-25138

5. LEASE DESIGNATION AND SERIAL NO.
Santa Fe 078914

6. IF INDIAN, ALLOTTEE OR TRIBE NAME

7. UNIT AGREEMENT NAME
Lindrith Unit

8. FARM OR LEASE NAME

9. WELL NO.
2

10. FIELD AND POOL, OR WILDCAT
Chacon-Dakota Associated

11. SEC., T., R., M., OR BLK. AND SURVEY OR AREA
Sec. 28, T24N, R3W

12. COUNTY OR PARISH 13. STATE
Rio Arriba New Mexico

APPLICATION FOR PERMIT TO DRILL, DEEPEN, OR PLUG BACK

1a. TYPE OF WORK
DRILL DEEPEN PLUG BACK

b. TYPE OF WELL
OIL WELL GAS WELL OTHER
SINGLE ZONE MULTIPLE ZONE

2. NAME OF OPERATOR
Mobil Oil Corporation

3. ADDRESS OF OPERATOR
Nine Greenway Plaza, Suite 2700, Houston, Texas 77046

4. LOCATION OF WELL (Report location clearly and in accordance with any State requirements.)
At surface 1810' FSL and 790' FWL, Sec. 28, T24N, R3W
At proposed prod. zone same as surface

14. DISTANCE IN MILES AND DIRECTION FROM NEAREST TOWN OR POST OFFICE*
50 miles Southeast of Farmington

15. DISTANCE FROM PROPOSED* 790' to lease line LOCATION TO NEAREST PROPERTY OR LEASE LINE, FT. (Also to nearest drlg. unit line, if any)
2680' North

16. NO. OF ACRES IN LEASE
26,365.43

17. NO. OF ACRES ASSIGNED TO THIS WELL
160

18. DISTANCE FROM PROPOSED LOCATION* TO NEAREST WELL, DRILLING, COMPLETED, OR APPLIED FOR, ON THIS LEASE, FT. to proposed Well #1
8200'

19. PROPOSED DEPTH
8200'

20. ROTARY OR CABLE TOOLS
Rotary

21. ELEVATIONS (Show whether DF, RT, GR, etc.)
7001' - Ground

22. APPROX. DATE WORK WILL START*
October 1, 1979

23. PROPOSED CASING AND CEMENTING PROGRAM

SIZE OF HOLE	SIZE OF CASING	WEIGHT PER FOOT	SETTING DEPTH	QUANTITY OF CEMENT
17-1/2"	13-3/8"	48# H-40	0-300'	1. Circulate to surface 2. Circulate to surface
12-1/4"	8-5/8"	24# K-55	0-2500'	
	8-5/8"	32# H-40	2500-3900'	
7-7/8"	5-1/2"	15.5# K-55	0-7500'	3. Circulate to surface
	5-1/2"	17# K-55	7500-8200'	

Cementing Program

- 1) Class A with 2% CaCl₂
- (2) Class A with 6% gel tailed in with Neat cement.
- 3) Class H

Mud Program

Depth	Type of Mud	Weight	Viscosity	pH	Water Loss
0-300'	Spud Mud	10.0	----	----	----
300-8200'	Fresh Water Gel	9.0	40	----	----

Blowout Preventer Program
Attached

IN ABOVE SPACE DESCRIBE PROPOSED PROGRAM: If proposal is to deepen or plug back, give data on present productive zone and proposed new productive zone. If proposal is to drill or deepen directionally, give pertinent data on subsurface locations and measured and true vertical depths. Give blowout preventer program, if any.

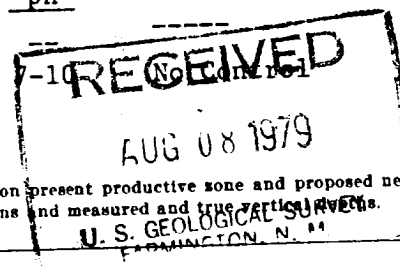

24. SIGNED A. D. Bond A. D. Bond TITLE Regulatory Engineering DATE August 3, 1979

(This space for Federal or State office use) COORDINATOR II

PERMIT NO. _____ APPROVAL DATE _____

APPROVED BY _____ TITLE _____ DATE AUG 10 1979

CONDITIONS OF APPROVAL, IF ANY: _____

NEW MEXICO OIL CONSERVATION COMMISSION
WELL LOCATION AND ACREAGE DEDICATION PLAT

Form O-10
Supersedes O-128
Effective 1-1-65

All distances must be from the outer boundaries of the Section.

Lessee Mobil Oil Corporation		Lease Lindrieth Unit			Well No. 2
Section L	Township 28	Range 24N	County 3W	County Rio Arriba	
Actual Surface Location of Well: 1810' feet from the South line and		790' feet from the West line			
Ground Level Elev. 7001'	Producing Formation Dakota	Pool Chacon-Dakota Associated	Dedicated Acreage 160 Acres		

1. Outline the acreage dedicated to the subject well by colored pencil or hachure marks on the plat below.
2. If more than one lease is dedicated to the well, outline each and identify the ownership thereof (both as to working interest and royalty).
3. If more than one lease of different ownership is dedicated to the well, have the interests of all owners been consolidated by communitization, unitization, force-pooling, etc?

Yes No If answer is "yes," type of consolidation Unitization

If answer is "no," list the owners and tract descriptions which have actually been consolidated. (Use reverse side of this form if necessary.) _____

No allowable will be assigned to the well until all interests have been consolidated (by communitization, unitization, forced-pooling, or otherwise) or until a non-standard unit, eliminating such interests, has been approved by the Commission.

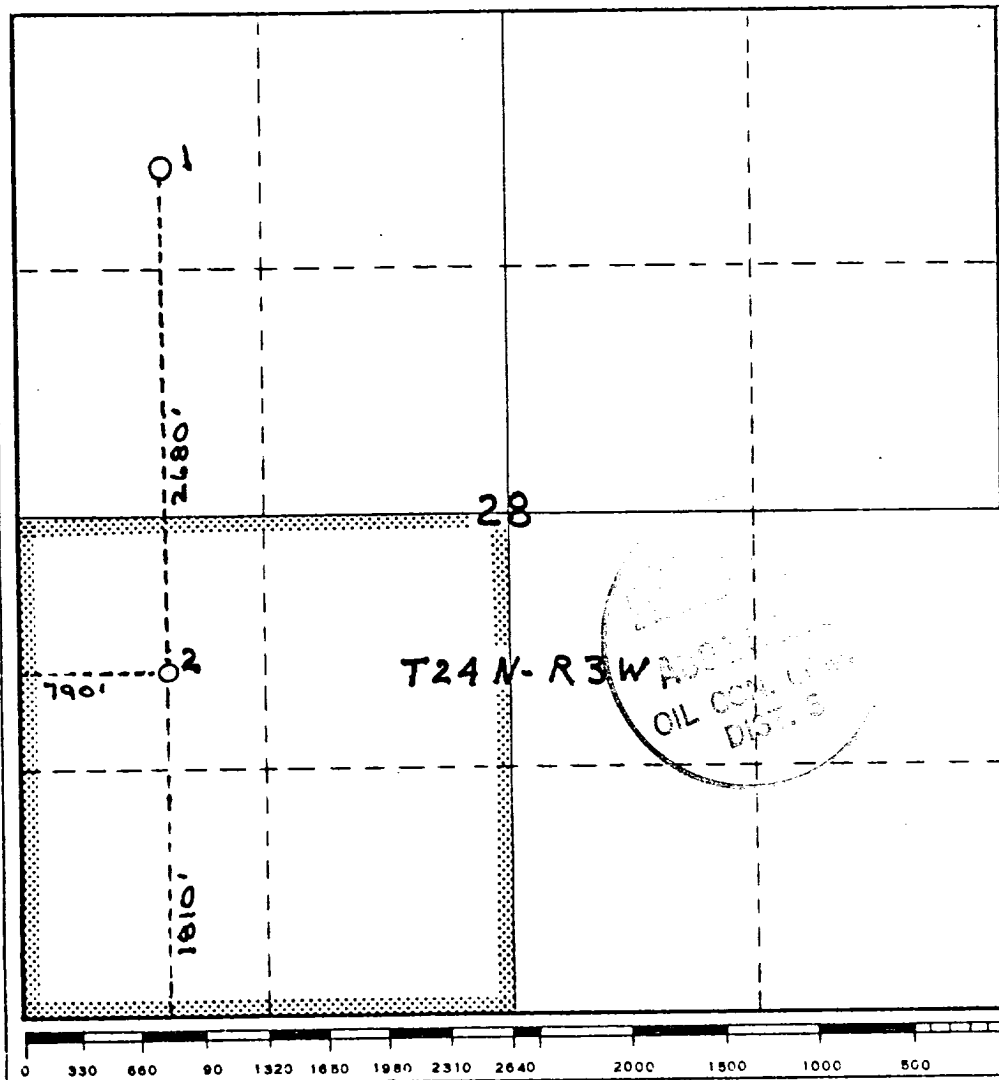

CERTIFICATION

I hereby certify that the information contained herein is true and complete to the best of my knowledge and belief.

A. D. Bond
Name
A. D. Bond
Position **Regulatory Engineering Coordinator II**
Company **Mobil Oil Corporation**
Date **August 3, 1979**

I hereby certify that the well location shown on this plat was plotted from field notes of actual surveys made by me or under my supervision, and that the same is true and correct to the best of my knowledge and belief.

H. A. Carson, Jr.
Date Surveyed **July 11, 1979**
Registered Professional Engineer and/or Land Surveyor
H. A. Carson, Jr.
Certificate No. **5063**

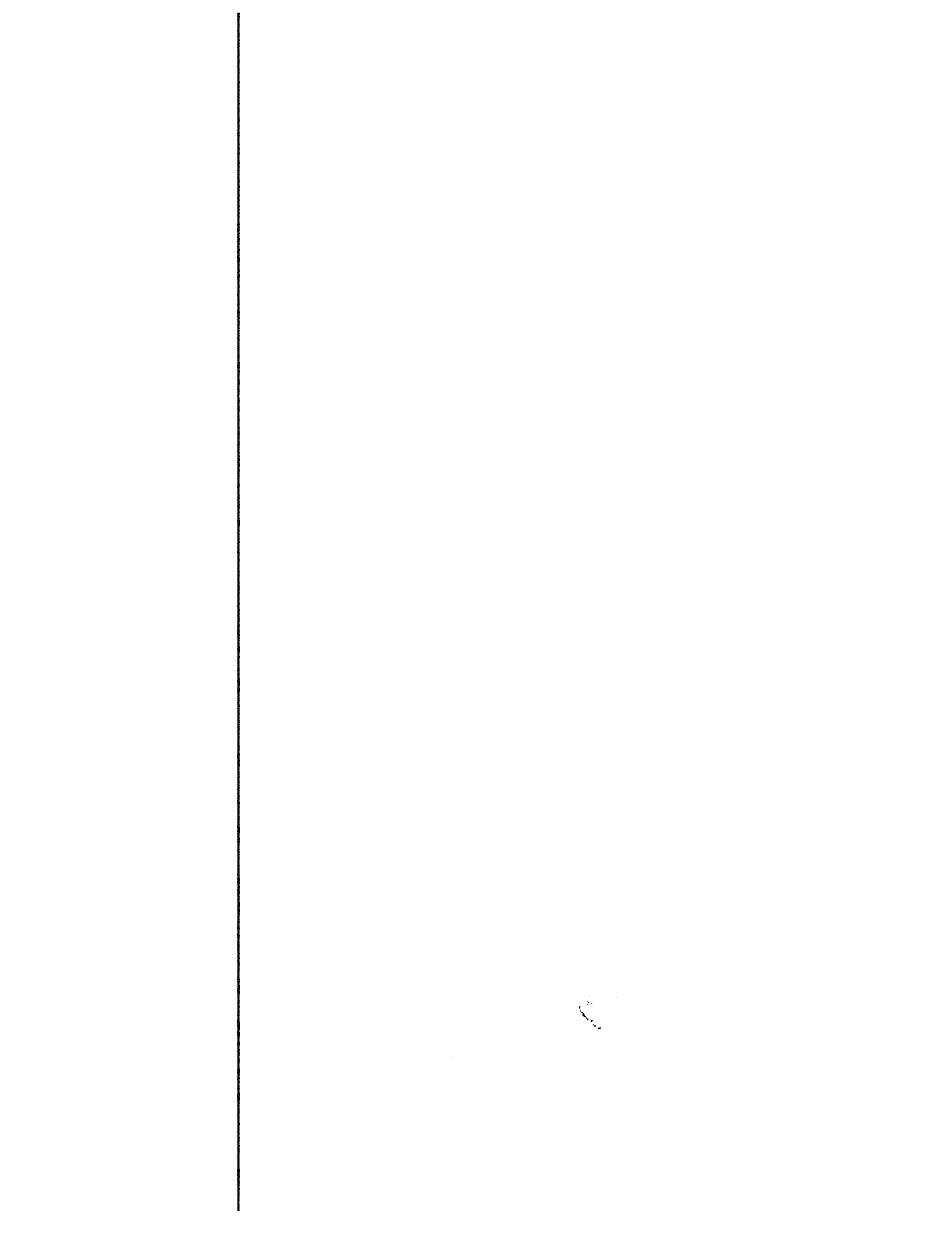

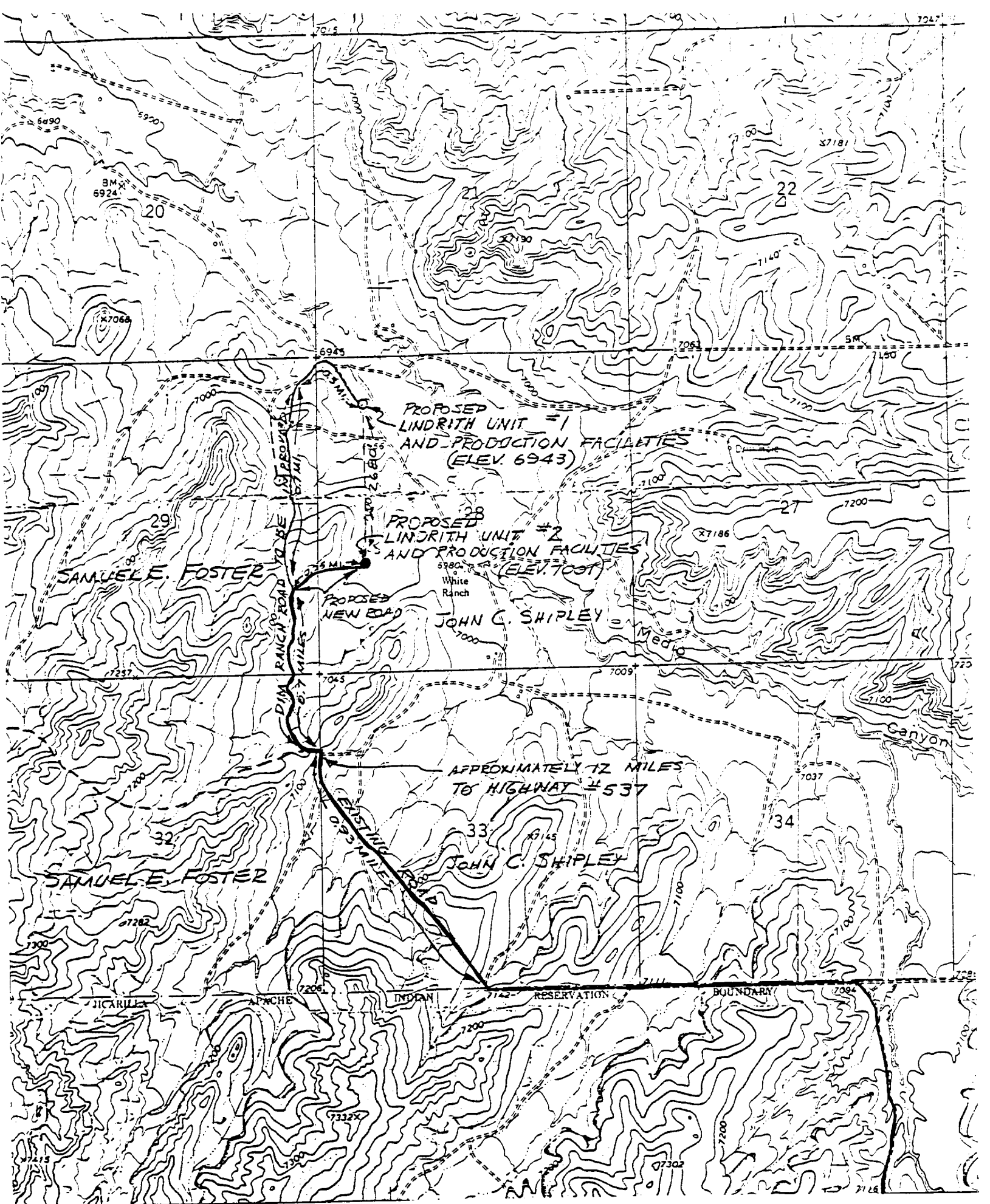

LINDRITH UNIT #2
 790' FWL AND 1810' FSL
 SEC. 28, T-24-N, R-3-W

MAP "B"

SCALE: 1:24000
 CONTOUR INTERVAL = 20'