

UNITED STATES
DEPARTMENT OF THE INTERIOR
GEOLOGICAL SURVEY

APPLICATION FOR PERMIT TO DRILL, DEEPEN, OR PLUG BACK

1a. TYPE OF WORK DRILL ☒ DEEPEN ☐ PLUG BACK ☐b. TYPE OF WELL
OIL WELL ☒ GAS WELL ☒ OTHER ☐ SINGLE ZONE ☐ MULTIPLE ZONE ☒2. NAME OF OPERATOR ARCO Oil and Gas Company
Division of Atlantic Richfield Company3. ADDRESS OF OPERATOR Suite 501
1860 Lincoln Street, Denver, Colorado 802954. LOCATION OF WELL (Report location clearly and in accordance with any State requirements.*)
At surface500' F/NL & 1650 F/WL Sec. 7 -24N-4W (NE, NW)
At proposed prod. zone

Same

14. DISTANCE IN MILES AND DIRECTION FROM NEAREST TOWN OR POST OFFICE*

See NTL-6

15. DISTANCE FROM PROPOSED*
LOCATION TO NEAREST
PROPERTY OR LEASE LINE, FT.
(Also to nearest drg. unit lde, if any) 1650'16. NO. OF ACRES IN LEASE
2611.2017. NO. OF ACRES ASSIGNED
TO THIS WELL
122.3118. DISTANCE FROM PROPOSED LOCATION*
TO NEAREST WELL, DRILLING, COMPLETED,
OR APPLIED FOR, ON THIS LEASE, FT. 450'19. PROPOSED DEPTH
7540'20. ROTARY OR CABLE TOOLS
Rotary21. ELEVATIONS (Show whether DF, RT, GR, etc.)
6800' GR (Ungraded)22. APPROX. DATE WORK WILL START*
When approved appl. rec'd
from District Engineer

23. PROPOSED CASING AND CEMENTING PROGRAM

SIZE OF HOLE	SIZE OF CASING	WEIGHT PER FOOT	SETTING DEPTH	QUANTITY OF CEMENT
12-1/4"	8-5/8" OD	24#	±300'	300 sx. (cmt. to surf)
7-7/8"	5-1/2" OD	15.5 & 17#	T. D.	550 sx.

Propose to drill well to a depth sufficient to test the Dakota Formation, setting surface casing and if productive setting production casing. If both formations are productive (Gallup and Dakota) will perforate, test and treat if necessary and commingle production.

Pursuant to NTL-6, attached are: Certified Location Plat
Drilling Plan with attachment
Surface Use and Operations Plan with attachments.



IN ABOVE SPACE DESCRIBE PROPOSED PROGRAM: If proposal is to deepen or plug back, give data on present productive zone and proposed new productive zone. If proposal is to drill or deepen directionally, give pertinent data on subsurface locations and measured and true vertical depths. Give blowout preventer program, if any.

24. SIGNED [Signature] TITLE Operations Manager DATE 8-22-79

(This space for Federal or State office use)

PERMIT NO. _____ APPROVAL DATE _____

APPROVED BY _____ TITLE _____ DATE 11

CONDITIONS OF APPROVAL, IF ANY:

Ante 11/11/79
oh 3rdState

AUG 23 1979

NEW MEXICO OIL CONSERVATION COMMISSION
WELL LOCATION AND ACREAGE DEDICATION PLAT

Form C-102
Supersedes C-128
Effective 1-1-65

All distances must be from the outer boundaries of the Section.

Operator ARCO OIL AND GAS COMPANY		Lease JICARILLA APACHE "H"		Well No. 114
Unit Letter C	Section 7	Township 24 NORTH	Range 4 WEST	County RIO ARRIBA
Actual Footage Location of Well: 500 feet from the NORTH line and 1650 feet from the WEST line				
Ground Level Elev. 6822	Producing Formation Gallup/Dakota	Pool West Lindrith Gallup/Dakota	Dedicated Acreage: 122.31 Acres	

1. Outline the acreage dedicated to the subject well by colored pencil or hatchure marks on the plat below.
2. If more than one lease is dedicated to the well, outline each and identify the ownership thereof (both as to working interest and royalty). **N/A**
3. If more than one lease of different ownership is dedicated to the well, have the interests of all owners been consolidated by communitization, unitization, force-pooling, etc? **N/A**

☐ Yes ☐ No If answer is "yes," type of consolidation _____

If answer is "no," list the owners and tract descriptions which have actually been consolidated. (Use reverse side of this form if necessary.) _____

No allowable will be assigned to the well until all interests have been consolidated (by communitization, unitization, forced-pooling, or otherwise) or until a non-standard unit, eliminating such interests, has been approved by the Commission.

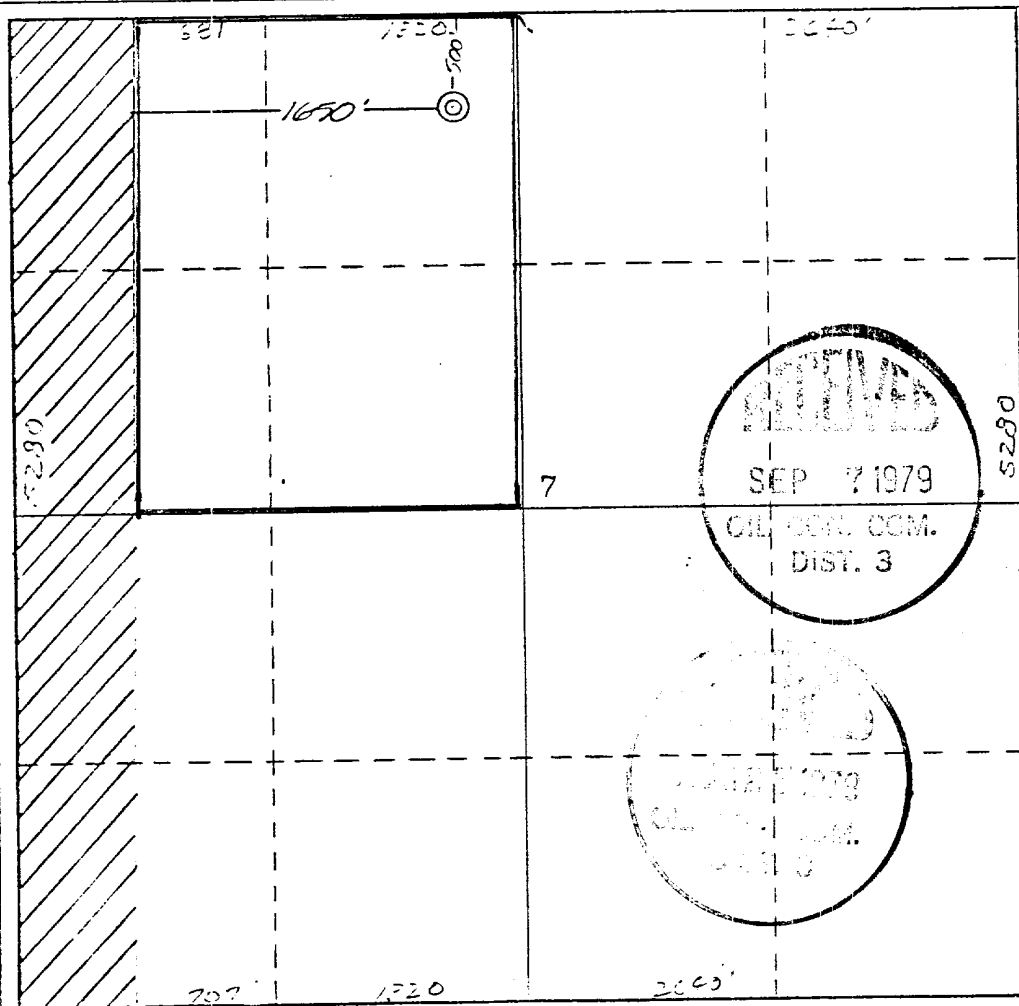

CERTIFICATION

I hereby certify that the information contained herein is true and complete to the best of my knowledge and belief.

W. A. Walther, Jr.
Name
W. A. Walther, Jr.
Position
Operations Manager
Company ARCO Oil and Gas Co.
Div. of Atlantic Richfield
Date August 23, 1979
Company

I hereby certify that the location shown on the plat is correct and that the same is true and correct to the best of my knowledge and belief.

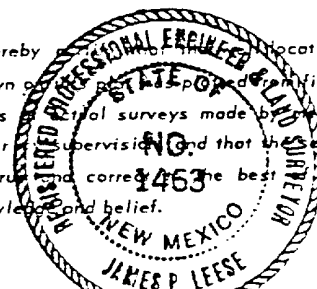

Date Surveyed
28 May 1979
Registered Professional Engineer and/or Land Surveyor
James P. Leese
James P. Leese
Certificate No.
1463

