

STATE OF NEW MEXICO
ENERGY AND MINERALS DEPARTMENT

OIL CONSERVATION DIVISION

P. O. BOX 2088

SANTA FE, NEW MEXICO 87501

Form C-102
Revised 10-1-78

All distances must be from the outer boundaries of the Section.

Operator BANNON ENERGY, INC.		Lease RINCON		Well No. # 4
Unit Letter F	Section 24	Township 24 NORTH	Range 7 WEST	County RIO ARRIBA
Actual Footage Location of Well 1850 feet from the NORTH line and 1820 feet from the WEST line				
Ground Level Elev. 6621	Producing Formation GALLUP	Pool DEVILS' FORK ASSOC.	Dedicated Acreage 160 Acres	

1. Outline the acreage dedicated to the subject well by colored pencil or hachure marks on the plat below.
2. If more than one lease is dedicated to the well, outline each and identify the ownership thereof (both as to working interest and royalty).
3. If more than one lease of different ownership is dedicated to the well, have the interests of all owners been consolidated by communitization, unitization, force-pooling, etc?

☐ Yes ☐ No If answer is "yes," type of consolidation _____

If answer is "no," list the owners and tract descriptions which have actually been consolidated. (Use reverse side of this form if necessary.) _____

No allowable will be assigned to the well until all interests have been consolidated (by communitization, unitization, forced-pooling, or otherwise) or until a non-standard unit, eliminating such interests, has been approved by the Division.

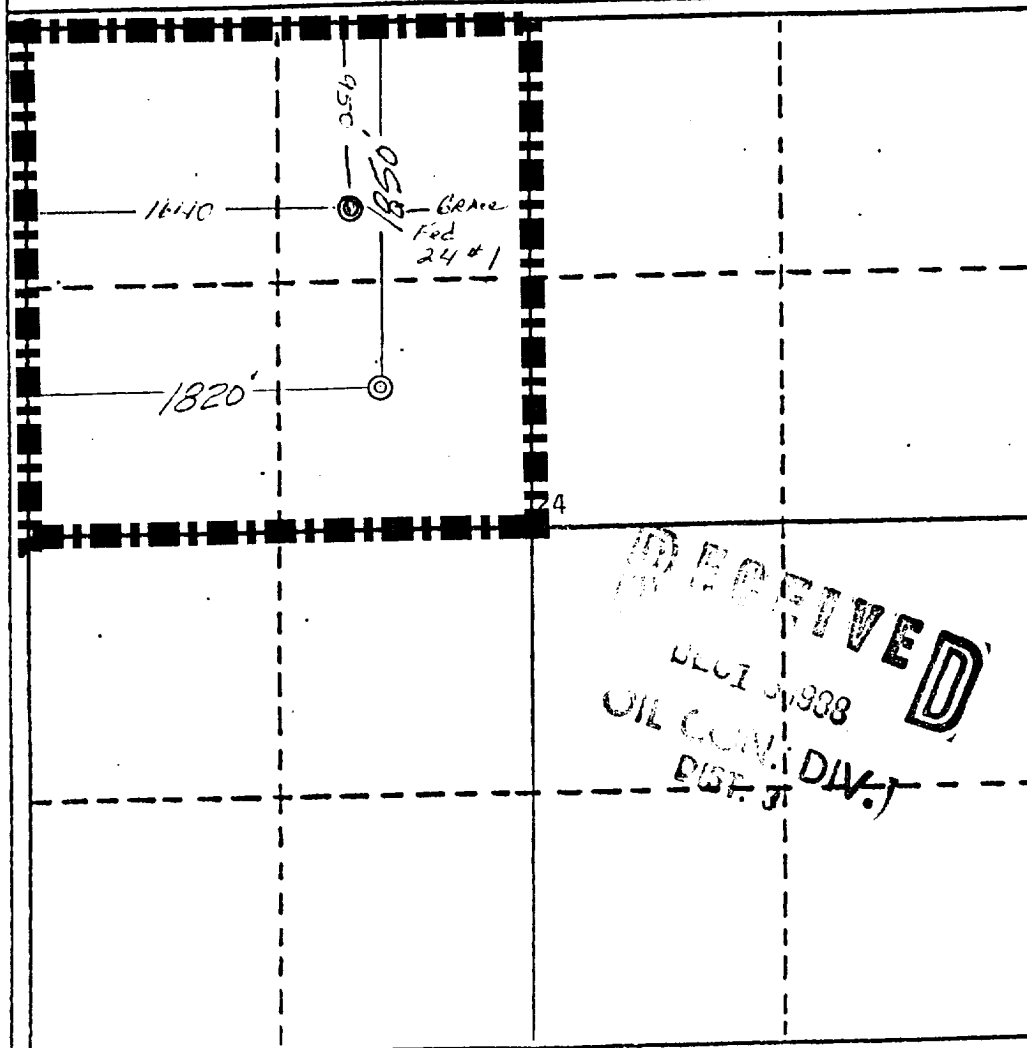

CERTIFICATION

I hereby certify that the information contained herein is true and complete to the best of my knowledge and belief.

Name
Shirley Blane for
Position BANNON ENERGY

Company
BANNON ENERGY, INC.

Date
DECEMBER 14, 1988

I hereby certify that the location shown on this plat was plotted from field notes of actual surveys made by me or under my supervision, and that the same is true and correct to the best of my knowledge and belief.

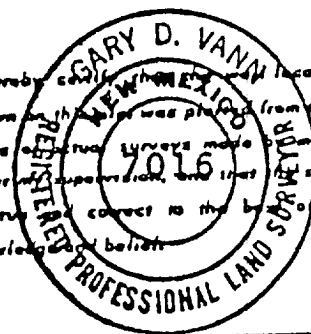

Date Surveyed
October 10, 1988

Registered Professional Engineer and/or Land Surveyor
Gary D. Vann
Gary D. Vann

Certificate No.
7016