

UNITED STATES
DEPARTMENT OF THE INTERIOR
GEOLOGICAL SURVEY

APPLICATION FOR PERMIT TO DRILL, DEEPEN, OR PLUG BACK

1a. TYPE OF WORK

DRILL ☒DEEPEN ☐OCT 29 1979
PLUG BACK ☐

b. TYPE OF WELL

OIL
WELL ☐GAS
WELL ☒

OTHER

U.S. GEOLOGICAL SURVEY

2. NAME OF OPERATOR

Cotton Petroleum Corporation

3. ADDRESS OF OPERATOR

717 17th St., Suite 2200, Denver, Colorado 80202

4. LOCATION OF WELL (Report location clearly and in accordance with any State requirements.*)

At surface

1850' FEL, 1850' FSL, Section 3

At proposed prod. zone

14. DISTANCE IN MILES AND DIRECTION FROM NEAREST TOWN OR POST OFFICE*

15. DISTANCE FROM PROPOSED*

LOCATION TO NEAREST
PROPERTY OR LEASE LINE, FT.
(Also to nearest lrlg. unit line, if any)

790'

16. NO. OF ACRES IN LEASE

17. NO. OF ACRES ASSIGNED
TO THIS WELL

160

18. DISTANCE FROM PROPOSED LOCATION*
TO NEAREST WELL, DRILLING, COMPLETED,
OR APPLIED FOR, ON THIS LEASE, FT.19. PROPOSED DEPTH
3200'20. ROTARY OR CABLE TOOLS
Rotary

21. ELEVATIONS (Show whether DF, RT, GR, etc.)

6819' GR

22. APPROX. DATE WORK WILL START*

April, 1980

23.

PROPOSED CASING AND CEMENTING PROGRAM

SIZE OF HOLE	SIZE OF CASING	WEIGHT PER FOOT	SETTING DEPTH	QUANTITY OF CEMENT
12-1/4"	8-5/8"	24#	100'	150 sx
7-7/8"	4-1/2"	10.5#	3200'	To be determined

It is proposed to drill this well with rotary tools using drilling mud for circulation through the Pictured Cliffs formation. All possible productive intervals in the Pictured Cliffs will be completed.

Estimated formation tops:

Ojo Alamo	2500'	Fruitland	2920'
Kirtland	2700'	Pictured Cliffs	3040'

The SE $\frac{1}{4}$ of Section 3 is dedicated to this well. The gas produced from this well will be sold to Northwest Pipeline Co.

IN ABOVE SPACE DESCRIBE PROPOSED PROGRAM: If proposal is to deepen or plug back, give data on present productive zone and proposed new productive zone. If proposal is to drill or deepen directionally, give pertinent data on subsurface locations and measured and true vertical depths. Give blowout preventer program, if any.

24.

SIGNED

D.E. Wood / JGJ

TITLE Division Production Manager

DATE

October 23, 1979

(This space for Federal or State office use)

PERMIT NO.

APPROVAL DATE

APPROVED BY

TITLE

DATE

CONDITIONS OF APPROVAL, IF ANY:

ch 3/22

*See Instructions On Reverse Side

OIL CONSERVATION DIVISION

STATE OF NEW MEXICO
ENERGY AND MINERALS DEPARTMENTP. O. BOX 2088
SANTA FE, NEW MEXICO 87501Form C-102
Revised 10-1-78

All distances must be from the outer boundary of the Section.

Operator COTTON PETROLEUM CORPORATION			Lease APACHE		Well No. 30
Unit: Letter J	Section 3	Township 24N	Range 4W	County Rio Arriba	
Actual Footage Location of Well: 1850 feet from the South line and 1850 feet from the East line					
Ground Level Elev. 6819	Producing Formation Pictured Cliffs		Pool So. Blanco Pictured Cliffs	Dedicated Acreage: 160 Acres	

1. Outline the acreage dedicated to the subject well by colored pencil or hachure marks on the plat below.
2. If more than one lease is dedicated to the well, outline each and identify the ownership thereof (both as to working interest and royalty).
3. If more than one lease of different ownership is dedicated to the well, have the interests of all owners been consolidated by communization, unitization, force-pooling, etc?

☐ Yes ☐ No If answer is "yes," type of consolidation _____

If answer is "no," list the owners and tract descriptions which have actually been consolidated. (Use reverse side of this form if necessary.) _____

No allowable will be assigned to the well until all interests have been consolidated (by communization, unitization, forced-pooling, or otherwise) or until a non-standard unit, eliminating such interests, has been approved by the Commission.

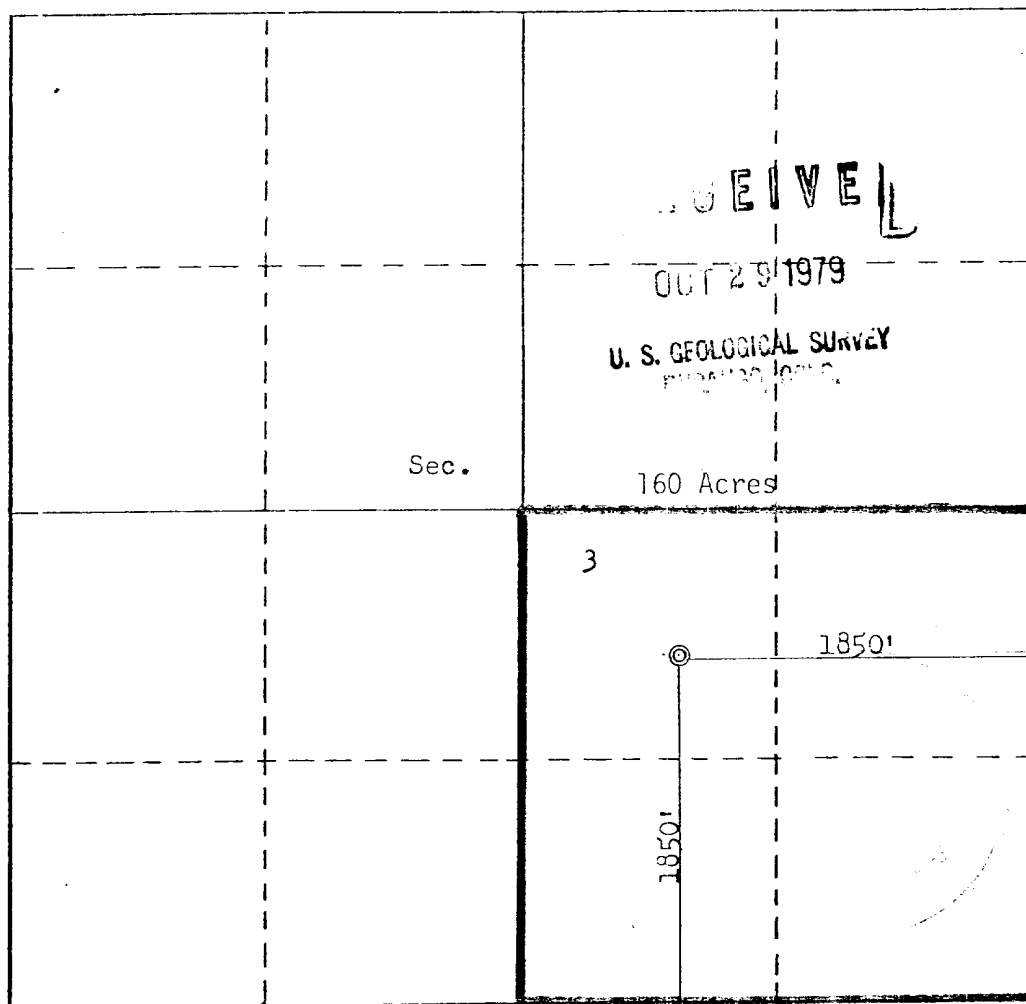

CERTIFICATION

I hereby certify that the information contained herein is true and complete to the best of my knowledge and belief.

D. E. Wood
Name

D. E. Wood
Position

Division Production Mgr.
Company

Cotton Petroleum Corporation
Date

October 23, 1979

I hereby certify that the well location shown on this plat was plotted from field notes of actual surveys made by me or under my supervision, and that the same is true and correct to the best of my knowledge and belief.

Date Surveyed

October 19, 1979

Registered Professional Engineer
and/or Land Surveyor

Fred B. Kerr Jr.
Certificate No. 3950

3950

0 230 660 90 1320 1650 1980 2310 2640 2000 1500 1000 500 0

