

All distances must be from the outer boundaries of the Section.

Operator COTTON PETROLEUM CORPORATION			Lease APACHE		Well No. 30
Unit Letter J	Section 3	Township 24N	Range 4W	County Rio Arriba	

Actual Footage Location of Well: 1850 feet from the South line and 1850 feet from the East line					
Ground Level Elev. 6819	Producing Formation Pictured Cliffs		Pool So. Blanco Pictured Cliffs	Dedicated Acreage: 160 Acres	

1. Outline the acreage dedicated to the subject well by colored pencil or hachure marks on the plat below.
2. If more than one lease is dedicated to the well, outline each and identify the ownership thereof (both as to working interest and royalty).
3. If more than one lease of different ownership is dedicated to the well, have the interests of all owners been consolidated by communitization, unitization, force-pooling, etc?

☐ Yes ☐ No If answer is "yes," type of consolidation _____

If answer is "no," list the owners and tract descriptions which have actually been consolidated. (Use reverse side of this form if necessary.) _____

No allowable will be assigned to the well until all interests have been consolidated (by communitization, unitization, forced-pooling, or otherwise) or until a non-standard unit, eliminating such interests, has been approved by the Commission.

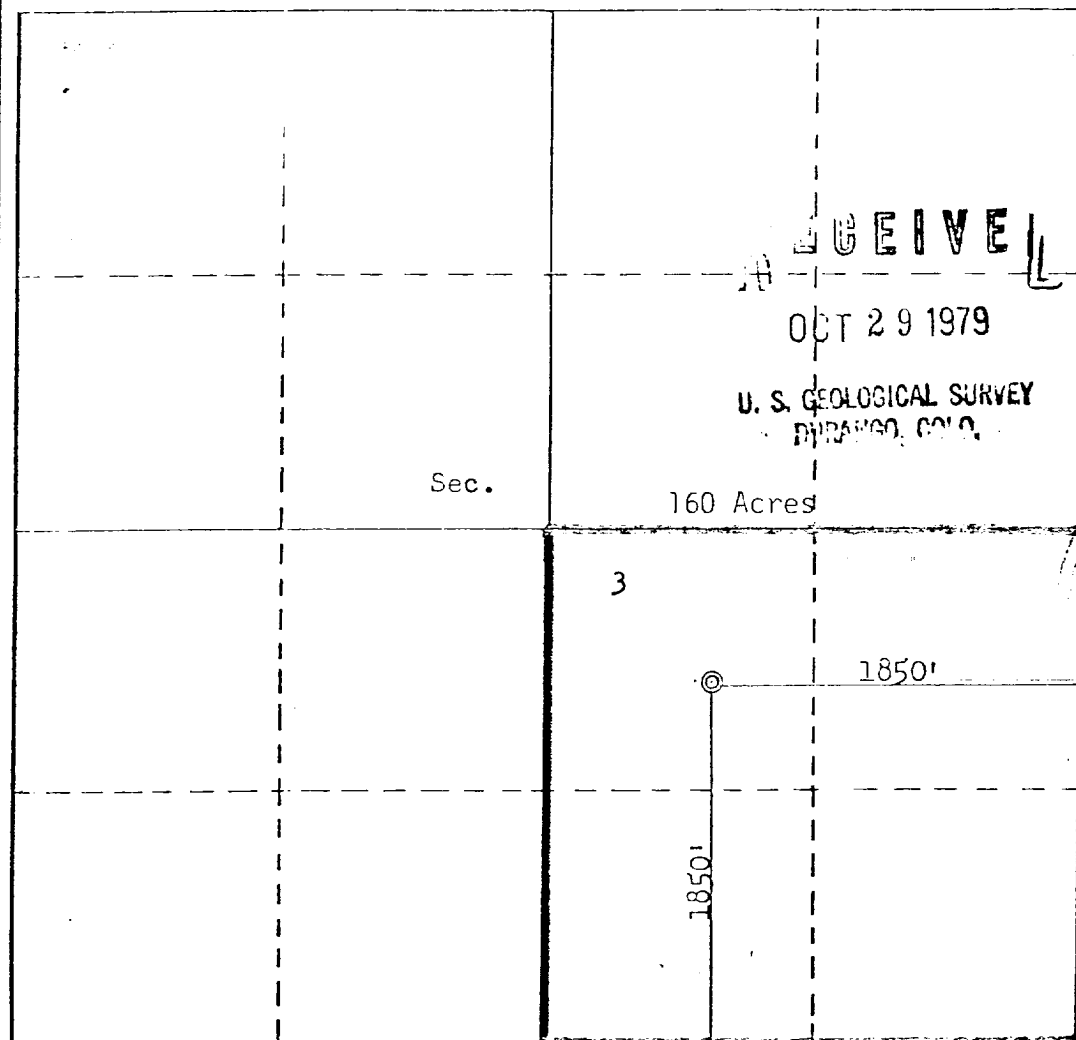

CERTIFICATION

I hereby certify that the information contained herein is true and complete to the best of my knowledge and belief.

DE. Wood / JCS
Name
D. E. Wood
Position
Division Production Mgr.
Company
Cotton Petroleum Corporation
Date
October 22, 1979

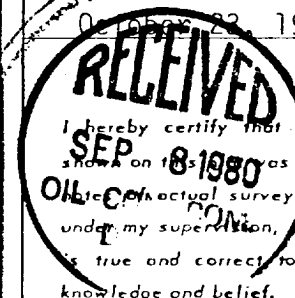

I hereby certify that the well location shown on this plat was plotted from field notes and actual surveys made by me or under my supervision, and that the same is true and correct to the best of my knowledge and belief.

Date Surveyed
October 12, 1979
Registered Professional Engineer and/or Land Surveyor
Fred B. Kerr Jr.
Certificate No. 3950
STATE OF NEW MEXICO

