

UNITED STATES  
DEPARTMENT OF THE INTERIOR  
GEOLOGICAL SURVEY

## SUNDRY NOTICES AND REPORTS ON WELLS

(Do not use this form for proposals to drill or to deepen or plug back to a different reservoir. Use Form 9-331-C for such proposals.)

1. oil ☐ gas ☒ other ☐  
2. NAME OF OPERATOR  
Cotton Petroleum Corporation  
3. ADDRESS OF OPERATOR  
717 17th St., Suite 2200, Denver, Colo. 80202  
4. LOCATION OF WELL (REPORT LOCATION CLEARLY. See space 17 below.)  
AT SURFACE: 1610' FSL, 1750' FSL, Sec. 24  
AT TOP PROD. INTERVAL:  
AT TOTAL DEPTH:  
16. CHECK APPROPRIATE BOX TO INDICATE NATURE OF NOTICE, REPORT, OR OTHER DATA

REQUEST FOR APPROVAL TO: SUBSEQUENT REPORT OF:

TEST WATER SHUT-OFF	<input type="checkbox"/>	<input type="checkbox"/>
FRACTURE TREAT	<input type="checkbox"/>	<input type="checkbox"/>
SHOOT OR ACIDIZE	<input type="checkbox"/>	<input type="checkbox"/>
REPAIR WELL	<input type="checkbox"/>	<input type="checkbox"/>
PULL OR ALTER CASING	<input type="checkbox"/>	<input type="checkbox"/>
MULTIPLE COMPLETE	<input type="checkbox"/>	<input type="checkbox"/>
CHANGE ZONES	<input type="checkbox"/>	<input type="checkbox"/>
ABANDON*	<input type="checkbox"/>	<input type="checkbox"/>
(other) Change location	<input type="checkbox"/>	<input type="checkbox"/>

5. LEASE  
Contract No. 129  
6. IF INDIAN, ALLOTTEE OR TRIBE NAME  
Jicarilla Apache  
7. UNIT AGREEMENT NAME  
8. FARM OR LEASE NAME  
Apache  
9. WELL NO.  
28  
10. FIELD OR WILDCAT NAME  
So. Blanco P.C.  
11. SEC., T., R., M. OR BLK. AND SURVEY OR AREA  
Sec. 24-T24N-R4W N.M.P.M.  
12. COUNTY OR PARISH  
Rio Arriba  
13. STATE  
New Mexico  
14. API NO.  
15. ELEVATIONS (SHOW DF, KDB, AND WD)  
6961' GR

(NOTE: Report results of multiple completion or zone change on Form 9-330.)

17. DESCRIBE PROPOSED OR COMPLETED OPERATIONS (Clearly state all pertinent details, and give pertinent dates, including estimated date of starting any proposed work. If well is directionally drilled, give subsurface locations and measured and true vertical depths for all markers and zones pertinent to this work.)\*

Permission is requested to change the location of the Apache #28 well from 1850' FWL, 1750' FSL, Section 24-T24N-R4W to 1610' FWL, 1750' FSL, Section 24-T24N-R4W.

This new location was approved for archaeological clearance by the Cultural Resource Management Program of New Mexico State University.

Subsurface Safety Valve: Manu. and Type \_\_\_\_\_

18. I hereby certify that the foregoing is true and correct

SIGNED [Signature] TITLE Division Production Mgr. DATE APR 10 1980

(This space for Federal or State office use)

APPROVED BY  
CONDITIONS OF APPROVAL IF ANY:APPROVED  
AS AMENDEDMAR 19 1980  
JAMES F. SIMS  
DISTRICT ENGINEER

TITLE \_\_\_\_\_ DATE \_\_\_\_\_

\*See Instructions on Reverse Side

## OIL CONSERVATION DIVISION

STATE OF NEW MEXICO  
ENERGY AND MINERALS DEPARTMENTP. O. BOX 2088  
SANTA FE, NEW MEXICO 87501Form C-107  
Revised 10-1-78

All distances must be from the outer boundaries of the Section.

Operator <b>COTTON PETROLEUM CORPORATION</b>		Lease <b>APACHE</b>		Well No. <b>28</b>	
Unit Letter <b>K</b>	Section <b>24</b>	Township <b>24N</b>	Range <b>LW</b>	County <b>Rio Arriba</b>	
Actual Footage Location of Well: <b>1750</b> feet from the <b>South</b> line and <b>1610</b> feet from the <b>West</b> line					
Ground Level Elev. <b>6964</b>	Producing Formation <b>PICTURED CLIFFS</b>		Pool <b>So. BLANCO PICTURED CLIFFS</b>		Dedicated Acreage: <b>160</b> Acres

1. Outline the acreage dedicated to the subject well by colored pencil or hachure marks on the plat below.
2. If more than one lease is dedicated to the well, outline each and identify the ownership thereof (both as to working interest and royalty).
3. If more than one lease of different ownership is dedicated to the well, have the interests of all owners been consolidated by communitization, unitization, force-pooling, etc?

☐ Yes ☐ No If answer is "yes," type of consolidation \_\_\_\_\_

If answer is "no," list the owners and tract descriptions which have actually been consolidated. (Use reverse side of this form if necessary.) \_\_\_\_\_

No allowable will be assigned to the well until all interests have been consolidated (by communitization, unitization, forced-pooling, or otherwise) or until a non-standard unit, eliminating such interests, has been approved by the Commission.

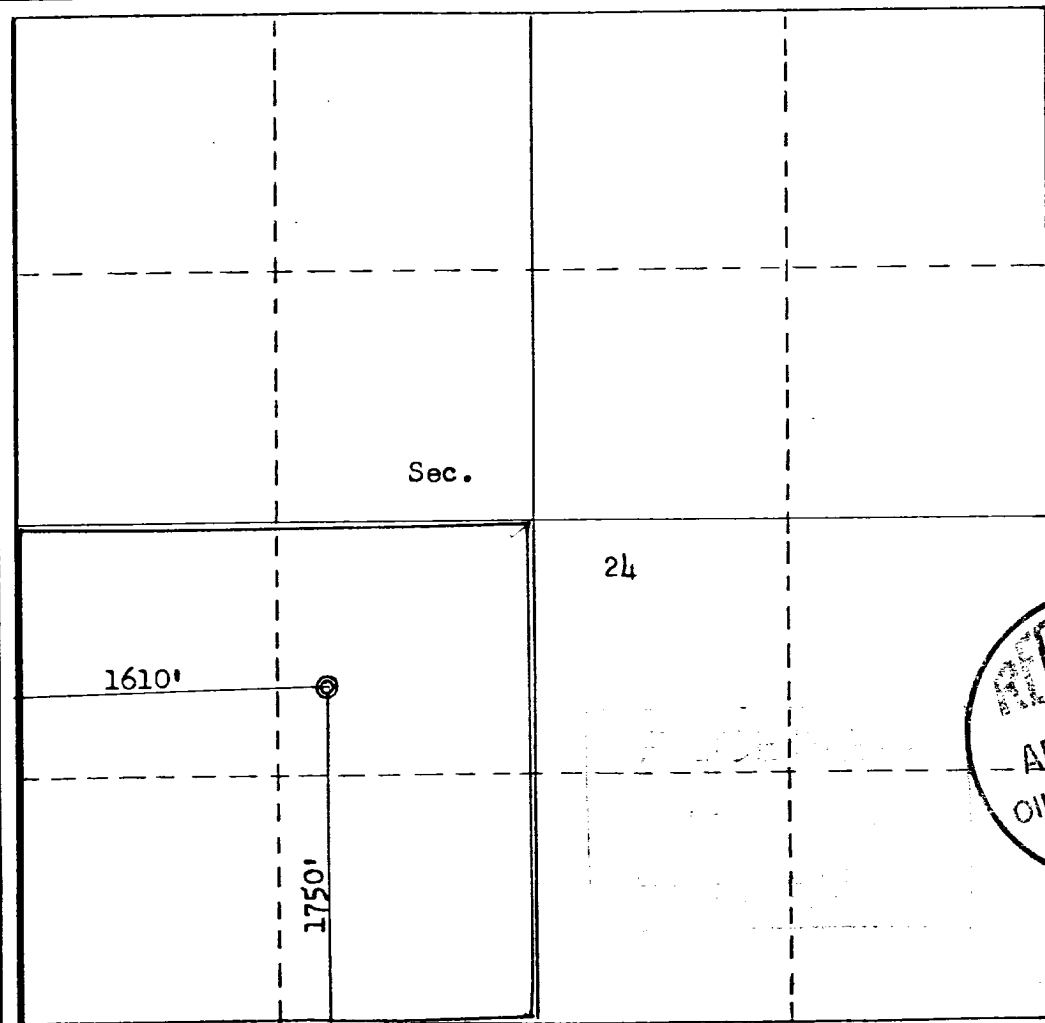

## CERTIFICATION

I hereby certify that the information contained herein is true and complete to the best of my knowledge and belief.

Name

Position

Company

Date

I hereby certify that the well location shown on this plat was plotted from field notes of actual surveys made by me or under my supervision, and that the same is true and correct to the best of my knowledge and belief.

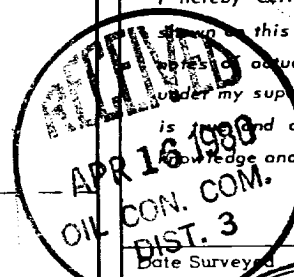

Date Surveyed

November 16, 1979  
Registered Professional Engineer  
and/or Land Surveyor

Fred B. Keen, Jr.

Certificate No.

3950

B. KEEN, JR.