

UNITED STATES  
DEPARTMENT OF THE INTERIOR  
GEOLOGICAL SURVEY

30-039-22257

APPLICATION FOR PERMIT TO DRILL, DEEPEN, OR PLUG BACK

1a. TYPE OF WORK  
DRILL ☒ DEEPEN ☐ PLUG BACK ☐

b. TYPE OF WELL  
OIL WELL ☒ GAS WELL ☒ OTHER ☐ SINGLE ZONE ☐ MULTIPLE ZONE ☒

2. NAME OF OPERATOR ARCO Oil and Gas Company  
Division of Atlantic Richfield Company

3. ADDRESS OF OPERATOR Suite 501  
1860 Lincoln Street, Denver, Colorado 80295

4. LOCATION OF WELL (Report location clearly and in accordance with any State requirements.)  
At surface  
I 2310' F/SL & 900' F/EL Sec. 8 -24N-4W (NE,SE)  
At proposed prod. zone  
Same

14. DISTANCE IN MILES AND DIRECTION FROM NEAREST TOWN OR POST OFFICE\*  
See NTL-6

15. DISTANCE FROM PROPOSED\* LOCATION TO NEAREST PROPERTY OR LEASE LINE, FT. (Also to nearest drlg. unit line, if any)  
900'  
18. DISTANCE FROM PROPOSED LOCATION\* TO NEAREST WELL, DRILLING, COMPLETED, OR APPLIED FOR, ON THIS LEASE, FT.  
1150'  
16. NO. OF ACRES IN LEASE  
2611.20  
19. PROPOSED DEPTH  
7540'

21. ELEVATIONS (Show whether DF, RT, GR, etc.)  
6705' GR (Ungraded)

5. LEASE DESIGNATION AND SERIAL NO.  
Jicarilla Contract # 111

6. INDIAN, ALLOTTEE OR TRIBE NAME  
Jicarilla

7. UNIT AGREEMENT NAME  
-----

8. FARM OR LEASE NAME  
Jicarilla

9. WELL NO.  
115

10. FIELD AND POOL, OR WILDCAT  
W. Lindrith Gallup/Dakota

11. SEC., T., R., M., OR BLK. AND SURVEY OR AREA  
Sec. 8 -24N-4W

12. COUNTY OR PARISH  
Rio Arriba  
13. STATE  
New Mexico

17. NO. OF ACRES ASSIGNED TO THIS WELL  
160

20. ROTARY OR CABLE TOOLS  
Rotary

22. APPROX. DATE WORK WILL START\*  
When approved appl. rec'd  
from District Engineer

23. PROPOSED CASING AND CEMENTING PROGRAM

| SIZE OF HOLE | SIZE OF CASING | WEIGHT PER FOOT | SETTING DEPTH | QUANTITY OF CEMENT     |
|--------------|----------------|-----------------|---------------|------------------------|
| 12-1/2"      | 8-5/8" OD      | 24#             | ±300'         | 300 sx. (cmt. to surf) |
| 7-7/8"       | 5-1/2" OD      | 15.5 & 17#      | T. D.         | 550 sx.                |

Propose to drill well to a depth sufficient to test the Dakota Formation, setting surface casing and if productive setting production casing. If both formations are productive (Gallup and Dakota) will perforate, test and treat if necessary and commingle production.

Pursuant to NTL-6, attached are: Certified Location Plat  
Drilling Plan with attachment  
Surface Use and Operations Plan with attachments.

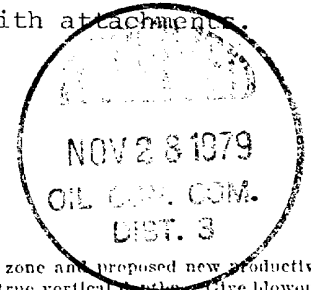

IN ABOVE SPACE DESCRIBE PROPOSED PROGRAM: If proposal is to deepen or plug back, give data on present productive zone and proposed new productive zone. If proposal is to drill or deepen directionally, give pertinent data on subsurface locations and measured and true vertical depths. Give blowout preventer program, if any.

24. SIGNED [Signature] WAW TITLE Operations Manager DATE 11-19-79

(This space for Federal or State office use)

PERMIT NO. \_\_\_\_\_ APPROVAL DATE \_\_\_\_\_

APPROVED BY \_\_\_\_\_ TITLE \_\_\_\_\_ DATE 11-28-1979

CONDITIONS OF APPROVAL, IF ANY:

NEW MEXICO OIL CONSERVATION COMMISSION  
WELL LOCATION AND ACREAGE DEDICATION PLAT

Form C-102  
Supersedes C-128  
Effective 1-1-65

All distances must be from the outer boundaries of the Section.

|   |   |                             |                                      |  |                        |
|---|---|-----------------------------|--------------------------------------|--|------------------------|
| Operator<br><b>ARCO OIL AND GAS COMPANY</b>   |   |                             | Lease<br><b>JICARILLA APACHE "H"</b> |  | Well No.<br><b>115</b> |
| Unit Letter<br><b>I</b>   | Section<br><b>8</b>                           | Township<br><b>24 NORTH</b> | Range<br><b>4 WEST</b>               | County<br><b>RIO ARriba</b>            |                        |
| Actual Footage Location of Well:<br><b>2310</b> feet from the <b>SOUTH</b> line and <b>900</b> feet from the <b>EAST</b> line |   |                             |                                      |  |                        |
| Ground Level Elev.<br><b>6686</b>   | Producing Formation<br><b>Gallup - Dakota</b> |                             | Pool<br><b>W. Lindroth</b>           | Dedicated Acreage:<br><b>160</b> Acres |                        |

1. Outline the acreage dedicated to the subject well by colored pencil or hatchure marks on the plat below.
2. If more than one lease is dedicated to the well, outline each and identify the ownership thereof (both as to working interest and royalty).
3. If more than one lease of different ownership is dedicated to the well, have the interests of all owners been consolidated by communitization, unitization, force-pooling, etc?

☐ Yes ☐ No If answer is "yes," type of consolidation \_\_\_\_\_

If answer is "no," list the owners and tract descriptions which have actually been consolidated. (Use reverse side of this form if necessary.) \_\_\_\_\_

No allowable will be assigned to the well until all interests have been consolidated (by communitization, unitization, forced-pooling, or otherwise) or until a non-standard unit, eliminating such interests, has been approved by the Commission.

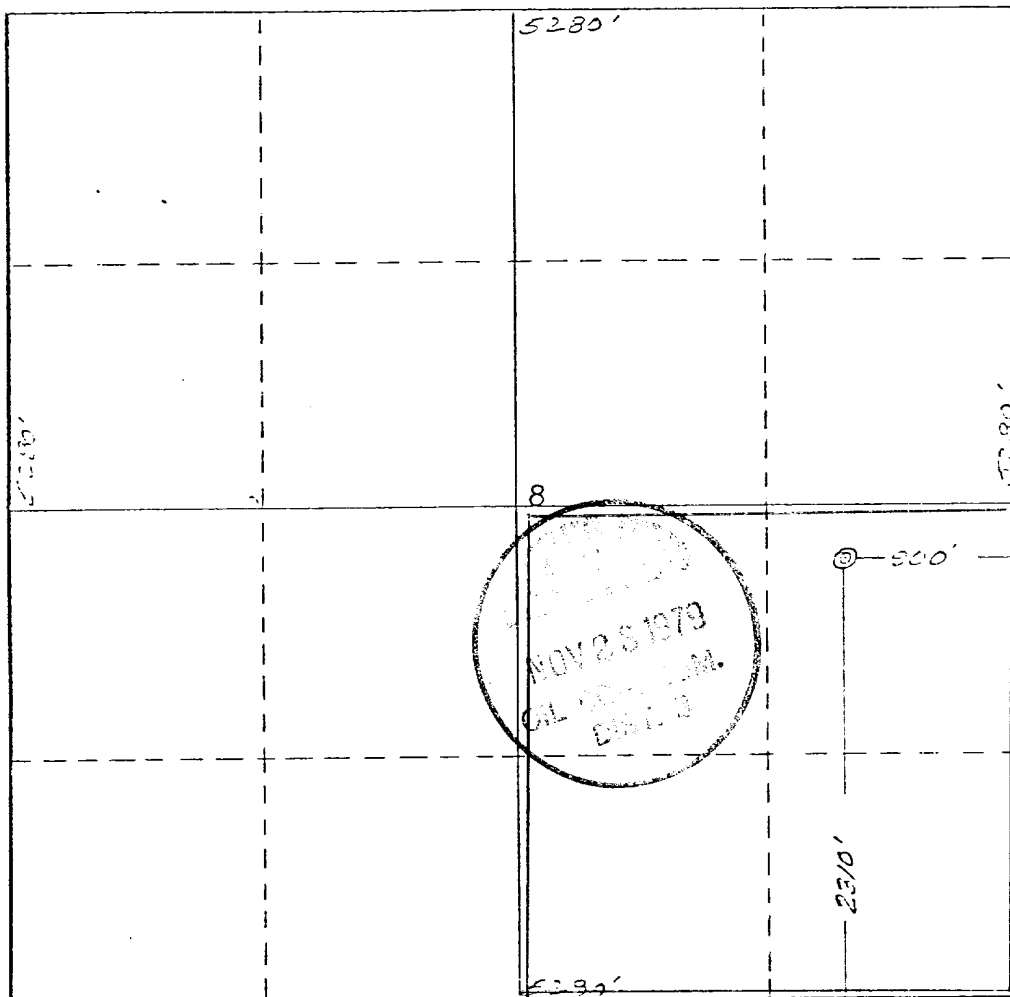

CERTIFICATION

I hereby certify that the information contained herein is true and complete to the best of my knowledge and belief.

*C. E. Satchum for W.A.W.*

Name  
**Operations Manager**  
Position  
**ARCO Oil & Gas Company**  
Company  
**11/13/79**  
Date

I hereby certify that the well location shown on this plat was plotted from field notes of actual surveys made by me or under my supervision and that the same is true and correct to the best of my knowledge and belief.

Date Surveyed  
**5 June 1979**

Registered Professional Engineer  
and Land Surveyor  
*James P. Leese*  
James P. Leese

Certificate No.  
**1463**

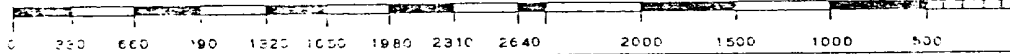

JICARILLA # 115