

UNITED STATES
DEPARTMENT OF THE INTERIOR
GEOLOGICAL SURVEY

30-039-22279

APPLICATION FOR PERMIT TO DRILL, DEEPEN, OR PLUG BACK

1A. TYPE OF WORK
DRILL ☒ DEEPEN ☐ PLUG BACK ☐

B. TYPE OF WELL
OIL WELL ☒ GAS WELL ☐ OTHER ☐
SINGLE ZONE ☒ MULTIPLE ZONE ☐

2. NAME OF OPERATOR
Mobil Oil Corporation

3. ADDRESS OF OPERATOR
Nine Greenway Plaza, Suite 2700; Houston, Texas 77046

4. LOCATION OF WELL (Report location clearly and in accordance with any State requirements.)
At surface

1840' FNL and 1840' FEL, Sec. 34, T24N, R3W
At proposed prod. zone

Same as surface

14. DISTANCE IN MILES AND DIRECTION FROM NEAREST TOWN OR POST OFFICE*
50 miles Southeast of Farmington

10. DISTANCE FROM PROPOSED* LOCATION TO NEAREST PROPERTY OR LEASE LINE, FT.
(Also to nearest drlg. unit line, if any)
800' to lease line

18. DISTANCE FROM PROPOSED LOCATION* TO NEAREST WELL, DRILLING, COMPLETED, OR APPLIED FOR, ON THIS LEASE, FT.
8500' ± NW to proposed well #2

21. ELEVATIONS (Show whether DF, RT, GR, etc.)
7037' - Ground

23. PROPOSED CASING AND CEMENTING PROGRAM

SIZE OF HOLE	SIZE OF CASING	WEIGHT PER FOOT	SETTING DEPTH	QUANTITY OF CEMENT
17-1/2"	13-3/8"	48# H-40	0-300'	1. Circulate to Surface
12-1/2"	8-5/8"	24# K-55	0-2500'	2. Circulate to Surface
	8-5/8"	32# H-40	2500-3900'	
7-7/8"	5-1/2"	15.5# K-55	0-7500'	3. Circulate to Surface
	5-1/2"	17# K-55	7500-8200'	

Cementing Program

- 1) Class A with 2% CaCl₂
3) Class H

(2) Class A with 6% gel tailed in with Neat cement

Mud Program

Depth	Type of Mud	Weight	Viscosity	pH	Water Loss
0-300'	Spud Mud	10.0#	---	---	---
300-8100'	Fresh Water Gel	9.0#	40	---	---

Blowout Preventer Program

See Attachment

IN ABOVE SPACE DESCRIBE PROPOSED PROGRAM: If proposal is to deepen or plug back, give data on present productive zone and proposed new productive zone. If proposal is to drill or deepen directionally, give pertinent data on subsurface locations and measured and true vertical depths. Give blowout preventer program, if any.

24. SIGNED A. D. Bond TITLE Regulatory Engineering DATE 12/11/79

(This space for Federal or State office use)

Coordinator II

PERMIT NO. _____ APPROVAL DATE _____

APPROVED BY _____ TITLE _____ DATE DEC 17 1979

CONDITIONS OF APPROVAL, IF ANY:

ok 3/28

GEOLOGICAL SURVEY

**NEW MEXICO OIL CONSERVATION COMMISSION
WELL LOCATION AND ACREAGE DEDICATION PLAT**

Form C-102
Supersedes C-128
Effective 1-1-65

All distances must be from the outer boundaries of the Section.

Operator Mobil Oil Corporation			Lease Lindrith B Unit		Well No. 4
Unit Letter G	Section 34	Township T24N	Range R3W	County Rio Arriba	
Actual Footage Location of Well: <div style="display: flex; justify-content: space-between;"> 1840 feet from the North line and 1840 feet from the East line </div>					
Ground Level Elev. 7037'	Producing Formation Dakota	Pool Chacon-Dakota Associated et al		Dedicated Acreage: 160 Acres	

1. Outline the acreage dedicated to the subject well by colored pencil or hachure marks on the plat below.
2. If more than one lease is dedicated to the well, outline each and identify the ownership thereof (both as to working interest and royalty).
3. If more than one lease of different ownership is dedicated to the well, have the interests of all owners been consolidated by communitization, unitization, force-pooling, etc?

☒ Yes ☐ No If answer is "yes," type of consolidation Unitization

If answer is "no," list the owners and tract descriptions which have actually been consolidated. (Use reverse side of this form if necessary.) _____

No allowable will be assigned to the well until all interests have been consolidated (by communitization, unitization, forced-pooling, or otherwise) or until a non-standard unit, eliminating such interests, has been approved by the Commission.

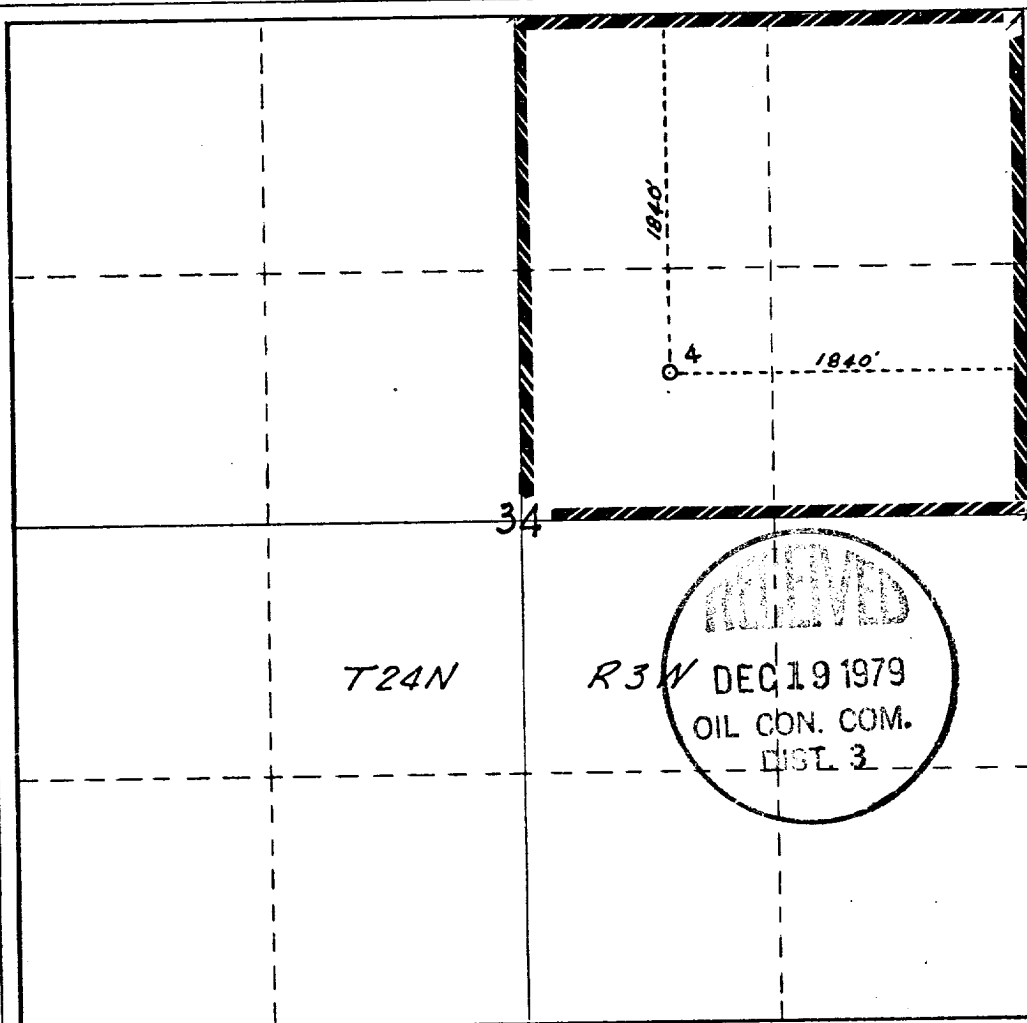

CERTIFICATION

I hereby certify that the information contained herein is true and complete to the best of my knowledge and belief.

A. D. Bond
 Name
A. D. Bond
 Position **Regulatory Engineering Coordinator II**
 Company
Mobil Oil Corporation
 Date
December 11, 1979

H. A. Carson, Jr.
 I hereby certify that the well location shown on this plat was plotted from field notes of actual surveys made by me or under my supervision, and that the same is true and correct to the best of my knowledge and belief.

H. A. Carson, Jr.
 Date Surveyed
November 14, 1979
 Registered Professional Engineer and/or Land Surveyor

H. A. Carson, Jr.
 Certificate No.
5063

0 330 660 990 1320 1650 1980 2310 2640 2000 1500 1000 500 0

