

**JICARILLA APACHE TRIBE
ENVIRONMENTAL PROTECTION OFFICE
P.O. BOX 507
DULCE, NEW MEXICO 87528**

SUBMIT 1 COPY TO
NATURAL RESOURCE DEPT
AND OIL & GAS ADMINISTRATION

OK

PIT REMEDIATION AND CLOSURE REPORT

Operator: DUGAN PRODUCTION CORP. Telephone: 505-325-1821
Address: P.O. Box 420, FARMINGTON, NM
Facility or Well Name: A NEW DAWN #3
Location: Unit or Qtr/Qtr Sec D Sec 23 T 24N R 5W County RIO ARriba
Pit Type: Separator ☒ Dehydrator ☐ Other ☐
Land Type: RANGE

Pit Location: Pit dimensions: length 15, width 24, depth 11
(Attach diagram) Reference: wellhead ☒, other ☐
Footage from reference: 20
Direction from reference: 30 Degrees ☒ East of North ☒
West South

Depth To Groundwater:

(Vertical distance from
contaminants to seasonal
high water elevation of
groundwater)

Less than 50 feet	(20 points)	
50 feet to 99 feet	(10 points)	
Greater than 100 feet	(0 points)	<u>0</u>

Distance to an Ephemeral Stream

(Downgradient dry wash greater than
ten feet in width)

Less than 100 feet	(10 points)	
Greater than 100 feet	(0 points)	<u>0</u>

Distance to Nearest Lake, Playa, or Watering Pond

(Downgradient lakes, playas and
livestock or wildlife watering ponds)

Less than 100 feet	(10 points)	
Greater than 100 feet	(0 points)	<u>0</u>

Wellhead Protection Area:

(Less than 200 feet from a private
domestic water source, or: less than
1000 feet from all other water sources)

Yes	(20 points)	
No	(0 points)	<u>0</u>

Distance To Surface Water:

(Horizontal distance to perennial
lakes, ponds, rivers, streams, creeks,
irrigation canals and ditches)

Less than 100 feet	(20 points)	
100 feet to 1000 feet	(10 points)	
Greater than 1000 feet	(0 points)	<u>0</u>

RANKING SCORE (TOTAL POINTS): 0

Date Remediation Started: 9-23-98 Date Completed: 9-23-98

Remediation Method: Excavation ☒ Approx. cubic yards 150
Check all appropriate (actions) Landfarmed ☒ Insitu Bioremediation _____
Other _____

Remediation Location: Onsite ☒ Offsite _____
(i.e. landfarmed onsite, name and location of offsite facility)

General Description of Remedial Action: Excavation

Groundwater Encountered: No ☒ Yes _____ Depth _____

Final Pit: Sample location see Attached Documents
Closure Sampling: _____
(if multiple samples, attach sample results and diagram of sample locations and depths)
Sample depth 10'
Sample date 9-23-98 Sample time 1120
Sample Results

Soil: Benzene	(ppm)	<u>-</u>	Water: Benzene	(ppb)	_____
Total BTEX	(ppm)	<u>-</u>	Toluene	(ppb)	_____
Field Headspace	(ppm)	<u>88</u>	Ethylbenzene	(ppb)	_____
TPH	(ppm)	<u>1.0</u>	Total Xylenes	(ppb)	_____

Groundwater Sample: Yes _____ No ☒ (If yes, attach sample results)

I HEREBY CERTIFY THAT THE INFORMATION ABOVE IS TRUE AND COMPLETE TO THE BEST OF MY KNOWLEDGE AND BELIEF

DATE 10-26-98 PRINTED NAME JEFFREY C. BLAGE
SIGNATURE Jeffrey C. Blage AND TITLE NMPE 11607

AFTER REVIEW OF THE PIT CLOSURE INFORMATION, PIT CLOSURE IS APPROVED IN ACCORDANCE TO THE JICARILLA APACHE TRIBE PIT CLOSURE ORDINANCE.

APPROVED: YES ☒ NO _____ (REASON) _____

SIGNED: Ken C. McCall DATE: 10-27-98

ENVIROTECH LABS

PRACTICAL SOLUTIONS FOR A BETTER TOMORROW

EPA METHOD 8015 Modified Nonhalogenated Volatile Organics Total Petroleum Hydrocarbons

Client: Blagg / Dugan
Sample ID: Separator C @ 10'
Laboratory Number: D957
Chain of Custody No: 6275
Sample Matrix: Soil
Preservative: Cool
Condition: Cool and Intact

Project #: 04034-10
Date Reported: 09-24-98
Date Sampled: 09-23-98
Date Received: 09-24-98
Date Extracted: 09-24-98
Date Analyzed: 09-24-98
Analysis Requested: 8015 TPH

Parameter	concentration (mg/Kg)	Det. Limit (mg/Kg)
Gasoline Range (C5 - C10)	ND	0.2
Diesel Range (C10 - C28)	1.0	0.1
Total Petroleum Hydrocarbons	1.0	0.2

ND - Parameter not detected at the stated detection limit.

References: Method 8015B, Nonhalogenated Volatile Organics, Test Methods for Evaluating Solid Waste, SW-846, USEPA, December 1996.

Comments: A New Dawn #3.

Analyst

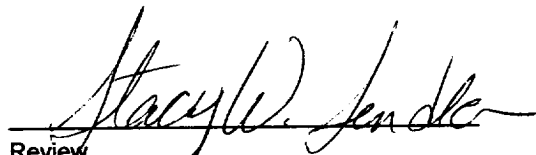
Review

CHAIN OF CUSTODY RECORD

6275

Client / Project Name		Project Location		ANALYSIS / PARAMETERS																							
BLAGG / DUGAN		A NEW DAWN #3																									
Sampler: J.C. Blagg		Client No. 0403410																									
Sample No./ Identification	Sample Date	Sample Time	Lab Number	Sample Matrix	No. of Containers	TPH	Boils							Remarks													
SEPARATOR C @ 10'	9-23-98	1120	D957	SOIL	1	X																					
TANK DRAW C @ 3'	"	1430	D958	"	1	X																					
Relinquished by: (Signature)		Date		Time		Received by: (Signature)		Date		Time																	
J.C. Blagg		9-24-98		0727		[Signature]		9-24-98		0727																	
Relinquished by: (Signature)						Received by: (Signature)																					
Relinquished by: (Signature)						Received by: (Signature)																					
<div> <div>ENVIROTECH INC.</div> <div> 5796 U.S. Highway 64 Farmington, New Mexico 87401 (505) 632-0615 </div> </div>														Sample Receipt <table border="1"> <tr> <td>Y</td> <td>N</td> <td>N/A</td> </tr> <tr> <td></td> <td></td> <td></td> </tr> <tr> <td colspan="3">Received Intact</td> </tr> <tr> <td colspan="3">Cool - Ice/Blue Ice</td> </tr> </table>		Y	N	N/A				Received Intact			Cool - Ice/Blue Ice		
Y	N	N/A																									
Received Intact																											
Cool - Ice/Blue Ice																											

RECEIVED
OCT 15 1999
OIL CON. DIV.
DIST. 3

JICARILLA APACHE TRIBE
ENVIRONMENTAL PROTECTION OFFICE
P.O. BOX 507
DULCE, NEW MEXICO 87528

COO# 7089
SUBMIT 1 COPY TO
NATURAL RESOURCE DEPT
AND OIL & GAS ADMINISTRATION

ON-SITE SOIL REMEDIATION REPORT

Operator: DUGAN PROD CORP. Telephone: 325.1821

Address: 709 E MURRAY DR. FARMINGTON NM. 87401

Facility or Well Name: A NEW DAWN #3

Location: Unit or Qtr/Qtr Sec D Sec 23 T 24N R 5W County BLAQUIRA

Land Type: RANGE

Date Remediation Started: 9.23.98 Date Completed: 7.15.99

Remediation Method: Landfarmed ☒ Approx. cubic yards 150

Composted ☐

Other ☐

Depth To Groundwater: (pts.) 0

Distance to an Ephemeral Stream (pts.) 0

Distance to Nearest Lake, Playa, or Watering Pond (pts.) 0

Wellhead Protection Area: (pts.) 0

Distance To Surface Water: (pts.) 0

RANKING SCORE (TOTAL POINTS): 0

Final Closure Sampling:

Sampling Date: 7.13.99 Time: 1135

Sample Results:

Field Headspace (ppm) 12.6

TPH (ppm) 208 Method TPH (8015)

Other ☐

I HEREBY CERTIFY THAT THE INFORMATION ABOVE IS TRUE AND COMPLETE TO THE BEST OF MY KNOWLEDGE AND BELIEF

DATE 9-24-99 PRINTED NAME JEFFREY C. BLAGG

SIGNATURE Jeffrey C. Blagg AND TITLE NMPE 11607

AFTER REVIEW OF THE SOIL REMEDIATION INFORMATION, ON-SITE REMEDIATION IS APPROVED IN ACCORDANCE TO THE JICARILLA APACHE TRIBE PIT CLOSURE ORDINANCE.

APPROVED: YES ☒ NO ☐ (REASON) ☐

SIGNED: K. C. Mamm DATE: 9-27-99

CLIENT: <u>DUGAN</u>	BLAGG ENGINEERING, INC. P.O. BOX 87, BLOOMFIELD, NM 87413 (505) 632-1199	LOCATION NO: _____ C.O.C. NO: <u>7089</u>
----------------------	---	--

FIELD REPORT: LANDFARM/COMPOST PILE CLOSURE VERIFICATION

LOCATION: NAME: <u>ANEN DAWN</u>	WELL #: <u>3</u>	PITS: <u>SEP</u>	DATE STARTED: <u>7.13.99</u>
QUAD/UNIT: <u>D</u> SEC: <u>23</u> TWP: <u>24N</u> RNG: <u>5W</u> PM: <u>NM</u> CNTY: <u>RA</u> ST: <u>NM</u>	DATE FINISHED: <u>7.15.99</u>		
QTR/FOOTAGE: <u>800N-800W</u>	CONTRACTOR: <u>FOUR</u>		
			ENVIRONMENTAL SPECIALIST: <u>REP</u>

SOIL REMEDIATION:

 REMEDIATION SYSTEM: LANDFARM

 APPROX. CUBIC YARDAGE: 150

 LAND USE: RANGE

 LIFT DEPTH (ft): 1'

FIELD NOTES & REMARKS:

 DEPTH TO GROUNDWATER: >100' NEAREST WATER SOURCE: >1000' NEAREST SURFACE WATER: >1000'

 NMDCD RANKING SCORE: 0 NMDCD TPH CLOSURE STD: 5000 PPM

LT. YELLOWISH BROWN-ORANGE SAND. NDN COHESIVE, SLIGHTLY MOIST, FIRM.
 NO APPARENT STAINING OBSERVED. NO HC ODOR DETECTED. SAMPLING DEPTHS
 RANGE FROM 6"-10" COLLECTED A 5PT. COMPOSITE SAMPLE FOR LAB ANALYSIS.

FIELD 418.1 CALCULATIONS

SAMP. TIME	SAMPLE I.D.	LAB No:	WEIGHT (g)	mL. FREON	DILUTION	READING	CALC. ppm

SKETCH/SAMPLE LOCATIONS

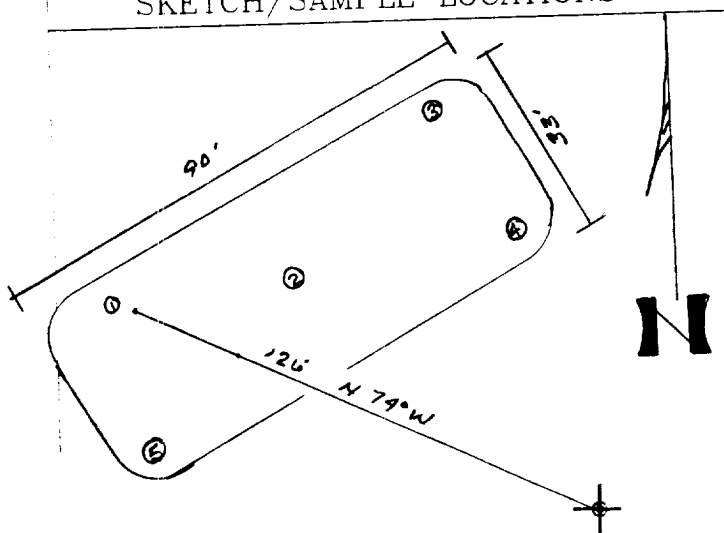

OVM RESULTS

LAB SAMPLES

SAMPLE ID	FIELD HEADSPACE PID (ppm)	SAMPLE ID	ANALYSIS	TIME	RESULTS
LF-1	12.6	LF-1	TPH (8015)	1135	208

SCALE

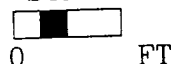

TRAVEL NOTES:

 CALLOUT: NA

 ONSITE: 7.13.99

EPA METHOD 8015 Modified
Nonhalogenated Volatile Organics
Total Petroleum Hydrocarbons

Client:	Blagg / Dugan	Project #:	403410
Sample ID:	LF - 1	Date Reported:	07-15-99
Laboratory Number:	F668	Date Sampled:	07-13-99
Chain of Custody No:	7089	Date Received:	07-14-99
Sample Matrix:	Soil	Date Extracted:	07-14-99
Preservative:	Cool	Date Analyzed:	07-14-99
Condition:	Cool and Intact	Analysis Requested:	8015 TPH

Parameter	Concentration (mg/Kg)	Det. Limit (mg/Kg)
Gasoline Range (C5 - C10)	0.9	0.2
Diesel Range (C10 - C28)	207	0.1
Total Petroleum Hydrocarbons	208	0.2

ND - Parameter not detected at the stated detection limit.

References: Method 8015B, Nonhalogenated Volatile Organics, Test Methods for Evaluating Solid Waste,
SW-846, USEPA, December 1996.

Comments: **A New Dawn 3 5 Pt. Composite.**

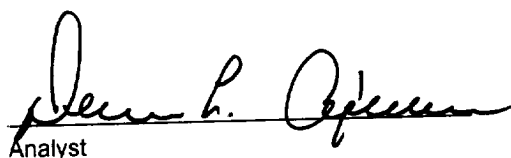
Analyst

Review

7089

[illegible]