

District III

1000 Rio Bos Rd

Aztec, NM 87410

Energy, Minerals and Natural Resources Department

DEPUTY OIL & GAS INSPECTOR

FEB 08 1999

State of New Mexico

OIL CONSERVATION DIVISION

2040 S. PACHECO

Santa Fe, New Mexico 87505

Submit 1 copy to
Appropriate District
and 1 copy to
Santa Fe Office

PIT REMEDIATION AND CLOSURE REPORT

RECEIVED
DEC - 9 1998

Operator: <u>Apache Corporation \ MW Petroleum</u>		Telephone: <u>505-325-0318</u>																									
Address: <u>2855 Southside River Road, Suite A, Farmington, NM 87401</u>																											
Facility or Well Name: <u>Jic Apache Tribal 124 #5</u>																											
Location: Unit or Qtr/Qtr Sec	<u>SE/NE</u>	<u>Sec 23</u>	<u>T 25 N</u>																								
	<u>R 4W</u>	County	<u>Rio Arriba</u>																								
Pit Type: Separator: _____	Dehydrator: _____	Other: <u>Blow Pit</u>																									
Land Type: <u>Jicarilla Tribal</u>																											
<table border="0"> <tr> <td>Beginning Pit Dimensions:</td> <td>Length <u>25'</u></td> <td>Width <u>20'</u></td> <td>Depth <u>5'</u></td> </tr> <tr> <td>Ending Pit Dimensions:</td> <td>Length <u>30'</u></td> <td>Width <u>25'</u></td> <td>Depth <u>9'</u></td> </tr> <tr> <td>Reference:</td> <td>Wellhead <u>XXX</u></td> <td>Other _____</td> <td></td> </tr> <tr> <td>Footage from reference:</td> <td><u>130'</u></td> <td></td> <td></td> </tr> <tr> <td>Direction from reference:</td> <td><u>174</u> Degrees</td> <td><u>X</u> East</td> <td>North _____</td> </tr> <tr> <td></td> <td></td> <td>West _____</td> <td>South <u>XX</u></td> </tr> </table>				Beginning Pit Dimensions:	Length <u>25'</u>	Width <u>20'</u>	Depth <u>5'</u>	Ending Pit Dimensions:	Length <u>30'</u>	Width <u>25'</u>	Depth <u>9'</u>	Reference:	Wellhead <u>XXX</u>	Other _____		Footage from reference:	<u>130'</u>			Direction from reference:	<u>174</u> Degrees	<u>X</u> East	North _____			West _____	South <u>XX</u>
Beginning Pit Dimensions:	Length <u>25'</u>	Width <u>20'</u>	Depth <u>5'</u>																								
Ending Pit Dimensions:	Length <u>30'</u>	Width <u>25'</u>	Depth <u>9'</u>																								
Reference:	Wellhead <u>XXX</u>	Other _____																									
Footage from reference:	<u>130'</u>																										
Direction from reference:	<u>174</u> Degrees	<u>X</u> East	North _____																								
		West _____	South <u>XX</u>																								
Depth To Groundwater: (vertical distance from contaminants to seasonal high water elevation of groundwater)		Less than 50 feet (20 points) _____ 50 feet to 99 feet (10 points) _____ Greater than 100 feet (0 points) <u>0</u>																									
Wellhead Protection Area: (Less than 200 feet from a private domestic water source, or; less than 1000 feet from all other water sources)		Yes (20 points) _____ No (0 points) <u>0</u>																									
Distance To Surface Water: (Horizontal distance to perennial lakes, ponds, rivers, streams, creeks, irrigation canals and ditches)		Less than 200 feet (20 points) _____ 200 feet to 1000 feet (10 points) _____ Greater than 1000 feet (0 points) <u>0</u>																									
		RANKING SCORE (TOTAL POINTS) <u>0</u>																									

Date Remediation Started:	<u>6/27/97</u>	Date Completed:	<u>6/30/97</u>
Remediation Method: (Check all appropriate sections)	Excavation	<u>XXX</u>	Approx. cubic yards
	Landfarmed	<u>XX</u>	Insitu Bioremediation
	Other		
Remediation Location: (i.e. landfarmed onsite, name and location of offsite facility)	Onsite	<u>XX</u>	Offsite
General Description of Remedial Action:			
<u>Excavate pit to 9' , took PID readings. Spread soil on</u>			
<u>location for remediation. Took soil samples.</u>			
Groundwater Encountered:	No	<u>XX</u>	Yes _____ Depth _____

Final Pit:	Sample location	<u>4 point composite sample taken from pit sidewalls. Grab sample</u>	
Closure Sampling: (in multiple samples, attach sample results and diagram of sample locations and depths)		<u>taken from pit bottom center.</u>	
	Sample depth	<u>9'</u>	<u>8 to 10" into pit sidewalls 10" into pit bottom</u>
	Sample Date	<u>6/30/97</u>	Sample Time <u>12:20 PM</u>
	Sample results		
	Benzene	(ppm)	<u>ND</u>
	Total BTEX	(ppm)	<u>ND</u>
	Field Headspace	(ppm)	<u>12.98</u>
	TPH		<u>Side/ND</u> <u>Btm/ND</u>
Groundwater Sample:	Yes _____	No	<u>XX</u> (If yes attach sample results)

I HEREBY CERTIFY THAT THE INFORMATION ABOVE IS TRUE AND COMPLETE TO THE BEST OF MY KNOWLEDGE AND BELIEF.

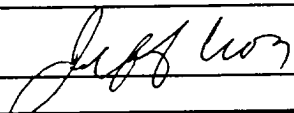
DATE <u>December 1, 1998</u>	PRINTED NAME <u>Jeff Cross</u>
SIGNATURE <u></u>	AND TITLE <u>Project Manager</u>

JICARILLA APACHE TRIBE
ENVIRONMENTAL PROTECTION OFFICE
P. O. BOX 507
DULCE, NEW MEXICO 87528

Submit 1 copy to
Natural Resource Dept.
and Oil & Gas Administration

PIT REMEDIATION AND CLOSURE REPORT

Operator: <u>MW PETROLEUM</u>		Telephone <u>505-325-0318</u>																										
Address: <u>2855 Southside River Road, Suite A, Farmington, NM 87401</u>																												
Facility or Well Name: <u>JAT 124 # 5</u>																												
Location:	Unit or Qtr/Qtr Sec	<u>SENE SEC 23 T 25 N R 4 W</u>	County <u>Rio Arriba</u>																									
Pit Type:	Separator: _____	Dehydrator: _____	Other <u>BLOW PIT</u>																									
Land Type: <u>Jicarilla Tribal</u>																												
<table style="width: 100%;"> <tr> <td>Pit Location: (Attach diagram)</td> <td>Pit Dimensions:</td> <td>Length <u>30'</u></td> <td>Width <u>25'</u></td> <td>Depth <u>9'</u></td> </tr> <tr> <td></td> <td>Reference:</td> <td>Wellhead <u>XX</u></td> <td>Other _____</td> <td></td> </tr> <tr> <td></td> <td>Footage from reference:</td> <td colspan="3"><u>130'</u></td> </tr> <tr> <td></td> <td>Direction from reference:</td> <td><u>174</u> Degrees</td> <td><u>X</u> East</td> <td>North _____</td> </tr> <tr> <td></td> <td></td> <td></td> <td>West</td> <td>South <u>XX</u></td> </tr> </table>				Pit Location: (Attach diagram)	Pit Dimensions:	Length <u>30'</u>	Width <u>25'</u>	Depth <u>9'</u>		Reference:	Wellhead <u>XX</u>	Other _____			Footage from reference:	<u>130'</u>				Direction from reference:	<u>174</u> Degrees	<u>X</u> East	North _____				West	South <u>XX</u>
Pit Location: (Attach diagram)	Pit Dimensions:	Length <u>30'</u>	Width <u>25'</u>	Depth <u>9'</u>																								
	Reference:	Wellhead <u>XX</u>	Other _____																									
	Footage from reference:	<u>130'</u>																										
	Direction from reference:	<u>174</u> Degrees	<u>X</u> East	North _____																								
			West	South <u>XX</u>																								
Depth To Groundwater: (vertical distance from contaminants to seasonal high water elevation of groundwater)		Less than 50 feet	(20 points) _____																									
		50 feet to 99 feet	(10 points) _____																									
		Greater than 100 feet	(0 points) <u>0</u>																									
Distance to an Ephemeral Stream: (Downgradient dry wash greater than ten feet in width)		Less than 100 feet	(10 points) _____																									
		Greater than 100 feet	(0 points) <u>0</u>																									
Distance to Nearest Lake, Playa, or Watering Pond: (Downgradient lakes, playas and livestock or wildlife watering ponds)		Less than 100 feet	(10 points) _____																									
		Greater than 100 feet	(0 points) <u>0</u>																									
Wellhead Protection Area: (Less than 200 feet from a private domestic water source, or less than 1000 feet from all other water sources)		Yes	(20 points) _____																									
		No	(0 points) <u>0</u>																									
Distance To Surface Water: (Horizontal distance to perennial lakes, ponds, rivers, streams, creeks, irrigation canals and ditches)		Less than 100 feet	(20 points) _____																									
		100 feet to 1000 feet	(10 points) _____																									
		Greater than 1000 feet	(0 points) <u>0</u>																									
		RANKING SCORE (TOTAL POINTS)	<u>0</u>																									

Date Remediation Started: 6/27/97 Date Completed: 6/30/97

Remediation Method: (Check all appropriate sections)
Excavation XXX Approx. cubic yards 111
Landfarmed XX Insitu Bioremediation _____
Other _____

Remediation Location: (i.e. landfarmed onsite, name and location of offsite facility)
Onsite XX Offsite _____

General Description of Remedial Action: EXCAVATE PIT TO 9', TOOK PID READINGS.
SPREAD SOIL ON LOCATION FOR REMEDIATION. TOOK SOIL SAMPLES.

Groundwater Encountered: No X Yes _____ Depth _____

Final Pit: Sample location 4 point composite taken from pit sidewalls
Closure Sampling: (in multiple samples, attach sample results and diagram of sample locations and depths) 1 point grab sample taken from pit bottom center.
Sample depth 9'
Sample Date 6/30/97 Sample Time 12:20PM
Sample results

Soil:	Benzene	(ppm)	<u>ND</u>	Water:	Benzene	(ppb)	<u>NA</u>
	Total BTEX	(ppm)	<u>ND</u>		Toluene	(ppb)	<u>NA</u>
	Field Headspace	(ppm)	<u>12.98</u>		Ethylbenzene	(ppb)	<u>NA</u>
	TPH	(ppm)	<u>ND\SIDE</u> <u>ND\BTM</u>		Total Xylenes	(ppb)	<u>NA</u>

Groundwater Sample: Yes _____ No X (If yes attach sample results)

I HEREBY CERTIFY THAT THE INFORMATION ABOVE IS TRUE AND COMPLETE TO THE BEST OF MY KNOWLEDGE AND BELIEF.

DATE 9/14/98 PRINTED NAME JEFF CROSS

SIGNATURE Jeff Cross AND TITLE Project Manager

AFTER REVIEW OF THE PIT CLOSURE INFORMATION, PIT CLOSURE IS APPROVED IN ACCORDANCE TO THE JICARILLA APACHE TRIBE PIT CLOSURE ORDINANCE.

APPROVED: YES X NO _____ (REASON) _____

SIGNED: Kent M... DATE: 11-13-98

APACHE CORPORATION/FARMINGTON DISTRICT PIT EXCAVATION AND CLOSURE REPORT

LOCATION JAT 124 # 5

PIT COUNT 1

Jicarilla Apache Tribal EPO/OCD/BLM
Review and Approval
OCD-BLM
EPO Representative _____
Date of Review _____

START				FINISH			
6/27/97				6/30/97			
DIMENSIONS							
	L	W	D		L	W	D
Pit 1	25'	20'	5'	Pit 1	30'	25'	9'
Pit 2				Pit 2			
Pit 3				Pit 3			
DATE:	6/30/97	Pit 1 @ 9'	Pit 2 @	Pit 3 @	Date:	6/30/97	Pit 1 @ 9'
	Center	20.1				Center	20.1
P	NW Corner	15.2			P	NW Corner	15.2
I	NE Corner	3.4			I	NE Corner	3.4
D	SW Corner	18.7			D	SW Corner	18.7
	SE Corner	7.5				SE Corner	7.5

NOTES:

6/27/97 START EXCAVATION ON PIT , LIGHT STAINING AND ODOR AT 9'

6/28/97,6/29/97 SHUT DOWN FOR WEEKEND.

6/30/97 EXCAVATE PIT SIDE WALLS ,NO STAINING OR ODOR,PID READINGS GOOD.

DATE		SOIL SAMPLING						PER LAB	
		Pit 1 @ 9'	Pit 2 @	Pit 3 @	ANALYSIS RESULTS			Assaigai	
					PIT	TPH	BETEX	WITNESS	DATE
P	Center	20.1			NO	SIDE\BTM	SIDE\BTM		
I	NW Corner	15.2			1	ND\ND	ND\ND	J.C.	6/30/97
D	NE Corner	3.4			2				
	SW Corner	18.7			3				
	SE Corner	7.5							

RE-SAMPLE

DATE:		Pit 1 @	Pit 2 @	Pit 3 @	ANALYSIS RESULTS			PER LAB	
					PIT	TPH	BETEX	WITNESS	DATE
P	Center				NO	SIDE\BTM	SIDE\BTM		
I	NW Corner				1				
D	NE Corner				2				
	SW Corner				3				
	SE Corner								

RE-SAMPLE

DATE:		Pit 1 @	Pit 2 @	Pit 3 @	ANALYSIS RESULTS			PER LAB	
					PIT	TPH	BETEX	WITNESS	DATE
P	Center				NO	SIDE\BTM	SIDE\BTM		
I	NW Corner				1				
D	NE Corner				2				
	SW Corner				3				
	SE Corner								

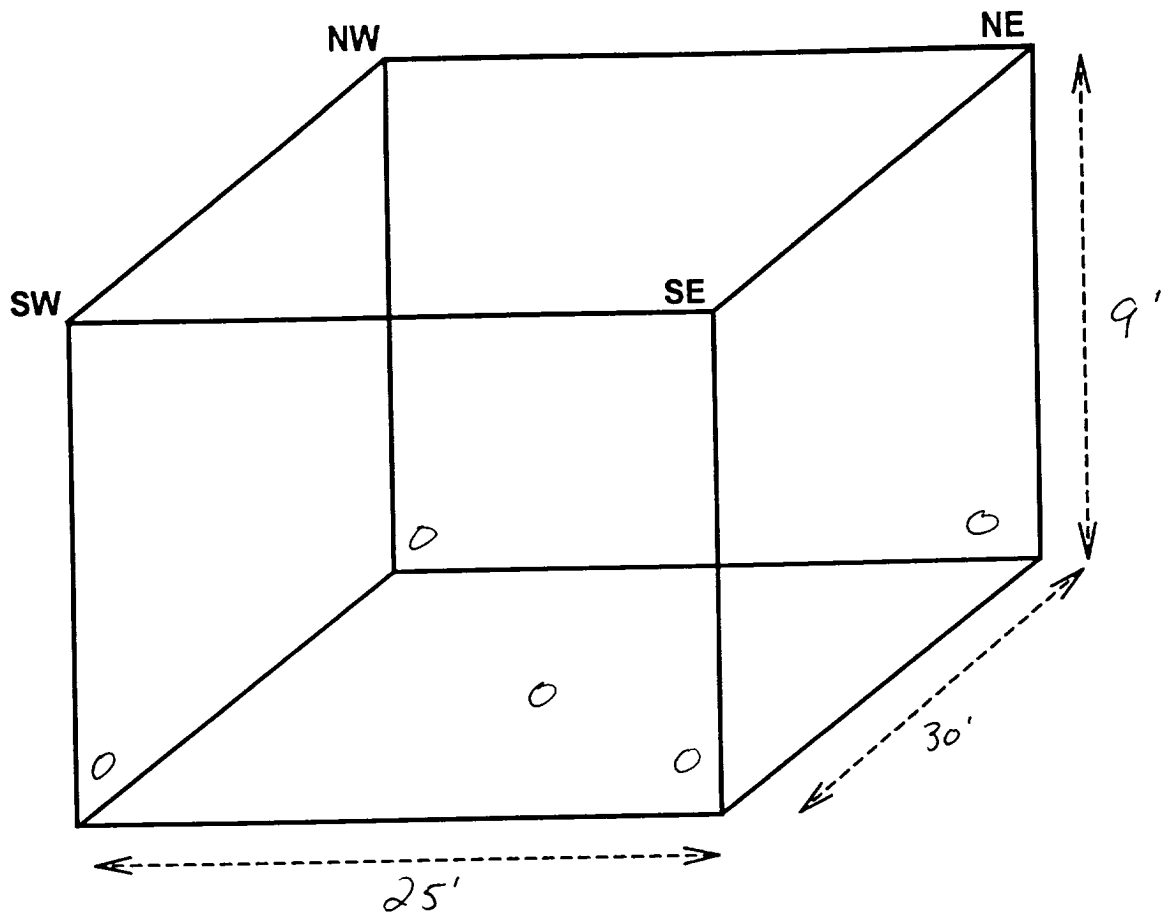

○ = SAMPLE AREA

WELL NAME JAT 124 # 5

SAMPLE DATE 6/30/97

NOTES 4 POINT COMPOSITE SAMPLE TAKEN 8" TO 10" INTO PIT

SIDEWALL

1 POINT GRAB SAMPLE TAKEN 10" TO 12" INTO BOTTOM CENTER

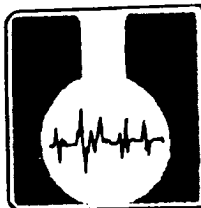

**ASSAIGAI
ANALYTICAL
LABORATORIES, INC.**

AUG 4 1997

7300 Jefferson, N.E. • Albuquerque, New Mexico 87109 • (505) 345-8964 • FAX (505) 345-7259
3332 Wedgewood, E-5 • El Paso, Texas 79925 • (915) 593-6000 • FAX (915) 593-7820

Report Generated:
July 11, 1997 14:53

**CERTIFICATE OF ANALYSIS
RESULTS BY SAMPLE**

SENT APACHE CORPORATION
TO: 304 N. BEHREND
FARMINGTON, NM 87401

WORKORDER # : 9707039
WORK ID : JICARILLA PIT CLOSURES
CLIENT CODE : APA01
DATE RECEIVED : 07/04/97

ATTN: JEFF CROSS

Page: 1

Lab ID: 9707039-01A
Sample ID: JAT 124 #5 SIDES

Collected: 06/30/97 12:20:00
Matrix: SOIL

TEST / METHOD	RESULT	UNITS	LIMIT	D_F	DATE ANAL	BATCH_ID
BTEX/SW846 8020A						
Benzene	ND	mg/kg	0.0050	100	07/08/97	SBTXME175
Toluene	ND	mg/kg	0.0050	100	07/08/97	SBTXME175
Ethylbenzene	ND	mg/kg	0.0050	100	07/08/97	SBTXME175
P-&m-Xylene	ND	mg/kg	0.010	100	07/08/97	SBTXME175
O-Xylene	ND	mg/kg	0.0050	100	07/08/97	SBTXME175

Lab ID: 9707039-01B
Sample ID: JAT 124 #5 SIDES

Collected: 06/30/97 12:20:00
Matrix: SOIL

TEST / METHOD	RESULT	UNITS	LIMIT	D_F	DATE ANAL	BATCH_ID
Diesel Range OG Soil/M8015						
Diesel Range OG in Soil	ND	mg/Kg	50	25	07/09/97	SDRO040

Lab ID: 9707039-02A
Sample ID: JAT 124 #5 BOTTOM

Collected: 06/30/97 12:30:00
Matrix: SOIL

TEST / METHOD	RESULT	UNITS	LIMIT	D_F	DATE ANAL	BATCH_ID
BTEX/SW846 8020A						
Benzene	ND	mg/kg	0.0050	100	07/08/97	SBTXME175
Toluene	ND	mg/kg	0.0050	100	07/08/97	SBTXME175
Ethylbenzene	ND	mg/kg	0.0050	100	07/08/97	SBTXME175
P-&m-Xylene	ND	mg/kg	0.010	100	07/08/97	SBTXME175
O-Xylene	ND	mg/kg	0.0050	100	07/08/97	SBTXME175



Lab ID: 9707039-02B

Sample ID: JAT 124 #5 BOTTOM

Collected: 06/30/97 12:30:00

Matrix: SOIL

TEST / METHOD	RESULT	UNITS	LIMIT	D_F	DATE ANAL	BATCH_ID
Diesel Range OG Soil/M8015 Diesel Range OG in Soil	ND	mg/Kg	50	25	07/09/97	SDRO040

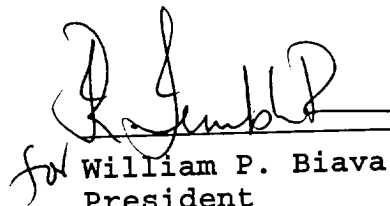
for William P. Biava
President

WORKORDER COMMENTS

DATE : 07/11/97
WORKORDER:

DEFINITIONS/DATA QUALIFIERS

The following are definitions, abbreviations, and data qualifiers which may have been utilized in your report:

- ND = Analyte "not detected" in analysis at the sample specific detection limit.
- D_F = Sample "dilution factor"
- NT = Analyte "not tested" per client request.
- B = Analyte was also detected in laboratory method QC blank.
- E = Analyte concentration (result) is an estimated value or exceeds analysis calibration range.
- LIMIT = The minimum amount of the analyte that AAL can detect utilizing the specified analysis.

Please Note: Multiply the "Limit" value (AAL's Detection Limit) by Dilution Factor (D_F) to obtain the sample specific Detection Limit.

REPORT COMMENTS

Chain of Custody Record

7039 7-4-67

Date -

7039 7-4-97

Page 1 of 1

Client Apache Corporation Project Manager / Contact Jeff Cross

Address 304 N. Behrend
Telephone No. (505) 774-6643

City/State/Zip Farmington, NM 87401 Fax No. (505) 774-6624

Project Name / Number JICARILLA PIT CLOSURES Samplers: (Signature) Jeff Wom

Contract / Purchase Order / Quote _____

7300 JEFFERSON, N.E.

ALBUQUERQUE, NEW MEXICO

(505) 345-8964

3332 WEDGEWOOD
EL PASO TEXAS 79925

(915) 593-6000

MELQUIADES ALANIS

6411 LOCAL UNO

CIUDAD JUAREZ, CHIHUAHUA MEXICO 32320

[illegible]

LABORATORY

NORTH

DRAINAGE

JICARILLA APACHE 124 WELL #5

NE/4 ~~SE~~/4

SECTION 23 T25N-R4W.

RIO ARriba COUNTY, NM.

PIT

O WELL HEAD

LAND FARM
75' X 40' X 12"

JICARILLA APACHE TRIBE
ENVIRONMENTAL PROTECTION OFFICE
P. O. BOX 507
DULCE, NEW MEXICO 87528

Submit 1 copy to
Natural Resource Dept.
and Oil & Gas Administration

ON-SITE SOIL REMEDIATION REPORT

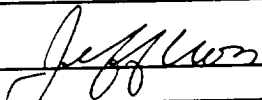
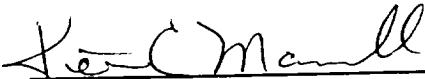
Operator: <u>M W PETROLUEM</u> Telephone <u>505-325-0318</u>	
Address: <u>2855 SOUTHSIDE RIVER ROAD /SUITE A/FARMINGTON, N.M. 87401-7947</u>	
Facility or Well Name: <u>JAT 124 # 5</u>	
Location: Unit or Qtr/Qtr Sec <u>SEWE SEC 23 T 25 N R 4 W</u> County <u>RIO ARRIBA</u>	
Land Type <u>JIC. TRIBAL</u>	
Date Remediation Started: <u>6/27/97</u> Date Completed: <u>8/17/98</u>	
Remediation Method: Landfarmed <u>XXX</u> Approx. cubic yards <u>111</u>	
Composted _____	
Other <u>REMEDIED SOIL TO BE PUT BACK IN PIT.</u>	
Depth to Groundwater: (pts) <u>0</u>	Final Closure Sampling Sampling Date: <u>8/17/98</u> Time: <u>1:45PM</u> Sample Results: Field Headspace (ppm) <u>0</u> TPH (ppm) <u>ND</u> Method <u>M8015</u> Other <u>BTEX \ SW846 , 8020A (ND)</u>
Distance to an Ephemeral Stream: (pts) <u>0</u>	
Distance to Nearest Lake, Playa, or Watering Pond: (pts) <u>0</u>	
Wellhead Protection Area: (pts) <u>0</u>	
Distance To Surface Water: (pts) <u>0</u>	
RANKING SCORE (TOTAL POINTS) <u>0</u>	
I HEREBY CERTIFY THAT THE INFORMATION ABOVE IS TRUE AND COMPLETE TO THE BEST OF MY KNOWLEDGE AND BELIEF	
DATE: <u>9/14/98</u>	PRINTED NAME <u>JEFF CROSS</u>
SIGNATURE <u></u>	TITLE <u>PROJECT MANAGER</u>
AFTER REVIEW OF THE SOIL REMEDIATION INFORMATION. ON-SITE REMEDIATION IS APPROVED IN ACCORDANCE TO THE JICARILLA APACHE TRIBE PIT CLOSURE ORDINANCE.	
APPROVED: YES <u>X</u> NO _____ (REASON) _____	
SIGNED: <u></u>	DATE: <u>11-13-98</u>

M W PETROLEUM/FARMINGTON DISTRICT SOIL REMEDIATIONS STATUS REPORT

REMEDIATION SITE JAT 124 # 5

* AMOUNT OF SOIL UNDERGOING REMEDIATION 111 Yds.

CELL No. <u>1</u>	SampDATE 8/17/98	TPH ND	BTEX ND
DIMENSIONS(LxWxH) <u>75' X 40' X 12"</u>			
CELL LOCATION (dir. from well head) <u>SOUTH</u>			
* DATE BEGAN: <u>6/27/97</u>			
DATE TERMINATED (TPH <5,000 ppm/BTEX< 50 ppm/Benzene < 10 ppm) <u>8/17/98</u>			

CELL No. <u>2</u>	SampDATE	TPH	BTEX
DIMENSIONS(LxWxH)			
CELL LOCATION (dir. from well head)			
* DATE BEGAN:			
DATE TERMINATED (TPH <5,000 ppm/BTEX< 50 ppm/Benzene < 10 ppm)			

CELL No. <u>3</u>	SampDATE	TPH	BTEX
DIMENSIONS(LxWxH)			
CELL LOCATION (dir. from well head)			
* DATE BEGAN:			
DATE TERMINATED (TPH <5,000 ppm/BTEX< 50 ppm/Benzene < 10 ppm)			

REMEDIATION RECORD: (Date, Treatment, Tilling)

7/2/97 TREAT SOIL CELL WITH 46-0-0 FERTILIZER, WATER, PLOW AND TILL.

7/15/97 PLOW AND TILL SOIL CELL.

7/24/97 PLOW AND TILL SOIL CELL.

6/25/98 PLOW AND TILL SOIL CELL.

8/7/97 WATER, PLOW AND TILL SOIL CELL.

7/9/98 WATER, PLOW AND TILL SOIL.

4/20/98 PLOW AND TILL SOIL CELL.

7/23/98 PLOW AND TILL SOIL CELL.

5/12/98 PLOW AND TILL SOIL CELL.

8/7/98 PLOW AND TILL SOIL CELL.

5/28/98 WATER, PLOW AND TILL SOIL CELL.

8/14/98 PLOW AND TILL SOIL CELL.

6/7/98 PLOW AND TILL SOIL CELL.

From excavation reports.

WELL NAME:

JAT 124 #5 cell

SAMPLE DATE:

8-17-98

DIMENSIONS:

80' x 40' x 12"



= SAMPLE AREA

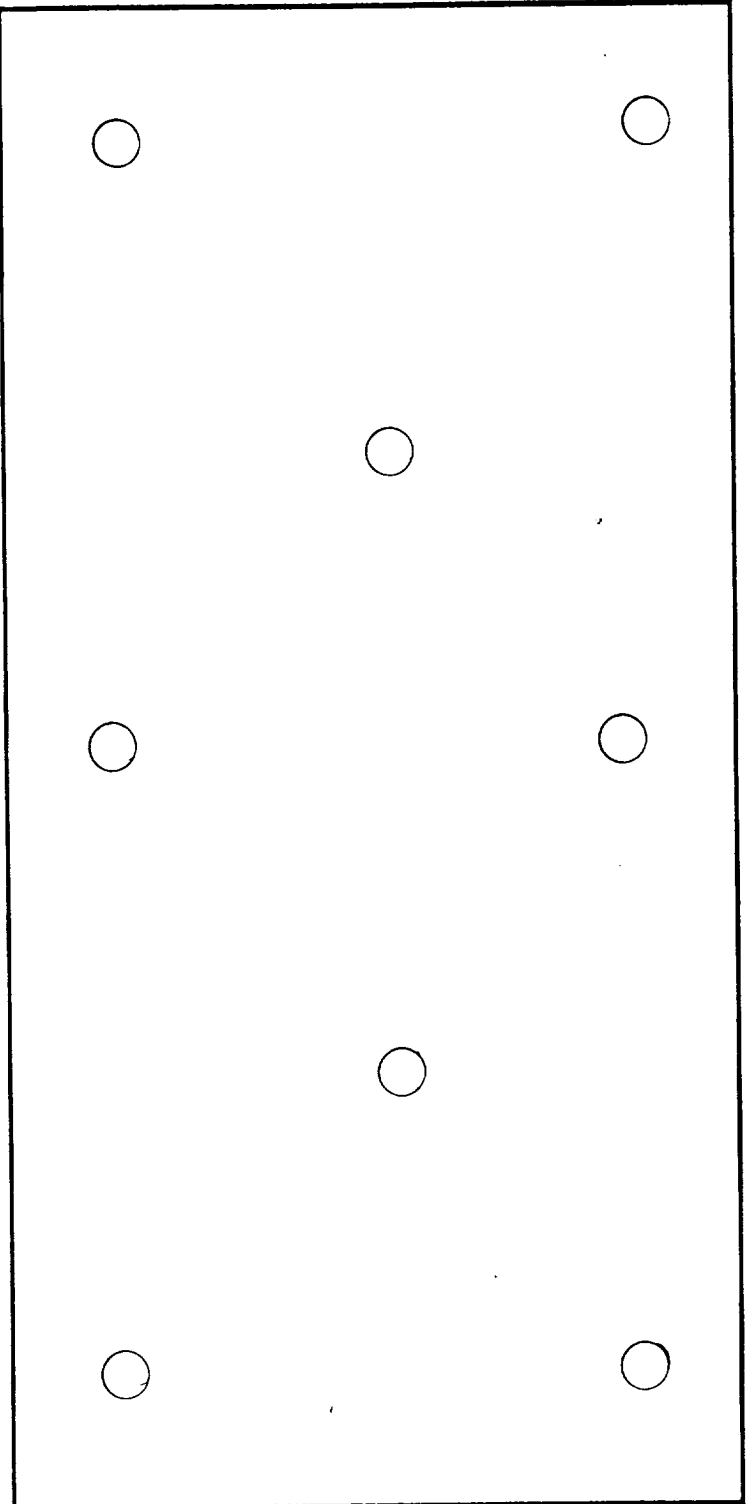

NOTES:

ALL SAMPLES TAKEN 10" TO 12" INTO CELL.

8 Point Composite Sample

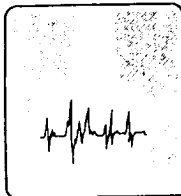

ASSAIGAI ANALYTICAL LABORATORIES, INC.

7300 Jefferson, NE • Albuquerque, New Mexico 87109 • (505) 345-6984 • FAX (505) 345-7259

3332 Wedgewood, E-5 • El Paso, Texas 79925 • (915) 593-6000 • FAX (915) 593-7820
127 Eastgate Drive, 212-C • Los Alamos, New Mexico 87544 • (505) 662-2558

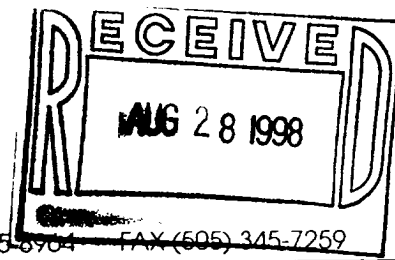

APACHE CORPORATION
attn: **JEFF CROSS**
2855 SOUTHSIDE RIVER RD STE A
FARMINGTON, NM 87401-7947

* explanation of codes

B	analyte detected in Method Blank
E	result is estimated
H	analyzed out of hold time
N	tentatively identified compound
S	subcontracted
1-9	see footnote

Assaigai Analytical Laboratories, Inc. Certificate of Analysis

Client: **APACHE CORPORATION**
Project: **9808189 JICARILLA PIT CLOSURES**

William P. Biava
William P. Biava: President of Assaigai Analytical Laboratories, Inc.

Client Sample ID: **JAT 124 #5 CELL** Sample Matrix: **SOIL** Sample Collected: **08/17/98 13:45:00**

Fraction	QC Group	CAS #	Result	Units	Dilution Factor	Detection Limit	* Sequence	Run Date
Test: SW846 8015A/8020A GRO / Purgeable Aromatics								
9808189-01A	X98392	71-43-2	Benzene	ND	mg / Kg	50	0.005	XG.1998.704-18 08/21/98
	X98392	100-41-4	Ethylbenzene	ND	mg / Kg	50	0.005	XG.1998.704-18
	X98392	95-47-6	o-Xylene	ND	mg / Kg	50	0.005	XG.1998.704-18
	X98392		p/m Xylenes	ND	mg / Kg	50	0.01	XG.1998.704-18
	X98392	108-88-3	Toluene	ND	mg / Kg	50	0.005	XG.1998.704-18
Test: SW846 8015A Diesel Range Organics by GC/FID								
9808189-01B	X98389		Diesel Range Organics	ND	mg / Kg	25	25	XG.1998.699-17 08/21/98

*** Sample specific analytical Detection Limit is determined by multiplying the sample Dilution Factor by the listed method Detection Limit. ***
*** Results relate only to the items tested. ***



