

UNITED STATES
DEPARTMENT OF THE INTERIOR
GEOLOGICAL SURVEY

APPLICATION FOR PERMIT TO DRILL, DEEPEN, OR PLUG BACK

1a. TYPE OF WORK

DRILL ☒DEEPEN ☐PLUG BACK ☐

b. TYPE OF WELL

OIL
WELL ☐GAS
WELL ☒OTHER ☐SINGLE
ZONE ☒MULTIPLE
ZONE ☐

2. NAME OF OPERATOR

SUPRON ENERGY CORPORATION

3. ADDRESS OF OPERATOR

P.O. Box 808, Farmington, New Mexico 87401

4. LOCATION OF WELL (Report location clearly and in accordance with any State requirements.)*

At surface

1095 ft./North line and 790 ft./East line

At proposed prod. zone

Same as above

14. DISTANCE IN MILES AND DIRECTION FROM NEAREST TOWN OR POST OFFICE*

15 miles northeast of Counselors, New Mexico

15. DISTANCE FROM PROPOSED*

LOCATION TO NEAREST
PROPERTY OR LEASE LINE, FT.
(Also to nearest drlg. unit line, if any)

790 ft.

790 ft.

18. DISTANCE FROM PROPOSED LOCATION*
TO NEAREST WELL, DRILLING, COMPLETED,
OR APPLIED FOR, ON THIS LEASE, FT.

305 ft.

16. NO. OF ACRES IN LEASE

2560

19. PROPOSED DEPTH

7560

17. NO. OF ACRES ASSIGNED
TO THIS WELL

319.91 E*

20. ROTARY OR CABLE TOOLS

Rotary

21. ELEVATIONS (Show whether DF, RT, GR, etc.)

6716 Gr.

22. APPROX. DATE WORK WILL START*

August 18, 1980

23.

PROPOSED CASING AND CEMENTING PROGRAM

SIZE OF HOLE	SIZE OF CASING	WEIGHT PER FOOT	SETTING DEPTH	QUANTITY OF CEMENT
12-1/4"	8-5/8"	24.00	250 ft.	175 sx
7-7/8"	4-1/2"	10.50	7560 ft.	1000 sx

The surface hole will be drilled to +250 ft. Casing will be run and cemented with the cement being circulated back to the surface. The surface casing will be pressure tested. The well will be drilled to T.D. of approx. 7560 ft. using a starch base mud as the circulating medium. Pipe will be run and cemented in three stages as follows: First stage 400 sx of 50-50 POZ mix, Second stage 400 sx of 50-50 POZ mix followed by 50 sx of class "B" cement and the Third stage 100 sx of HOWCO Lite followed by 50 sx of class "B" with the estimated cement top to be at 2,300 ft. The pipe will be pressure tested and the Dakota zone will be perforated and fractured to stimulate production. The well will be cleaned up and tubing run and landed above the Dakota zone. The wellhead will be nipped down and the well tested.

IN ABOVE SPACE DESCRIBE PROPOSED PROGRAM: If proposal is to deepen or plug back, give data on present productive zones and proposed new productive zone. If proposal is to drill or deepen directionally, give pertinent data on subsurface locations and measured and true vertical depths. Give blowout preventer program, if any.

24.

SIGNED

Rudy D. Motto

TITLE Area Superintendent

DATE 6-12-80

(This space for Federal or State office use)

PERMIT NO.

APPROVAL DATE

APPROVED BY

TITLE

CONDITIONS OF APPROVAL, IF ANY:

ok Frank

M1000

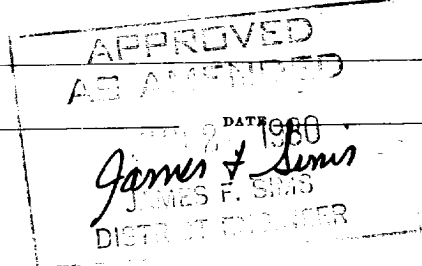

All distances must be from the outer boundaries of the Section.

Operator SUPRON ENERGY CORPORATION		Lease JICARILLA "K"		Well No. 15-E
Unit Letter A	Section 1	Township 25 NORTH	Range 5 WEST	County RIO ARriba
Actual Footage Location of Well: 1095 feet from the NORTH line and 790 feet from the EAST line				
Ground Level Elev. 6716	Producing Formation DAKOTA	Pool BASIN Dakota	Dedicated Acreage: E 1/2 319.91 Acres	

1. Outline the acreage dedicated to the subject well by colored pencil or hatch marks on the plat below.
2. If more than one lease is dedicated to the well, outline each and identify the ownership thereof (both as to working interest and royalty).
3. If more than one lease of different ownership is dedicated to the well, have the interests of all owners been consolidated by communitization, unitization, force-pooling, etc?

☐ Yes ☐ No If answer is "yes," type of consolidation _____

If answer is "no," list the owners and tract descriptions which have actually been consolidated. (Use reverse side of this form if necessary.) _____

No allowable will be assigned to the well until all interests have been consolidated (by communitization, unitization, forced-pooling, or otherwise) or until a non-standard unit, eliminating such interests, has been approved by the Division.

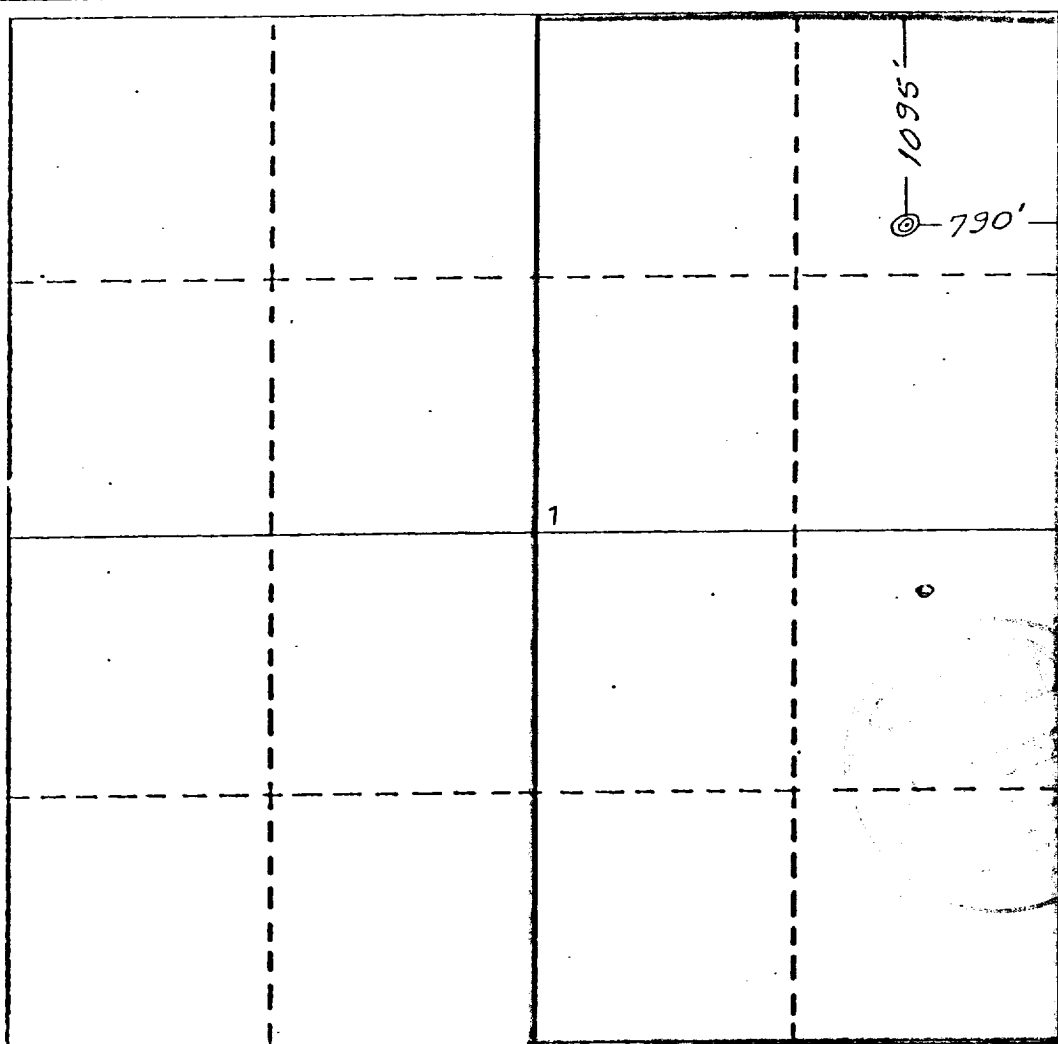

CERTIFICATION

I hereby certify that the information contained herein is true and complete to the best of my knowledge and belief.

Rudy D. Motto
Name

Rudy D. Motto

Position

Area Superintendent

Company

SUPRON ENERGY CORPORATION

Date

February 6, 1980

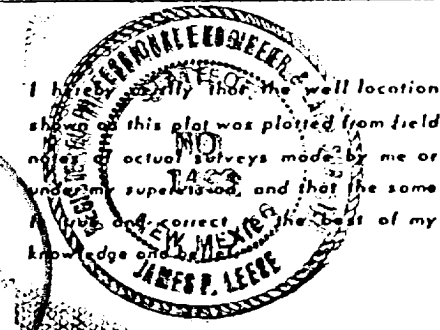

Date Surveyed

February 6, 1980

Registered Professional Engineer
and/or Land Surveyor

James P. Leese
James P. Leese

Certificate No.

1463

SUPRON ENERGY CORPORATION

JICARILLA "K" No. 15-E
NE ¼ Sec. 1, T-25N, R-5W, N.M.P.M.
Rio Arriba County, New Mexico

1. The Geologic name of the surface formation is, "Wasatch".
2. The estimated tops of important Geologic markers are:
 - A. Ojo Alamo 2646 ft.
 - B. Fruitland 2776 ft.
 - C. Pictured Cliffs 3081 ft.
 - D. Chacra 3607 ft.
 - E. Cliff House 4771 ft.
 - F. Point Lookout 5301 ft.
 - G. Gallup 5941 ft.
 - H. Greenhorn 7226 ft.
 - I. Dakota 7298 ft.
3. The estimated depths at which anticipated water, oil or other mineral bearing formations are expected to be encountered are:
 - A. Ojo Alamo 2646 ft. Water
 - B. Fruitland 2776 ft. Water
 - C. Pictured Cliffs 3081 ft. Gas
 - D. Chacra 3607 ft. Dry
 - E. Cliff House 4771 ft. Gas
 - F. Point Lookout 5301 ft. Gas
 - G. Gallup 5941 ft. Gas
 - H. Greenhorn 7226 ft. Shale
 - I. Dakota 7298 ft. Gas
4. The casing program is shown on form 9-331C and all casing is new.
5. The lessee's pressure control equipment schematics are attached, along with minimum specifications, testing procedures, and frequencies.
6. The type, estimated volumes, and characteristics of the circulating medium are as follows:
 - A. 0 - 250 ft. Natural Mud
 - B. 250 - 7560 ft. Permaloid non dispersed mud containing approx. 180 sx gel, 70 sx of permaloid and 20 sx of CMC.
7. The auxiliary equipment to be used will be floats at the bit and a sub on the floor with a full opening valve to be stabbed into the drill pipe when the kelly is not in the string.
8. The well is in an area which is partially developed; therefore we will not have a testing and coring program. The logging program is as follows:
 - A. E.S. Induction
 - B. Gamma Ray Density
 - C. Gamma Ray Correlation
 - D. Cement Bond Log
9. We do not expect to find any abnormal pressures, temperatures or hydrogen sulfide problems in this partially developed area.
10. The anticipated starting date for this well is August 18, 1980.

SUPRON ENERGY CORPORATION
JICARILLA "K" NO. 15-E
NE/4 Sec. 1, T-25N, R-5W, N.M.P.M.
Rio Arriba County, New Mexico

The following attachments are included with this application:

1. Topographical map showing proposed location and access road.
2. Access road not required.
3. Map showing existing producing facilities.
4. Location of surface equipment if required.
5. Drilling and completion water will be obtained from the Jicarilla "J" Water well.
6. All pits will be fenced and constructed in such a way as to prevent litter on the location.
7. We will dispose of all waste by placing it in the reserve pit and burying it when the well is completed.
8. There will be no camp at or near the well site.
9. There will be no air strip.
10. A plat is attached showing the location of the rig, mud tanks, reserve pit, burn pit, etc.
11. A letter of certification is attached. The operator representative for compliance purposes is Rudy D. Motto, Area Superintendent, P.O. Box 808, Farmington, New Mexico 87401. Phone (505) 325-3587.
12. After the well is completed, the location will be cleaned up, and bladed. The reserve pit will be allowed to dry and then filled and restored to its natural state.
13. The soil is sandy clayey loam, the principal vegetation is greasewood, sagebrush, rabbitbrush, pinon, juniper, paintbrush, prickly pear, wild mustard, brome, indian ricegrass, galleta.



JICARILLA NATIONAL MONUMENT

Supron Energy Corporation
Jicarilla K #15E
NE $\frac{1}{4}$ Sec 1, T25N, R5W, N.M.P.M.
Rio Arriba County, N.M.

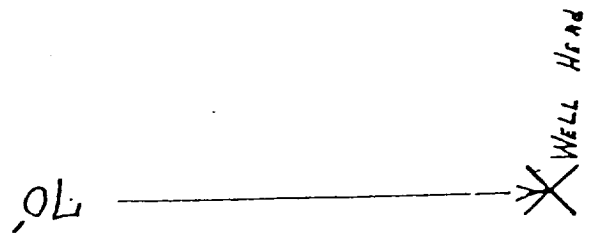
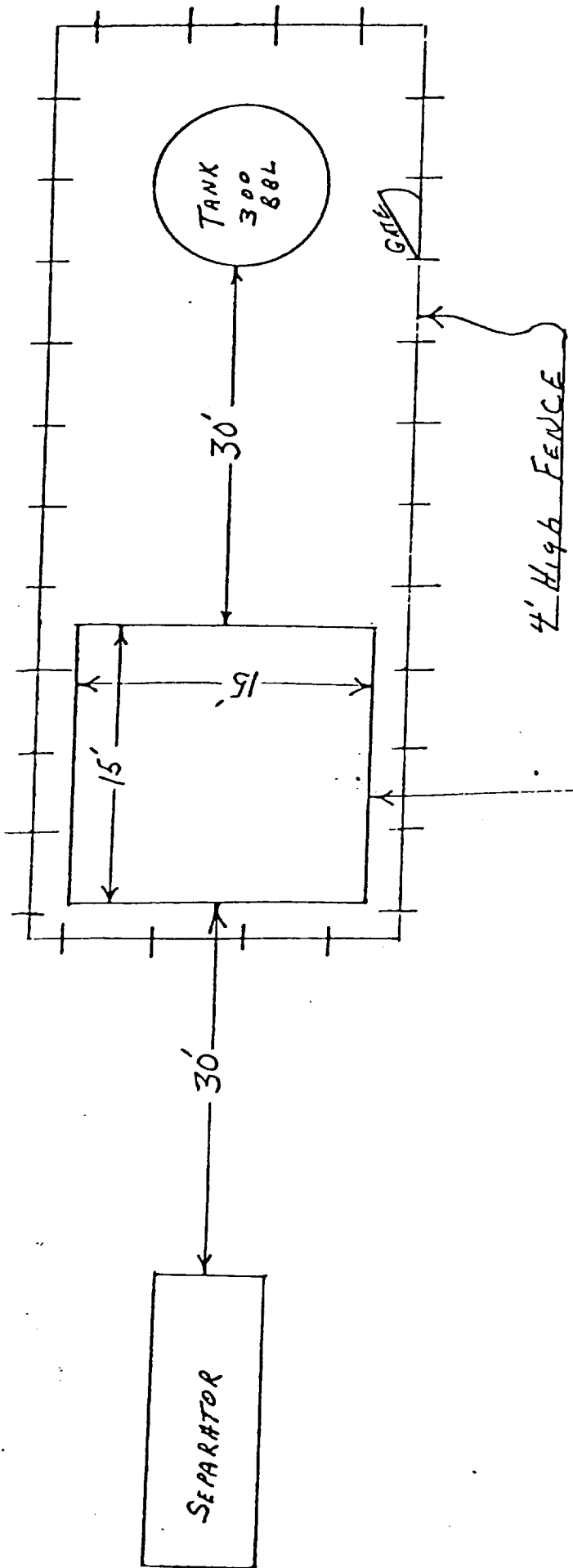

Blowout Preventer will be tested daily and prior to drilling out with the results to be logged on the drillers report.

The B.O.P. and all valve and fittings are rated at 3000 psi working pressure, and hydraulically operated

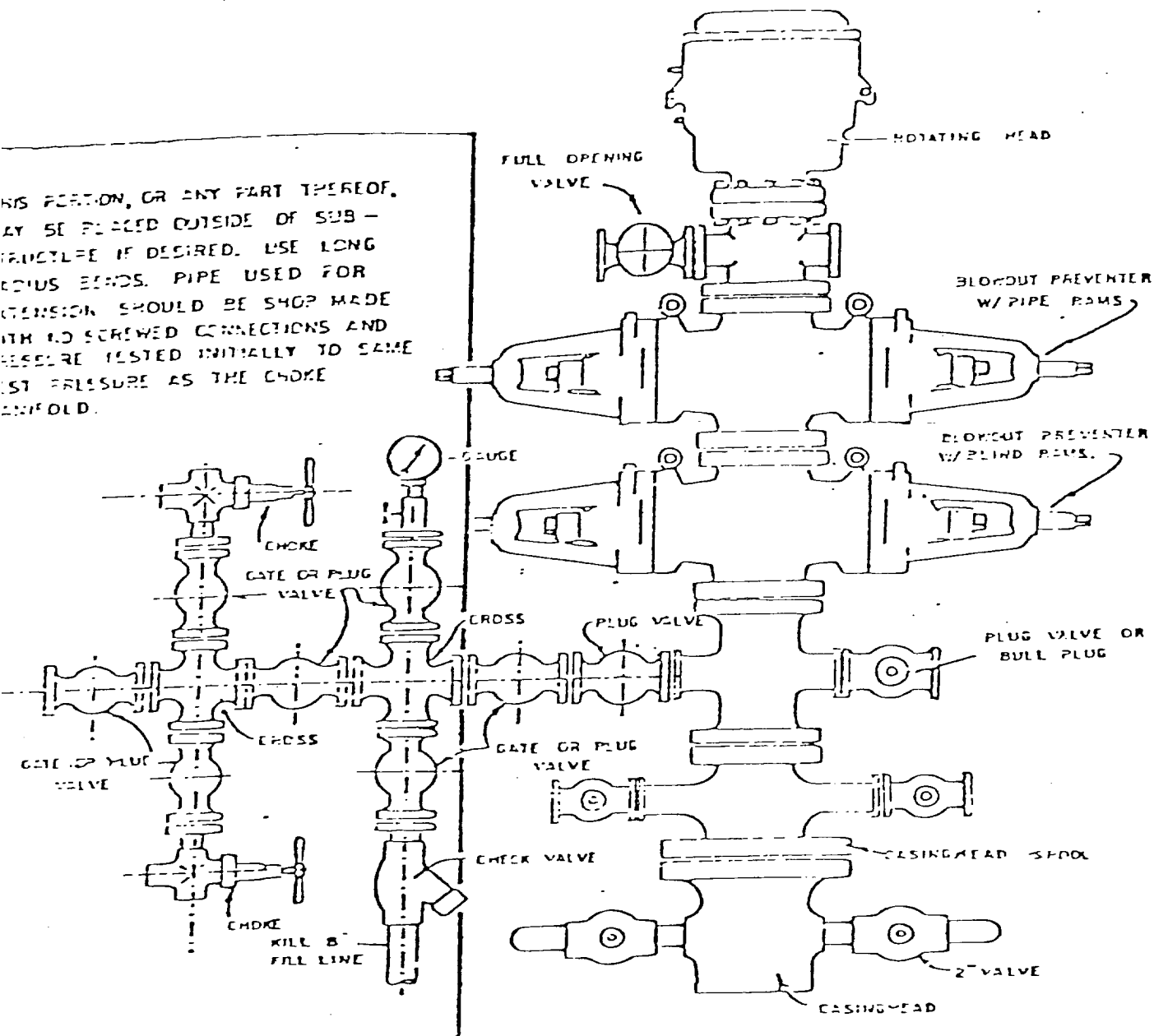

BLOWOUT PREVENTER HOOKUP

NO ROAD

LOCATION AND EQUIPMENT LAYOUT

JICARILLA "K" NO. 15-E

1095 Ft./N; 790 ft./E line

Sec. 1, T-25N, R-5W

Rio Arriba County, New Mexico

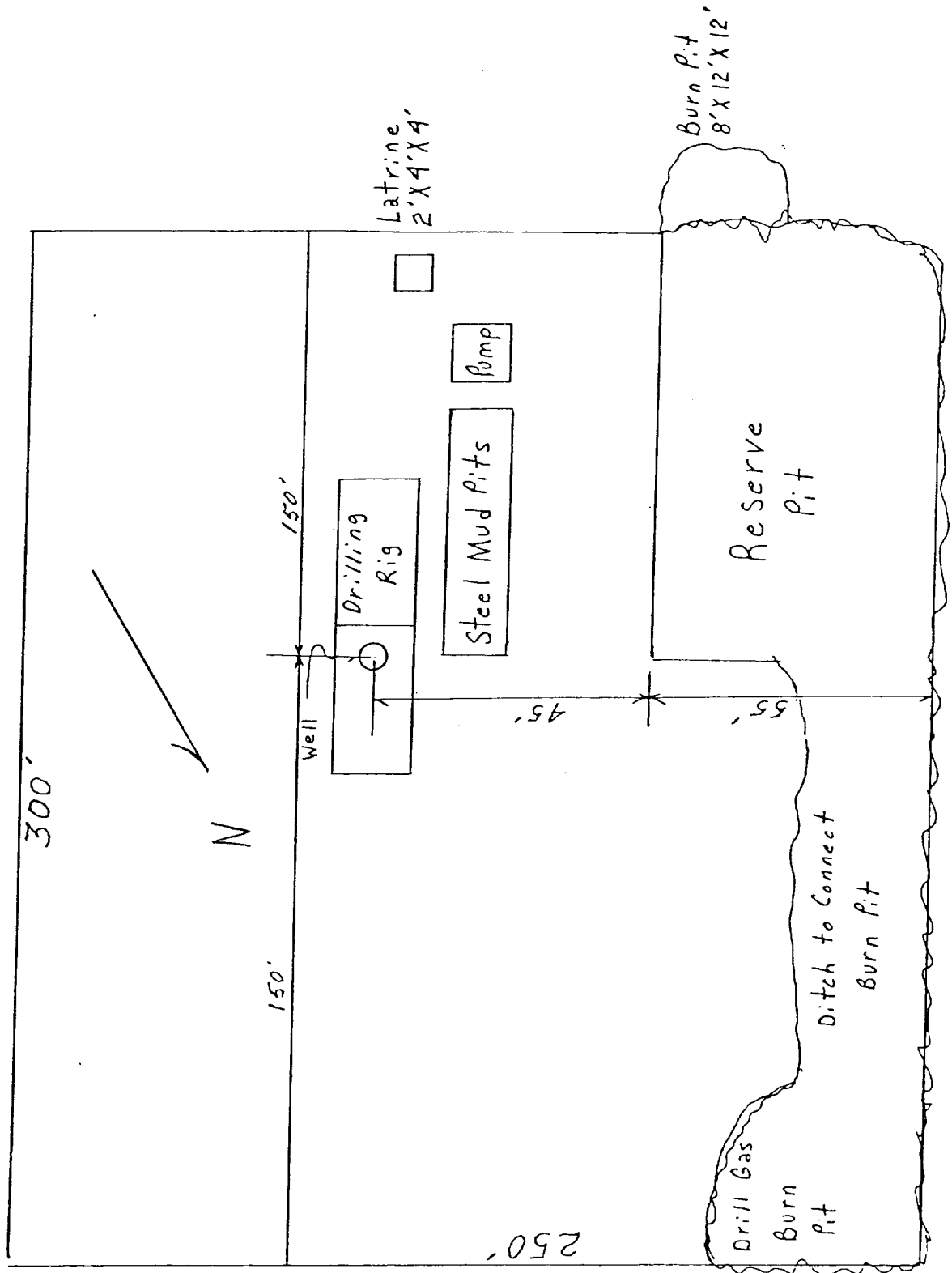

SUPRON ENERGY CORPORATION
Post Office Box 808
FARMINGTON, NEW MEXICO 87401

I hereby certify that I, or persons under my direct supervision, have inspected the proposed drillsite and access route; that I am familiar with the conditions which presently exist; that the statements made in this plan are, to the best of my knowledge, true and correct; and, that the work associated with the operations proposed herein will be performed by SUPRON ENERGY CORPORATION and its contractors subcontractors in conformity with this plan and the terms and conditions under which it is approved.

SUPRON ENERGY CORPORATION

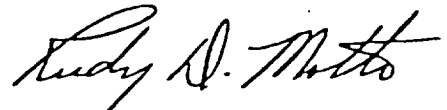

Rudy D. Motto
Area Superintendent
Phone: 325-3587