

UNITED STATES
DEPARTMENT OF THE INTERIOR
GEOLOGICAL SURVEY

30-049-22439
3. LEASE DESIGNATION AND SERIAL NO.

SF-078874

4. IF INDIAN, ALLOTTEE OR TRIBE NAME

5. UNIT AGREEMENT NAME

6. FARM OR LEASE NAME

Canyon Largo Unit

7. WELL NO.

299

8. FIELD AND POOL, OR WILDCAT

Devils Fork Gallup

9. SEC., T., R., M., OR BLK.
AND SURVEY OR AREA

Sec. 4, T24N, R6W

10. COUNTY OR PARISH

Rio Arriba N.M.

APPLICATION FOR PERMIT TO DRILL, DEEPEN, OR PLUG BACK

1. TYPE OF WORK

DRILL ☒

DEEPEN ☐

PLUG BACK ☐

2. TYPE OF WELL

OIL
WELL ☒

GAS
WELL ☐

OTHER

SINGLE
ZONE ☒

MULTIPLE
ZONE ☐

3. NAME OF OPERATOR

J. Gregory Merrion & Robert L. Bayless

4. ADDRESS OF OPERATOR

P.O. Box 1541, Farmington, NM 87401

5. LOCATION OF WELL (Report location clearly and in accordance with any State requirements.)

At surface

990 PSL & 1980 FEL

At proposed prod. zone

same

6. DISTANCE IN MILES AND DIRECTION FROM NEAREST TOWN OR POST OFFICE*

Approx 3.5 miles NE of Lindrith Camp

7. DISTANCE FROM PROPOSED*

LOCATION TO NEAREST

PROPERTY OR LEASE LINE, FT.

(Also to nearest drlg. unit line, if any) 990'

8. NO. OF ACRES IN LEASE

2559 \pm

9. NO. OF ACRES ASSIGNED
TO THIS WELL

5/80

10. DISTANCE FROM PROPOSED LOCATION*

TO NEAREST WELL, DRILLING, COMPLETED,
OR APPLIED FOR, ON THIS LEASE, FT.

appx. 3000'

11. PROPOSED DEPTH

5700'

12. ROTARY OR CABLE TOOLS

rotary

13. ELEVATIONS (Show whether DF, RT, GR, etc.)

6436' GL

14. APPROX. DATE WORK WILL START*

As soon as possible

15.

PROPOSED CASING AND CEMENTING PROGRAM

SIZE OF HOLE	SIZE OF CASING	WEIGHT PER FOOT	SETTING DEPTH	QUANTITY OF CEMENT
12-1/4"	8-5/8"	24 lb.	150 ft. 200	100 sacks
7-7/8"	4-1/2"	10.5 lb.	5700 ft.	500 sacks

Will drill 12-1/4" hole to 150 ft. and set 150 ft. of 8-5/8", 24 lb. casing with 100 sacks cement. Will drill 7-7/8" hole to 5700 ft. and run open hole logs. If appears productive will run 5700 ft. of 4-1/2", 10.5 lb. casing and cement with 500 sacks. Will set stage collar at approximately 4300 ft. and bring cement up across Ojo Alamo formation. Will perforate and stimulate as required. Minimum specifications for pressure control equipment which is to be used: 10", 900 series double ram BOP.

ESTIMATED TOPS

Formation	Depth	Content
Ojo Alamo	1480'	
Pictured Cliffs	2070'	Gas, Salt Water
Mesa Verde	3605'	Salt Water
Gallup	5375'	Oil, Salt Water

IN ABOVE SPACE DESCRIBE PROPOSED PROGRAM: If proposal is to deepen or plug back, give data on present productive zone and proposed new productive zone. If proposal is to drill or deepen directionally, give pertinent data on subsurface locations and measured and true vertical depths. Give blowout prevention program, if any.

24.

SIGNED

Steven L. Smith

TITLE

Engineer

DATE

April 15, 1980

(This space for Federal or State office use)

PERMIT NO.

APPROVAL DATE

APPROVED BY

TITLE

DATE

CONDITIONS OF APPROVAL, IF ANY:

ah 3 me

*See Instructions On Reverse Side

SVOL C-104 for NSL

OIL CONSERVATION DIVISION

STATE OF NEW MEXICO
LAND AND MINERALS DEPARTMENT

P. O. BOX 2088

SANTA FE, NEW MEXICO 87501

Form C-107
Revised 10-1-78

All distances must be from the outer boundaries of the Section

Operator MERRION & BAYLESS			Lease CANYON LARGO UNIT		Well No. 299
Unit Letter 0	Section 4	Township 24N	Range 6W	County Rio Arriba	
Actual Footage Location of Well: 990 feet from the South line and 1980 feet from the East line					
Ground Level Elev. 6436	Producing Formation Gallup		Pool Devils Fork	Dedicated Acreage: 80 Acres	

1. Outline the acreage dedicated to the subject well by colored pencil or hatchure marks on the plat below.
2. If more than one lease is dedicated to the well, outline each and identify the ownership thereof (both as to working interest and royalty).
3. If more than one lease of different ownership is dedicated to the well, have the interests of all owners been consolidated by communitization, unitization, force-pooling, etc?

☐ Yes ☐ No If answer is "yes," type of consolidation _____

If answer is "no," list the owners and tract descriptions which have actually been consolidated. (Use reverse side of this form if necessary.) _____

No allowable will be assigned to the well until all interests have been consolidated (by communitization, unitization, forced-pooling, or otherwise) or until a non-standard unit, eliminating such interests, has been approved by the Commission.

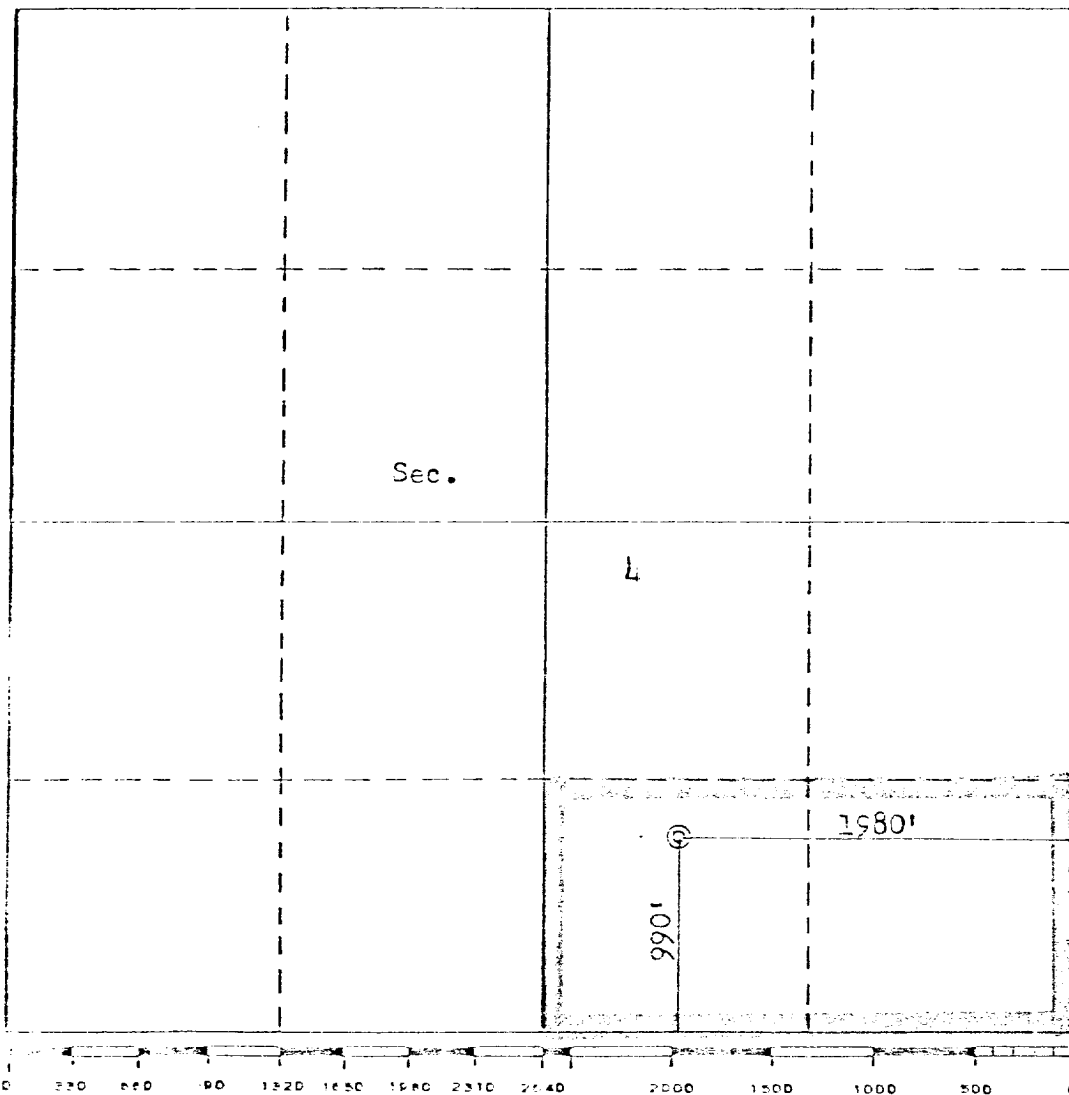

CERTIFICATION

I hereby certify that the information contained herein is true and complete to the best of my knowledge and belief.

Steven S. Dunn

Name

Steven S. Dunn

Position

Engineer

Company

Merrion & Bayless

Date

April 15, 1980

I hereby certify that the well location shown on this plat was plotted from field notes of actual surveys made by me or under my supervision, and that the same is true and correct to the best of my knowledge and belief.

Date Surveyed

March 15, 1980

Registered Professional Engineer
and/or Land Surveyor

Fred B. Kern

Certificate No.

3950

UNITED STATES
DEPARTMENT OF THE INTERIOR
GEOLOGICAL SURVEY

SUNDRY NOTICES AND REPORTS ON WELLS

(Do not use this form for proposals to drill or to deepen or plug back to a different reservoir. Use Form 9-331-C for such proposals.)

1. oil ☒ well gas ☐ well other ☐
2. NAME OF OPERATOR
J. Gregory Merrion & Robert L. Bayless
3. ADDRESS OF OPERATOR
P.O. Box 507, Farmington, NM 87401
4. LOCATION OF WELL (REPORT LOCATION CLEARLY. See space 17 below.)
AT SURFACE: 990 PSL & 1980 FEL
AT TOP PROD. INTERVAL: same
AT TOTAL DEPTH: same
16. CHECK APPROPRIATE BOX TO INDICATE NATURE OF NOTICE, REPORT, OR OTHER DATA

REQUEST FOR APPROVAL TO:

- TEST WATER SHUT-OFF ☐
FRACTURE TREAT ☐
SHOOT OR ACIDIZE ☐
REPAIR WELL ☐
PULL OR ALTER CASING ☐
MULTIPLE COMPLETE ☐
CHANGE ZONES ☐
ABANDON* ☐
(other) Amend 9-331 Gated 04-15-80

SUBSEQUENT REPORT OF:

RECEIVED

APR 20 1980

(NOTE: Report results of multiple completion or zone change on Form 9-330.)

17. DESCRIBE PROPOSED OR COMPLETED OPERATIONS (Clearly state all pertinent details and give pertinent dates including estimated date of starting any proposed work. If well is directionally drilled, give subsurface locations and measured and true vertical depths for all markers and zones pertinent to this work.)*

Please amend APD as follows:

1. Item #23: Setting depth of 8-5/8", K-55 casing will be 200 ft. w/150 sacks Class "B" cement w/3% CACL₂. The 4-1/2", K-55 casing will be set w/500 sacks Class "H" cement, 50-50 Pozmix w/2% gel. Circulating medium will be clear water and clay.
2. Estimated tops: San Jose -----Surface
Ojo Alamo -----1480'
Kirtland -----1685'
Fruitland -----1820'
Pic. Cliffs --2070'
- Cliff House -----3605'
Point Lookout ---4305'
Gallup -----5375'

Subsurface Safety Valve: Manu. and Type

Set @ _____ Ft.

18. I hereby certify that the foregoing is true and correct

SIGNED J. Gregory Merrion TITLE Operator DATE 04-29-80

(This space for Federal or State office use)

APPROVED BY _____ TITLE _____
CONDITIONS OF APPROVAL, IF ANY:

DATE APPROVED
AS AMENDED
JUL 1 1980
James F. Sims
DISTRICT ENGINEER

*See Instructions on Reverse Side

WMOCC