

JICARILLA APACHE TRIBE
ENVIRONMENTAL PROTECTION OFFICE
P.O. BOX 507
DULCE, NEW MEXICO 87528

BT677 sep-ok
SUBMIT 1 COPY TO
NATURAL RESOURCE DEPT
AND OIL & GAS ADMINISTRATION

RECEIVED
AUG 16 1999

OIL CON. DIV.
DIST. 3

PIT REMEDIATION AND CLOSURE REPORT

Operator: AMOCO PRODUCTION COMPANY Telephone: (505) 326-9200
Address: 200 Amoco Court, Farmington, NM 87401
Facility or Well Name: JICARILLA CONTRACT # 146 - 36
Location: Unit or Qtr/Qtr Sec A Sec 4 T 35N R 5W County RIO ARriba
Pit Type: Separator Dehydrator Other BLOW
Land Type: RANGE

Pit Location: Pit dimensions: length 55', width 45', depth 18'
(Attach diagram) Reference: wellhead X, other
Footage from reference: 285'
Direction from reference: 88 Degrees X East of North
West of South X

Depth To Groundwater: (Vertical distance from contaminants to seasonal high water elevation of groundwater)	Less than 50 feet 50 feet to 99 feet Greater than 100 feet	(20 points) (10 points) (0 points)	<u>0</u>
Distance to an Ephemeral Stream (Downgradient dry wash greater than ten feet in width)	Less than 100 feet Greater than 100 feet	(10 points) (0 points)	<u>0</u>
Distance to Nearest Lake, Playa, or Watering Pond (Downgradient lakes, playas and livestock or wildlife watering ponds)	Less than 100 feet Greater than 100 feet	(10 points) (0 points)	<u>0</u>
Wellhead Protection Area: (Less than 200 feet from a private domestic water source, or: less than 1000 feet from all other water sources)	Yes No	(20 points) (0 points)	<u>0</u>
Distance To SurfaceWater: (Horizontal distance to perennial lakes, ponds, rivers, streams, creeks, irrigation canals and ditches)	Less than 100 feet 100 feet to 1000 feet Greater than 1000 feet	(20 points) (10 points) (0 points)	<u>0</u>

RANKING SCORE (TOTAL POINTS): 0

81677 Blow PIT

Date Remediation Started: _____ Date Completed: 10/27/98

Remediation Method: Excavation ☒ Approx. cubic yards 825
 Check all appropriate sections) Landfarmed ☒ Insitu Bioremediation _____

Other _____

Remediation Location: Onsite ☒ Offsite ☒ TICA CONTR. 146-20 (A-4-25-5)
 (i.e. landfarmed onsite, name and location of offsite facility) (APPROX. 700 C.Y.)

General Description of Remedial Action: Excavation

Groundwater Encountered: No ☒ Yes _____ Depth _____

Final Pit: Sample location see Attached Documents
 Closure Sampling: _____
 (if multiple samples, attach sample results and diagram of sample locations and depths) Sample depth 18' (PIT BOTTOM)
 Sample date 10/23/98 Sample time 1130

Sample Results

Soil: Benzene	(ppm)	_____	Water: Benzene	(ppb)	_____
Total BTEX	(ppm)	_____	Toluene	(ppb)	_____
Field Headspace	(ppm)	<u>48.5</u>	Ethylbenzene	(ppb)	_____
TPH	(ppm)	<u>0.3</u>	Total Xylenes	(ppb)	_____

Groundwater Sample: Yes _____ No ☒ (If yes, attach sample results)

I HEREBY CERTIFY THAT THE INFORMATION ABOVE IS TRUE AND COMPLETE TO THE BEST OF MY KNOWLEDGE AND BELIEF

DATE 10/27/98 PRINTED NAME Buddy D. Shaw
 SIGNATURE Buddy D. Shaw AND TITLE Environmental Coordinator

AFTER REVIEW OF THE PIT CLOSURE INFORMATION, PIT CLOSURE IS APPROVED IN ACCORDANCE TO THE JICARILLA APACHE TRIBE PIT CLOSURE ORDINANCE.

APPROVED: YES ☒ NO _____ (REASON) _____

SIGNED: Ken C. Mamm DATE: 12-28-98

CLIENT: <u>AMOCO</u>	BLAGG ENGINEERING, INC. P.O. BOX 87, BLOOMFIELD, NM 87413 (505) 632-1199	LOCATION NO: <u>81677</u> C.D.C. NO: <u>6319</u>																																
FIELD REPORT: CLOSURE VERIFICATION		PAGE No: <u>1</u> of <u>1</u>																																
LOCATION: NAME <u>JICA CONT 146</u> WELL #: <u>36</u> PIT: <u>BLOW</u> QUAD/UNIT: <u>A SEC: 4</u> TWP: <u>25N</u> RNG: <u>SW</u> PM: <u>NM</u> CNTY: <u>RA</u> ST: <u>NM</u> QTR/FOOTAGE: <u>NE/4 NE/4</u> CONTRACTOR: <u>PALL</u>		DATE STARTED: _____ DATE FINISHED: <u>10/23/98</u> ENVIRONMENTAL SPECIALIST: <u>JCC</u>																																
EXCAVATION APPROX. <u>55</u> FT. x <u>45</u> FT. x <u>13</u> FT. DEEP. CUBIC YARDAGE: <u>825</u> DISPOSAL FACILITY: <u>ONSITE / JICA CONTR. 146-20</u> REMEDIATION METHOD: <u>LANDFILL</u> LAND USE: <u>RANGE</u> LEASE: <u>JICA CONT 146</u> FORMATION: _____																																		
FIELD NOTES & REMARKS: PIT LOCATED APPROXIMATELY <u>285</u> FT. <u>S 83° E</u> FROM WELLHEAD. DEPTH TO GROUNDWATER: <u>>100</u> NEAREST WATER SOURCE: <u>>1000</u> NEAREST SURFACE WATER: <u>>1000</u> NMOCB RANKING SCORE: <u>0</u> NMOCB TPH CLOSURE STD: <u>5,000</u> PPM SOIL AND EXCAVATION DESCRIPTION:																																		
<p><u>Gr. Brown to black, silty, firm silty</u> <u>soil. no HC stain, minor odor on samples.</u></p>																																		
<div style="display: flex; justify-content: space-between;"> <div style="width: 30%;"> <p><u>CLOSED</u></p> <p>SCALE</p> <p>0 FT</p> </div> <div style="width: 40%;"> <p>FIELD 418.1 CALCULATIONS</p> <table border="1" style="width:100%; border-collapse: collapse;"> <thead> <tr> <th>TIME</th> <th>SAMPLE I.D.</th> <th>LAB No:</th> <th>WEIGHT (g)</th> <th>mL. FREON</th> <th>DILUTION</th> <th>READING</th> <th>CALC. ppm</th> </tr> </thead> <tbody> <tr><td> </td><td> </td><td> </td><td> </td><td> </td><td> </td><td> </td><td> </td></tr> <tr><td> </td><td> </td><td> </td><td> </td><td> </td><td> </td><td> </td><td> </td></tr> <tr><td> </td><td> </td><td> </td><td> </td><td> </td><td> </td><td> </td><td> </td></tr> </tbody> </table> </div> <div style="width: 25%;"> <p>CHECK ONE:</p> <p><input checked="" type="checkbox"/> PIT ABANDONED</p> <p><input type="checkbox"/> STEEL TANK INSTALLED</p> <p><input type="checkbox"/> FIBERGLASS TANK INSTALLED</p> </div> </div>			TIME	SAMPLE I.D.	LAB No:	WEIGHT (g)	mL. FREON	DILUTION	READING	CALC. ppm																								
TIME	SAMPLE I.D.	LAB No:	WEIGHT (g)	mL. FREON	DILUTION	READING	CALC. ppm																											
<p>PIT PERIMETER</p>	<p>OVM RESULTS</p> <table border="1" style="width:100%; border-collapse: collapse;"> <thead> <tr> <th>SAMPLE ID</th> <th>FIELD HEADSPACE PID (ppm)</th> </tr> </thead> <tbody> <tr><td>1N@ 15'</td><td>4.4</td></tr> <tr><td>2E@ 15'</td><td>38.5</td></tr> <tr><td>3S@ 15'</td><td>8.8</td></tr> <tr><td>4W@ 15'</td><td>15.4</td></tr> <tr><td>5C@ 18'</td><td>48.3</td></tr> </tbody> </table>	SAMPLE ID	FIELD HEADSPACE PID (ppm)	1N@ 15'	4.4	2E@ 15'	38.5	3S@ 15'	8.8	4W@ 15'	15.4	5C@ 18'	48.3	<p>PIT PROFILE</p>																				
SAMPLE ID	FIELD HEADSPACE PID (ppm)																																	
1N@ 15'	4.4																																	
2E@ 15'	38.5																																	
3S@ 15'	8.8																																	
4W@ 15'	15.4																																	
5C@ 18'	48.3																																	
<p>LAB SAMPLES</p> <table border="1" style="width:100%; border-collapse: collapse;"> <thead> <tr> <th>SAMPLE ID</th> <th>ANALYSIS</th> <th>TIME</th> </tr> </thead> <tbody> <tr> <td>5 C@ 18'</td> <td>TPH 8015</td> <td>11:30</td> </tr> </tbody> </table> <p style="text-align: center;"><u>PASSED</u></p>			SAMPLE ID	ANALYSIS	TIME	5 C@ 18'	TPH 8015	11:30																										
SAMPLE ID	ANALYSIS	TIME																																
5 C@ 18'	TPH 8015	11:30																																
TRAVEL NOTES: CALLOUT: _____ ONSITE: _____																																		

ENVIROTECH LABS

PRACTICAL SOLUTIONS FOR A BETTER TOMORROW

EPA METHOD 8015 Modified Nonhalogenated Volatile Organics Total Petroleum Hydrocarbons

Client:	Blagg / AMOCO	Project #:	04034-10
Sample ID:	Blow C @ 18'	Date Reported:	10-27-98
Laboratory Number:	E097	Date Sampled:	10-23-98
Chain of Custody No:	6319	Date Received:	10-26-98
Sample Matrix:	Soil	Date Extracted:	10-26-98
Preservative:	Cool	Date Analyzed:	10-26-98
Condition:	Cool and Intact	Analysis Requested:	8015 TPH

Parameter	Concentration (mg/Kg)	Det. Limit (mg/Kg)
Gasoline Range (C5 - C10)	ND	0.2
Diesel Range (C10 - C28)	0.3	0.1
Total Petroleum Hydrocarbons	0.3	0.2

ND - Parameter not detected at the stated detection limit.

References: Method 8015B, Nonhalogenated Volatile Organics, Test Methods for Evaluating Solid Waste, SW-846, USEPA, December 1996.

Comments: Jicarilla Contract 146 Well 36.

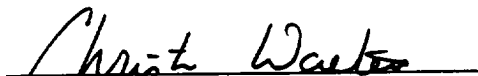
Analyst

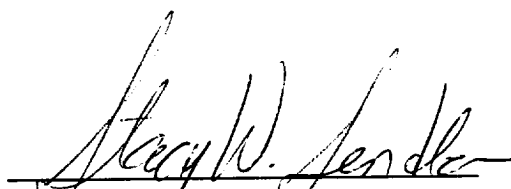
Review

**JICARILLA APACHE TRIBE
ENVIRONMENTAL PROTECTION OFFICE
P.O. BOX 507
DULCE, NEW MEXICO 87528**

BJ677

SUBMIT 1 COPY TO
NATURAL RESOURCE DEPT
AND OIL & GAS ADMINISTRATION

PIT REMEDIATION AND CLOSURE REPORT

Operator: AMOCO PRODUCTION COMPANY **Telephone:** (505) 326-9200
Address: 200 Amoco Court, Farmington, NM 87401
Facility or Well Name: JICARILLA CONTRACT # 146 - 36
Location: Unit or Qtr/Qtr Sec A Sec 4 T 25N R 5W County RIO ARRIBA
Pit Type: Separator ☒ Dehydrator ☐ Other ☐
Land Type: RANGE

Pit Location:
(Attach diagram)

Pit dimensions: length 30', width 18', depth 20'
Reference: wellhead ☒, other ☐
Footage from reference: 170'
Direction from reference: 64 Degrees ☒ East of North ☒
West of South ☐

Depth To Groundwater:

(Vertical distance from
contaminants to seasonal
high water elevation of
groundwater)

Less than 50 feet	(20 points)	
50 feet to 99 feet	(10 points)	
Greater than 100 feet	(0 points)	<u>0</u>

Distance to an Ephemeral Stream

(Downgradient dry wash greater than
ten feet in width)

Less than 100 feet	(10 points)	
Greater than 100 feet	(0 points)	<u>0</u>

Distance to Nearest Lake, Playa, or Watering Pond

(Downgradient lakes, playas and
livestock or wildlife watering ponds)

Less than 100 feet	(10 points)	
Greater than 100 feet	(0 points)	<u>0</u>

Wellhead Protection Area:

(Less than 200 feet from a private
domestic water source, or: less than
1000 feet from all other water sources)

Yes	(20 points)	
No	(0 points)	<u>0</u>

Distance To Surface Water:

(Horizontal distance to perennial
lakes, ponds, rivers, streams, creeks,
irrigation canals and ditches)

Less than 100 feet	(20 points)	
100 feet to 1000 feet	(10 points)	
Greater than 1000 feet	(0 points)	<u>0</u>

RANKING SCORE (TOTAL POINTS): 0

BJ677

SEP. PIT

Date Remediation Started: _____

Date Completed: 10/27/98Remediation Method: Excavation ☒
Check all appropriate sections) Landfarmed ☒Approx. cubic yards 200

Insitu Bioremediation _____

Other _____

Remediation Location: Onsite ☒ Offsite _____
(i.e. landfarmed onsite,
name and location of
offsite facility)General Description of Remedial Action: ExcavationGroundwater Encountered: No ☒ Yes _____ Depth _____Final Pit: Sample location see Attached Documents
Closure Sampling: _____
(if multiple samples,
attach sample results
and diagram of sample
locations and depths) Sample depth 15' (WEST SIDEWALL)
Sample date 10/23/98 Sample time 1240

Sample Results

Soil: Benzene	(ppm)	<u>1,930</u>	Water: Benzene	(ppb)	_____
Total BTEX	(ppm)	<u>36,020</u>	Toluene	(ppb)	_____
Field Headspace	(ppm)	<u>281</u>	Ethylbenzene	(ppb)	_____
TPH	(ppm)	<u>3,560</u>	Total Xylenes	(ppb)	_____

Groundwater Sample: Yes _____ No ☒ (If yes, attach sample results)

I HEREBY CERTIFY THAT THE INFORMATION ABOVE IS TRUE AND COMPLETE TO THE BEST OF MY KNOWLEDGE AND BELIEF

DATE 10/27/98 PRINTED NAME Buddy D. Shaw
SIGNATURE Buddy D. Shaw AND TITLE Environmental Coordinator

AFTER REVIEW OF THE PIT CLOSURE INFORMATION, PIT CLOSURE IS APPROVED IN ACCORDANCE TO THE JICARILLA APACHE TRIBE PIT CLOSURE ORDINANCE.

APPROVED: YES ☒ NO _____ (REASON) _____SIGNED: Ken C. McNeill DATE: 12-28-98

CLIENT: <u>AMOCO</u>	BLAGG ENGINEERING, INC. P.O. BOX 87, BLOOMFIELD, NM 87413 (505) 632-1199	LOCATION NO: <u>BJ677</u> C.O.C. NO: <u>6319</u>																																																																																
FIELD REPORT: CLOSURE VERIFICATION		PAGE No: <u>1</u> of <u>1</u>																																																																																
LOCATION: NAME: <u>JIC CONT 146</u> WELL #: <u>36</u> PIT: <u>SEPARATOR</u> QUAD/UNIT: <u>A SEC: 4</u> TWP: <u>25N</u> RNG: <u>5W</u> PM: <u>NM</u> CNTY: <u>RA</u> ST: <u>NM</u> QTR/FDOTAGE: <u>NE/4</u> <u>NE/4</u> CONTRACTOR: <u>PAUL</u>		DATE STARTED: _____ DATE FINISHED: <u>10/23/93</u> ENVIRONMENTAL SPECIALIST: <u>JCB</u>																																																																																
EXCAVATION APPROX. <u>30</u> FT. x <u>18</u> FT. x <u>20</u> FT. DEEP. CUBIC YARDAGE: <u>200</u> DISPOSAL FACILITY: <u>ONSITE</u> REMEDIATION METHOD: <u>LANDFARM</u> LAND USE: <u>RANGE</u> LEASE: <u>JIC CONT 146</u> FORMATION: _____																																																																																		
FIELD NOTES & REMARKS: PIT LOCATED APPROXIMATELY <u>170</u> FT. <u>N64E</u> FROM WELLHEAD. DEPTH TO GROUNDWATER: <u>>100</u> NEAREST WATER SOURCE: <u>>1000</u> NEAREST SURFACE WATER: <u>>1000</u> NMDCD RANKING SCORE: <u>0</u> NMDCD TPH CLOSURE STD: <u>5,000</u> PPM <u>SOIL AND EXCAVATION DESCRIPTION:</u>																																																																																		
<div style="text-align: right;">CHECK ONE:</div> <div style="display: flex; justify-content: flex-end;"> <input checked="" type="checkbox"/> PIT ABANDONED <input type="checkbox"/> STEEL TANK INSTALLED <input type="checkbox"/> FIBERGLASS TANK INSTALLED </div>																																																																																		
<div style="display: flex; justify-content: space-between; align-items: flex-start;"> <div style="width: 30%;"> <p style="text-align: center;">CLOSED</p> <p>SCALE</p> <div style="display: flex; align-items: center;"> <div style="width: 20px; height: 10px; background-color: black; margin-right: 5px;"></div> <div style="border-bottom: 1px solid black; width: 50px; margin-right: 5px;"></div> </div> <p>0 FT</p> <p style="text-align: center;">PIT PERIMETER</p> </div> <div style="width: 40%; text-align: center;"> <p>FIELD 418.1 CALCULATIONS</p> <table border="1" style="width:100%; border-collapse: collapse;"> <thead> <tr> <th>TIME</th> <th>SAMPLE I.D.</th> <th>LAB No:</th> <th>WEIGHT (g)</th> <th>mL. FREON</th> <th>DILUTION</th> <th>READING</th> <th>CALC. ppm</th> </tr> </thead> <tbody> <tr><td> </td><td> </td><td> </td><td> </td><td> </td><td> </td><td> </td><td> </td></tr> <tr><td> </td><td> </td><td> </td><td> </td><td> </td><td> </td><td> </td><td> </td></tr> <tr><td> </td><td> </td><td> </td><td> </td><td> </td><td> </td><td> </td><td> </td></tr> <tr><td> </td><td> </td><td> </td><td> </td><td> </td><td> </td><td> </td><td> </td></tr> </tbody> </table> </div> <div style="width: 30%; text-align: center;"> <p>PIT PROFILE</p> </div> </div> <div style="margin-top: 10px;"> <p style="text-align: center;">OVM RESULTS</p> <table border="1" style="width:100%; border-collapse: collapse;"> <thead> <tr> <th>SAMPLE ID</th> <th>FIELD HEADSPACE PID (ppm)</th> </tr> </thead> <tbody> <tr><td>1N@ 10'</td><td>56</td></tr> <tr><td>2E@ 15'</td><td>194</td></tr> <tr><td>3S@ 18'</td><td>97</td></tr> <tr><td>4W@ 15'</td><td>281</td></tr> <tr><td>5C@ 20'</td><td>155</td></tr> <tr><td> </td><td> </td></tr> <tr><td> </td><td> </td></tr> <tr><td> </td><td> </td></tr> <tr><td> </td><td> </td></tr> <tr><td> </td><td> </td></tr> </tbody> </table> <div style="display: flex; justify-content: space-between; align-items: flex-start;"> <div style="width: 30%;"> <p style="text-align: center;">LAB SAMPLES</p> <table border="1" style="width:100%; border-collapse: collapse;"> <thead> <tr> <th>SAMPLE ID</th> <th>ANALYSIS</th> <th>TIME</th> </tr> </thead> <tbody> <tr> <td>④ W@ 15'</td> <td>TPH/BTEX</td> <td>1240</td> </tr> <tr> <td colspan="3" style="text-align: center;">(Both PASSED)</td> </tr> <tr><td> </td><td> </td><td> </td></tr> <tr><td> </td><td> </td><td> </td></tr> <tr><td> </td><td> </td><td> </td></tr> </tbody> </table> </div> <div style="width: 65%;"> <p>TRAVEL NOTES: CALLOUT: _____ ONSITE: _____</p> </div> </div> </div>			TIME	SAMPLE I.D.	LAB No:	WEIGHT (g)	mL. FREON	DILUTION	READING	CALC. ppm																																	SAMPLE ID	FIELD HEADSPACE PID (ppm)	1N@ 10'	56	2E@ 15'	194	3S@ 18'	97	4W@ 15'	281	5C@ 20'	155											SAMPLE ID	ANALYSIS	TIME	④ W@ 15'	TPH/BTEX	1240	(Both PASSED)											
TIME	SAMPLE I.D.	LAB No:	WEIGHT (g)	mL. FREON	DILUTION	READING	CALC. ppm																																																																											
SAMPLE ID	FIELD HEADSPACE PID (ppm)																																																																																	
1N@ 10'	56																																																																																	
2E@ 15'	194																																																																																	
3S@ 18'	97																																																																																	
4W@ 15'	281																																																																																	
5C@ 20'	155																																																																																	
SAMPLE ID	ANALYSIS	TIME																																																																																
④ W@ 15'	TPH/BTEX	1240																																																																																
(Both PASSED)																																																																																		

ENVIROTECH LABS

PRACTICAL SOLUTIONS FOR A BETTER TOMORROW

EPA METHOD 8015 Modified Nonhalogenated Volatile Organics Total Petroleum Hydrocarbons

Client:	Blagg / AMOCO	Project #:	04034-10
Sample ID:	Sep W @ 15'	Date Reported:	10-27-98
Laboratory Number:	E098	Date Sampled:	10-23-98
Chain of Custody No:	6319	Date Received:	10-26-98
Sample Matrix:	Soil	Date Extracted:	10-26-98
Preservative:	Cool	Date Analyzed:	10-26-98
Condition:	Cool and Intact	Analysis Requested:	8015 TPH

Parameter	Concentration (mg/Kg)	Det. Limit (mg/Kg)
Gasoline Range (C5 - C10)	1,180	0.2
Diesel Range (C10 - C28)	2,380	0.1
Total Petroleum Hydrocarbons	3,560	0.2

ND - Parameter not detected at the stated detection limit.

References: Method 8015B, Nonhalogenated Volatile Organics, Test Methods for Evaluating Solid Waste, SW-846, USEPA, December 1996.

Comments: Jicarilla Contract 146 Well 36.

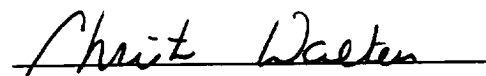
Analyst

Review

ENVIROTECH LABS

PRACTICAL SOLUTIONS FOR A BETTER TOMORROW

EPA METHOD 8021 AROMATIC VOLATILE ORGANICS

Client:	Blagg / Amoco	Project #:	04034-10
Sample ID:	Sep W @ 15'	Date Reported:	10-27-98
Laboratory Number:	E098	Date Sampled:	10-23-98
Chain of Custody:	6319	Date Received:	10-26-98
Sample Matrix:	Soil	Date Analyzed:	10-26-98
Preservative:	Cool	Date Extracted:	10-26-98
Condition:	Cool & Intact	Analysis Requested:	BTEX

Parameter	Concentration (ug/Kg)	Det. Limit (ug/Kg)
Benzene	1,930	8.8
Toluene	9,490	8.4
Ethylbenzene	2,260	7.6
p,m-Xylene	14,030	10.8
o-Xylene	8,310	5.2
Total BTEX	36,020	

ND - Parameter not detected at the stated detection limit.

Surrogate Recoveries:	Parameter	Percent Recovery
	Trifluorotoluene	100 %
	Bromofluorobenzene	100 %

References: Method 5030B, Purge-and-Trap, Test Methods for Evaluating Solid Waste, SW-846, USEPA, December 1996.

Method 8021B, Aromatic Volatile Organics, Test Methods for Evaluating Solid Waste, SW-846, USEPA, December 1996.

Comments: Jicarilla Contract 146 Well 36.

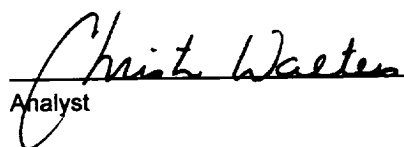
Analyst

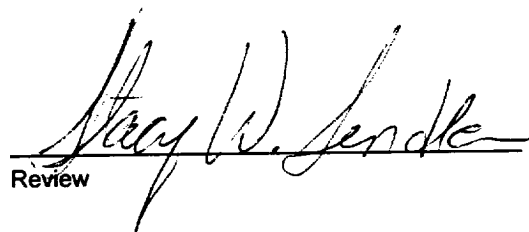
Review

6319

[illegible]

**JICARILLA APACHE TRIBE
ENVIRONMENTAL PROTECTION OFFICE
P.O. BOX 507
DULCE, NEW MEXICO 87528**

SUBMIT 1 COPY TO:
NATURAL RESOURCE DEPT
AND OIL & GAS ADMINISTRATION

ON-SITE SOIL REMEDIATION REPORT

Operator: AMOCO PRODUCTION COMPANY Telephone: (505) 326-9200

Address: 200 Amoco Court, Farmington, NM 87401

Facility or Well Name: JICARILLA CONTRACT 146-36

Location: Unit or Qtr/Qtr Sec A Sec 4 T25N R5W County BIO ARREISA

Land Type: RANGE

Date Remediation Started: 10-23-98 Date Completed: 5/12/99

Remediation Method: Landfarmed ☒ Approx. cubic yards 325

Composted ☐

Other ☐

Depth To Groundwater: (pts.) 0

Distance to an Ephemeral Stream (pts.) 0

Distance to Nearest Lake, Playa, or Watering Pond (pts.) 0

Wellhead Protection Area: (pts.) 0

Distance To Surface Water: (pts.) 0

RANKING SCORE (TOTAL POINTS): 0

Final Closure Sampling:

Sampling Date: 5-11-99 Time: 1210

Sample Results:

Field Headspace (ppm) 95.6

TPH (ppm) 803 Method TPH (8015)

Other ☐

I HEREBY CERTIFY THAT THE INFORMATION ABOVE IS TRUE AND COMPLETE TO THE BEST OF MY KNOWLEDGE AND BELIEF

DATE 5/12/99 PRINTED NAME Buddy D. Shaw

SIGNATURE Buddy D. Shaw AND TITLE Environmental Coordinator

AFTER REVIEW OF THE SOIL REMEDIATION INFORMATION, ON-SITE REMEDIATION IS APPROVED IN ACCORDANCE TO THE JICARILLA APACHE TRIBE PIT CLOSURE ORDINANCE.

APPROVED: YES ☐ NO ☐ (REASON) _____

SIGNED: _____ DATE: _____

CLIENT: <u>AMOCO</u>	BLAGG ENGINEERING, INC. P.O. BOX 87, BLOOMFIELD, NM 87413 (505) 632-1199	LOCATION NO: <u>BS677</u> C.B.C. NO: <u>6918</u>
----------------------	--	---

FIELD REPORT: LANDFARM/COMPOST PILE CLOSURE VERIFICATION

LOCATION: NAME: <u>JICARILLA CONTRACT 146</u> WELL #: <u>36</u>	PITS: <u>SEP., BLOW</u>	DATE STARTED: <u>5.11.99</u>
QUAD/UNIT: <u>A</u> SEC: <u>4</u> TWP: <u>25N</u> RNG: <u>SW</u> PM: <u>NM</u> CNTY: <u>RA</u> ST: <u>NM</u>		DATE FINISHED: _____
QTR/FOOTAGE: <u>NE/4 NE/4</u>	CONTRACTOR: <u>P+S</u>	ENVIRONMENTAL SPECIALIST: <u>BEP</u>

SOIL REMEDIATION:

REMEDICATION SYSTEM: LANDFARM

APPROX. CUBIC YARDAGE: 325

LAND USE: RANGE

LIFT DEPTH (ft): 2'

FIELD NOTES & REMARKS:

DEPTH TO GROUNDWATER: >100' NEAREST WATER SOURCE: >1000' NEAREST SURFACE WATER: >1000'

NMCD RANKING SCORE 0 NMCD TPH CLOSURE STD: 5000 PPM

DK YELLOWISH BROWN SAND, NON COHESIVE, SLIGHTLY MOIST, FIRM.
SMALL AREA OF STAINING OBSERVED IN LANDFARM. (SEE SKETCH BELOW)
NO. ODOR DETECTED IN SAMPLING PTS. ② + ③. SAMPLING DEPTHS RANGE FROM 6" - 18" COLLECTED A 5PT COMPOSITE SAMPLE FOR LAB ANALYSIS

CLOSED

FIELD 418.1 CALCULATIONS

SAMP. TIME	SAMPLE I.D.	LAB No:	WEIGHT (g)	mL. FREON	DILUTION	READING	CALC. ppm

NOTE: SOME OF THE SOIL WAS MOVED TO THE 146 20 AND LANDFARMED

APPROX.
700 C.Y

SKETCH/SAMPLE LOCATIONS

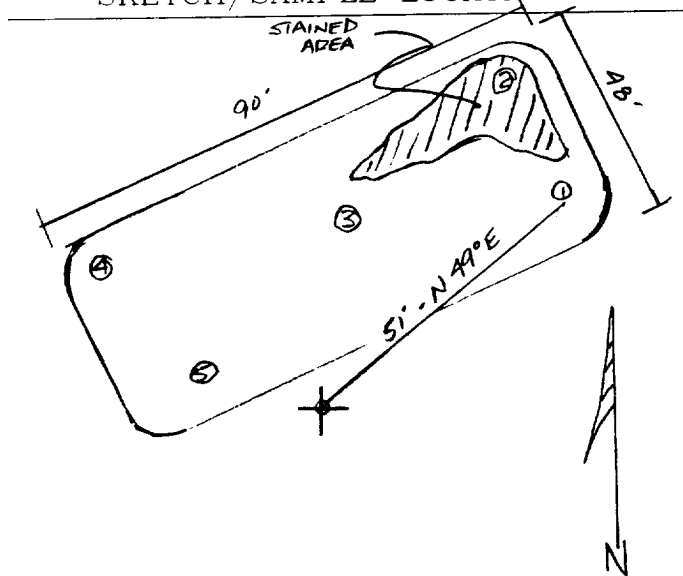

OVM RESULTS

LAB SAMPLES

SAMPLE ID	FIELD HEADSPACE PID (ppm)	SAMPLE ID	ANALYSIS	TIME	RESULTS
LF-1	95.4	LF-1	TPH (8015)	1210	803

SCALE



TRAVEL NOTES

CALLOUT: NA

ONSITE: 5 11 99

ENVIROTECH LABS

PRACTICAL SOLUTIONS FOR A BETTER TOMORROW

EPA METHOD 8015 Modified Nonhalogenated Volatile Organics Total Petroleum Hydrocarbons

Client:	Blagg / AMOCO	Project #:	403410
Sample ID:	LF - 1	Date Reported:	05-12-99
Laboratory Number:	F204	Date Sampled:	05-11-99
Chain of Custody No:	6918	Date Received:	05-12-99
Sample Matrix:	Soil	Date Extracted:	05-12-99
Preservative:	Cool	Date Analyzed:	05-12-99
Condition:	Cool and Intact	Analysis Requested:	8015 TPH

Parameter	Concentration (mg/Kg)	Det. Limit (mg/Kg)
Gasoline Range (C5 - C10)	84.4	0.2
Diesel Range (C10 - C28)	719	0.1
Total Petroleum Hydrocarbons	803	0.2

ND - Parameter not detected at the stated detection limit.

References: Method 8015B, Nonhalogenated Volatile Organics, Test Methods for Evaluating Solid Waste, SW-846, USEPA, December 1996.

Comments: Jicarilla Contract 146 - 36 Landfarm. 5 Pt. Composite.

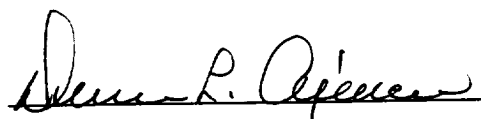
Analyst

Review

CHAIN OF CUSTODY RECORD

6918

Client / Project Name BALGA/Amoco			Project Location CAUDFEAR			ANALYSIS / PARAMETERS									
Client No. 403410			Remarks												
Sampler: REP			No. of Containers TPH (8015)												
Sample No./ Identification	Sample Date	Sample Time	Lab Number	Sample Matrix											
LE-1	5/19/99	1210	F204	SOIL	1					✓					
				ST. CONTAINER											
				SAMPLE PASSPORT											
				COOL											
Relinquished by: (Signature) <i>[Signature]</i>			Date	Time	Received by: (Signature) <i>[Signature]</i>					Date	Time				
Relinquished by: (Signature) <i>[Signature]</i>					Received by: (Signature) <i>[Signature]</i>										
Relinquished by: (Signature)			Received by: (Signature)												

ENVIROTECH INC.

5796 U.S. Highway 64
Farmington, New Mexico 87401
(505) 632-0615

Sample Receipt

Received Intact	Y	N	N/A
Cool - Ice/Blue Ice	✓		