

UNITED STATES  
DEPARTMENT OF THE INTERIOR

## GEOLOGICAL SURVEY

## APPLICATION FOR PERMIT TO DRILL, DEEPEN, OR PLUG BACK

## 1a. TYPE OF WORK

DRILL ☒DEEPEN ☐PLUG BACK ☐

## b. TYPE OF WELL

OIL  
WELL ☒GAS  
WELL ☒

OTHER

SINGLE  
ZONE ☐MULTIPLE  
ZONE ☒

## 2. NAME OF OPERATOR

GETTY OIL COMPANY

## 3. ADDRESS OF OPERATOR

P. O. Box 3360, Casper, Wyoming 82602

## 4. LOCATION OF WELL (Report location clearly and in accordance with any State requirements.)\*

At surface

1830' FSL 790' FWL (NWSW)

At proposed prod. zone Same

## 14. DISTANCE IN MILES AND DIRECTION FROM NEAREST TOWN OR POST OFFICE\*

117 miles Southeasterly from Aztec

## 15. DISTANCE FROM PROPOSED\*

LOCATION TO NEAREST  
PROPERTY OR LEASE LINE, FT.  
(Also to nearest drilg. unit line, if any)

790'

## 16. NO. OF ACRES IN LEASE

? 2540 2560

17. NO. OF ACRES ASSIGNED  
TO THIS WELL

39.93

W / 319.60

18. DISTANCE FROM PROPOSED LOCATION\*  
TO NEAREST WELL, DRILLING, COMPLETED,  
OR APPLIED FOR, ON THIS LEASE, FT.

## 19. PROPOSED DEPTH

7150'

## 20. ROTARY OR CABLE TOOLS

Rotary

## 21. ELEVATIONS (Show whether DF, RT, GR, etc.)

6762' GR

## 22. APPROX. DATE WORK WILL START\*

Oct. 1, 1980

23

## PROPOSED CASING AND CEMENTING PROGRAM

SIZE OF HOLE	SIZE OF CASING	WEIGHT PER FOOT	SETTING DEPTH	QUANTITY OF CEMENT
12-1/4	8-5/8	New 24#	350	200 sx
7-7/8	5-1/2	New 14#	5200	1150 sx *
7-7/8	5-1/2	New 15.5#	7150	

\* Cement volume will depend on hole size and caliper calculate from logs

Ten (10) point resource protection plan attached.

APPROVED  
AS AMENDED

OCT 01 1980

JAMES F. SIMS  
DISTRICT ENGINEER

RECEIVED

SEP 17 1980

U. S. GEOLOGICAL SURVEY  
FARMINGTON, N. M.

8. ABOVE SPACE DESCRIBE PROPOSED PROGRAM: If proposal is to deepen or plug back, give data on present productive zone and proposed new productive zone. If proposal is to drill or deepen directionally, give pertinent data on subsurface locations and measured and true vertical depths. Give blowout preventer program, if any.

14.

SIGNATURE

H. E. Aab

TITLE

Area Supt.

DATE September 9, 1980

(This space for Federal or State office use)

PERMIT NO.

APPROVAL DATE

APPROVED BY

TITLE

DATE

CONDITIONS OF APPROVAL, IF ANY:

\*See Instructions On Reverse Side

All distances must be from the outer boundaries of the Section.

Operator <b>GETTY OIL COMPANY</b>			Lease <b>JICARILLA B</b>			Well No. <b>20E</b>		
Unit Letter <b>L</b>	Section <b>31</b>	Township <b>25N</b>	Range <b>5W</b>	County <b>Rio Arriba</b>				
Actual Footage Location of Well: <b>1330</b> feet from the <b>South</b> line and <b>790</b> feet from the <b>West</b> line								
Ground Level Elev. <b>6762</b>	Producing Formation <b>Dakota &amp; Gallup</b>		Pool <b>Basin Dakota &amp; Otero Gallup</b>			Dedicated Acreage <b>319.60</b>		<b>39.93</b> Acres

1. Outline the acreage dedicated to the subject well by colored pencil or hachure marks on the plat below.
2. If more than one lease is dedicated to the well, outline each and identify the ownership thereof (both as to working interest and royalty).
3. If more than one lease of different ownership is dedicated to the well, have the interests of all owners been consolidated by communitization, unitization, force-pooling, etc?

☐ Yes ☐ No If answer is "yes," type of consolidation \_\_\_\_\_

If answer is "no," list the owners and tract descriptions which have actually been consolidated. (Use reverse side of this form if necessary.) \_\_\_\_\_

No allowable will be assigned to the well until all interests have been consolidated (by communitization, unitization, forced-pooling, or otherwise) or until a non-standard unit, eliminating such interests, has been approved by the Commission.

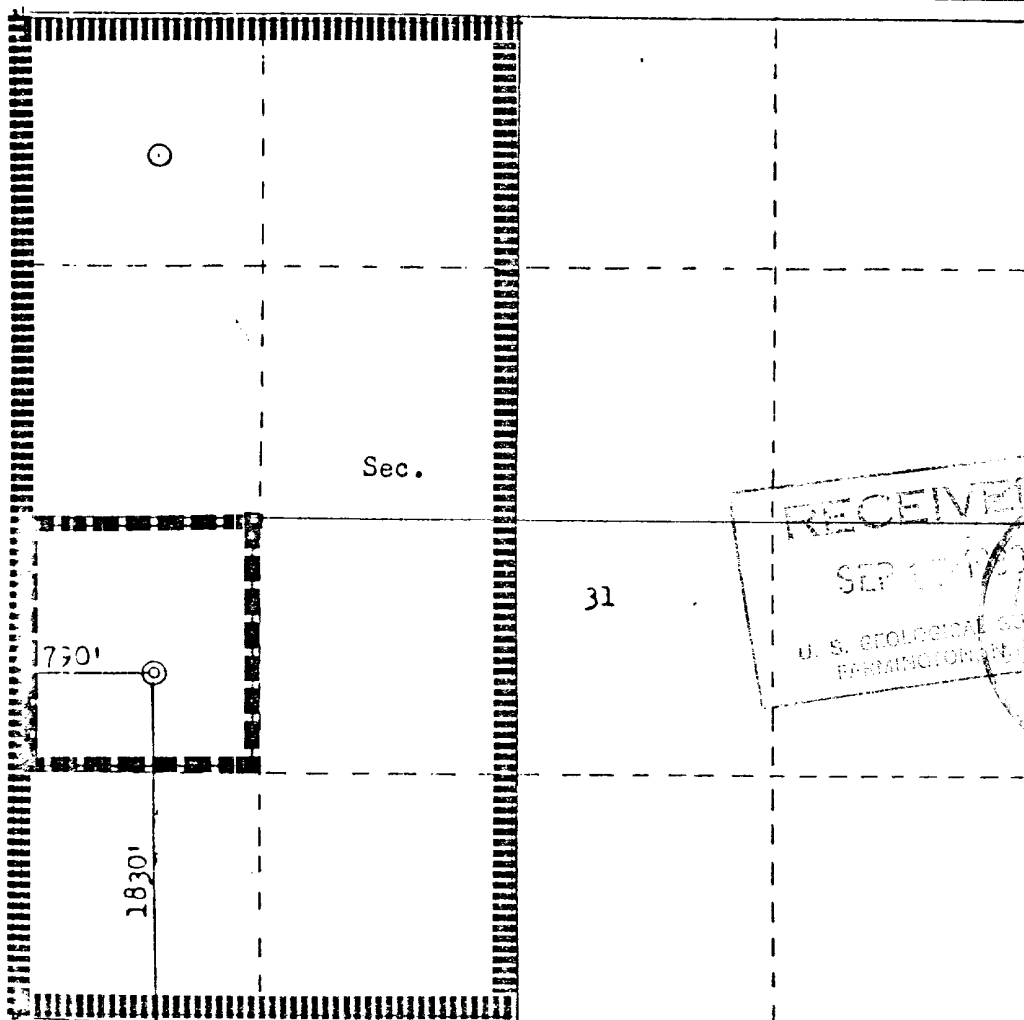

CERTIFICATION

I hereby certify that the information contained herein is true and complete to the best of my knowledge and belief.

Name  
*Al Kendrick*  
Position  
**Agent**  
Company  
**Getty Oil Company**  
Date  
**9/12/80**

I hereby certify that the well location shown on this plat was plotted from field notes of actual surveys made by me or under my supervision, and that the same is true and correct to the best of my knowledge and belief.

Date Surveyed  
**August 1980**  
Registered Professional Engineer and Land Surveyor  
*Fred Hickern Jr.*  
Certificate No. **3950**



## DRILLING PROGNOSIS

Jiarilla "B" #20E

NWSW Section 31, T25N, R5W  
Rio Arriba Co., NM

### 1. SURFACE FORMATION:

Unnamed sand and shale

### 2 & 3. ESTIMATED TOPS AND ANTICIPATED OIL, GAS AND WATER ZONES:

<del>050 A18MO</del>	<del>1548</del>	
<del>Kirelud</del>	<del>2250</del>	
Pictured Cliffs	2619' - 2699'	
Lewis	2699' - 4219'	
Mesaverde	4219' - 5020'	
Mancos	5020' - 5866'	
Gallup	5866' - 6326'	Oil
Greenhorn	6804' - 6864'	
Dakota	6899' - 7150'	Gas

If any water zones are encountered they will be adequately protected and reported, none anticipated.

### 4. CASING PROGRAM: (All New)

Hole Size	Interval	Section Length	Size	Weight, Grade & Joint
12 1/4"	0-350'	350'	8 5/8"	24.0#, K-55 8rd-ST&C
7 7/8"	0-5200'	5200'	5 1/2"	14.0#, K-55 8rd-ST&C
7 7/8"	5200'-7150'	1950'	5 1/2"	15.5#, K-55 8rd-LT&C

### 5. PRESSURE CONTROL EQUIPMENT:

Schematic attached.

Type: 9 or 10" - 900 Series - Double Gate  
Pressure Rating: 3000 psi  
Testing Procedure: Equipment will be pressure tested to 1500 psi prior to drilling out from under surface and operational checks will be made daily and recorded on tour sheet.

### 6. MUD PROGRAM: (Visual Monitoring)

Interval	Mud Type	Mud Wt (ppg)	Viscosity(sec/qt)	W.L.	Additives
0'-350'	Gel/Lime	8.4-9.0	30-45	NC	Gel/Lime
350'-5600'	Gel/Lime	8.4-8.9	30-32	NC	Gel/Lime
5600'-7150'	LSND	8.4-9.2	34-38	10	Gel, Starch, CMC

Sufficient mud inventory will be maintained on location during drilling.

7. AUXILIARY EQUIPMENT:

1. A Kelly cock will be kept in the string at all times.
2. Periodic checks will be made each tour of the mud system.
3. A stabbing valve will be kept on the derrick floor to be stabbed into the drill pipe whenever the Kelly is not in the string.
4. No bit float will be used.

3. EVALUATION PROGRAM:

Logs: Dual Induction-SFL-Base of surface casing to T.D.  
Detail Scale 5" = 100', 2550' - 2700', 5750' to T.D.  
Compensated Neutron-Formation Density-2550'-2700', 5750' to T.D.  
Gamma continued to surface.  
DST's: None  
Cores: None

9. ABNORMAL CONDITIONS:

It is not anticipated that abnormal temperatures, pressures or toxic gases will be encountered.

10. DRILLING ACTIVITY:

Anticipated commencement date: October 1, 1980

Required drilling days: Approximately 18

Required completion days: Approximately 15

GETTY OIL COMPANY

Jicarilla B #20E  
NWSW, L, Section 31, T25N, R5W  
Rio Arriba County, New Mexico

13 POINT SURFACE USE PLAN

1. Existing Roads Map A (shown in RED)
  - A. Survey Plat attached. (Actual staking includes 2 - 200' reference stakes)
  - B. Approximately 13 miles north northeast of Counselors Trading Post, N.M.
  - C. Refer to Map A.
  - D. Refer to Map A.
  - E. The existing roads are maintained by the petroleum industry for access to existing wells in the area.
2. Planned Access Road Refer to Map A (shown in Green)

The location is approximately 300 feet south of the existing road.

  1. Width - 20' flat bladed
  2. Maximum grade - 6% or less
  3. Turnouts - none
  4. Drainage design - will follow the existing drainage
  5. Culverts - none deemed necessary
  6. Surface materials - none deemed necessary
  7. Cattleguards - none needed
  8. New access road will be flagged.
3. Location of Existing Wells in This Section
  - A. Water wells - none
  - B. Abandoned wells - none
  - C. Temporarily abandoned wells - Jicarilla B #9, SWSE, Otero Gallup Pool
  - D. Disposal wells - none
  - E. Drilling wells - none
  - F. Producing wells - shown on Map B
  - G. Shut in wells - Jicarilla B #20, NWNW, Otero Gallup Pool
  - H. Injection wells - none
  - I. Monitoring or Observation wells - none
4. Location of Existing or Proposed Facilities
  - A. Existing within this section
    1. Tank batteries - one tank @ Jicarilla B #20, NWNW
    2. Producing Facilities - one separator @ Jicarilla B #20, NWNW
    3. Oil Gathering Lines - See Map C
    4. Gas Gathering Lines - See Map B for El Paso Natural Gas Co. line.
    5. Injection Lines - none
    6. Disposal Lines - none



B. New Facilities Contemplated

1. Tank will be set on this location for Dakota Production. This will necessitate a separator and dehydrator also on location.
2. Tank will probably be one 400 barrel tank and with separator will occupy a space about 100' X 130'.
3. Tank pad will be constructed of native materials.
4. The Gallup oil production will be pipeline transported to the existing tank battery in the north half of Section 32.
5. Pumping unit, if needed, and pit will be fenced.

C. Rehabilitation

Rehabilitation of disturbed areas no longer needed for operations will be accomplished by grading, leveling, and reseeding as agreed upon at the time with the surface owner's representative.

5. Location and Type of Water Supply

- A. Water will be used from the existing water hole in Larga Canyon located in the NW/4 Section 15, T24N, R5W, being approximately 7 road miles from this location.
- B. Water will be trucked to the location.
- C. No water well will be needed at this location.

6. Source of Construction Materials

All fill materials will be taken from the excess spoil from the required construction of this location.

7. Methods for Handling Waste Disposal

- A. Cuttings will be retained in the reserve pit.
- B. Drilling fluids will be contained in a reserve pit or steel pits until the well is completed.
- C. Oil will be collected in tanks. Little or no water is anticipated at this location. If volume of oil is sufficient, it will be trucked from the location.
- D. A portable toilet will be provided.
- E. A fenced burn pit will be provided for trash. This pit will be enclosed with small mesh wire. The reserve pit will be fenced on three sides. The fourth side will be fenced when the rig is off location.
- F. Location and mud pits will be regraded and seeded as soon as feasible after the well is completed. The area will be cleaned of all debris.





8. Ancilliary Facilities

No camps or airstrips are planned.

9. Well Site Layout

- A. Refer to Rig Layout Sheet.
- B. Refer to Rig Detail Sheet.
- C. Refer to Rig Detail Sheet.
- D. The pits will not be lined.

10. Surface Restoration Plan

- A. In the event of a dry hole, pits will be allowed to dry and will then be backfilled. The location will be restored to as near the original contour as feasible, then seeded. Spoil materials will be segregated and either burned or buried.
- B. Revegetation will be achieved by seeding with a mixture approved by a representative of the surface owner.
- C. Pits will be fenced at time of rig release and until area is recontoured.
- D. Overhead flagging will be installed if oil is in or on pit.
- E. Rehabilitation operations will begin as soon as practical after the rig is off location and should be completed before winter 1981.

11. Other Information

- A. The area is gentle rolling hills being a sandy, clayey loam, gray-brown in color and covered with native grasses and sagebrush with some juniper and pinon trees. The fauna consists of native birds, mule deer, coyotes and rodents.
- B. The surface owner is the Jicarilla Apache Tribe of Indians.
- C. The natural drainage is southwesterly to Largo Canyon which is about three miles away. There are no occupied dwellings, archeological, historical or cultural sites visible on this location.

12. Operator's Representatives

Paul Berhost  
Farmington, New Mexico  
Phone (505) 325-9682  
327-3622

H. E. Aab  
Casper, Wyoming  
Phone (307) 265-8386

13. Certification

I hereby certify that I have inspected the proposed drillsite and access route; that I am familiar with the conditions which presently exist; that the statements made in this plan are to the best of my knowledge true and correct; and the work associated with the operations proposed herein will be performed by GETTY OIL COMPANY and its contractors and subcontractors in conformity with this plan and the terms and conditions under which it is approved.

Date

9/16/80  
A. R. Kendrick, Consultant



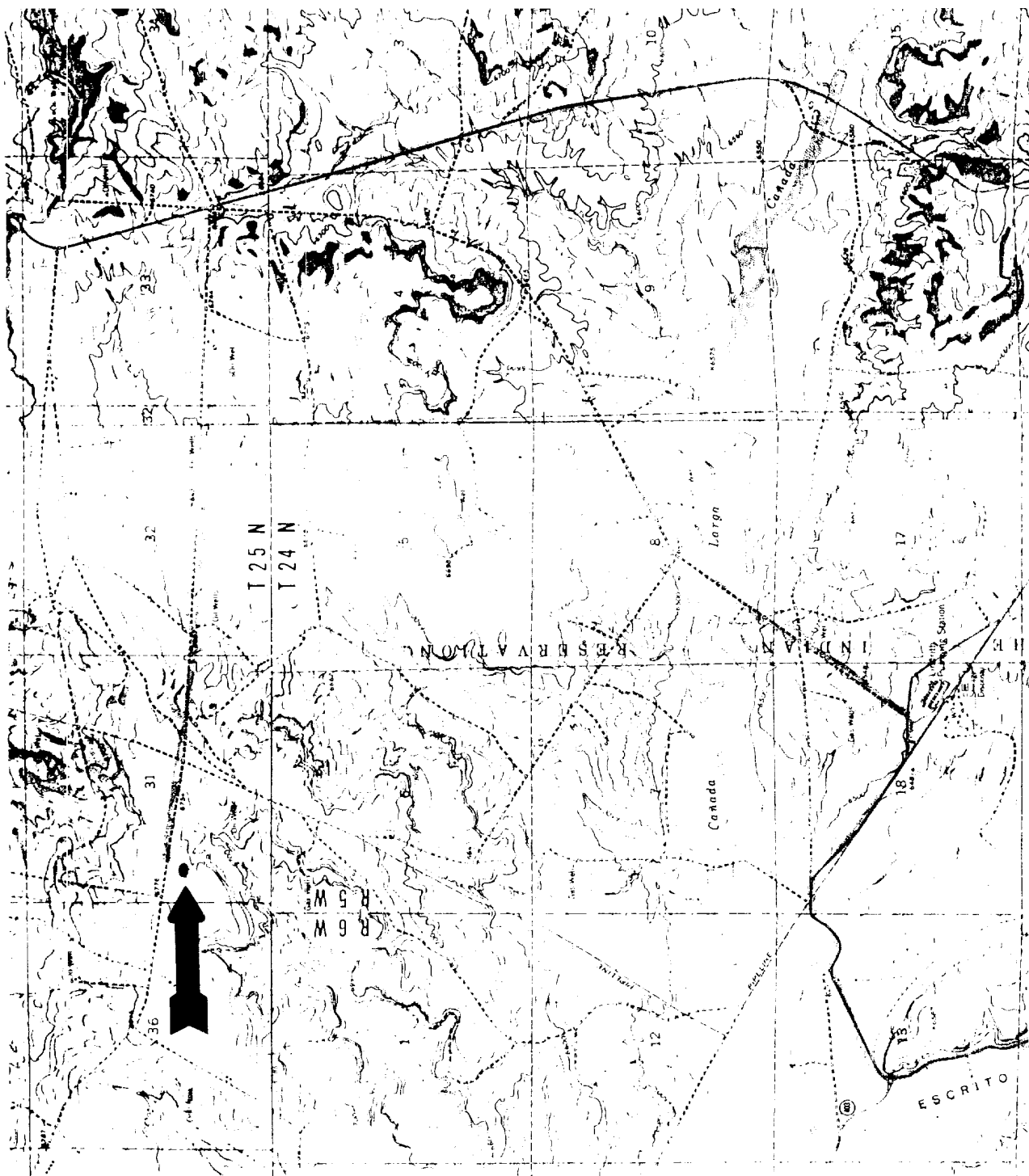

7

Vicinity Map for  
 GETTY OIL COMPANY  
 JICARILLA B #20E  
 1830' FSL, 790' FWL  
 Sec. 31, T25N, R5W  
 Rio Arriba County, New Mexico





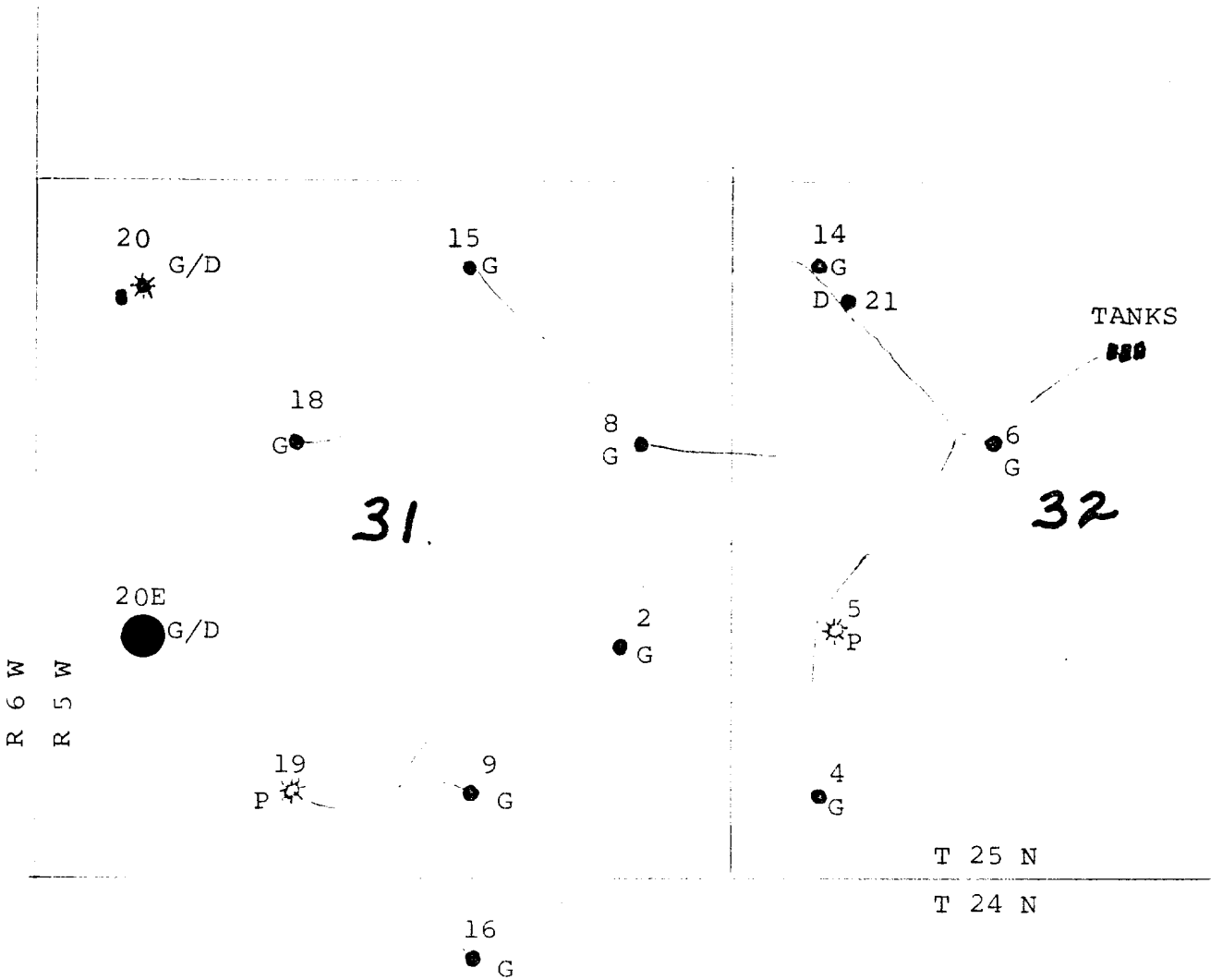

OIL PIPELINES  
 GETTY OIL COMPANY  
 JICARILLA B LEASE  
 Sec. 31, T25N, R5W





BLOWOUT PREVENTER DIAGRAM  
3000# W.P.

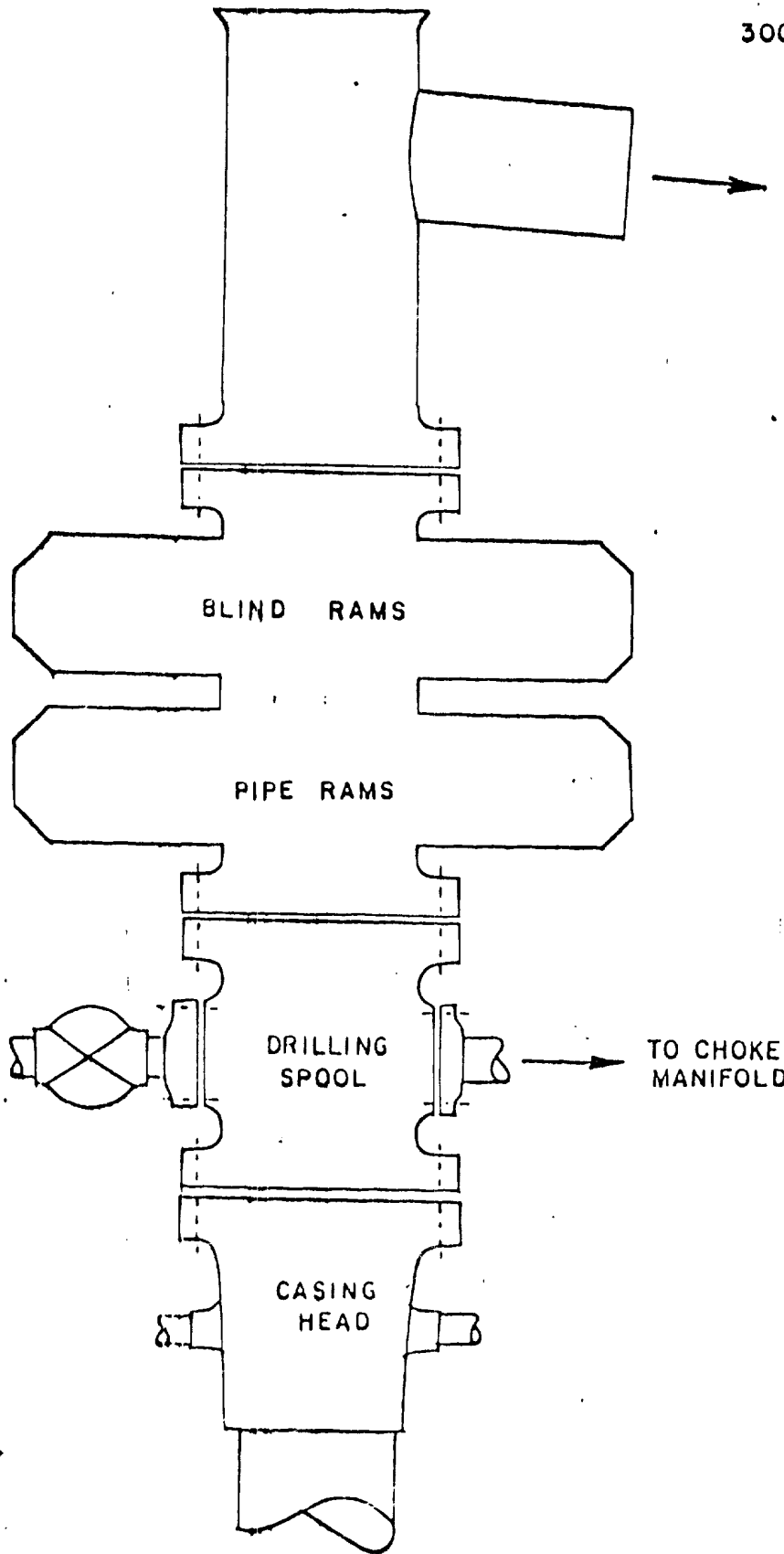



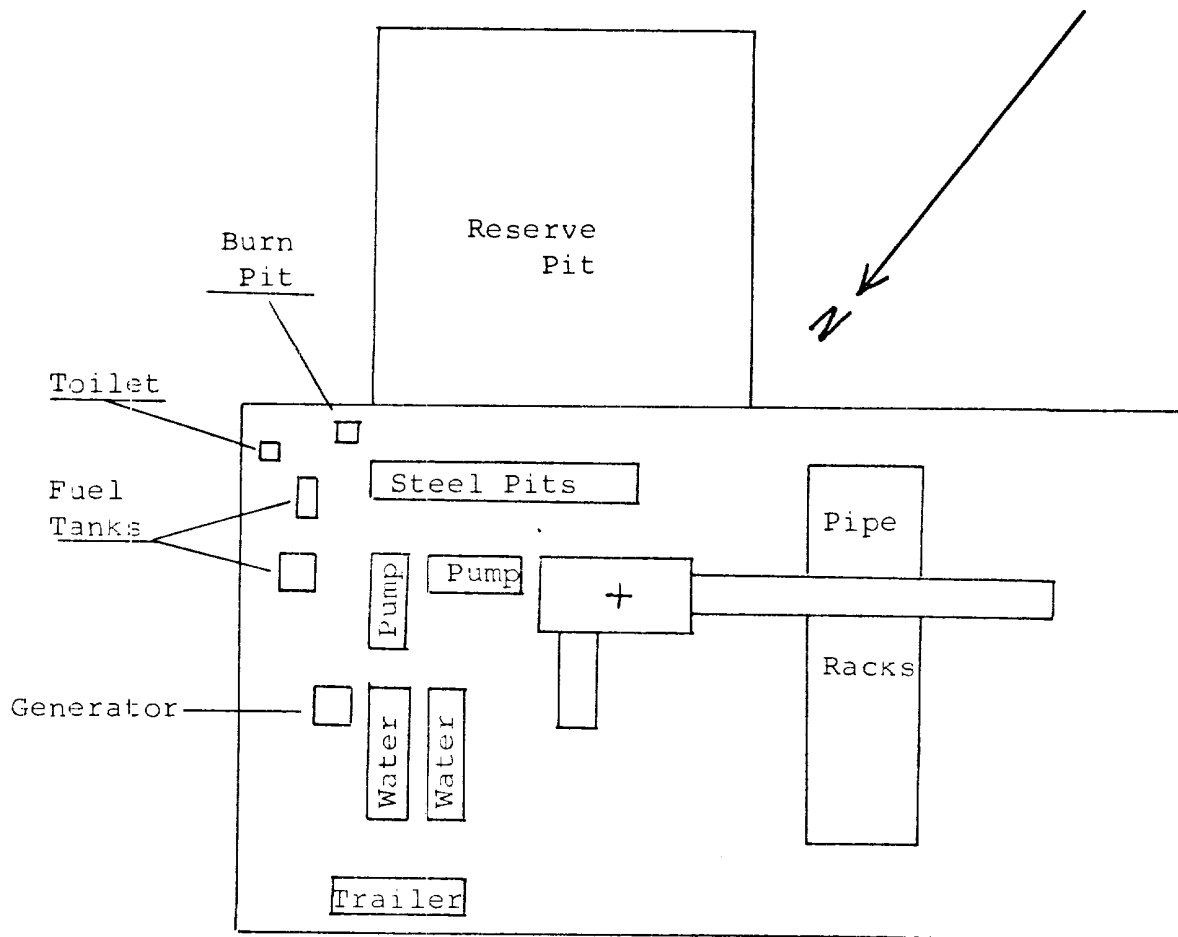

RIG PLAN SHEET



Vicinity Map for  
 GETTY OIL COMPANY #20E JICARILLA B  
 1830' FSL 790' FWL Sec. 31-T25N-R5W  
 RIO ARriba COUNTY, NEW MEXICO

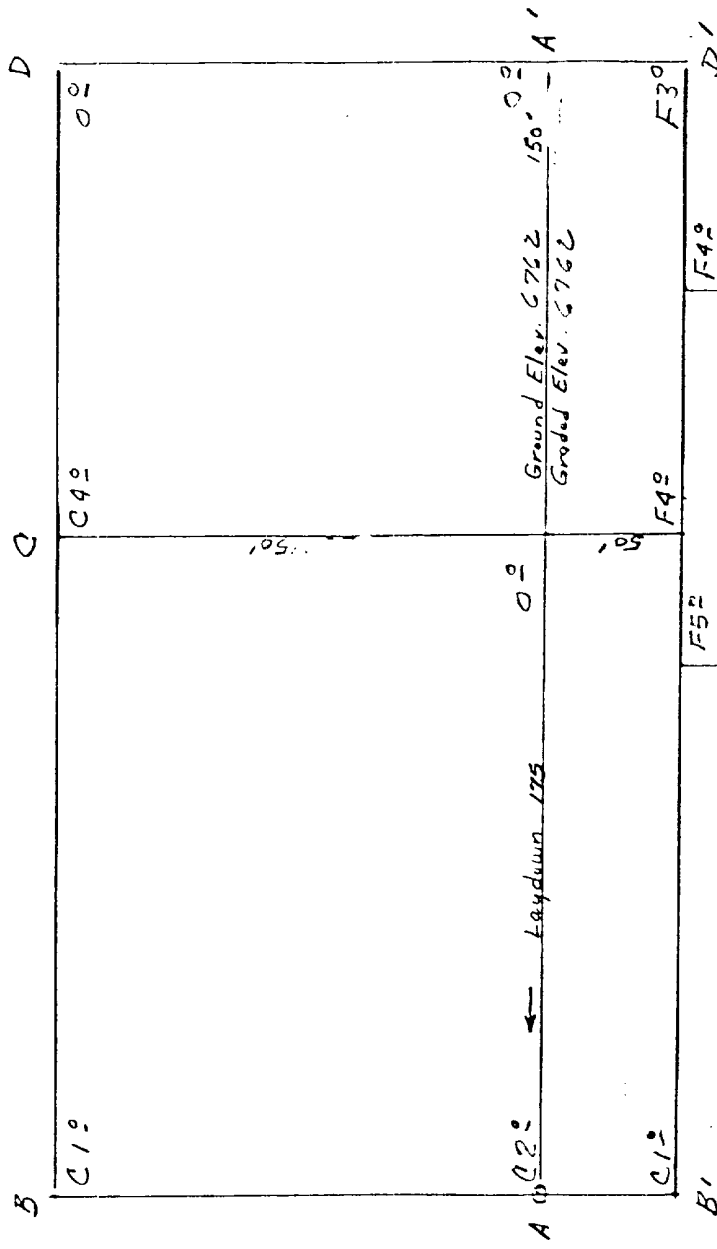

Vert. 1"=40'      A-A'      Horiz. 1"=100'

6760			
6750			
6740			

B-B'      Horiz. 1"=100'

6760			
6750			
6740			

Vert. 1"=40'      D-D'      Horiz. 1"=100'

6760			
6750			
6740			

B-B'      Horiz. 1"=100'

6760			
6750			
6740			

