

UNITED STATES
DEPARTMENT OF THE INTERIOR
GEOLOGICAL SURVEY

APPLICATION FOR PERMIT TO DRILL, DEEPEN, OR PLUG BACK

1a. TYPE OF WORK

DRILL ☒DEEPEN ☐PLUG BACK ☐

b. TYPE OF WELL

OIL
WELL ☒GAS
WELL ☐OTHER ☐SINGLE
ZONE ☐MULTIPLE
ZONE ☐

2. NAME OF OPERATOR

Cotton Petroleum Corporation

3. ADDRESS OF OPERATOR

717 17th St., Suite 2200, Denver, CO 80202

4. LOCATION OF WELL (Report location clearly and in accordance with any State requirements.)*

At surface

At proposed prod. zone 1710' FWL, 750' FNL Section 9

14. DISTANCE IN MILES AND DIRECTION FROM NEAREST TOWN OR POST OFFICE*

15. DISTANCE FROM PROPOSED*
LOCATION TO NEAREST
PROPERTY OR LEASE LINE, FT.

(Also to nearest drg. unit line, if any)

750

18. DISTANCE FROM PROPOSED LOCATION*
TO NEAREST WELL, DRILLING, COMPLETED,
OR APPLIED FOR, ON THIS LEASE, FT.

16. NO. OF ACRES IN LEASE

2665

19. PROPOSED DEPTH

7320'

17. NO. OF ACRES ASSIGNED
TO THIS WELL

160

20. ROTARY OR CABLE TOOLS

Rotary

21. ELEVATIONS (Show whether DF, RT, GR, etc.)

6730' GR

22. APPROX. DATE WORK WILL START*

1-1-81

23.

PROPOSED CASING AND CEMENTING PROGRAM

SIZE OF HOLE	SIZE OF CASING	WEIGHT PER FOOT	SETTING DEPTH	QUANTITY OF CEMENT
12 1/4"	8 5/8"	24#	300'	100 sacks
7 7/8"	4 1/2"	10.5#	11 6/8' 7320'	to be determined

This action is subject to administrative
appeal pursuant to 30 CFR 290.

It is proposed to drill this well with rotary tools, and drilling mud as a circulation medium, through the Dakota Formation. Possible production zones in the Gallup and Dakota Formation will be completed and downhole commingled. Production casing will be cemented in such a manner as to protect the Pictured Cliffs Formation. Fence reserve pit on 3 sides before spudding. Fence 4th side when WORT.

Estimated Formation Tops

Pictured Cliffs
Chacra
Mesaverde
GallupDRILLING OPERATIONS AUTHORIZED ARE
SUBJECT TO COMPLIANCE WITH ATTACHED
"GENERAL REQUIREMENTS"2775' Greenhorn
3607' Graneros
4418' Dakota
6058'6923'
6980'
7000'

The NW $\frac{1}{4}$ of Sec. 9 is dedicated to this well, an area of 160 acres. The gas produced from this well is committed.

IN ABOVE SPACE DESCRIBE PROPOSED PROGRAM: If proposal is to deepen or plug back, give data on present productive zone and proposed new productive zone. If proposal is to drill or deepen directionally, give pertinent data on subsurface locations and measured and true vertical depths. Give blowout preventer program, if any.

24.

SIGNED

DE Wood/da S

TITLE

Division Production Mgr.

DATE

10-30-80

(This space for Federal or State office use)

APPROVED
AS AMENDED

PERMIT NO.

APPROVAL DATE

APPROVED BY

CONDITIONS OF APPROVAL, IF ANY

TITLE

DATE

DISTRICT ENGINEER

NMOCC

*See Instructions On Reverse Side

All distances must be from the outer boundaries of the Section.

Operator COTTON PETROLEUM CORPORATION			Lease APACHE		Well No. 136
Unit Letter C	Section 9	Township 24N	Range 4W	County Rio Arriba	
Actual Footage Location of Wells 750 feet from the North line and 1710 feet from the West line					
Ground Level Elev: 6713	Producing Formation Gallup - Dakota		Pool Lindrieth Gallup Dakota West		Dedicated Acreage: 160 Acres

1. Outline the acreage dedicated to the subject well by colored pencil or hatchure marks on the plat below.

2. If more than one lease is dedicated to the well, outline each and identify the ownership thereof (both as to working interest and royalty).

3. If more than one lease of different ownership is dedicated to the well, have the interests of all owners been consolidated by communitization, unitization, force-pooling, etc?

☐ Yes ☐ No If answer is "yes," type of consolidation _____

If answer is "no," list the owners and tract descriptions which have actually been consolidated. (Use reverse side of this form if necessary.) _____

No allowable will be assigned to the well until all interests have been consolidated (by communitization, unitization, forced-pooling, or otherwise) or until a non-standard unit, eliminating such interests, has been approved by the Commission.

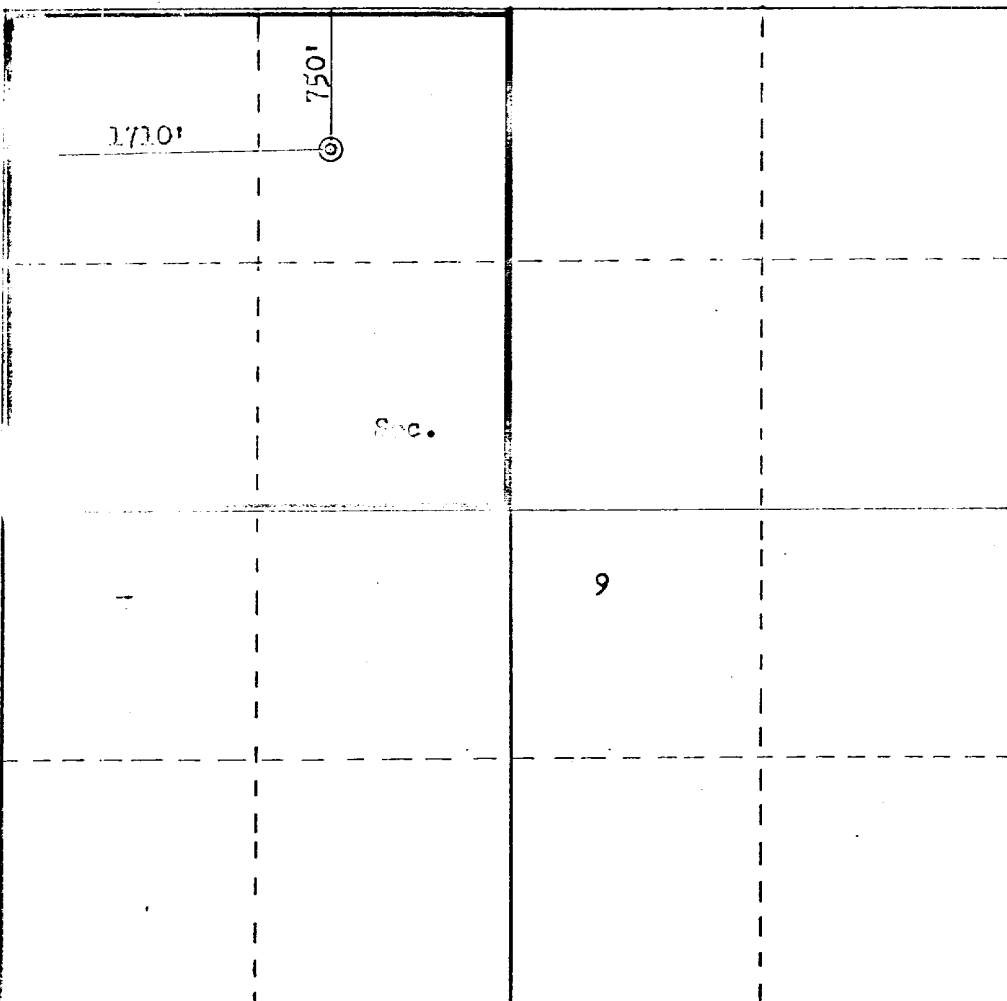

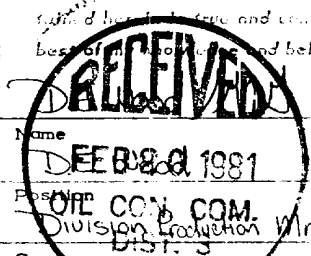
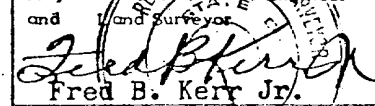
CERTIFICATION	
I hereby certify that the information contained herein is true and correct to the best of my knowledge and belief.	
	
Name	DEEDS 1981
Post Office	ONE CORN. COM.
Company	Division Production Manager
Date	11/1/80
I hereby certify that the well location shown on this plat was plotted from field notes of actual surveys made by me or under my supervision, and that the same is true and correct to the best of my knowledge and belief.	
Date Surveyed	September 30, 1980
Registered Professional Engineer and Land Surveyor	
	
Certificate No.	220



Vicinity Map for Attachment 1
COTTON PETROLEUM CORP. #136 APACHE
750' FNL 1710' FWL Sec. 9-T24N-R4W
RIO ARriba COUNTY, NEW MEXICO