

UNITED STATES
DEPARTMENT OF THE INTERIOR
GEOLOGICAL SURVEY

SUNDRY NOTICES AND REPORTS ON WELLS

(Do not use this form for proposals to drill or to deepen or plug back to a different reservoir. Use Form 9-331-C for such proposals.)

1. oil ☒ gas ☐ other ☐
well well
2. NAME OF OPERATOR
Merriam Oil & Gas Corporation
3. ADDRESS OF OPERATOR
P. O. Box 1017, Farmington, New Mexico 87499
4. LOCATION OF WELL (REPORT LOCATION CLEARLY. See space 17 below.)
AT SURFACE: 790' FNL and 1850' FWL
AT TOP PROD. INTERVAL: Same
AT TOTAL DEPTH: Same
16. CHECK APPROPRIATE BOX TO INDICATE NATURE OF NOTICE, REPORT, OR OTHER DATA

REQUEST FOR APPROVAL TO:	Subsequent Report of:
TEST WATER SHUT-OFF <input type="checkbox"/>	<input type="checkbox"/>
FRACTURE TREAT <input type="checkbox"/>	<input type="checkbox"/>
SHOOT OR ACIDIZE <input type="checkbox"/>	<input type="checkbox"/>
REPAIR WELL <input type="checkbox"/>	<input type="checkbox"/>
PULL OR ALTER CASING <input type="checkbox"/>	<input type="checkbox"/>
MULTIPLE COMPLETE <input type="checkbox"/>	<input type="checkbox"/>
CHANGE ZONES <input type="checkbox"/>	<input type="checkbox"/>
ABANDON* <input type="checkbox"/>	<input type="checkbox"/>
(other) Plat	

5. LEASE
SF 078877
6. IF INDIAN, ALLOTTEE OR TRIBE NAME
7. UNIT AGREEMENT NAME
8. FARM OR LEASE NAME
Canyon Largo Unit
9. WELL NO.
304
10. FIELD OR WILDCAT NAME
Devils Fork Gallup
11. SEC., T., R., M., OR BLK. AND SURVEY OR AREA
Sec. 11, T24N, R6W
12. COUNTY OR PARISH
Rio Arriba
13. STATE
New Mexico
14. API NO.
15. ELEVATIONS (SHOW DF, KDB, AND WD)
6415' GL

(NOTE: Report results of multiple completion or zone change on Form 9-330.)

17. DESCRIBE PROPOSED OR COMPLETED OPERATIONS (Clearly state all pertinent details, and give pertinent dates, including estimated date of starting any proposed work. If well is directionally drilled, give subsurface locations and measured and true vertical depths for all markers and zones pertinent to this work.)*

Attached is a plat indicating 160 dedicated acres instead of 80.

RECEIVED
OIL CO. & GAS
DIST.

Subsurface Safety Valve: Manu. and Type _____ Set @ _____ Ft.

18. I hereby certify that the foregoing is true and correct

SIGNED Alfred A. ... TITLE Operations Manager DATE 3/29/83

(This space for Federal or State office use)

APPROVED BY _____ TITLE _____ DATE _____
CONDITIONS OF APPROVAL, IF ANY:

RECEIVED FOR RECORD

*See Instructions on Reverse Side

APR 05 1983

CACHE 74

NMOCC

All distances must be from the center boundary of the Section.

Merrion Oil & Gas Corporation		CANYON LARGO UNIT		Well No. 304
Unit Letter C	Section 11	Township 24N	Range 6W	County Rio Arriba
Actual Footage Location of Well:				
790	feet from the North	Line and	1850	feet from the West
Ground Level Elev: 6415	Producing Formation Gallup	Pool Devils Fork Gallup	Dedicated Acreage: 160 Acres	

1. Outline the acreage dedicated to the subject well by colored pencil or hatchure marks on the plat below.
2. If more than one lease is dedicated to the well, outline each and identify the ownership thereof (both as to working interest and royalty).
3. If more than one lease of different ownership is dedicated to the well, have the interests of all owners been consolidated by communitization, unitization, force-pooling, etc?

☐ Yes ☐ No If answer is "yes," type of consolidation _____

If answer is "no," list the owners and tract descriptions which have actually been consolidated. (Use reverse side of this form if necessary.) _____

No allowable will be assigned to the well until all interests have been consolidated (by communitization, unitization, forced-pooling, or otherwise) or until a non-standard unit, eliminating such interests, has been approved by the Commission.

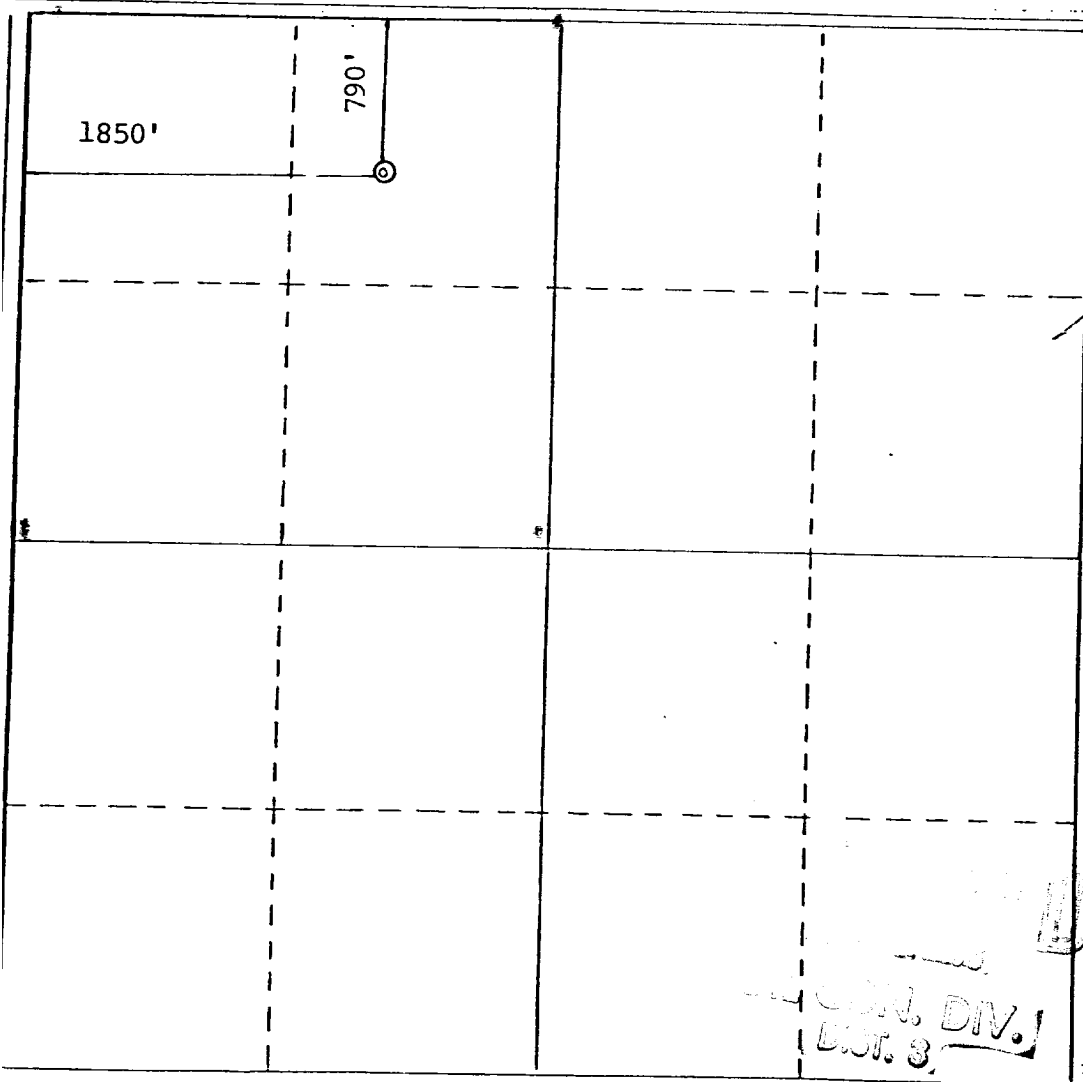

CERTIFICATION

I hereby certify that the information contained herein is true and complete to the best of my knowledge and belief.

Steve S. Dunn

Name
Steve S. Dunn
Position
Operations Manager
Company
Merrion Oil & Gas Corp.

Date
3/29/83

I hereby certify that the well location shown on this plot was plotted from field notes of actual surveys made by me or under my supervision, and that the same is true and correct to the best of my knowledge and belief.

Date Surveyed
March 20, 1983
Registered Professional Engineer
and Land Surveyor
Frederick E. Keener Jr.
Frederick E. Keener Jr.

NEW MEXICO
DIV.
DIST. 3

