

UNITED STATES  
DEPARTMENT OF THE INTERIOR  
GEOLOGICAL SURVEY

30-039-27819

APPLICATION FOR PERMIT TO DRILL, DEEPEN, OR PLUG BACK

1a. TYPE OF WORK  
 DRILL  DEEPEN  PLUG BACK

b. TYPE OF WELL  
 OIL WELL  GAS WELL  OTHER   
 SINGLE ZONE  MULTIPLE ZONE

2. NAME OF OPERATOR  
 CHACE OIL COMPANY, INC.

3. ADDRESS OF OPERATOR  
 313 Washington, S.E., Albuq., N. M. 87108

4. LOCATION OF WELL (Report location clearly and in accordance with any State requirements)  
 At surface 1840' FSL & 800' FEL, Unit "I"  
 At proposed prod. zone

14. DISTANCE IN MILES AND DIRECTION FROM NEAREST TOWN OR POST OFFICE\*  
 15 miles W-SW of Lindreth, N. M.

15. DISTANCE FROM PROPOSED\* LOCATION TO NEAREST PROPERTY OR LEASE LINE, FT. (Also to nearest drlg. unit line, if any) 800'

18. DISTANCE FROM PROPOSED\* LOCATION TO NEAREST WELL, DRILLING COMPLETED, OR APPLIED FOR, ON THIS LEASE, FT. 2500'

21. ELEVATIONS (Show whether DF, RT, GR, etc.)  
 7087' GR

5. LEASE DESIGNATION AND SERIAL NO.  
 Jicarilla 70

6. IF INDIAN, ALLOTTEE OR TRIBE NAME  
 Jicarilla Apache

7. UNIT AGREEMENT NAME

8. FARM OR LEASE NAME  
 Jicarilla 70

9. WELL NO.  
 12

10. FIELD AND POOL, OR WILDCAT

11. SEC., T., R., M., OR BLM. AND SURVEY OR AREA  
 Lindreth-Gallup- Dakota

Sec. 34, T24N, R4W

12. COUNTY OR PARISH 13. STATE  
 Rio Arriba N. Mex.

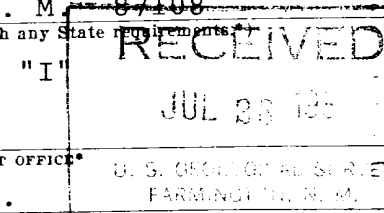

16. NO. OF ACRES IN LEASE  
 2560

19. PROPOSED DEPTH  
 7400'

17. NO. OF ACRES ASSIGNED TO THIS WELL  
 40

20. ROTARY OR CABLE TOOLS  
 Rotary

22. APPROX. DATE WORK WILL START\*  
 Oct. 1981

23. PROPOSED CASING AND CEMENTING PROGRAM

SIZE OF HOLE	SIZE OF CASING	WEIGHT PER FOOT	SETTING DEPTH	QUANTITY OF CEMENT
9 3/4"	8 5/8"	24	200	200 SXS
DRILLING OPERATIONS AUTHORIZED ARE SUBJECT TO COMPLIANCE WITH ATTACHED "GENERAL REQUIREMENTS"			This action is subject to administrative appeal pursuant to 30 CFR 290.	

Drill 205' of 9 3/4" surface hole. Set 200' of 8 5/8" casing. Cement to surface with 200 sxs using oil base mud (15%), and Schaffer 5000# standard doublegate hydraulic BOP. Drill a 7 7/8" hole to 7400' to test the Dakota formation.

Wasatch formation on surface. Estimated tops: Ojo-2250'; Pictured Cliff-3010'; Cliff House House-3930'; Point Lookout-5175'; Galena-6040'; Greenhorn-7000'; Dakota "A"-7140'; Burro Canyon-7350'



IN ABOVE SPACE DESCRIBE PROPOSED PROGRAM: If proposal is to deepen or plug back, give data on present productive zone and proposed new productive zone. If proposal is to drill or deepen directionally, give pertinent data on subsurface locations and measured and true vertical depths. Give blowout preventer program, if any.

24. SIGNED [Signature] TITLE Geologist DATE 7/17/81

(This space for Federal or State office use)

PERMIT NO. \_\_\_\_\_ APPROVAL DATE \_\_\_\_\_

APPROVED BY \_\_\_\_\_ TITLE \_\_\_\_\_ DATE \_\_\_\_\_

CONDITIONS OF APPROVAL, IF ANY:

sh 3-

\*See Instructions On Reverse Side

NMOCC

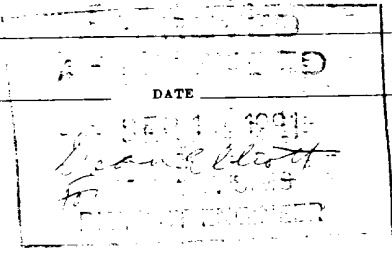

UNITED STATES  
DEPARTMENT OF THE INTERIOR  
GEOLOGICAL SURVEY

SUNDRY NOTICES AND REPORTS ON WELLS

(Do not use this form for proposals to drill or to deepen or plug back to a different reservoir. Use Form 9-331-C for such proposals.)

1. oil well  gas well  other

2. NAME OF OPERATOR  
Chace Oil Company, Inc.

3. ADDRESS OF OPERATOR  
313 Washington, S.E. Albuq., NM 87108

4. LOCATION OF WELL (REPORT LOCATION CLEARLY. See space 17 below.)  
1840' FSL & 800' FEL Unit "I"  
AT SURFACE:  
AT TOP PROD. INTERVAL:  
AT TOTAL DEPTH:

5. LEASE  
Jicarilla 70

6. IF INDIAN, ALLOTTEE OR TRIBE NAME  
Jicarilla Apache

7. UNIT AGREEMENT NAME

8. FARM OR LEASE NAME  
Jicarilla 70

9. WELL NO.  
12

10. FIELD OR WILDCAT NAME  
S. Lindreth-Gallup-Dakota

11. SEC., T., R., M., OR BLK. AND SURVEY OR AREA  
Sec. 34, T24N, R4W

12. COUNTY OR PARISH  
Rio Arriba

13. STATE  
N. Mex.

14. API NO.

15. ELEVATIONS (SHOW DF, KDB, AND WD)  
7087' GR

16. CHECK APPROPRIATE BOX TO INDICATE NATURE OF NOTICE, REPORT, OR OTHER DATA

REQUEST FOR APPROVAL TO:

TEST WATER SHUT-OFF

FRACTURE TREAT

SHOOT OR ACIDIZE

REPAIR WELL

PULL OR ALTER CASING

MULTIPLE COMPLETE

CHANGE ZONES

ABANDON\*

(other) Spud well

SUBSEQUENT REPORT OF:

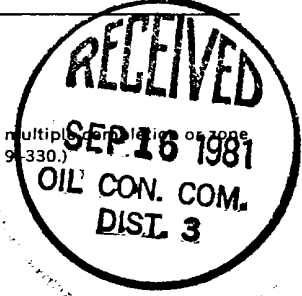
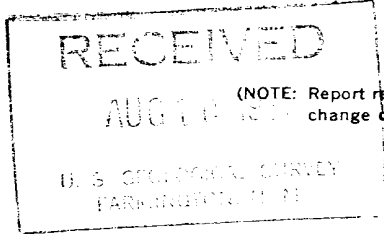

17. DESCRIBE PROPOSED OR COMPLETED OPERATIONS (Clearly state all pertinent details and give pertinent dates, including estimated date of starting any proposed work. If well is directionally drilled, give subsurface locations and measured and true vertical depths for all markers and zones pertinent to this work.)\*

Operations to commence approx. October 1, 1981. 4 1/2" casing to be run to 7350'. Cemented in two stages. 7310' float collar. Second stage 3200'. 800 sxs 50-50 posmix and class "B" cement with 2% calcium chloride, 6 1/2# Gilstone per sack. 12) Will log with induction and density logs. No cores. 13) No hazards expected.

Subsurface Safety Valve: Manu. and Type \_\_\_\_\_ Set @ \_\_\_\_\_ Ft.

18. I hereby certify that the foregoing is true and correct  
SIGNED [Signature] TITLE Geologist DATE 8/6/81

(This space for Federal or State office use)

APPROVED BY \_\_\_\_\_ TITLE \_\_\_\_\_ DATE \_\_\_\_\_  
CONDITIONS OF APPROVAL, IF ANY:

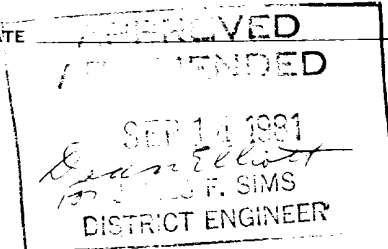

\*See Instructions on Reverse Side

NMOCC

All distances must be from the outer boundaries of the Section.

Operator <b>CHACE OIL COMPANY</b>		Lease <b>JICARILLA</b>		Well No. <b>70-12</b>
Unit Letter <b>I</b>	Section <b>34</b>	Township <b>24 NORTH</b>	Range <b>4 WEST</b>	County <b>RIO ARRIBA</b>
Actual Footage Location of Well:				
<b>1840</b> feet from the <b>SOUTH</b>		Line and	<b>800</b> feet from the <b>EAST</b>	
Ground Level Elev. <b>7087</b>	Producing Formation <b>Dakota</b>	Pool <b>S. Lindreth-Gallup-Dakota</b>		Dedicated Acreage: <b>40</b> Acres

1. Outline the acreage dedicated to the subject well by colored pencil or hatchure marks on the plat below.
2. If more than one lease is dedicated to the well, outline each and identify the ownership thereof (both as to working interest and royalty).
3. If more than one lease of different ownership is dedicated to the well, have the interests of all owners been consolidated by communitization, unitization, force-pooling, etc?

Yes  No If answer is "yes," type of consolidation \_\_\_\_\_

If answer is "no," list the owners and tract descriptions which have actually been consolidated. (Use reverse side of this form if necessary.) \_\_\_\_\_

No allowable will be assigned to the well until all interests have been consolidated (by communitization, unitization, forced-pooling, or otherwise) or until a non-standard unit, eliminating such interests, has been approved by the Division

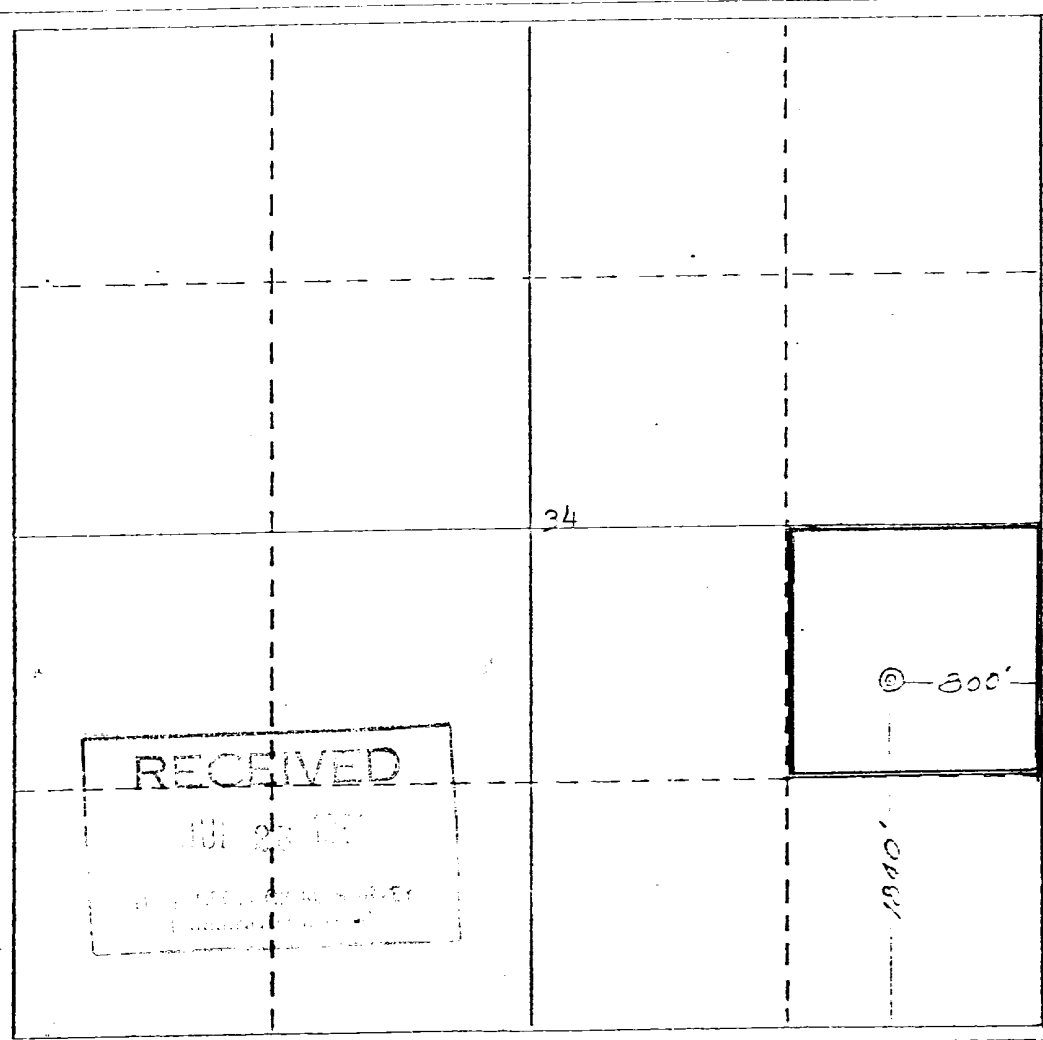

CERTIFICATION

I hereby certify that the information contained herein is true and complete to the best of my knowledge and belief.

*Ron Gordon*

Name

**Ron Gordon**

Position

**Geologist**

Company

**Chace Oil Co., Inc.**

Date

**7-24-81**

I hereby certify that the well location shown on this plat was plotted from field notes of actual surveys made by \_\_\_\_\_ under my supervision, and that the same is true and correct to the best of my knowledge and belief.

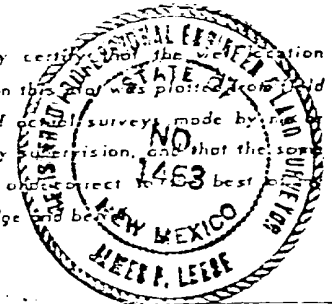

Date Surveyed

**July 7, 1981**

Registered Professional Engineer and/or Land Surveyor

*James P. Leese*  
**James P. Leese**

Certificate No.

**1463**

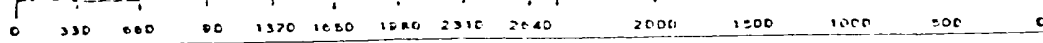



INTERIOR GEOLOGICAL SURVEY WASHINGTON 2025  
 6 MI. TO N. MEX. 44  
 CUBAN VIA N. MEX. 44. 27 MI.

ROAD CLASSIFICATION  
 Light-duty  
 Unimproved dirt  
 State Route

Mapped, edited, and published by the Geological Survey  
 Contour by USGS and USC&GS  
 Topography by photogrammetric methods from aerial  
 photographs taken 1958 and 1962. Field checked 1963  
 Polyconic projection 1927 North American datum  
 60,000 foot grid based on New Mexico coordinate system, central zone

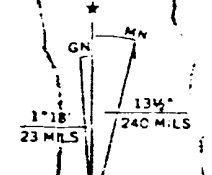

**CHACE OIL COMPANY**  
 Jicarilla #71-4  
 OTERO STORE, NNE $\frac{1}{4}$ , Sec. 3, T23N, R4W, N.M.P.M.,  
 N3615-W10715/7 Rio Arriba County, New Mexico

UTM GRID AND 1963 MAGNETIC NC  
 DECLINATION AT CENTER OF SHEET

1963  
 AMS 4556 IV SE-SERIES V66