

UNITED STATES  
DEPARTMENT OF THE INTERIOR  
GEOLOGICAL SURVEY

## APPLICATION FOR PERMIT TO DRILL, DEEPEN, OR PLUG BACK

1a. TYPE OF WORK  
DRILL ☒ DEEPEN ☐ PLUG BACK ☐

b. TYPE OF WELL  
OIL WELL ☒ GAS WELL ☒ OTHER ☐ SINGLE ZONE ☒ MULTIPLE ZONE ☐

2. NAME OF OPERATOR  
Southland Royalty Company

3. ADDRESS OF OPERATOR  
P.O. Drawer 570, Farmington, New Mexico 87401

4. LOCATION OF WELL (Report location clearly and in accordance with any State requirements.)\*  
At surface  
410' FNL & 670' FEL  
At proposed prod. zone

5. LEASE DESIGNATION AND SERIAL NO.  
Jicarilla 416

6. IF INDIAN, ALLOTTEE OR TRIBE NAME

7. UNIT AGREEMENT NAME

8. FARM OR LEASE NAME  
Medio Canyon

9. WELL NO.  
3

10. FIELD AND POOL, OR WILDCAT  
Wildcat Pool  
Chacon Dakota

11. SEC., T., R., M., OR BLK.  
AND SURVEY OR AREA  
A Section 36, T24N, R4W

12. COUNTY OR PARISH  
Rio Arriba

13. STATE  
New Mexico

14. DISTANCE IN MILES AND DIRECTION FROM NEAREST TOWN OR POST OFFICE\*  
12 miles West of Lindrith, New Mexico

15. DISTANCE FROM PROPOSED\*  
LOCATION TO NEAREST  
PROPERTY OR LEASE LINE, FT.  
(Also to nearest drlg. unit line, if any)  
410'

16. NO. OF ACRES IN LEASE  
2560'

17. NO. OF ACRES ASSIGNED  
TO THIS WELL  
220 160

18. DISTANCE FROM PROPOSED LOCATION\*  
TO NEAREST WELL, DRILLING, COMPLETED,  
OR APPLIED FOR, ON THIS LEASE, FT.  
400'

19. PROPOSED DEPTH  
7912'

20. ROTARY OR CABLE TOOLS  
Rotary

21. ELEVATIONS (Show whether DF, RT, GR, etc.)  
7228' GR

22. APPROX. DATE WORK WILL START\*  
August 31, 1981

23. PROPOSED CASING AND CEMENTING PROGRAM

SIZE OF HOLE	SIZE OF CASING	WEIGHT PER FOOT	SETTING DEPTH	QUANTITY OF CEMENT
12-1/4"	3-5/8"	24#	200'	165 cu.ft.
7-7/8"	4-1/2"	10.5#	7000'	873 cu.ft. (1st Stage)
7-7/8"	4-1/2"	11.6#	7000'-7912'	528 cu.ft. (2nd Stage)
	2-3/8"	4.7#	7900'	

Surface formation is San Jose.

Top of Pictured Cliffs sand is at 3335'.

Fresh water mud will be used to drill from surface to total depth.

It is anticipated that an IES, GR-Density and Sonic Log will be run at  
Total Depth.

No abnormal pressures or poisonous gases are anticipated in this well.

It is expected that this well will be drilled before September 15, 1981.

This depends on time required for approvals, rig availability, and  
the weather.

Gas is dedicated.

IN ABOVE SPACE DESCRIBE PROPOSED PROGRAM: If proposal is to deepen or plug back, give data on present productive zone and proposed productive zone. If proposal is to drill or deepen directionally, give pertinent data on subsurface locations and measured and true vertical depths. Give blowout preventer program, if any.

24. SIGNATURE John A. Crum TITLE Petroleum Engineer DATE August 6, 1981  
(This space for Federal or State office use)

PERMIT NO. \_\_\_\_\_ APPROVAL DATE \_\_\_\_\_

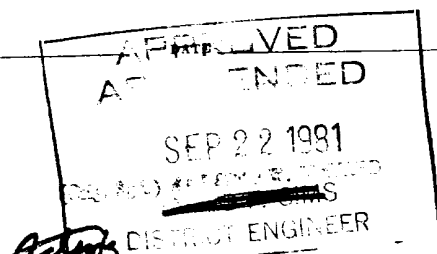
APPROVED BY \_\_\_\_\_ TITLE \_\_\_\_\_  
CONDITIONS OF APPROVAL, IF ANY: \_\_\_\_\_

**NEW MEXICO OIL CONSERVATION COMMISSION  
WELL LOCATION AND ACREAGE DEDICATION PLAT**

Form C-102  
Supersedes C-128  
Effective 1-1-65

All distances must be from the outer boundaries of the Section.

Operator <i>Southland Royalty Company</i>			Lease <i>MEDIO CANYON</i>		Well No. <i>3</i>
Unit Letter <i>A</i>	Section <i>36</i>	Township <i>24N</i>	Range <i>4W</i>	County <i>Rio Arriba</i>	
Actual Footage Location of Well: <i>410</i> feet from the <i>North</i> line and <i>670</i> feet from the <i>East</i> line					
Ground Level Elev. <i>7228'</i>	Producing Formation <i>Gallup-Dakota</i>	Pool <i>West Lindrith</i>		Dedicated Acreage: <i>160</i> Acres	

1. Outline the acreage dedicated to the subject well by colored pencil or hachure marks on the plat below.
2. If more than one lease is dedicated to the well, outline each and identify the ownership thereof (both as to working interest and royalty).
3. If more than one lease of different ownership is dedicated to the well, have the interests of all owners been consolidated by communitization, unitization, force-pooling, etc?

☐ Yes   ☐ No   If answer is "yes," type of consolidation \_\_\_\_\_

If answer is "no," list the owners and tract descriptions which have actually been consolidated. (Use reverse side of this form if necessary.) \_\_\_\_\_

No allowable will be assigned to the well until all interests have been consolidated (by communitization, unitization, forced-pooling, or otherwise) or until a non-standard unit, eliminating such interests, has been approved by the Commission.

**CERTIFICATION**

*I hereby certify that the information contained herein is true and complete to the best of my knowledge and belief.*

Name: *J. E. Filder*  
 Position: *District Engineer*  
 Company: *Southland Royalty Company*  
 Date: *September 17, 1981*

*I hereby certify that the well location shown on this plat was plotted from field notes of actual surveys made by me or under my supervision, and that the same is true and correct to the best of my knowledge and belief.*

Date Surveyed \_\_\_\_\_

Registered Professional Engineer and/or Land Surveyor \_\_\_\_\_

Certificate No. \_\_\_\_\_

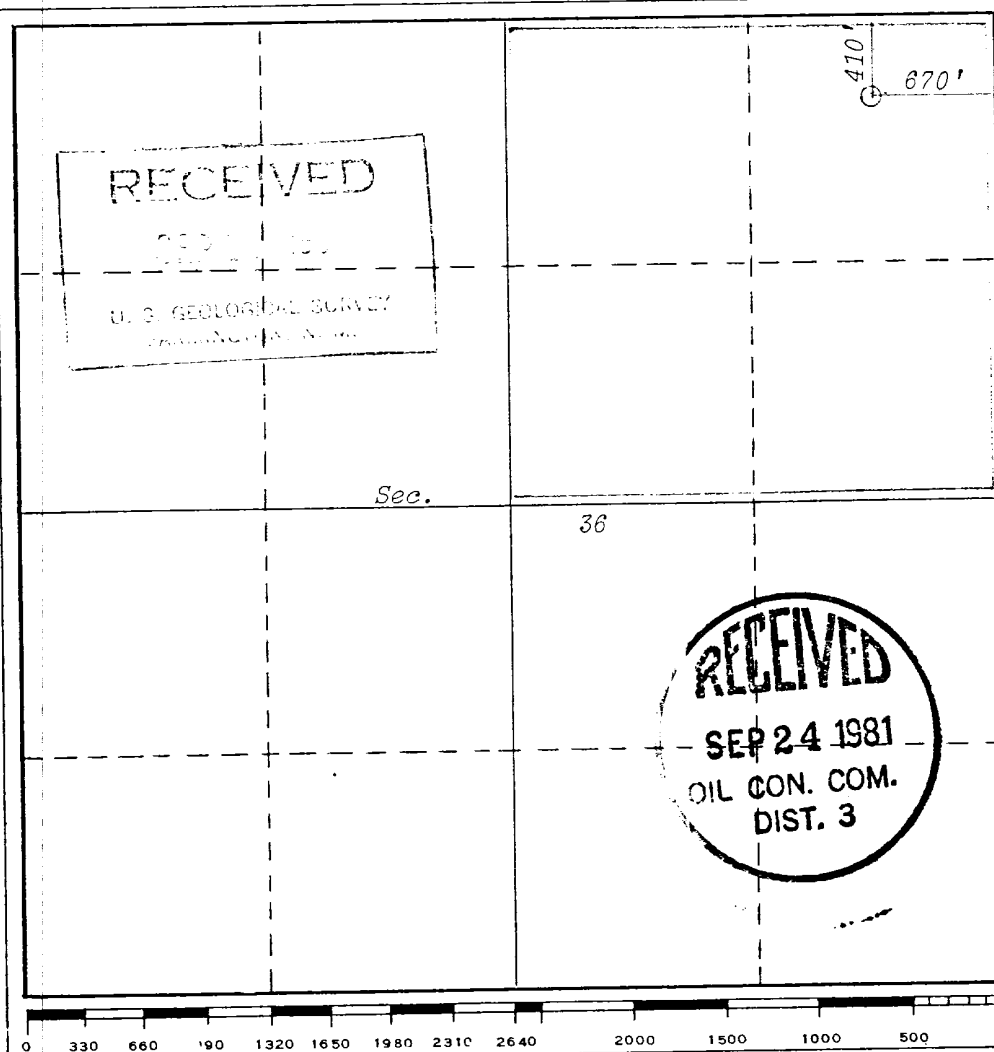

**NMOC**

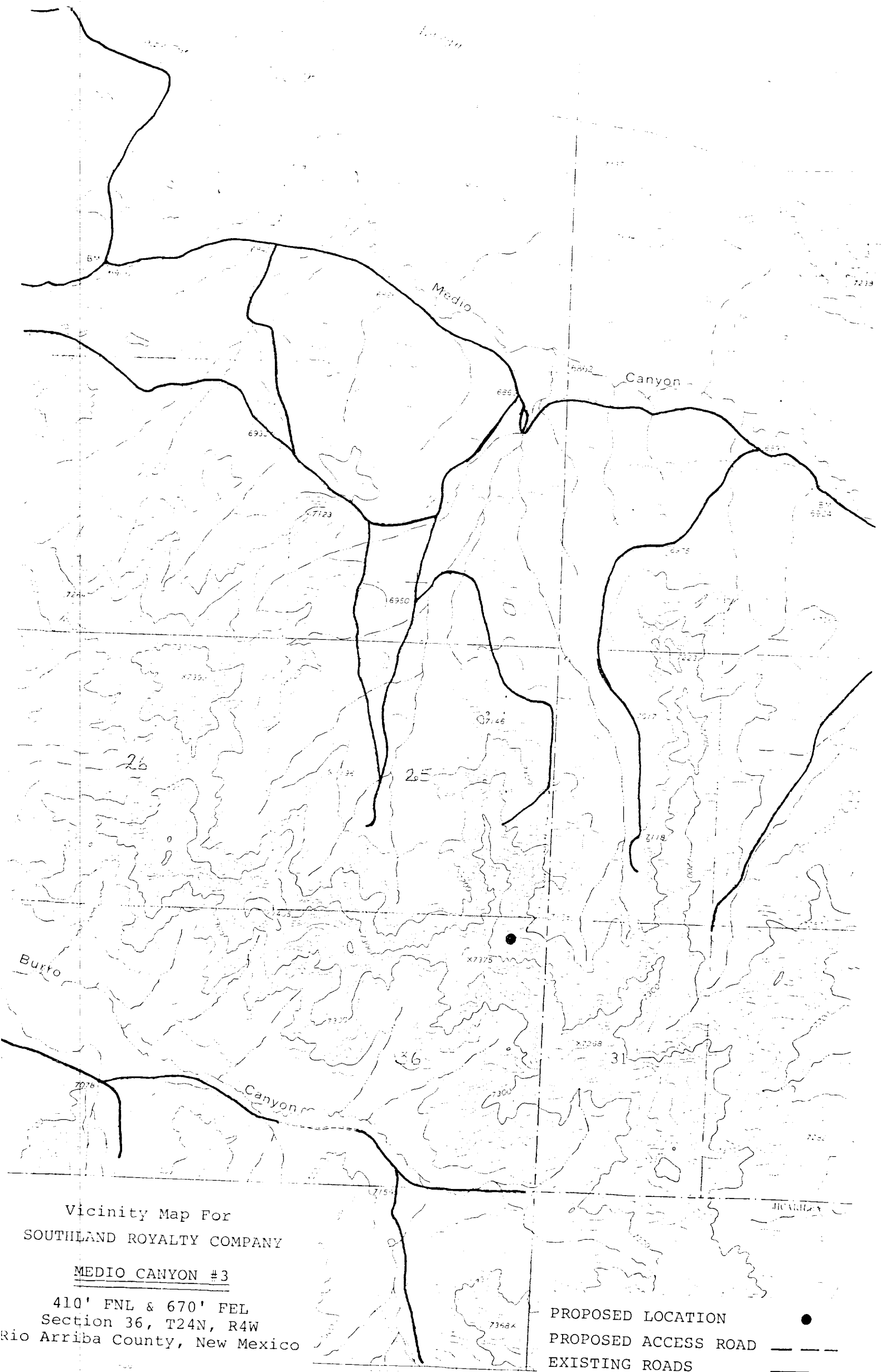

Vicinity Map For  
SOUTHLAND ROYALTY COMPANY

MEDIO CANYON #3

410' FNL & 670' FEL  
Section 36, T24N, R4W  
Rio Arriba County, New Mexico

PROPOSED LOCATION  
PROPOSED ACCESS ROAD  
EXISTING ROADS

