

UNITED STATES
DEPARTMENT OF THE INTERIOR
GEOLOGICAL SURVEY

APPLICATION FOR PERMIT TO DRILL, DEEPEN, OR PLUG BACK

1a. TYPE OF WORK

DRILL ☒DEEPEN ☐PLUG BACK ☐

b. TYPE OF WELL

OIL
WELL ☒GAS
WELL ☐

OTHER

SINGLE
ZONE ☒MULTIPLE
ZONE ☐

2. NAME OF OPERATOR

Supron Energy Corporation

3. ADDRESS OF OPERATOR

P.O. Box 808, Farmington, New Mexico 87401

4. LOCATION OF WELL (Report location clearly and in accordance with any State requirements.*)

At surface 1650 ft./South line and 1650 ft./East line

At proposed prod. zone Same as above

14. DISTANCE IN MILES AND DIRECTION FROM NEAREST TOWN OR POST OFFICE*

4 miles north of Lybrook, New Mexico

15. DISTANCE FROM PROPOSED*

LOCATION TO NEAREST
PROPERTY OR LEASE LINE, FT.
(Also to nearest drlg. unit line, if any) 330 ft.

16. NO. OF ACRES IN LEASE

320.00

18. DISTANCE FROM PROPOSED LOCATION*

TO NEAREST WELL, DRILLING, COMPLETED,
OR APPLIED FOR, ON THIS LEASE, FT. 1st well
on the lease

19. PROPOSED DEPTH

6190

17. NO. OF ACRES ASSIGNED

TO THIS WELL
W. 1/4 of SE 1/4 80.00

20. ROTARY OR CABLE TOOLS

Rotary

21. ELEVATIONS (Show whether DF, RT, GR, etc.)

7284 Gr.

22. APPROX. DATE WORK WILL START*

November 15, 1981

23. PROPOSED CASING AND CEMENTING PROGRAM

SIZE OF HOLE	SIZE OF CASING	WEIGHT PER FOOT	SETTING DEPTH	QUANTITY OF CEMENT
12 1/4"	8 5/8" H-40	24.00	250 ft.	150 sx Circulated
7 7/8"	4 1/2" K-55	10.50	6190 ft.	1050 sx Cover the Ojo Alamo

We desire to drill 12 1/4" hole to approximately 250 ft. using natural mud as the circulating medium. Run new 8 5/8" surface casing to T.D. and cement. Circulate cement to the surface. Pressure test the pipe. Drill out with 7 7/8" bit to approximately 6190 ft. using a starch base, Permaloid, non-dispersed mud as the circulating medium. Log the well. Run new 4 1/2", 10.50# casing to T.D. with a D.V. tool at approximately 2650 ft. Cement the 1st stage with approximately 250 sx of 65-35-poz mix, followed by approximately 350 sx of 50-50 poz mix. Second stage approximately 350 sx of 65-35 poz mix, followed by approximately 100 sx of 50-50 poz mix. Pressure test the casing. Perforate and fracture the Gallup zone. Clean the well up. Run tubing to the production zone. Run rods and nipple down the wellhead. Set pumping unit and connect to a gathering system.

This gas has previously been dedicated to a transporter.

IN ABOVE SPACE DESCRIBE PROPOSED PROGRAM: If proposal is to deepen or plug back, give data on present productive zone and proposed new productive zone. If proposal is to drill or deepen directionally, give pertinent data on subsurface locations and measured and true vertical depths. Give blowout preventer program, if any.

24.

SIGNED

Rudy D. Motto

TITLE

Area Superintendent

DATE

September 30, 1981

(This space for Federal or State office use)

PERMIT NO.

APPROVAL DATE

APPROVED BY

(Orig. Sgd.) RAYMOND W. VINYARD

TITLE

RAYMOND W. VINYARD
ACTING DISTRICT SUPERVISOR

DATE

CONDITIONS OF APPROVAL, IF ANY:

ch I

All distances must be from the outer boundaries of the Section.

Operator SUPRON ENERGY CORPORATION			Lease F-20-24-7		Well No. #1
Unit Letter J	Section 20	Township 24 NORTH	Range 7 WEST	County RIO ARriba	
Actual Footage Location of Well: 1650 feet from the SOUTH line and 1650 feet from the EAST line					
Ground Level Elev. 7284	Producing Formation Gallup		Pool Escrito Extension		Dedicated Acreage: W$\frac{1}{4}$ of SE$\frac{1}{4}$ 80.00 Acres

1. Outline the acreage dedicated to the subject well by colored pencil or hatchure marks on the plat below.
2. If more than one lease is dedicated to the well, outline each and identify the ownership thereof (both as to working interest and royalty).
3. If more than one lease of different ownership is dedicated to the well, have the interests of all owners been consolidated by communitization, unitization, force-pooling, etc?

☐ Yes ☐ No If answer is "yes," type of consolidation _____

If answer is "no," list the owners and tract descriptions which have actually been consolidated. (Use reverse side of this form if necessary.) _____

No allowable will be assigned to the well until all interests have been consolidated (by communitization, unitization, forced-pooling, or otherwise) or until a non-standard unit, eliminating such interests, has been approved by the Division

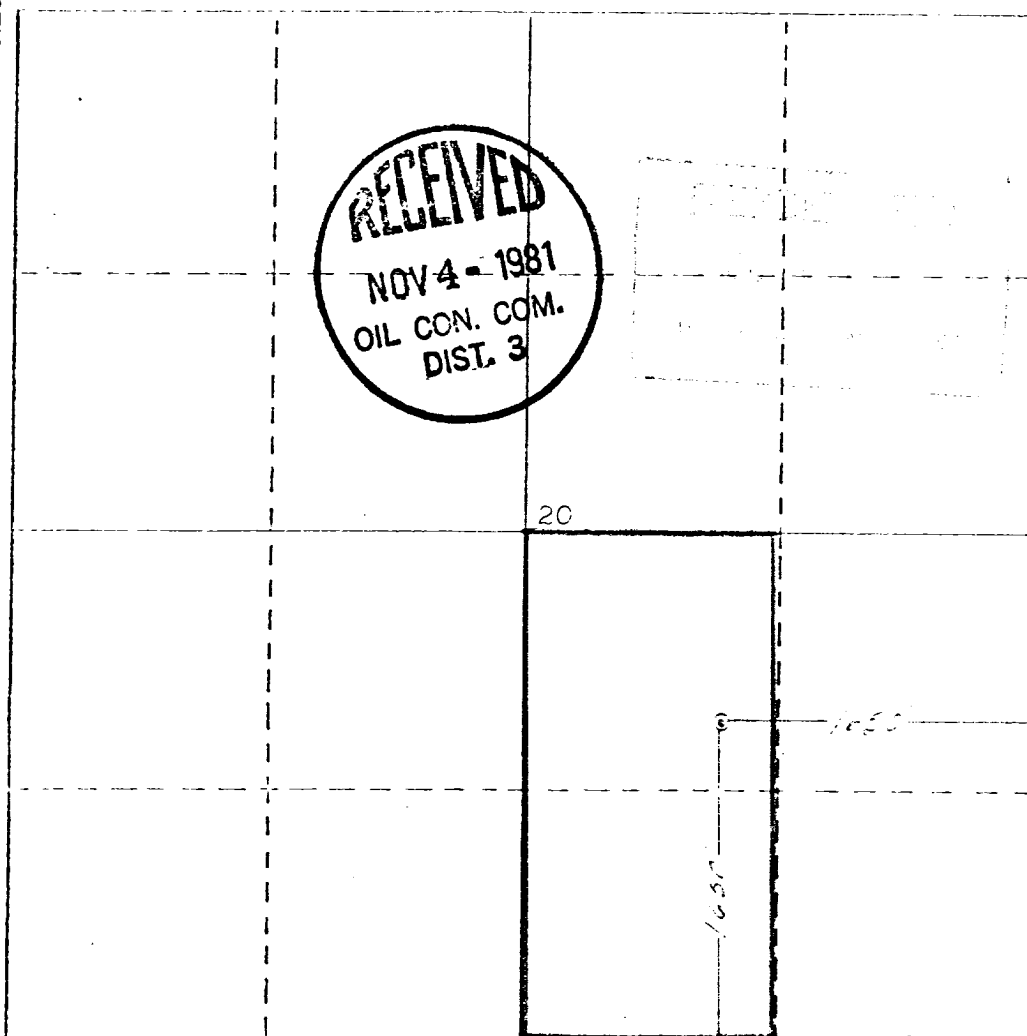

CERTIFICATION

I hereby certify that the information contained herein is true and complete to the best of my knowledge and belief.

Rudy D. Motto
Name _____

Rudy D. Motto
Position _____

Area Superintendent
Company _____

SUPRON ENERGY CORPORATION

Date _____

August 7, 1981

I hereby certify that the well location shown on this plat was plotted from field notes of actual surveys made by me or under my supervision, and that the same is true and correct to the best of my knowledge and belief.

Michael Daly

Registered Professional Engineer
and/or Land Surveyor

Michael Daly

Certificate No.
5992