

UNITED STATES  
DEPARTMENT OF THE INTERIOR  
GEOLOGICAL SURVEY

SUNDRY NOTICES AND REPORTS ON WELLS

(Do not use this form for proposals to drill or to deepen or plug back to a different reservoir. Use Form 9-331-C for such proposals.)

1. oil well ☐ gas well ☒ other

2. NAME OF OPERATOR

Beartooth Oil & Gas Company

3. ADDRESS OF OPERATOR

P. O. Box 2564, Billings, Montana

4. LOCATION OF WELL (REPORT LOCATION CLEARLY. See space 17 below.)

AT SURFACE: 1100' FSL, 875' FWL

AT TOP PROD. INTERVAL:

AT TOTAL DEPTH: same

16. CHECK APPROPRIATE BOX TO INDICATE NATURE OF NOTICE, REPORT, OR OTHER DATA

REQUEST FOR APPROVAL TO:

TEST WATER SHUT-OFF ☐  
FRACTURE TREAT ☐  
SHOOT OR ACIDIZE ☐  
REPAIR WELL ☐  
PULL OR ALTER CASING ☐  
MULTIPLE COMPLETE ☐  
CHANGE ZONES ☐  
ABANDON\* ☐

(other) Change Well Name

SUBSEQUENT REPORT OF:

☐  
☐  
☐  
☐  
☐  
☐  
☐  
☐

5. LEASE

SF-080565-A

6. IF INDIAN, ALLOTTEE OR TRIBE NAME

7. UNIT AGREEMENT NAME

8. FARM OR LEASE NAME

Minel-Federal

9. WELL NO.

#3-A (previously #2)

10. FIELD OR WILDCAT NAME

Blanco-Mesaverde

11. SEC., T., R., M., OR BLK. AND SURVEY OR AREA

SW<sup>1</sup>/<sub>4</sub>SW<sup>1</sup>/<sub>4</sub> Sec. 6-25N-3W

12. COUNTY OR PARISH

Rio Arriba

13. STATE

New Mexico

14. API NO.

15. ELEVATIONS (SHOW DF, KDB, AND WD)  
7159' GL

(NOTE: Report results of multiple completion or zone change on Form 9-330.)

17. DESCRIBE PROPOSED OR COMPLETED OPERATIONS (Clearly state all pertinent details, and give pertinent dates, including estimated date of starting any proposed work. If well is directionally drilled, give subsurface locations and measured and true vertical depths for all markers and zones pertinent to this work.)\*

Inasmuch as the Minel Federal #2 is to be drilled as a Mesaverde well, the name has to be changed to the Minel Federal #3-A according to State rules.



Subsurface Safety Valve: Manu. and Type \_\_\_\_\_ Set @ \_\_\_\_\_ Ft.

18. I hereby certify that the foregoing is true and correct

SIGNED Robert D. Ballantyne TITLE Drilling Supervisor DATE November 18, 1981  
Robert D. Ballantyne

(This space for Federal or State office use)

APPROVED BY \_\_\_\_\_ TITLE \_\_\_\_\_ DATE \_\_\_\_\_  
CONDITIONS OF APPROVAL, IF ANY:

ACCEPTED FOR RECORD

NOV 24 1981

FARMINGTON DISTRICT  
BY Sm

\*See Instructions on Reverse Side

NMOCC

All distances must be from the outer boundaries of the Section

CURTIS LITTLE		Lease		Minel		Well No. <u>42 3A</u>	
Unit Letter <u>D</u>	Section <u>6</u>	Township <u>25 NORTH</u>	Range <u>3 WEST</u>	County <u>RIO ARRIBA</u>			
Actual Footage Location of Well: 1100 feet from the <u>SOUTH</u> line and 875 feet from the <u>WEST</u> line							
Ground Level Elev. <u>7404</u>	Producing Formation <u>Dakota MESAVERDE</u>		Pool <u>BLANCO MESAVERDE -Basin-Dakota</u>		Dedicated Acreage <u>340</u>		Area

1. Outline the acreage dedicated to the subject well by colored pencil or hatchure marks on the plat below.
2. If more than one lease is dedicated to the well, outline each and identify the ownership thereof (both as to working interest and royalty).
3. If more than one lease of different ownership is dedicated to the well, have the interests of all owners been consolidated by communitization, unitization, force-pooling, etc?

☐ Yes ☐ No If answer is "yes," type of consolidation \_\_\_\_\_

If answer is "no," list the owners and tract descriptions which have actually been consolidated. (Use reverse side of this form if necessary.) \_\_\_\_\_

No allowable will be assigned to the well until all interests have been consolidated (by communitization, unitization, forced-pooling, or otherwise) or until a non-standard unit, eliminating such interests, has been approved by the Division.

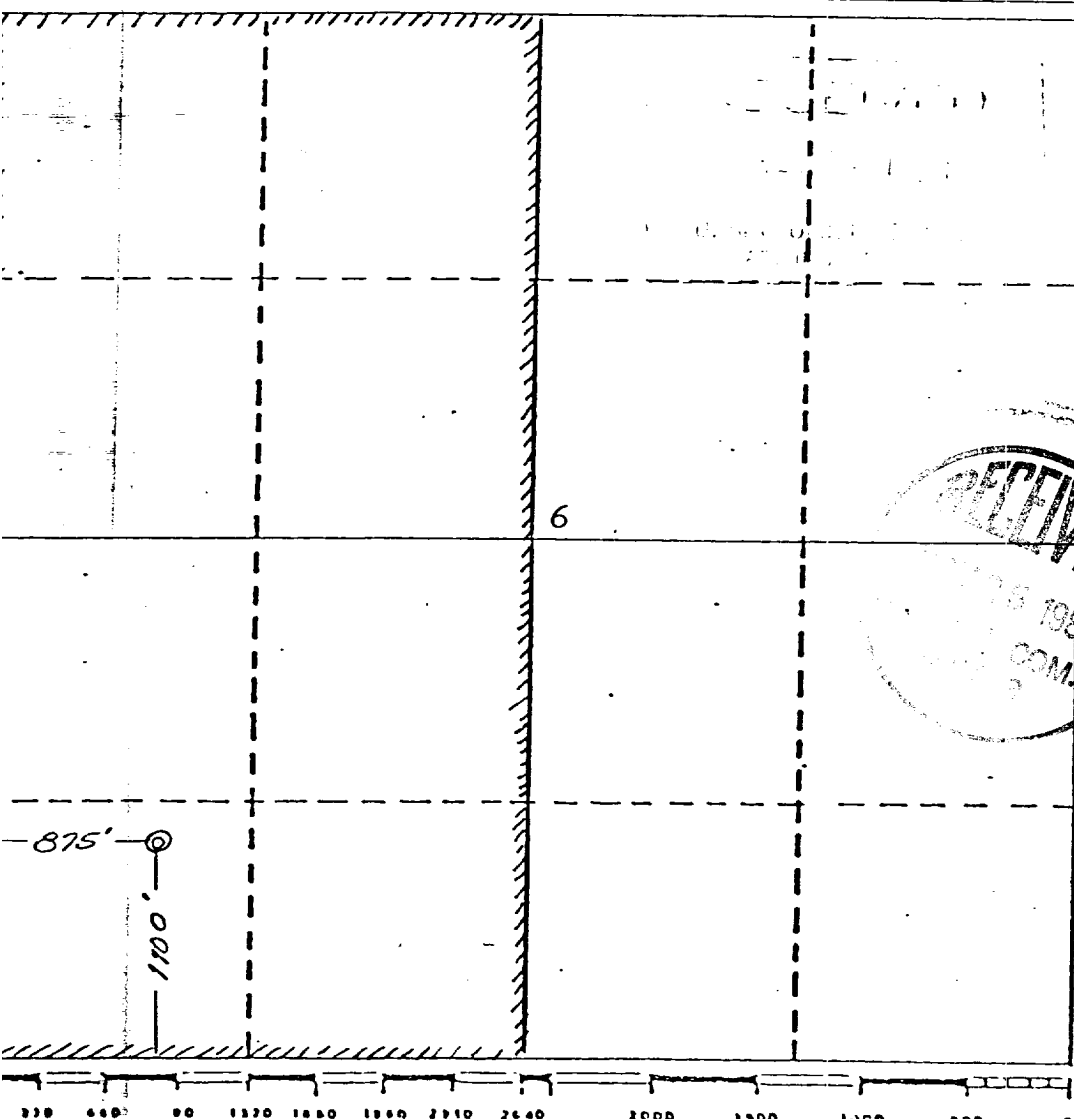

CERTIFICATION

I hereby certify that the information contained herein is true and complete to the best of my knowledge and belief.

Name CURTIS J. LITTLE

Position OPERATOR

Company CURTIS J. LITTLE

Date May 13, 1980

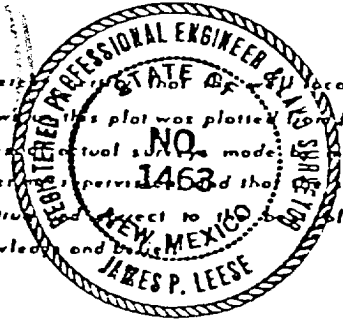
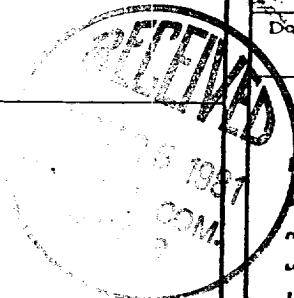

I hereby certify that this plat was plotted from field notes, actual survey made, or under supervision and that same is true and correct to the best of my knowledge and belief.

Date Surveyed  
April 16, 1980

Registered Professional Engineer  
and/or Land Surveyor  
James P. Leese  
James P. Leese

Certificate No.  
1463