

UNITED STATES  
DEPARTMENT OF THE INTERIOR  
GEOLOGICAL SURVEY

SUNDRY NOTICES AND REPORTS ON WELLS

(Do not use this form for proposals to drill or to deepen or plug back to a different reservoir. Use Form 9-331-C for such proposals.)

1. oil ☐ gas ☒ other

2. NAME OF OPERATOR

Petro-Lewis Corporation

3. ADDRESS OF OPERATOR

79490

1111 W. Loop 289, P.O. Box 16200 Lubbock, TX

4. LOCATION OF WELL (REPORT LOCATION CLEARLY. See space 17 below.)

AT SURFACE: 2036' FNL & 1000' FWL

AT TOP PROD. INTERVAL: Same

AT TOTAL DEPTH: Same

16. CHECK APPROPRIATE BOX TO INDICATE NATURE OF NOTICE, REPORT, OR OTHER DATA

REQUEST FOR APPROVAL TO:

SUBSEQUENT REPORT OF:

TEST WATER SHUT-OFF ☐

FRACTURE TREAT ☐

SHOOT OR ACIDIZE ☐

REPAIR WELL ☐

PULL OR ALTER CASING ☐

MULTIPLE COMPLETE ☐

CHANGE ZONES ☐

ABANDON\* ☐

(other) Change well designation

5. LEASE  
SF-080565

6. IF INDIAN, ALLOTTEE OR TRIBE NAME

7. UNIT AGREEMENT NAME

8. FARM OR LEASE NAME  
Florance

9. WELL NO.  
8A

10. FIELD OR WILDCAT NAME  
Blanco Mesaverde

11. SEC., T., R., M., OR BLK. AND SURVEY OR AREA  
Sec. 5, T25N, R3W

12. COUNTY OR PARISH: 13. STATE  
Rio Arriba New Mexico

14. API NO.  
30-039-22865

15. ELEVATIONS (SHOW DF, KDB, AND WD)  
7352' KB

(NOTE: Report results of multiple completion or zone change on Form 9-330.)

17. DESCRIBE PROPOSED OR COMPLETED OPERATIONS (Clearly state all pertinent details, and give pertinent dates, including estimated date of starting any proposed work. If well is directionally drilled, give subsurface locations and measured and true vertical depths for all markers and zones pertinent to this work.)\*

This well, formerly the Florance 11, has been completed in the Mesaverde formation. The well has been renamed the Florance 8A.

Subsurface Safety Valve: Manu. and Type \_\_\_\_\_ Set @ \_\_\_\_\_ Ft.

18. I hereby certify that the foregoing is true and correct

SIGNED William D. Fulton TITLE Sr. Petroleum Eng. DATE 3/21/83

(This space for Federal or State office use)

APPROVED BY \_\_\_\_\_ TITLE \_\_\_\_\_ DATE \_\_\_\_\_  
CONDITIONS OF APPROVAL, IF ANY:

ACCEPTED FOR RECORD

MAR 29 1983

\*See Instructions on Reverse Side

FARMINGTON  
BY JFK

NMOCC

NEW MEXICO OIL CONSERVATION COMMISSION  
WELL LOCATION AND ACREAGE DEDICATION PLAT

Form C-102  
Supersedes C-128  
Effective 1-1-65

All distances must be from the outer boundaries of the Section.

|  |   |                        |                                 |                             |  |   |  |  |
|--|---|------------------------|---------------------------------|-----------------------------|--|---|--|--|
| Operator<br><b>Petro-Lewis Corporation</b>   |   |                        | Lease<br><b>Florance</b>        |                             |  | Well No.<br><b>8A</b>                     |  |  |
| Unit Letter<br><b>E</b>  | Section<br><b>5</b>                     | Township<br><b>25N</b> | Range<br><b>3W</b>              | County<br><b>Rio Arriba</b> |  |   |  |  |
| Actual Footage Location of Well:<br><b>2036</b> feet from the <b>North</b> line and <b>1000</b> feet from the <b>West</b> line |   |                        |                                 |                             |  |   |  |  |
| Ground Level Elev.<br><b>7340'</b>   | Producing Formation<br><b>Mesaverde</b> |                        | Pool<br><b>Blanco Mesaverde</b> |                             |  | Dedicated Acreage:<br><b>390.84</b> Acres |  |  |

- Outline the acreage dedicated to the subject well by colored pencil or hachure marks on the plat below.
- If more than one lease is dedicated to the well, outline each and identify the ownership thereof (both as to working interest and royalty).
- If more than one lease of different ownership is dedicated to the well, have the interests of all owners been consolidated by communitization, unitization, force-pooling, etc?

☐ Yes ☐ No If answer is "yes," type of consolidation \_\_\_\_\_

If answer is "no," list the owners and tract descriptions which have actually been consolidated. (Use reverse side of this form if necessary.) \_\_\_\_\_

No allowable will be assigned to the well until all interests have been consolidated (by communitization, unitization, forced-pooling, or otherwise) or until a non-standard unit, eliminating such interests, has been approved by the Commission.

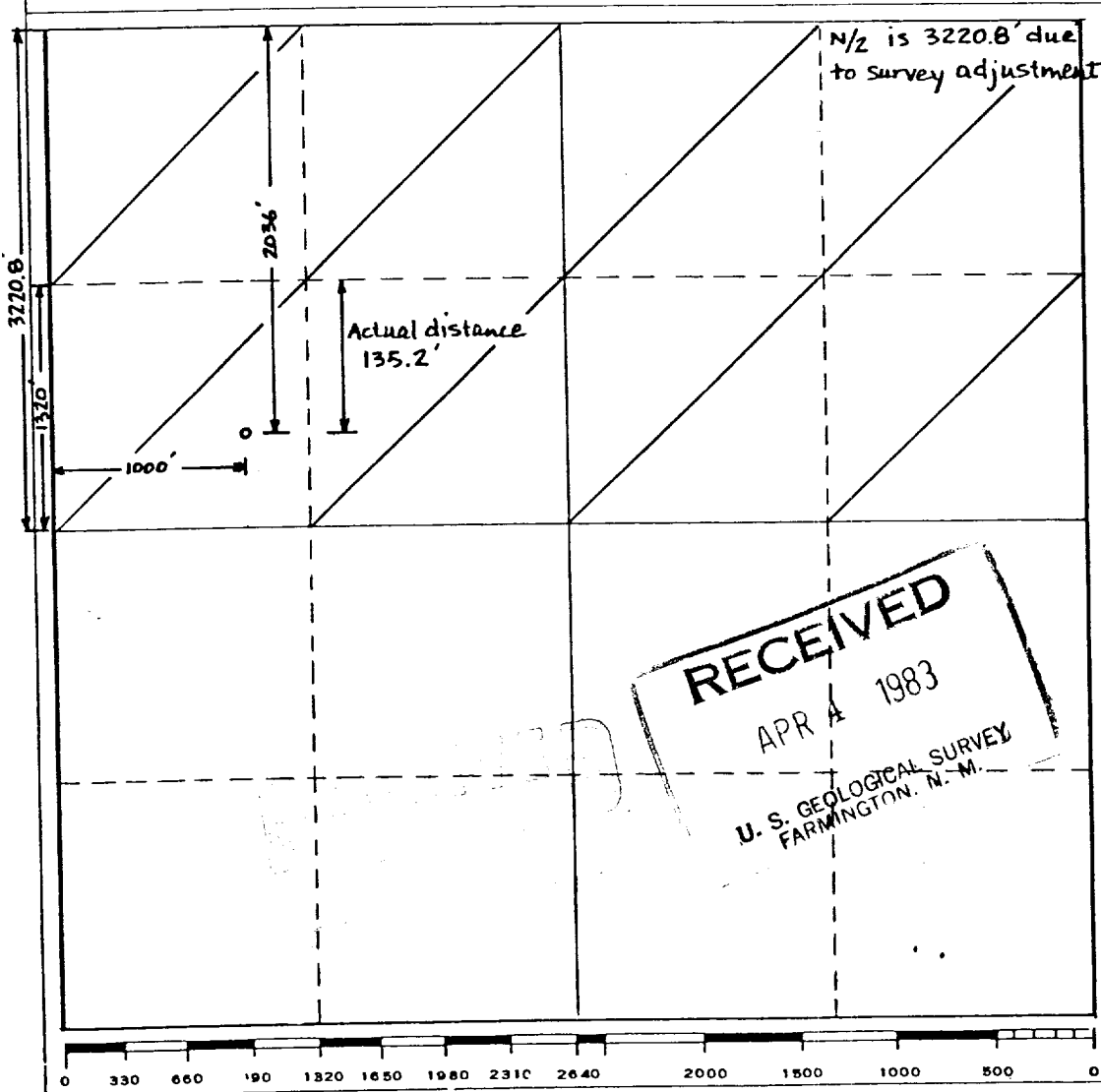

CERTIFICATION

I hereby certify that the information contained herein is true and complete to the best of my knowledge and belief.

Name: William D. Fulton  
 Position: Sr. Petroleum Engineer  
 Company: Petro-Lewis Corporation  
 Date: March 29, 1983

I hereby certify that the well location shown on this plat was plotted from field notes of actual surveys made by me or under my supervision, and that the same is true and correct to the best of my knowledge and belief.

Date Surveyed: \_\_\_\_\_  
 Registered Professional Engineer and/or Land Surveyor: \_\_\_\_\_

Certificate No. \_\_\_\_\_

