

NEW MEXICO OIL CONSERVATION COMMISSION
WELL LOCATION AND ACREAGE DEDICATION PLAT

Form C-102
Supersedes C-128
Effective 1-1-85

All distances must be from the outer boundaries of the Section.

Operator MINEL INCORPORATED		Lease Cavias		Well No. 1	
Init Letter G	Section 2	Township 25N	Range 3W	County Rio Arriba	
Actual Footage Location of Well: 2290 feet from the North line and 1850 feet from the East line					
Ground Level Elev. 7319	Producing Formation Pictured Cliff		Pool Tapacito		Dedicated Acreage 175.186.17 Acres

1. Outline the acreage dedicated to the subject well by colored pencil or hatchure marks on the plat below.
2. If more than one lease is dedicated to the well, outline each and identify the ownership thereof (both as to working interest and royalty).
3. If more than one lease of different ownership is dedicated to the well, have the interests of all owners been consolidated by communitization, unitization, force-pooling, etc?

☒ Yes ☐ No If answer is "yes," type of consolidation _____ Communitization _____

If answer is "no," list the owners and tract descriptions which have actually been consolidated. (Use reverse side of this form if necessary.) _____

No allowable will be assigned to the well until all interests have been consolidated (by communitization, unitization, forced-pooling, or otherwise) or until a non-standard unit, eliminating such interests, has been approved by the Commission.

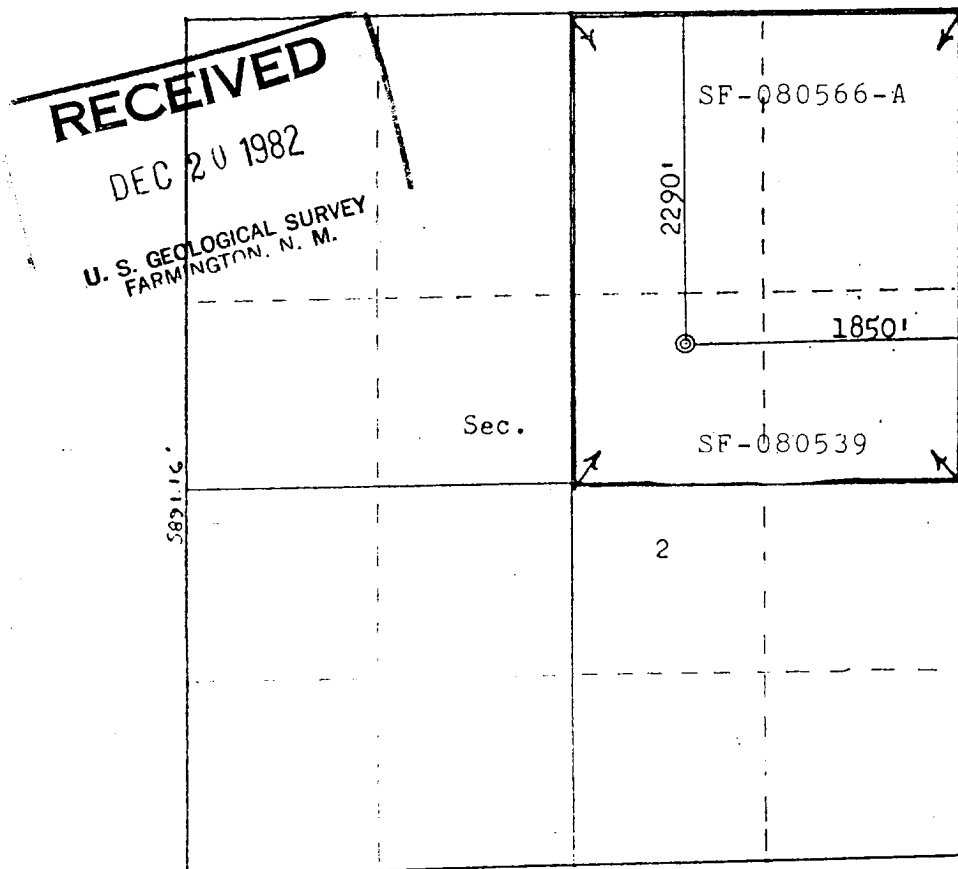

Lease numbers corrected as per telephone conversation between Mr. H.P. Walters and Joe Elledge, on December 20, 1982.
Scale: 1"=1320'

CERTIFICATION

I hereby certify that the information contained herein is true and complete to the best of my knowledge and belief.

Name
Joe Elledge
Position
Agent
Company
Minel Inc.
Date
10-28-81

I hereby certify that the well location shown on this plat was plotted from field notes of actual surveys made by me or under my supervision, and that the same is true and correct to the best of my knowledge and belief.

Date Surveyed
October 24, 1982
Registered Professional Engineer and Land Surveyor
Fred B. Korman
Certificate No.
3950