

District I
PO Box 1900, Hobbs, NM 88241-1900
District II
811 South First, Artesia, NM 88210
District III
1000 Rio Brasso Rd., Aztec, NM 87410
District IV
2040 South Pacheco, Santa Fe, NM 87505

State of New Mexico
Energy, Minerals & Natural Resources Department

OIL CONSERVATION DIVISION
2040 South Pacheco
Santa Fe, NM 87505

Form C-102
Revised October 18, 1994
Instructions on back
Submit to Appropriate District Office
State Lease - 4 Copies
Fee Lease - 3 Copies

☐ AMENDED REPORT

WELL LOCATION AND ACREAGE DEDICATION PLAT

API Number 30-03923252		Pool Code 96489		Pool Name WILDCAT, 25NSWTD - GALLUP CO	
Property Code		Property Name JICARILLA CONTRACT 147			Well Number 5E
OGRID No.		Operator Name AMOCO PRODUCTION CO.			Elevation 6705

10 Surface Location

UL or lot no. D	Section 7	Township 25N	Range 05W	Lot Idn 1	Feet from the 990	North/South line NORTH	Feet from the 960	East/West line WEST	County RA
--------------------	--------------	-----------------	--------------	--------------	----------------------	---------------------------	----------------------	------------------------	--------------

11 Bottom Hole Location If Different From Surface

UL or lot no.	Section	Township	Range	Lot Idn	Feet from the	North/South line	Feet from the	East/West line	County
---------------	---------	----------	-------	---------	---------------	------------------	---------------	----------------	--------

Dedicated Acres 39.62	Joint or Infill	Consolidation Code	Order No.
--------------------------	-----------------	--------------------	-----------

NO ALLOWABLE WILL BE ASSIGNED TO THIS COMPLETION UNTIL ALL INTERESTS HAVE BEEN CONSOLIDATED
OR A NON-STANDARD UNIT HAS BEEN APPROVED BY THE DIVISION

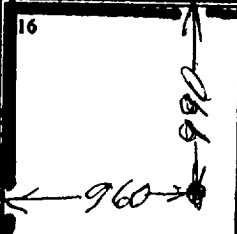
<div>16</div> 					17 OPERATOR CERTIFICATION I hereby certify that the information contained herein is true and complete to the best of my knowledge and belief. Signature: <u>Patty Haeefe</u> Patty Haeefe Printed Name: <u>Staff Assistant</u> Title: <u>2/29/96</u> Date: <u></u>	
					18 SURVEYOR CERTIFICATION I hereby certify that the well location shown on this plat was plotted from field notes of actual surveys made by me or under my supervision, and that the same is true and correct to the best of my belief. Date of Survey: <u></u> Signature and Seal of Professional Surveyor: <u></u> Certificate Number: <u></u>	
	<div>RECEIVED MAR - 1 1996 OIL CON. DIV. DIST. 3</div>					

101000
BJS 96
sep-08
SUBMIT 1 COPY TO
NATURAL RESOURCE DEPT
AND OIL & GAS ADMINISTRATION

RECEIVED
AUG 18 1999

OIL CON. DIV.

DIST. 3

RANKING SCORE (TOTAL POINTS): 2

BT596

Blow PIT

Date Remediation Started: _____ Date Completed: 7/30/98

Remediation Method: Excavation ☒ Approx. cubic yards 700
Check all appropriate sections) Landfarmed ☒ Insitu Bioremediation _____
Other _____

Remediation Location: Onsite ☒ Offsite _____
(i.e. landfarmed onsite, name and location of offsite facility)

General Description of Remedial Action: Excavation, BEDROCK BOTTOM.

Groundwater Encountered: No ☒ Yes _____ Depth _____

Final Pit: Closure Sampling: (if multiple samples, attach sample results and diagram of sample locations and depths)

Sample location see Attached Documents

Sample depth 10' (EAST SIDEWALK)

Sample date 7/30/98 Sample time 1000

Sample Results

Soil: Benzene	(ppm)	_____	Water: Benzene	(ppb)	_____
Total BTEX	(ppm)	_____	Toluene	(ppb)	_____
Field Headspace	(ppm)	<u>0.0</u>	Ethylbenzene	(ppb)	_____
TPH	(ppm)	<u>ND</u>	Total Xylenes	(ppb)	_____

Groundwater Sample: Yes _____ No ☒ (If yes, attach sample results)

I HEREBY CERTIFY THAT THE INFORMATION ABOVE IS TRUE AND COMPLETE TO THE BEST OF MY KNOWLEDGE AND BELIEF

DATE 7/30/98 PRINTED NAME Buddy D. Shaw
SIGNATURE Buddy D. Shaw AND TITLE Environmental Coordinator

AFTER REVIEW OF THE PIT CLOSURE INFORMATION, PIT CLOSURE IS APPROVED IN ACCORDANCE TO THE JICARILLA APACHE TRIBE PIT CLOSURE ORDINANCE.

APPROVED: YES ☒ NO _____ (REASON) _____

SIGNED: Kim C Marshall DATE: 9-9-98

3003923252

CLIENT: <u>AMOCO</u>	BLAGG ENGINEERING, INC. P.O. BOX 87, BLOOMFIELD, NM 87413 (505) 632-1199	LOCATION NO: <u>BT596</u> C.O.C. NO: _____
----------------------	--	---

FIELD REPORT: CLOSURE VERIFICATION

PAGE No: 1 of 1

LOCATION: NAME: <u>JICA CONTR. 147</u> WELL #: <u>5E</u> PIT: <u>BLOW</u>	DATE STARTED: <u>7/30/98</u> DATE FINISHED: _____
QUAD/UNIT: <u>D</u> SEC: <u>7</u> TWP: <u>25N</u> RNG: <u>5W</u> PM: <u>UM</u> CNTY: <u>RA</u> ST: <u>NM</u>	ENVIRONMENTAL SPECIALIST: <u>NV</u>
QTR/FOOTAGE: <u>900' FNL / 960' FWL</u> CONTRACTOR: <u>PBS</u>	

EXCAVATION APPROX. <u>44</u> FT. x <u>43</u> FT. x <u>16</u> FT. DEEP.	CUBIC YARDAGE: <u>700</u>
DISPOSAL FACILITY: <u>ON-SITE</u>	REMEDIATION METHOD: <u>LANDFARM</u>
LAND USE: <u>RANGE</u>	LEASE: <u>JIC 147</u> FORMATION: <u>OK</u>

FIELD NOTES & REMARKS:	PIT LOCATED APPROXIMATELY <u>110</u> FT. <u>S66E</u> FROM WELLHEAD.
DEPTH TO GROUNDWATER: <u>>100'</u>	NEAREST WATER SOURCE: <u>>1000'</u> NEAREST SURFACE WATER: <u>>1000'</u>
NMOC D RANKING SCORE: <u>0</u>	NMOC D TPH CLOSURE STD: <u>5000</u> PPM
SOIL AND EXCAVATION DESCRIPTION:	

CHECK ONE:
<input checked="" type="checkbox"/> PIT ABANDONED
<input type="checkbox"/> STEEL TANK INSTALLED
<input type="checkbox"/> FIBERGLASS TANK INSTALLED

SIDEWALLS - DK. YELL. BROWN TO DUNE GRAY SILTY SAND TO SILTY CLAY, NON COHESIVE TO COHESIVE, SLIGHTLY MOIST, FIRM TO STIFF, NO APPARENT HC ODOOR DETECTED W/IN EXCAVATION OR ANY OF THE OVM SAMPLES. ISOLATED PATCHES OF HC STAINING OBSERVED ON NORTH SIDEWALL FROM 12'-16' BELOW GRADE (BEDROCK), 6" THICK ACROSS CENTER OF OF SOUTH SIDEWALL.

BOTTOM - BEDROCK (SHALE), VERY HARD LT. MED. GRAY IN COLOR, NO APPARENT HC ODOOR DETECTED IN OVM SAMPLE.

BEDROCK
BOTTOM

CLOSED

FIELD 418.1 CALCULATIONS

TIME	SAMPLE I.D.	LAB No:	WEIGHT (g)	mL. FREON	DILUTION	READING	CALC. ppm
1000	② e 10'	TPH-2006	5	20	1:1	5	ND

SCALE



0 FT

PIT PERIMETER

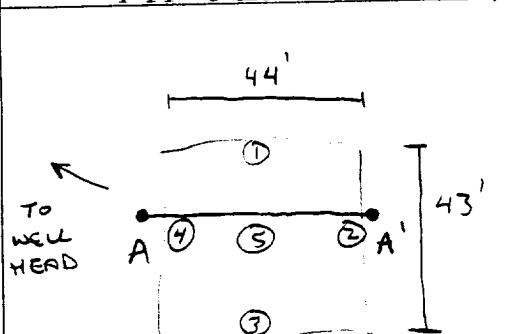
OVM
RESULTS

SAMPLE ID	FIELD HEADSPACE PID (ppm)
1 e 9'	0.0
2 e 10'	0.0
3 e 10'	0.0
4 e 8'	0.0
5 e 16'	0.0

LAB SAMPLES

SAMPLE ID	ANALYSIS	TIME

PIT PROFILE

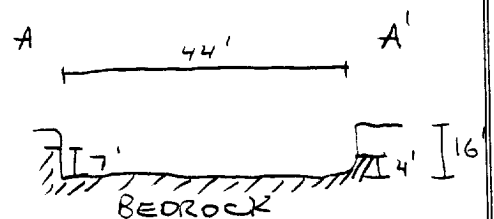

TRAVEL NOTES:

CALLOUT: 7/29/98 - MORN. ONSITE: 7/30/98 - MORN.

BLAGG ENGINEERING, INC.
P.O. Box 87, Bloomfield, New Mexico 87413
Phone: (505)632-1199 Fax: (505)632-3903

**FIELD MODIFIED EPA METHOD 418.1
TOTAL PETROLEUM HYDROCARBONS**

Client:	AMOCO	Project #:	
Sample ID:	2 @ 10'	Date Analyzed:	07-30-98
Project Location:	Jicarilla Contract # 147 - 5E	Date Reported:	07-30-98
Laboratory Number:	TPH-2006	Sample Matrix:	Soil

Parameter	Result, mg/kg	Detection Limit, mg/kg
Total Recoverable Petroleum Hydrocarbons	ND	20

ND = Not Detectable at stated detection limits.

QA/QC:	QA/QC Sample TPH mg/kg	Duplicate TPH mg/kg	% *Diff.
	228	244	6.78

*Administrative Acceptance limits set at 30%.

Method: Modified Method 418.1, Petroleum Hydrocarbons, Total
Recoverable, Chemical Analysis of Water and Waste,
USEPA Storet No.4551, 1978

Comments: Blow Pit - BJ596

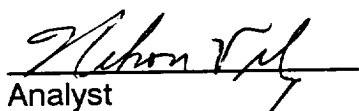
Analyst

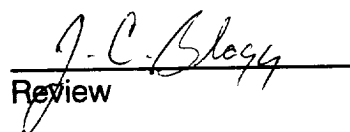
Review

BLAGG ENGINEERING, INC.

P.O. Box 87, Bloomfield, New Mexico 87413

Phone: (505)632-1199 Fax: (505)632-3903

Field TPH-Worksheet

Max Characters:

Client:

AMOCO

Project #:

Sample ID:

2 @ 10'

Date Analyzed:

07-30-98

Project Location:

Jicarilla Contract # 147 - 5E

Date Reported:

07-30-98

Laboratory Number:

TPH-2006

Sample Matrix:

Soil

Sample Weight:

5.00 grams

Volume Freon:

20.00 mL

Dilution Factor:

1 (unitless)

TPH Reading:

5 mg/kg

TPH Result:

20.0 mg/kg

Reported TPH Result:

20 mg/kg

Actual Detection Limit:

20.0 mg/kg

Reported Detection Limit:

20 mg/kg

QA/QC:

Original
TPH mg/kg

Duplicate
TPH mg/kg

%
Diff.

228

244

6.78

Comments:

*****Max Characters*****

Comments:

Blow Pit - BJ596

8J596

**JICARILLA APACHE TRIBE
ENVIRONMENTAL PROTECTION OFFICE
P.O. BOX 507
DULCE, NEW MEXICO 87528**

SUBMIT 1 COPY TO
NATURAL RESOURCE DEPT
AND OIL & GAS ADMINISTRATION

PIT REMEDIATION AND CLOSURE REPORT

Operator: AMOCO PRODUCTION COMPANY **Telephone:** (505) 326-9200
Address: 200 Amoco Court, Farmington, NM 87401
Facility or Well Name: JICARILLA CONTRACT #147-SE
Location: Unit or Qtr/Qtr Sec D Sec 7 T 25N R 5W County RIO ARIZONA
Pit Type: Separator ☒ Dehydrator ☐ Other ☐
Land Type: RANGE

Pit Location: Pit dimensions: length 29', width 30', depth 6'
(Attach diagram) Reference: wellhead ☒, other ☐
Footage from reference: 155'
Direction from reference: 50 Degrees ☐ East of North ☒
☒ West of South ☐

Depth To Groundwater: (Vertical distance from contaminants to seasonal high water elevation of groundwater)	Less than 50 feet (20 points) 50 feet to 99 feet (10 points) Greater than 100 feet (0 points)	<u>0</u>
Distance to an Ephemeral Stream (Downgradient dry wash greater than ten feet in width)	Less than 100 feet (10 points) Greater than 100 feet (0 points)	<u>0</u>
Distance to Nearest Lake, Playa, or Watering Pond (Downgradient lakes, playas and livestock or wildlife watering ponds)	Less than 100 feet (10 points) Greater than 100 feet (0 points)	<u>0</u>
Wellhead Protection Area: (Less than 200 feet from a private domestic water source, or: less than 1000 feet from all other water sources)	Yes (20 points) No (0 points)	<u>0</u>
Distance To Surface Water: (Horizontal distance to perennial lakes, ponds, rivers, streams, creeks, irrigation canals and ditches)	Less than 100 feet (20 points) 100 feet to 1000 feet (10 points) Greater than 1000 feet (0 points)	<u>0</u>

RANKING SCORE (TOTAL POINTS): 0

BJ 596

SEP. PIT

Date Remediation Started: _____ Date Completed: 7/30/98Remediation Method: Excavation ☒
(check all appropriate sections)Landfarmed ☒

Other _____

Approx. cubic yards 150

Insitu Bioremediation _____

Remediation Location:
(i.e. landfarmed onsite,
name and location of
offsite facility)Onsite ☒ Offsite _____General Description of Remedial Action: Excavation. BEDROCK BOTTOM.

Groundwater Encountered:

No ☒

Yes _____

Depth _____

Final Pit:
Closure Sampling:
(if multiple samples,
attach sample results
and diagram of sample
locations and depths)Sample location see Attached DocumentsSample depth 3' (EAST SIDEWALL)Sample date 1/30/98Sample time 0830

Sample Results

Soil: Benzene (ppm) _____

Water: Benzene (ppb) _____

Total BTEX (ppm) _____

Toluene (ppb) _____

Field Headspace (ppm) 0.0

Ethylbenzene (ppb) _____

TPH (ppm) ND

Total Xylenes (ppb) _____

Groundwater Sample: Yes _____ No ☒ (If yes, attach sample results)

I HEREBY CERTIFY THAT THE INFORMATION ABOVE IS TRUE AND COMPLETE TO THE BEST OF MY KNOWLEDGE AND BELIEF

DATE

7/30/98

PRINTED NAME

Buddy D. Shaw

SIGNATURE

Buddy D. Shaw

AND TITLE

Environmental Coordinator

AFTER REVIEW OF THE PIT CLOSURE INFORMATION, PIT CLOSURE IS APPROVED IN ACCORDANCE TO THE JICARILLA APACHE TRIBE PIT CLOSURE ORDINANCE.

APPROVED: YES ☒ NO _____ (REASON) _____

SIGNED:

K. C. M...

DATE:

9-9-98

CLIENT: <u>AMOCO</u>	BLAGG ENGINEERING, INC. P.O. BOX 87, BLOOMFIELD, NM 87413 (505) 632-1199	LOCATION NO: <u>BJ596</u> C.O.C. NO: _____
----------------------	--	---

FIELD REPORT: CLOSURE VERIFICATION	PAGE No: <u>1</u> of <u>1</u>
------------------------------------	-------------------------------

LOCATION: NAME: <u>JICA CONTR. 147</u> WELL #: <u>5E</u> PIT: <u>SEP</u> QUAD/UNIT: <u>D</u> SEC: <u>7</u> TWP: <u>25N</u> RNG: <u>5W</u> PM: <u>NM</u> CNTY: <u>RA</u> ST: <u>NM</u> QTR/FOOTAGE: <u>900' FNL / 960' FNL</u> CONTRACTOR: <u>P&S</u>	DATE STARTED: <u>7/30/98</u> DATE FINISHED: _____ ENVIRONMENTAL SPECIALIST: <u>NV</u>
--	---

EXCAVATION APPROX. <u>29</u> FT. x <u>30</u> FT. x <u>6</u> FT. DEEP.	CUBIC YARDAGE: <u>150</u>
DISPOSAL FACILITY: <u>ON-SITE</u>	REMEDIALATION METHOD: <u>LANDFARM</u>
LAND USE: <u>RANGE</u>	LEASE: <u>JIC 147</u> FORMATION: <u>DK</u>

FIELD NOTES & REMARKS:	PIT LOCATED APPROXIMATELY <u>155</u> FT. <u>NSW</u> FROM WELLHEAD. DEPTH TO GROUNDWATER: <u>2100'</u> NEAREST WATER SOURCE: <u>21000'</u> NEAREST SURFACE WATER: <u>21000'</u> NMOC D RANKING SCORE: <u>0</u> NMOC D TPH CLOSURE STD: <u>5000</u> PPM
------------------------	---

CHECK ONE:
☒ PIT ABANDONED
☐ STEEL TANK INSTALLED
☐ FIBERGLASS TANK INSTALLED

SOIL AND EXCAVATION DESCRIPTION:

SIDEWALLS - OK. YELL BROWN SILTY SAND TO OLIVE GRAY BEDROCK (SHALE)
 SAND - NON COHESIVE SLIGHTLY MOIST, FIRM NO APPARENT STAINING
 OR HC ODOR OBSERVED / DETECTED w/in SAND
 BEDROCK - SOFT TO VERY HARD FROM 3'-6' BELOW GRADE w/in NORTH & SOUTH SIDEWALLS
 BOTTOM - BEDROCK (SHALE) VERY HARD, PARAFFIN LIKE STAINING, MED. GRAY IN COLOR, SLIGHT HC ODOR DETECTED IN OVN SAMPLE.

BEADROCK BOTTOM

SCALE

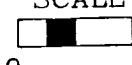

0 FT

CLOSED

FIELD 418.1 CALCULATIONS

TIME	SAMPLE I.D.	LAB No:	WEIGHT (g)	mL. FREON	DILUTION	READING	CALC. ppm
0830	② @ 3'	TPH-2007	5	20	1:1	4	ND

PIT PERIMETER

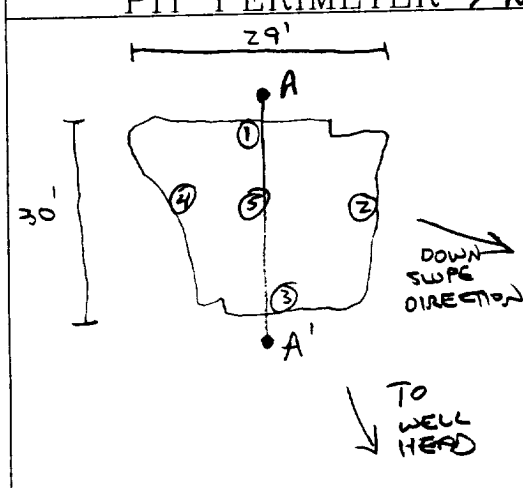

PIT PROFILE

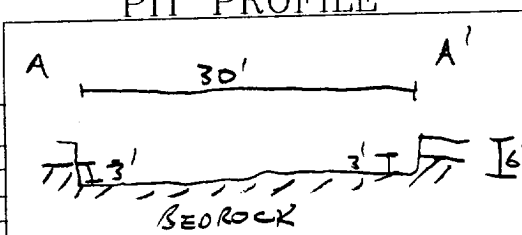

OVM RESULTS		
SAMPLE ID	FIELD HEADSPACE PID (ppm)	
1 @ 4'	19.8	RK
2 @ 3'	0.0	
3 @ 4'	94.8	RK
4 @ 3'	0.0	
5 @ 6'	51.7	RK

LAB SAMPLES		
SAMPLE ID	ANALYSIS	TIME

TRAVEL NOTES: CALLOUT: 7/29/98 - MORN. ONSITE: 7/30/98 - MORN.

BLAGG ENGINEERING, INC.
P.O. Box 87, Bloomfield, New Mexico 87413
Phone: (505)632-1199 Fax: (505)632-3903

**FIELD MODIFIED EPA METHOD 418.1
TOTAL PETROLEUM HYDROCARBONS**

Client:	AMOCO	Project #:	
Sample ID:	2 @ 3'	Date Analyzed:	07-30-98
Project Location:	Jicarilla Contract # 147 - 5E	Date Reported:	07-30-98
Laboratory Number:	TPH-2007	Sample Matrix:	Soil

Parameter	Result, mg/kg	Detection Limit, mg/kg
Total Recoverable Petroleum Hydrocarbons	ND	20

ND = Not Detectable at stated detection limits.

QA/QC:	QA/QC Sample TPH mg/kg	Duplicate TPH mg/kg	% *Diff.
	228	244	6.78

*Administrative Acceptance limits set at 30%.

Method: Modified Method 418.1, Petroleum Hydrocarbons, Total Recoverable, Chemical Analysis of Water and Waste, USEPA Storet No.4551, 1978

Comments: Separator Pit - BJ596

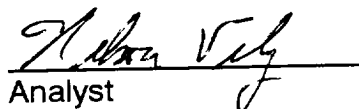
Analyst

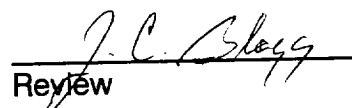
Review

BLAGG ENGINEERING, INC.

P.O. Box 87, Bloomfield, New Mexico 87413

Phone: (505)632-1199 Fax: (505)632-3903

Field TPH-Worksheet

Max Characters:

Client:

Sample ID:

Project Location:

Laboratory Number:

AMOCO

2 @ 3'

Jicarilla Contract # 147 - 5E

TPH-2007

Project #:

Date Analyzed:

Date Reported:

Sample Matrix:

07-30-98

07-30-98

Soil

Sample Weight:

5.00 grams

Volume Freon:

20.00 mL

Dilution Factor:

1 (unitless)

TPH Reading:

4 mg/kg

TPH Result:

16.0 mg/kg

Reported TPH Result:

16 mg/kg

Actual Detection Limit:

20.0 mg/kg

Reported Detection Limit:

20 mg/kg

QA/QC:

Original
TPH mg/kg

228

Duplicate
TPH mg/kg

244

%
Diff.

6.78

Comments:

*****Max Characters*****

Comments:

Separator Pit - BJ596

**JICARILLA APACHE TRIBE
ENVIRONMENTAL PROTECTION OFFICE
P.O. BOX 507
DULCE, NEW MEXICO 87528**

SUBMIT 1 COPY TO
NATURAL RESOURCE DEPT
AND OIL & GAS ADMINISTRATION

ON-SITE SOIL REMEDIATION REPORT

Operator: <u>AMOCO PRODUCTION COMPANY</u>		Telephone: <u>(505) 326-9200</u>
Address: <u>200 Amoco Court, Farmington, NM 87401</u>		
Facility or Well Name: <u>JICARILLA CONTRACT 147 SE</u>		
Location: Unit or Qtr/Qtr Sec <u>D</u> Sec <u>7</u> T <u>25N</u> R <u>5W</u> County <u>RIO ARIZONA</u>		
Land Type: <u>RANGE</u>		
Date Remediation Started: <u>7.30.98</u>		Date Completed: <u>4/3/99</u>
Remediation Method: Landfarmed <input checked="" type="checkbox"/>		Approx. cubic yards <u>850</u>
Composted <input type="checkbox"/>		
Other <input type="checkbox"/>		
Depth To Groundwater: (pts.) <u>0</u>		Final Closure Sampling: Sampling Date: <u>3.31.99</u> Time: <u>1000</u> Sample Results: Field Headspace (ppm) <u>8.3</u> TPH (ppm) <u>2,730</u> Method <u>8015</u> Other _____
Distance to an Ephemeral Stream (pts.) <u>0</u>		
Distance to Nearest Lake, Playa, or Watering Pond (pts.) <u>0</u>		
Wellhead Protection Area: (pts.) <u>0</u>		
Distance To Surface Water: (pts.) <u>0</u>		
RANKING SCORE (TOTAL POINTS): <u>0</u>		
I HEREBY CERTIFY THAT THE INFORMATION ABOVE IS TRUE AND COMPLETE TO THE BEST OF MY KNOWLEDGE AND BELIEF		
DATE <u>4/3/99</u>		PRINTED NAME <u>Buddy D. Shaw</u>
SIGNATURE <u>Buddy D. Shaw</u>		AND TITLE <u>Environmental Coordinator</u>
AFTER REVIEW OF THE SOIL REMEDIATION INFORMATION, ON-SITE REMEDIATION IS APPROVED IN ACCORDANCE TO THE JICARILLA APACHE TRIBE PIT CLOSURE ORDINANCE.		
APPROVED: YES <input type="checkbox"/> NO <input type="checkbox"/> (REASON) _____		
SIGNED: _____ DATE: _____		

CLIENT: <u>AMOCO</u>	BLAGG ENGINEERING, INC. P.O. BOX 87, BLOOMFIELD, NM 87413 (505) 632-1199	LOCATION NO: <u>B5596</u> C.O.C. NO: <u>0585</u>
----------------------	--	---

FIELD REPORT: LANDFARM/COMPOST PILE CLOSURE VERIFICATION	
LOCATION: NAME: <u>JICARILLA CONTRACT 147</u> WELL #: <u>SE</u> PITS: <u>SEP, BLOW</u>	DATE STARTED: <u>8-31-99</u> DATE FINISHED: _____
QUAD/UNIT: <u>D</u> SEC: <u>7</u> TWP: <u>25N</u> RNG: <u>5W</u> PM: <u>NM</u> CNTY: <u>RA</u> ST: <u>NM</u>	ENVIRONMENTAL SPECIALIST: <u>REP</u>
QTR/FOOTAGE: <u>NW/4 NW/4</u> CONTRACTOR: <u>P+S</u>	

SOIL REMEDIATION:	
REMEDIATION SYSTEM: <u>LANDFARM</u>	APPROX. CUBIC YARDAGE: <u>850</u>
LAND USE: <u>RANGE</u>	LIFT DEPTH (ft): <u>1-2</u>

FIELD NOTES & REMARKS:	
DEPTH TO GROUNDWATER: <u>>100'</u> NEAREST WATER SOURCE: <u>>1000'</u> NEAREST SURFACE WATER: <u>>1000'</u>	
NMOC D RANKING SCORE: <u>0</u> NMOC D TPH CLOSURE STD: <u>5000</u> PPM	
<p>OK. YELLOWISH BROWN SAND, NON COHESIVE, SLIGHTLY MOIST, FIRM.</p> <p>TWO LARGE AREAS OF STAINING IN LANDFARM AREA #1 (SEE SKETCH BELOW)</p> <p>H/C ODOR DETECTED IN SAMPLING POINTS ① + ③. SAMPLING DEPTHS RANGE FROM 6" - 18". TOOK A SPT. COMPOSITE SAMPLE FOR LAB ANALYSIS</p>	

CLOSED

FIELD 418.1 CALCULATIONS

SAMP. TIME	SAMPLE I.D.	LAB No:	WEIGHT (g)	mL. FREON	DILUTION	READING	CALC. ppm

SKETCH/SAMPLE LOCATIONS

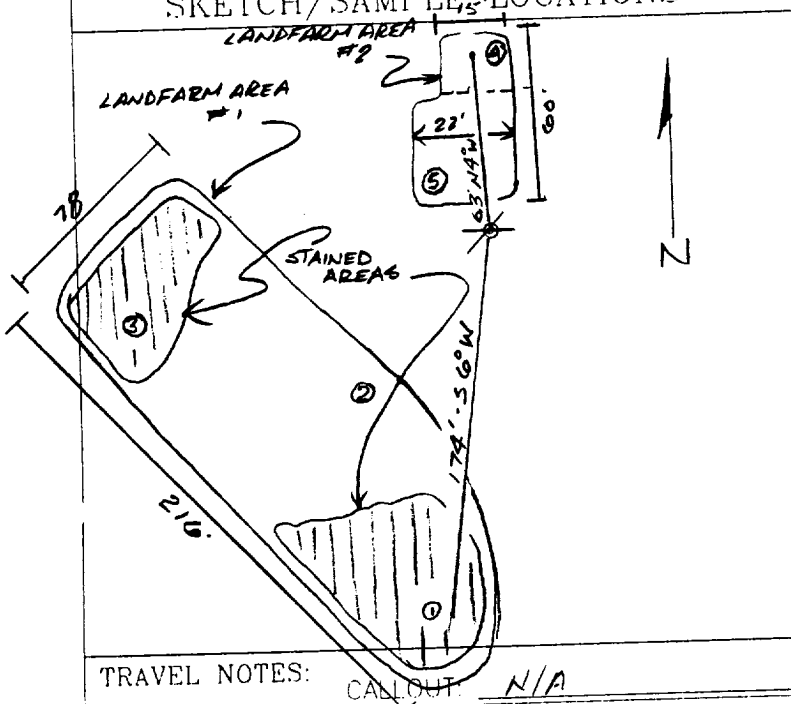

OVM RESULTS

LAB SAMPLES

SAMPLE ID	FIELD HEADSPACE PID (ppm)	SAMPLE ID	ANALYSIS	TIME	RESULTS
LF-1	8.3	LF-1	TPH (B015)	1000	2,730

SCALE

0 100 FT

TRAVEL NOTES: CALL OUT: <u>N/A</u>	ONSITE: <u>8-31-99</u>
------------------------------------	------------------------

ENVIROTECH LABS

PRACTICAL SOLUTIONS FOR A BETTER TOMORROW

EPA METHOD 8015 Modified Nonhalogenated Volatile Organics Total Petroleum Hydrocarbons

Client: Blagg / AMOCO
Sample ID: LF - 1
Laboratory Number: E925
Chain of Custody No: 6585
Sample Matrix: Soil
Preservative: Cool
Condition: Cool and Intact

Project #: 403410
Date Reported: 04-03-99
Date Sampled: 03-31-99
Date Received: 04-01-99
Date Extracted: 04-03-99
Date Analyzed: 04-03-99
Analysis Requested: 8015 TPH

Parameter	Concentration (mg/Kg)	Det. Limit (mg/Kg)
Gasoline Range (C5 - C10)	13.8	0.2
Diesel Range (C10 - C28)	2,720	0.1
Total Petroleum Hydrocarbons	2,730	0.2

ND - Parameter not detected at the stated detection limit.

References: Method 8015B, Nonhalogenated Volatile Organics, Test Methods for Evaluating Solid Waste, SW-846, USEPA, December 1996.

Comments: Jicarilla Contract 147 - 5E Landfarm. 5 Pt. Composite.

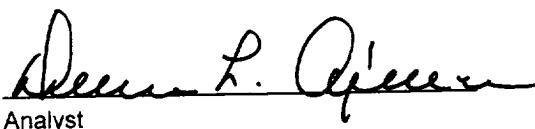
Analyst

Review

5859

[illegible]