

UNITED STATES
DEPARTMENT OF THE INTERIOR
GEOLOGICAL SURVEY

APPLICATION FOR PERMIT TO DRILL, DEEPEN, OR PLUG BACK

1a. TYPE OF WORK

DRILL ☒DEEPEN ☐PLUG BACK ☐

b. TYPE OF WELL

OIL
WELL ☒GAS
WELL ☐OTHER ☐SINGLE
ZONE ☐MULTIPLE
ZONE ☐

2. NAME OF OPERATOR

BCO, Inc. c/o Ned Dollar, Agent

3. ADDRESS OF OPERATOR

P.O. Box 399 Aztec, New Mexico 87410

4. LOCATION OF WELL (Report location clearly and in accordance with any State requirements.)*

At surface

(NW/SE) 1920' FSL & 2120' FEL Sec. 18, T24N-R7W.

At proposed prod zone

14. DISTANCE IN MILES AND DIRECTION FROM NEAREST TOWN OR POST OFFICE*

7 miles NW of Escrito Trading Post.

15. DISTANCE FROM PROPOSED*

LOCATION TO NEAREST
PROPERTY OR LEASE LINE, FT.
(Also to nearest drg. unit line, if any)18. DISTANCE FROM PROPOSED LOCATION*
TO NEAREST WELL, DRILLING, COMPLETED,
OR APPLIED FOR, ON THIS LEASE, FT.

21. ELEVATIONS (Show whether DF, RT, GR, etc.)

7163' GR

16. NO. OF ACRES IN LEASE

962.72

19. PROPOSED DEPTH

6113'-6187'

17. NO. OF ACRES ASSIGNED
TO THIS WELL

40 w/80

20. ROTARY OR CABLE TOOLS

Rotary

22. APPROX. DATE WORK WILL START*

April 10, 1984

100-100000-1000000

23. PROPOSED CASING AND CEMENTING PROGRAM

appeal pursuant to 30 CFR 290.

SIZE OF HOLE	SIZE OF CASING	WEIGHT PER FOOT	SETTING DEPTH	QUANTITY OF CEMENT
12-1/4"	8-5/8"	23# 8 Rd.	200'	150 sx
7-7/8"	4-1/2"	11.6 N-80	6200	1000 sx circulate to surface

Drill Surface hole to 200 + -. Cmt. to surface w/approximately 150 sx. Drill 7-7/8" hole to TD 6200'. Run 4-1/2" csng. to TD. Cmt. in s-stg 1-stg 175 sx class H 2% CaCl, 8# Salt, 1/2# flocele, 6-1/4# gilsonite, mixed at 15.1#. Yield 1.36 cu' per sx for a total of 238 cu ft. Top of cmt will be reported on subsequent notice, based on cmt log. Stage 2; approximate 1350 sx of 65/35 Class H; 3% gel, 12-1/3 gilsonite, 5.6# salt, 8.2 Calseal. Yield 1.68 cubic ft. per/sx. Plan to circulate to surface.

RECEIVED
MAR 30 1984
OIL & GAS DIV.

IN ABOVE SPACE DESCRIBE PROPOSED PROGRAM: If proposal is to deepen or plug back, give data on present productive zone and proposed new productive zone. If proposal is to drill or deepen directionally, give pertinent data on subsurface locations and measured and true vertical depths. Give blowout preventer program, if any.

SIGNED Ned Dollar DIST. 3
TITLE Agent

(This space for Federal or State office use)

PERMIT NO. APPROVAL DATE

APPROVED BY
CONDITIONS OF APPROVAL, IF ANY:

TITLE

NSL 1785
chf

NMOCC

*See Instructions On Reverse Side

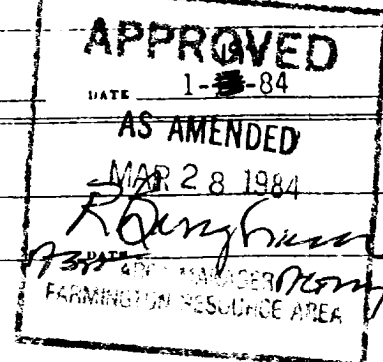

All distances must be from the outer boundaries of the Section.

Operator BCO, INC.		Lease Escrito Gallup Unit (Eliz #8)		Well No. 25
Unit Letter J	Section 18	Township 24 North	Range 7 West	County Rio Arriba
Actual Footage Location of Well:				
1920	feet from the South	line and	2120	feet from the East line
Ground Level Elev. 7163	Producing Formation Gallup	Pool Escrito Gallup		Dedicated Acreage: 80 Acres

1. Outline the acreage dedicated to the subject well by colored pencil or hatchure marks on the plat below.
2. If more than one lease is dedicated to the well, outline each and identify the ownership thereof (both as to working interest and royalty).
3. If more than one lease of different ownership is dedicated to the well, have the interests of all owners been consolidated by communitization, unitization, force-pooling, etc?

☐ Yes ☐ No If answer is "yes," type of consolidation _____

If answer is "no," list the owners and tract descriptions which have actually been consolidated. (Use reverse side of this form if necessary.) _____

No allowable will be assigned to the well until all interests have been consolidated (by communitization, unitization, forced-pooling, or otherwise) or until a non-standard unit, eliminating such interests, has been approved by the Division

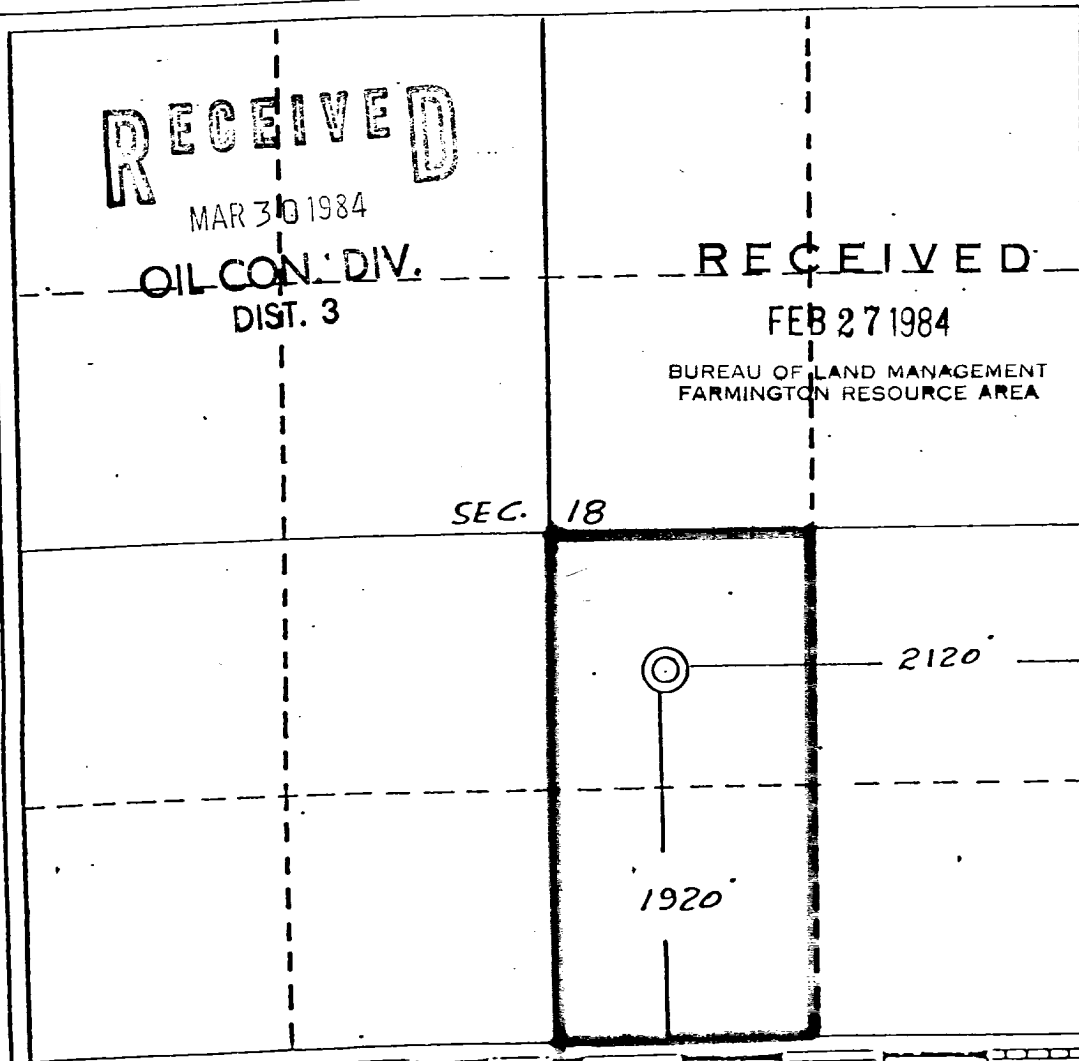

CERTIFICATION

I hereby certify that the information contained herein is true and complete to the best of my knowledge and belief.

Harry R. Bigbee
Name

Harry R. Bigbee

Position

President

Company

BCO, Inc.

Date

2-21-84

I hereby certify that the location shown on this plat was placed in the field by me or under my supervision, and that some of the data collected is correct to the best of my knowledge and belief.

EDGAR L. RISENHOOVER
NEW MEXICO
5979
REGISTERED LAND SURVEYOR

Date Surveyed

December 8, 1983

Registered Professional Engineer
and/or Land Surveyor

Edgar L. Risenhoover

Certificate No. 5979

Edgar L. Risenhoover, L.S.