



STATE OF NEW MEXICO  
**ENERGY AND MINERALS DEPARTMENT**  
OIL CONSERVATION DIVISION

August 9, 1984

TONEY ANAYA  
GOVERNOR

POST OFFICE BOX 2088  
STATE LAND OFFICE BUILDING  
SANTA FE, NEW MEXICO 87501  
(505) 827-5800

Southern Union Exploration Company  
P. O. Box 2179  
Farmington, New Mexico 87499

Attention: Jeffrey J. Bollschweiler

Administrative Order NSL-1862

Gentlemen:

Reference is made to your application for a non-standard location for your Jicarilla K Well No. 22A located 420 feet from the South line and 1850 feet from the East line of Section 2, Township 25 North, Range 5 West, NMPM, Blanco Mesaverde Pool, Rio Arriba County, New Mexico. The S/2 of said Section 2 is to be dedicated to the well.

By authority granted me under the provisions of Rule 104 FI, the above-described unorthodox location is hereby approved.

Sincerely,

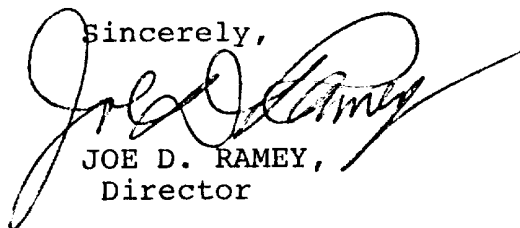

JOE D. RAMEY,  
Director

JDR/RLS/dr

cc: Oil Conservation Division - Aztec  
Oil & Gas Engineering Committee - Hobbs  
Bureau of Land Management - Farmington

**RECEIVED**  
AUG 13 1984  
OIL CON. DIV.  
DIST. 3



STATE OF NEW MEXICO  
ENERGY AND MINERALS DEPARTMENT  
OIL CONSERVATION DIVISION  
AZTEC DISTRICT OFFICE

1000 RIO BRAZOS ROAD  
AZTEC, NEW MEXICO 87410  
(505) 334-6178

OIL CONSERVATION DIVISION  
BOX 2088  
SANTA FE, NEW MEXICO 87501

DATE \_\_\_\_\_

RE: Proposed MC \_\_\_\_\_  
Proposed DHC \_\_\_\_\_  
Proposed NSL X \_\_\_\_\_  
Proposed SWD \_\_\_\_\_  
Proposed WFX \_\_\_\_\_  
Proposed PMX \_\_\_\_\_

Gentlemen:

I have examined the application dated 8-7-84  
for the Southern Union Exp. Co., Jicarilla A# 22-A O-2-25N-5W  
Operator Lease and Well No. Unit, S-T-R

and my recommendations are as follows:

APPROVE  
\_\_\_\_\_  
\_\_\_\_\_  
\_\_\_\_\_  
\_\_\_\_\_  
\_\_\_\_\_

Yours truly,

Charles Holman



Southern Union Exploration Company  
P. O. Box 2179  
Farmington, New Mexico 87499  
(505) 327 4481

August 7, 1984

New Mexico Oil Conservation Commission  
P. O. Box 2088  
Santa Fe, NM 87501

Re: Jicarilla K-22A, Mesa Verde  
Jicarilla Contract #145  
420' FSL & 1850' FEL  
Sec 2-T25N-R5W  
Rio Arriba County, NM

Dear Sirs:

The above referenced well was located in an unorthodox location due to topography. A rocky mesa and ridge run North & South through the Eastern half of the  $\frac{1}{4}$  section. The terrain is unsatisfactory for a drill pad in an orthodox location.

Approvals from off-setting lease holders are included.

Sincerely,

*Jeffrey J. Bollschweiler*  
Jeffrey J. Bollschweiler  
Division Engineer

JJB/jr  
Enclosures

**RECEIVED**

AUG 08 1984

OIL CON. DIV  
DIST. 3



Southern Union Exploration Company  
P.O. Box 2179  
Farmington, New Mexico 87499  
Phone 327 4481



FARMINGTON DISTRICT	
APR 26 1984	
DS	
DAS	
DE	
NDF	
SDF	
DDS	

April 25, 1984

Amoco Production Company  
501 Airport Drive  
Farmington, New Mexico 87401

Attn: Mr. Buddy Shaw

Dear Sir:

Southern Union Exploration proposes to drill and complete our Jicarilla K #22A well in the Mesa Verde formation. The well is located 500' FSL and 1850' FEL, Sec 2-T25N-R5W, N.M.P.M. in Rio Arriba County, New Mexico. This well cannot be drilled in this drilling unit in a standard location due to topography.

Our records indicate that you are the owner and operator of acreage which adjoins this drilling unit. If you have no objections to this proposed non-standard location, please sign the attached copy of this letter and return to this office. ✓

Your prompt attention to this matter would be greatly appreciated.

Sincerely,

*Jeffrey J. Bollschweiler*  
Jeffrey J. Bollschweiler  
Division Engineer

JJB/jr

**RECEIVED**  
AUG 08 1984  
OIL CON. DIV.  
DIST. 3

This above non-standard location is hereby approved.

By: *R13 Giles* for Amoco Production Company  
Title: *Production & Identification Manager*  
Date: *5-10-84*

OK  
SEM



Southern Union Exploration Company  
P. O. Box 2179  
Farmington, New Mexico 87499  
(505) 327 4481

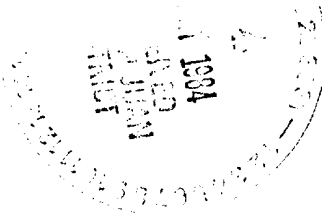

MAY 10 1984	
DS	
1 DAS	✓
DI	
NE F	
SDE	
DDG	
2 BBS	BBS

May 8, 1984

Amoco Production Company  
501 Airport Drive  
Farmington, New Mexico 87401

Attn: Mr. Buddy Shaw

Re: Jicarilla K-22A, unorthodox location  
Jicarilla Contract #145  
420' FSL & 1850' FEL  
Sec 2-T25N-R5W  
San Juan Co., New Mexico

Dear Sir:

On April 25, 1984, I sent a letter to request approval of an unorthodox location for the above referenced Mesa Verde well. The survey was completed @ 420' from the south line due to the topography. The original location was 500' FSL & 1850' FEL, Sec 2-T25N-R5W.

If you have no objections to this proposed non-standard location, please sign the attached copy of this letter and return to this office.

JJB/jr  
Enclosures

Sincerely,

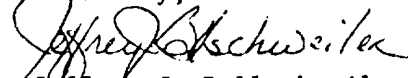
  
Jeffrey J. Bollschweiler  
Division Engineer

This above referenced non-standard location is approved.

By: B B Gilkey  
Title: Mgmt. Promotion & Utilization  
Date: 5-24-84



Southern Union Exploration Company  
P. O. Box 2179  
Las Alamos, New Mexico 87409  
Phone (505) 4481



April 25, 1984

Marathon Oil Company  
P. O. Box 2659  
Casper, Wyoming 82604

Attn: Mr. John Wilcox

Dear Sir:

Southern Union Exploration proposes to drill and complete our Jicarilla K #22A well in the Mesa Verde formation. The well is located 500' FSL and 1850' FEL, Sec 2-T25N-R5W, N.M.P.M. in Rio Arriba County, New Mexico. This well cannot be drilled in this drilling unit in a standard location due to topography.

Our records indicate that you are the owner and operator of acreage which adjoins this drilling unit. If you have no objections to this proposed non-standard location, please sign the attached copy of this letter and return to this office.

Your prompt attention to this matter would be greatly appreciated.

Sincerely,

*Jeffrey J. Bollschweiler*  
JR

Jeffrey J. Bollschweiler  
Division Engineer

JJB/jr

This above non-standard location is hereby approved.

By: *Doyle L. Jones*  
Title: *Dist. Operations Mgr.*  
Date: *May 2, 1984*



Southern Union Exploration Company  
P. O. Box 1179  
Albuquerque, New Mexico 87149  
Tel. 277-4481

JUN 27 1984  
DISTRICT

June 27, 1984

Marathon Oil Company  
P. O. Box 2659  
Casper, Wyoming 82604  
Attn: Mr. Jess O'Neal

Re: Jicarilla K-22A, unorthodox location  
Jicarilla Contract #145  
420' FSL & 1850' FEL Sec 2-T25N-R5W  
Rio Arriba County, New Mexico

Dear Sir:

On April 25, 1984, I sent a letter to request approval of an unorthodox location for the above referenced Mesa Verde well. The survey was completed @ 420' from the south line due to the topography. The original location was 500' FSL & 1850' FEL, Sec 2-T25N-R5W.

If you have no objections to this proposed non-standard location, please sign the attached copy of this letter & return to this office.

JJB/jr  
Enclosures

This above referenced non-standard location is approved.

By: Jesse E. O'Neal  
Title: District Engr.  
Date: 6/29/84

Sincerely,  
Jeffrey J. Bollschweiler  
Jeffrey J. Bollschweiler  
Division Engineer

RECEIVED

JUN 29 1984

CASPER DISTRICT  
OPERATIONS



Southern Union Exploration Company  
P. O. Box 2149  
Farmington, New Mexico 87499  
(505) 377-4481

RECEIVED  
APR 30 1984

4482-1430

April 25, 1984

Union Texas Petroleum Corporation  
P. O. Box 1290  
Farmington, New Mexico 87499

Attn: Rudy Motto

Dear Sir:

Southern Union Exploration proposes to drill and complete our Jicarilla K #22A well in the Mesa Verde formation. The well is located 500' FSL and 1850' FEL, Sec 2-T25N-R5W, N.M.P.M. in Rio Arriba County, New Mexico. This well cannot be drilled in this drilling unit in a standard location due to topography.

Our records indicate that you are the owner and operator of acreage which adjoins this drilling unit. If you have no objections to this proposed non-standard location, please sign the attached copy of this letter and return to this office.

Your prompt attention to this matter would be greatly appreciated.

Sincerely,

Jeffrey J. Bollschweiler  
Division Engineer

JJB/jr  
Enclosures

This above non-standard location is hereby approved.

By: Derald M. Walston

Title: Division General Manager

Date: May 8, 1984

103 MAY 10 1984





Southern Union Exploration Company  
P.O. Box 1290  
Farmington, New Mexico 87499  
Phone (505) 4481

July 5, 1984

Union Texas Petroleum Corporation  
P. O. 1290  
Farmington, New Mexico 87499

Re: Jicarilla K-22A, unorthodox location  
Jicarilla Contract #145  
420' FSL & 1850' FEL Sec 2-T25N-R5W  
Rio Arriba County, New Mexico

Dear Sir:

On April 25, 1984, I sent a letter to request approval of an unorthodox location for the above referenced Mesa Verde well. The survey was completed @ 420' from the south line due to the topography. The original location was 500' FSL & 1850' FEL, Sec 2-T25N-R5W.

If you have no objections to this proposed non-standard location, please sign the attached copy of this letter and return to this office.

Sincerely,

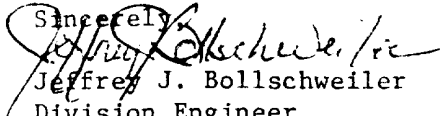
  
Jeffrey J. Bollschweiler  
Division Engineer

JJB/jr

This above reference non-standard location is approved.

By:

Title:

Date:

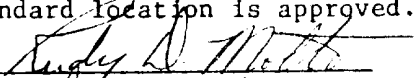
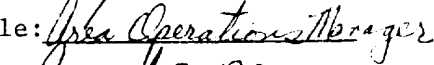
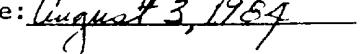
## OIL CONSERVATION DIVISION

STATE OF NEW MEXICO  
ENERGY AND MINERALS DEPARTMENTP. O. BOX 2088  
SANTA FE, NEW MEXICO 87501Form C-107  
Revised 10-1-7

All distances must be from the outer boundaries of the Section.

Operator SOUTHERN UNION EXPLORATION COMPANY			Lease JICARILLA "K"		Well No. 22A
Unit Letter 0	Section 2	Township 25N	Range 5W	County Rio Arriba	
Actual Footage Location of Well: 120 feet from the South line and 1850 feet from the East line					
Ground Level Elev: 6697	Producing Formation Point Lookout (MV)		Pool Blanco Mesa Verde	Dedicated Acreage: 320 Acres	

1. Outline the acreage dedicated to the subject well by colored pencil or hachure marks on the plat below.
2. If more than one lease is dedicated to the well, outline each and identify the ownership thereof (both as to working interest and royalty).
3. If more than one lease of different ownership is dedicated to the well, have the interests of all owners been consolidated by communitization, unitization, force-pooling, etc?

☐ Yes ☐ No If answer is "yes," type of consolidation \_\_\_\_\_

If answer is "no," list the owners and tract descriptions which have actually been consolidated. (Use reverse side of this form if necessary.) \_\_\_\_\_

No allowable will be assigned to the well until all interests have been consolidated (by communitization, unitization, forced-pooling, or otherwise) or until a non-standard unit, eliminating such interests, has been approved by the Commission.

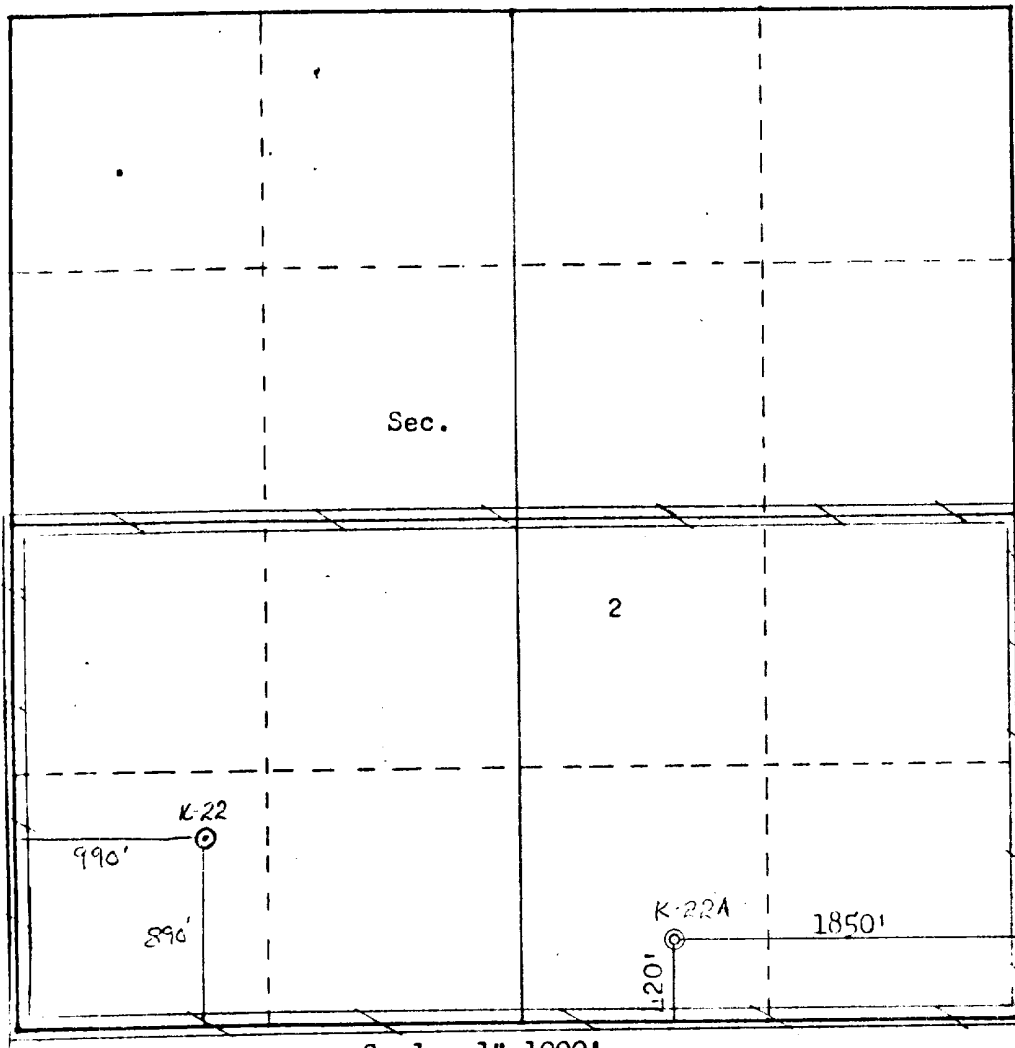

## CERTIFICATION

I hereby certify that the information contained herein is true and complete to the best of my knowledge and belief.

*Jeffrey J. Bollschweiler*  
Name

Jeffrey J. Bollschweiler

Position

Division Engineer

Company

Southern Union Exploration

Date

May 7, 1984

I hereby certify that the well location shown on this plat was plotted from field notes of actual surveys made by me or under my supervision, and that the same is true and correct to the best of my knowledge and belief.

Date Surveyed

April 26, 1984

Registered Professional Engineer  
and Land Surveyor

*Fred B. Kerr Jr.*  
Fred B. Kerr Jr.

Certificate No. 4222

1950

