

UNITED STATES
DEPARTMENT OF THE INTERIOR
BUREAU OF LAND MANAGEMENT

SUBMIT IN TRIPLICATE*
(Other instructions on re-
verse side)

Budget Bureau No. 1004-0135
Expires August 31, 1985

SUNDRY NOTICES AND REPORTS ON WELLS

(Do not use this form for proposals to drill or to deepen or plug a well. Use "APPLICATION FOR PERMIT" for such proposals.)

RECEIVED

AUG 22 1985

1. OIL WELL ☐ GAS WELL ☒ OTHER

2. NAME OF OPERATOR

Amoco Production Co.

3. ADDRESS OF OPERATOR

501 Airport Drive, Farmington, N.M. 87401

4. LOCATION OF WELL (Report location clearly and in accordance with any State requirements. See also space 17 below.)
At surface

1840' FNL x 830' FWL

14. PERMIT NO.

15. ELEVATIONS (Show whether DF, RT, GR, etc.)

6853' GR

16.

Check Appropriate Box To Indicate Nature of Notice, Report, or Other Data

NOTICE OF INTENTION TO:

TEST WATER SHUT-OFF

FRACTURE TREAT

SHOOT OR ACIDIZE

REPAIR WELL

(Other) Pool & Spacing Change

PULL OR ALTER CASING

MULTIPLE COMPLETE

ABANDON*

CHANGE PLANS

SUBSEQUENT REPORT OF:

WATER SHUT-OFF

FRACTURE TREATMENT

SHOOTING OR ACIDIZING

(Other)

REPAIRING WELL

ALTERING CASING

ABANDONMENT*

17. DESCRIBE PROPOSED OR COMPLETED OPERATIONS (Clearly state all pertinent details, and give pertinent dates, including estimated date of starting any proposed work. If well is directionally drilled, give subsurface locations and measured and true vertical depths for all markers and zones pertinent to this work.)

(NOTE: Report results of multiple completion on Well Completion or Recompletion Report and Log form.)

Per the telephone conversation of Ernie Busch from the NMOCD and Ed Alizedah on 8-19-85 the above referenced well will be in the West Lindrith Gallup Dakota pool rather than the Basin Dakota. Also the spacing will change from 320 to 160 dedicated acres as shown in the attached plat.

18. I hereby certify that the foregoing is true and correct

SIGNED

TITLE Adm. Supervisor

DATE 8-20-85

(This space for Federal or State office use)

APPROVED BY

CONDITIONS OF APPROVAL, IF ANY:

TITLE

ACCEPTED FOR RECORD

DATE

1985

*See Instructions on Reverse Side

FARMINGTON RESOURCE AREA

OIL CONSERVATION DIVISION

P. O. BOX 2088

SANTA FE, NEW MEXICO 87501

Form C-107
Revised 10-1

All distances must be from the outer boundaries of the Section.

AMOCO PRODUCTION COMPANY			Lease JICARILLA CONTRACT 143		Well No. 18Y
Unit Letter E	Section 23	Township 25N	Range 5W	County Rio Arriba	
Actual Footage Location of Well: 1840 feet from the North line and 830 feet from the West line					
Ground Level Elev: 6853	Producing Formation Gallup-Dakota		Pool W. Lindrith Gallup-Dakota	Dedicated Acreage: 160 Acres	

1. Outline the acreage dedicated to the subject well by colored pencil or hatchure marks on the plat below.
2. If more than one lease is dedicated to the well, outline each and identify the ownership thereof (both as to working interest and royalty).
3. If more than one lease of different ownership is dedicated to the well, have the interests of all owners been consolidated by communitization, unitization, force-pooling, etc?

☐ Yes ☐ No If answer is "yes," type of consolidation _____

If answer is "no," list the owners and tract descriptions which have actually been consolidated. (Use reverse side of this form if necessary.) _____

No allowable will be assigned to the well until all interests have been consolidated (by communitization, unitization, forced-pooling, or otherwise) or until a non-standard unit, eliminating such interests, has been approved by the Commission.

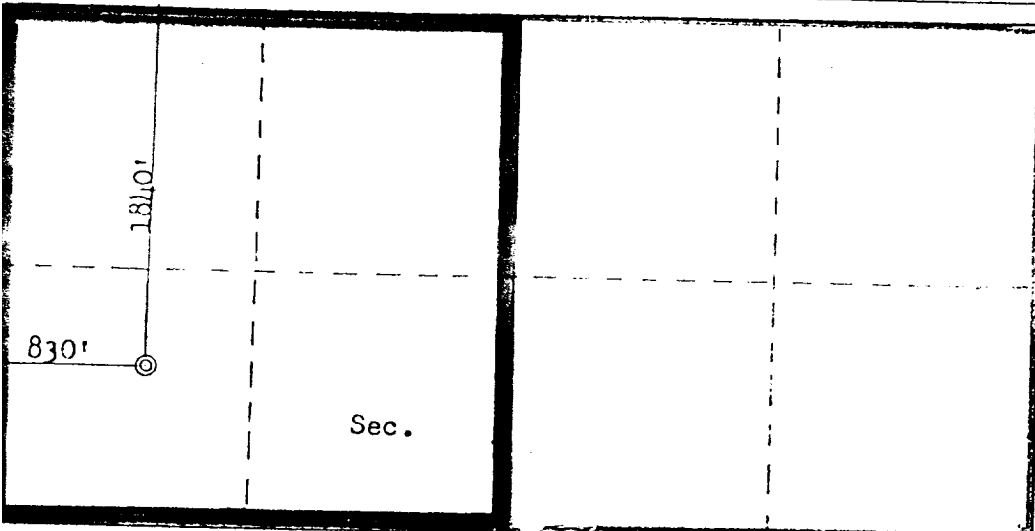

RECEIVED

AUG 22 1985

BUREAU OF LAND MANAGEMENT
FARMINGTON RESOURCE AREA

23

RECEIVED
AUG 26 1985
OIL CONSERVATION
DIVISION

CERTIFICATION

I hereby certify that the information contained herein is true and complete to the best of my knowledge and belief.

B.D. Shaw

Name

B. D. Shaw

Position

Adm. Supervisor

Company

Amoco Production Co.

Date

5/1/85

I hereby certify that the well location shown on this plat was plotted from field notes of actual surveys made by me or under my supervision, and that the same is true and correct to the best of my knowledge and belief.

Date Surveyed

REGISTERED LAND ENGINEER
Fred B. Shaw
and
Land Surveyor
Fred B. Shaw

Certificate No.