

UNITED STATES
DEPARTMENT OF THE INTERIOR
GEOLOGICAL SURVEY

RECEIVED
Other instructions on reverse side

Form approved.
Budget Bureau No. 42-R1425.

AUG 1 - 1985

APPLICATION FOR PERMIT TO DRILL, DEEPEN, OR PLUG BACK

1a. TYPE OF WORK
 DRILL DEEPEN PLUG BACK
 b. TYPE OF WELL
 OIL WELL GAS WELL OTHER SINGLE ZONE MULTIPLE ZONE

2. NAME OF OPERATOR
 Mobil Producing TX. & N.M. Inc.

3. ADDRESS OF OPERATOR
 P. O. Box 633, Midland, Texas 79702

4. LOCATION OF WELL (Report location clearly and in accordance with any State requirements.)
 At surface: 560' FWL 1985' FWL
 At proposed prod. zone: Same as surface

14. DISTANCE IN MILES AND DIRECTION FROM NEAREST TOWN OR POST OFFICE
 6 miles west of Lindrith, NM

15. DISTANCE FROM PROPOSED LOCATION TO NEAREST PROPERTY OR LEASE LINE, FT. (Also to nearest drig. unit line, if any)
 7260'

18. DISTANCE FROM PROPOSED LOCATION TO NEAREST WELL, DRILLING, COMPLETED, OR APPLIED FOR, ON THIS LEASE, FT.
 1760'

BUREAU OF LAND MANAGEMENT
 WILDLIFE RESOURCE AREA

5. LEASE DESIGNATION AND SERIAL NO.
 SF 078913

6. IF INDIAN, ALLOTTEE OR TRIBE NAME

7. UNIT AGREEMENT NAME
 Lindrith B Unit

8. FARM OR LEASE NAME

9. WELL NO.
 40 Join w# 22

10. FIELD AND POOL, OR WILDCAT
 West Lindrith-Gallup/Dakota

11. SEC., T., R., M., OR BLK. AND SURVEY OR AREA
 Sec. 15, T-24-N, R-3-W

12. COUNTY OR PARISH
 Rio Arriba

13. STATE
 NM

16. NO. OF ACRES IN LEASE
 2560

17. NO. OF ACRES ASSIGNED TO THIS WELL
 160 - 2 Wells

19. PROPOSED DEPTH
 7750'

20. ROTARY OR CABLE TOOLS
 Rotary

22. APPROX. DATE WORK WILL START
 ASAP

21. ELEVATIONS (Show whether DF, RT, GR, etc.)
 6926' GL
 DRILLING OPERATIONS AUTHORIZED ARE SUBJECT TO COMPLIANCE WITH ATTACHED "GENERAL REQUIREMENTS"

23. PROPOSED CASING AND CEMENTING PROGRAM

SIZE OF HOLE	SIZE OF CASING	WEIGHT PER FOOT	SETTING DEPTH
12 1/4	9-5/8	36 H40	0 - 400
8-3/4	5 1/2	15.5 K55	0 - 7750

This action is subject to technical and procedural review pursuant to 43 CFR 3165.3 and appeal pursuant to 43 CFR 3165.4.

1. Circulate to surface
2. Circulate to surface

CEMENTING PROGRAM: See Attached
 1. Class B with 2% CaCl₂ 2. Class B

LOGGING PROGRAM:
 CNL-FDC-CAL-GR TD - 3300'
 BHC-SONIC-CAL-GR TD - 3300'
 DIL-SP-GR TD - 3300'

MUD PROGRAM:

DEPTH	MUD TYPE	MUD WT.	VISCOSITY	WATER LOSS
0 - 400	FW-Spud	8.5 - 9.0	32 - 38	N/C
400 - 6000'	FW	8.4 - 9.4	28 - 35	N/C
6000 - 7750'	FW - Gel	8.6 - 9.4	32 - 38	±20

BLOWOUT PREVENTOR PROGRAM:
 See Attached

15. ABOVE SPACE DESCRIBE PROPOSED PROGRAM: If proposal is to deepen or plug back, give data on present productive zone and proposed new productive zone. If proposal is to drill or deepen directionally, give pertinent data on subsurface locations and measured and true vertical depths. Give blowout preventer program, if any.

24. SIGNED C. A. Stone for G. E. Tate TITLE Env. & Reg. Manager DATE 6/17/85

(This space for Federal or State office use)

PERMIT NO. _____ APPROVAL DATE _____

APPROVED BY _____ TITLE _____ DATE _____

CONDITIONS OF APPROVAL, IF ANY:

Handwritten signature: Anthony S. Chubb

OIL CONSERVATION DIVISION

STATE OF NEW MEXICO
ENERGY AND MINERALS DEPARTMENT

P. O. BOX 2088
SANTA FE, NEW MEXICO 87501

Form C-102
Revised 10-1-78

All distances must be from the outer boundaries of the Section.

Operator Mobil Producing TX. & N.M. Inc.		Lease Lindrith B Unit			Well No. 40
Unit Letter C	Section 15	Township T24N	Range R3W	County Rio Arriba	
Actual Footage Location of Well: 860' feet from the NORTH line and 1980 feet from the WEST line					
Ground Level Elev. 6926	Producing Formation Dakota - Gallup		Pool West Lindrith - Gallup/Dakota	Dedicated Acreage: 160-2 wells	

- Outline the acreage dedicated to the subject well by colored pencil or hachure marks on the plat below.
- If more than one lease is dedicated to the well, outline each and identify the ownership thereof (both as to working interest and royalty).
- If more than one lease of different ownership is dedicated to the well, have the interests of all owners been consolidated by communitization, unitization, force-pooling, etc?

Yes No If answer is "yes," type of consolidation Unitization

If answer is "no," list the owners and tract descriptions which have actually been consolidated. (Use reverse side of this form if necessary.)

No allowable will be assigned to the well until all interests have been consolidated (by communitization, unitization, forced-pooling, or otherwise) or until a non-standard unit, eliminating such interests, has been approved by the Division.

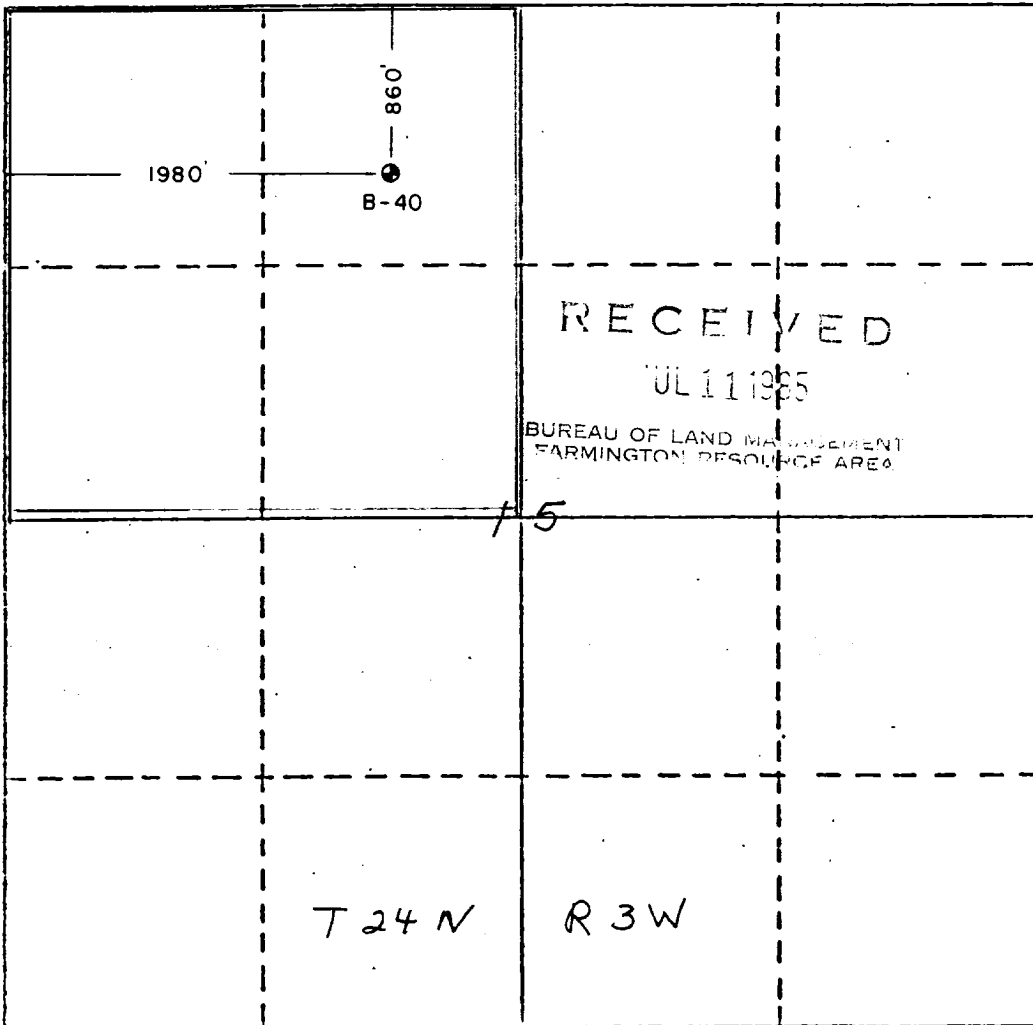

RECEIVED
JUL 11 1985
BUREAU OF LAND MANAGEMENT
FARMINGTON RESOURCE AREA

CERTIFICATION

I hereby certify that the information contained herein is true and complete to the best of my knowledge and belief.

C.A. Stone for

Name G. E. Tate
Position Env. & Reg. Manager
Company Mobil Producing TX. & N.M. Inc
Date July 5, 1985

I hereby certify that the well location shown on this plat was plotted from field notes of actual surveys made by me or under my supervision, and that the same is true and correct to the best of my knowledge and belief.

Date Surveyed
May 23, 1985

Registered Professional Engineer and/or Land Surveyor

[Signature]
Certificate No. 6256

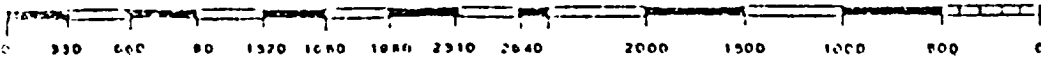

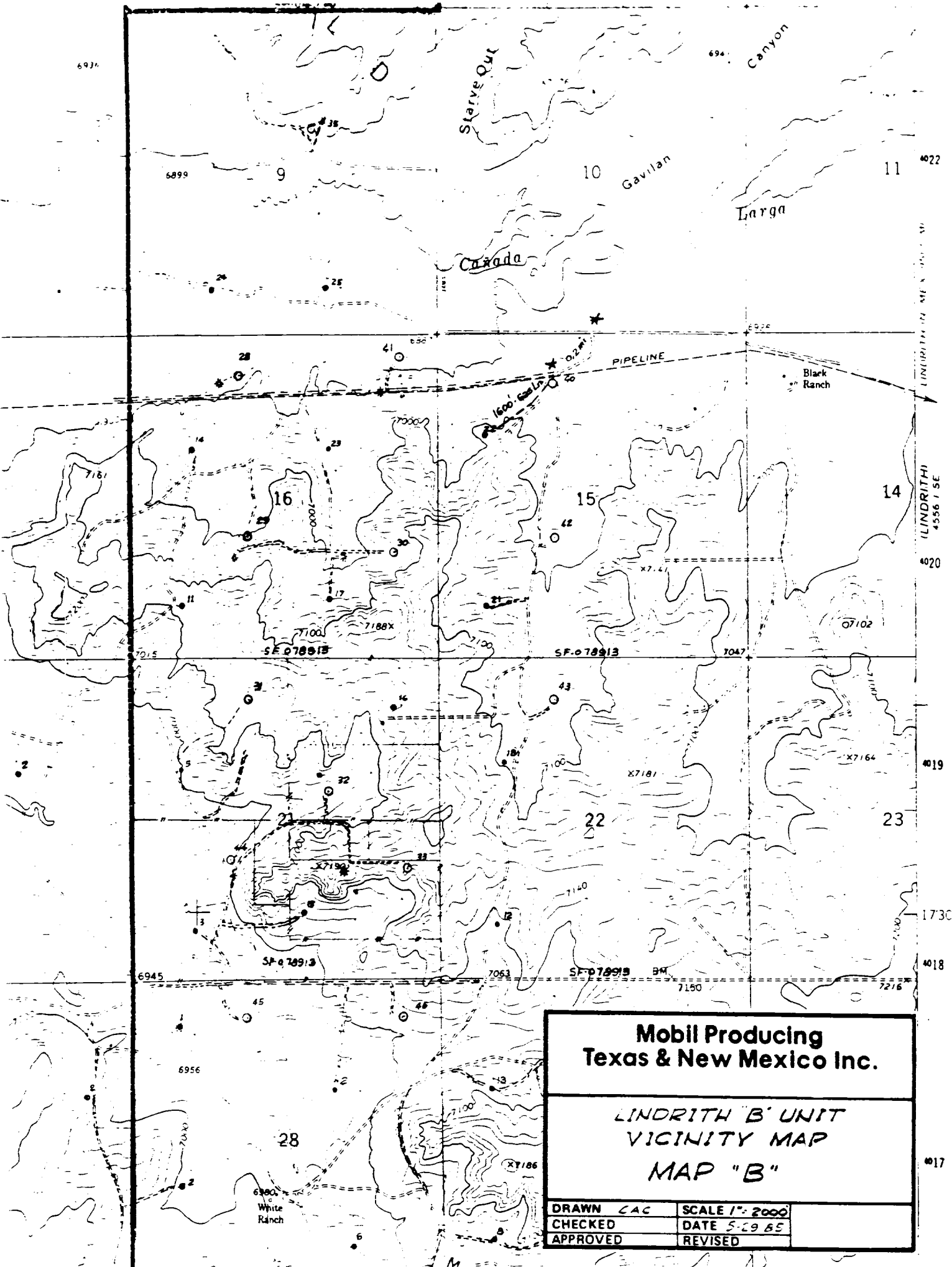

**Mobil Producing
Texas & New Mexico Inc.**

*LINDRITH 'B' UNIT
VICINITY MAP
MAP "B"*

DRAWN CAC	SCALE 1" = 2000'
CHECKED	DATE 5-29-65
APPROVED	REVISED

RECEIVED
AUG 1 1985
UNITED STATES
DEPARTMENT OF THE INTERIOR
GEOLOGICAL SURVEY OIL CON. DIV.

SUNDRY NOTICES AND REPORTS ON WELLS
DIST 3

(Do not use this form for proposals to drill or to deepen or plug back to a different reservoir. Use Form 9-331-C for such proposals.)

1. oil well gas well other

2. NAME OF OPERATOR
Mobil Producing TX & NM Inc.

3. ADDRESS OF OPERATOR
P. O. Box 633, Midland, Texas 79702

4. LOCATION OF WELL (REPORT LOCATION CLEARLY. See space 17 below.)
AT SURFACE: 860' FNL; 1980' FWL, Sec. 15
AT TOP PROD. INTERVAL: Same
AT TOTAL DEPTH: Same

16. CHECK APPROPRIATE BOX TO INDICATE NATURE OF NOTICE, REPORT, OR OTHER DATA

5. LEASE
Lindrith "B" Unit

6. IF INDIAN, ALLOTTEE OR TRIBE NAME

7. UNIT AGREEMENT NAME
Lindrith "B" Unit

8. FARM OR LEASE NAME

9. WELL NO.
40 Joint w/ 32

10. FIELD OR WILDCAT NAME
West Lindrith - Gallup/Dakota

11. SEC., T., R., M., OR BLK. AND SURVEY OR AREA
Sec. 15, T-24-N, R-3-W

12. COUNTY OR PARISH
Rio Arriba

13. STATE
NM

14. API NO.

15. ELEVATIONS (SHOW DF, KDB, AND WD)
6920* GL 6926

REQUEST FOR APPROVAL TO: SUBSEQUENT REPORT OF:

TEST WATER SHUT-OFF	<input type="checkbox"/>	<input type="checkbox"/>
FRACTURE TREAT	<input type="checkbox"/>	<input type="checkbox"/>
SHOOT OR ACIDIZE	<input type="checkbox"/>	<input type="checkbox"/>
REPAIR WELL	<input type="checkbox"/>	<input type="checkbox"/>
PULL OR ALTER CASING	<input type="checkbox"/>	<input type="checkbox"/>
MULTIPLE COMPLETE	<input type="checkbox"/>	<input type="checkbox"/>
CHANGE ZONES	<input type="checkbox"/>	<input type="checkbox"/>
ABANDON*	<input type="checkbox"/>	<input type="checkbox"/>
(other) Change cement program	<input type="checkbox"/>	<input type="checkbox"/>

REC'D
UL 29 1985
(NOTE: Report results of multiple completion or zone change on Form 9-330.)

BUREAU OF LAND MANAGEMENT
FARMINGTON RESOURCE AREA

17. DESCRIBE PROPOSED OR COMPLETED OPERATIONS (Clearly state all pertinent details, and give pertinent dates, including estimated date of starting any proposed work. If well is directionally drilled, give subsurface locations and measured and true vertical depths for all markers and zones pertinent to this work.)*

Because the State of New Mexico Oil Conservation Division will not allow the use of foam cement, we are amending our cement program to the following:

1. 240 Cu. Ft. Class B + ^{2%}CaCl₂ circulated to surface.
2. (a) 1st stage - 410 Cu. Ft. of Class B + Pacemaker lite circulated to 6000' where DV tool is set.
(b) 2nd stage - 1360 Cu. Ft. of Class B circulated from 6000' at DV tool to surface.

Subsurface Safety Valve: Manu. and Type _____ Set @ _____ Ft.

18. I hereby certify that the foregoing is true and correct
SIGNED C.A. Stone for G.E. Tate TITLE Env. & Reg. Mgr. DATE July 23, 1985

(This space for Federal or State office use)

APPROVED BY _____ TITLE _____ DATE _____
CONDITIONS OF APPROVAL, IF ANY:

05
2/80

*See Instructions on Reverse Side

NMOCC

[Handwritten signature]
for

Instructions

General: This form is designed for submitting proposals to perform certain well operations, and reports of such operations when completed, as indicated, on Federal and Indian lands pursuant to applicable Federal law and regulations, and, if approved or accepted by any State, on all lands in such State, pursuant to applicable State law and regulations. Any necessary special instructions concerning the use of this form and the number of copies to be submitted, particularly with regard to local, area, or regional procedures and practices, either are shown below or will be issued by, or may be obtained from, the local Federal and/or State office.

Item 4: If there are no applicable State requirements, locations on Federal or Indian land should be described in accordance with Federal requirements. Consult local State or Federal office for specific instructions.

Item 17: Proposals to abandon a well, and subsequent reports of abandonment should include such special information as is required by local Federal and/or State offices. In addition, such proposals and reports should include reasons for the abandonment; data on any former or present productive zones, or other zones with present significant fluid contents not sealed off by cement or otherwise; depths (top and bottom) and method of placement of cement plugs; mud or other material placed below, between and above plugs; amount, size, method of parting of any casing, liner or tubing pulled and the depth to top of any left in the hole; method of closing top of well; and date well site conditioned for final inspection looking to approval of the abandonment.