

UNITED STATES  
DEPARTMENT OF THE INTERIOR  
BUREAU OF LAND MANAGEMENT

5. LEASE DESIGNATION AND SERIAL NO.

SF-078563

6. IF INDIAN, ALLOTTEE OR TRIBE NAME

7. UNIT AGREEMENT NAME

8. FARM OR LEASE NAME

Rincon

9. WELL NO.

4

10. FIELD AND POOL, OR WILDCAT

DEVILS ROCK ASSOC-  
Escrito Gallup

11. SEC., T., R., M., OR BLK.

AND SURVEY OR AREA

SE 1/4 NW 1/4 F

Sec. 24-T24N-R7W

12. COUNTY OR PARISH

Rio Arriba

13. STATE

New Mexico

APPLICATION FOR PERMIT TO DRILL, DEEPEN, OR PLUG BACK

1a. TYPE OF WORK

DRILL ☒

DEEPEN ☐

PLUG BACK ☐

b. TYPE OF WELL

OIL  
WELL ☒

GAS  
WELL ☐

OTHER

SINGLE  
ZONE ☐

MULTIPLE  
ZONE ☐

2. NAME OF OPERATOR

Jack A. Gale *Bannon Energy Inc.*

3. ADDRESS OF OPERATOR

P.O. Box 191, Farmington, New Mexico 87499

4. LOCATION OF WELL (Report location clearly and in accordance with any State requirements.)\*

At surface

1850' FNL, 1820' FWL

At proposed prod. zone Same

14. DISTANCE IN MILES AND DIRECTION FROM NEAREST TOWN OR POST OFFICE\*

13 miles NW Counselors Trading Post, New Mexico

15. DISTANCE FROM PROPOSED\*

LOCATION TO NEAREST  
PROPERTY OR LEASE LINE, FT.  
(Also to nearest drig. unit line, if any)

16. NO. OF ACRES IN LEASE

560 760

17. NO. OF ACRES ASSIGNED  
TO THIS WELL

500 160 *Joint w/ GRACE*

18. DISTANCE FROM PROPOSED LOCATION\*  
TO NEAREST WELL, DRILLING, COMPLETED,  
OR APPLIED FOR, ON THIS LEASE, FT.

19. PROPOSED DEPTH

5650

20. ROTARY OR CABLE TOOLS

Rotary

21. ELEVATIONS (Show whether DF, RT, GR, etc.)

6621 GR

6633 KB

22. APPROX. DATE WORK WILL START\*

December 1, 1988

23. *DRILLING OPERATIONS AND ARE  
SUBJECT TO COMPLIANCE WITH ATTACHED  
"GENERAL REQUIREMENTS"  
PROPOSED CASING AND CEMENTING PROGRAM*

*This action is subject to technical and  
procedural review pursuant to 43 CFR 3160.3  
and appeal procedures.*

SIZE OF HOLE	SIZE OF CASING	WEIGHT PER FOOT	SETTING DEPTH	QUANTITY OF CEMENT
12 1/4	8 5/8	24.0 lb. J-55	250'	250 sks. 259 ft.
7 7/8	4 1/2	10.50 lb. K-55	5650	950 sks.

All producing intervals in Gallup formation will be stimulated as necessary.

Exhibits:

- "A" Location and elevation plat
- "B" Ten point compliance program
- "C" Blowout preventor diagram
- "D" Multi-point requirements of APD
- "E" Access road to location

- "F" Drill rig layout
- "G" Fracturing program layout
- "H" Location profile
- "I" Pipeline R.O.W.
- "J" Road R.O.W.

RECEIVED  
DEC 2 1988  
OIL CON. DIV.  
DIST. 3

IN ABOVE SPACE DESCRIBE PROPOSED PROGRAM: If proposal is to deepen or plug back, give data on present productive zone and proposed new productive zone. If proposal is to drill or deepen directionally, give pertinent data on subsurface locations and measured and true vertical depths. Give blowout preventer program, if any.

24.

SIGNED

*Devinne Blinn*

TITLE Production Superintendent

DATE October 21, 1988

(This space for Federal or State office use)

PERMIT NO.

APPROVAL DATE

"Approval of this action does

not warrant that the applicant  
holds legal or equitable rights

TITLE

DATE

or title to this land

HOLD CHECK FOR NAME CHANGE *See Instructions On Reverse Side*

Title 18 U.S.C. Section 1001, makes it a crime for any person knowingly and willfully to make to any department or agency of the

All distances must be from the outer boundaries of the Section.

Operator BANNON ENERGY, INC.		Lease RINCON		Well No. # 4
Unit Letter F	Section 24	Township 24 NORTH	Range 7 WEST	County RIO ARriba
Actual Footage Location of Wells 1850 feet from the NORTH line and 1820 feet from the WEST line				
Ground Level Elev. 6621	Producing Formation GALLUP	Pool DEVILS' FORK ASSOC.	Dedicated Acreage 160 Acres	

1. Outline the acreage dedicated to the subject well by colored pencil or hachure marks on the plat below. *Joined with Fed. 24#1*
2. If more than one lease is dedicated to the well, outline each and identify the ownership thereof (both as to working interest and royalty).
3. If more than one lease of different ownership is dedicated to the well, have the interests of all owners been consolidated by communitization, unitization, force-pooling, etc?

☐ Yes ☐ No If answer is "yes," type of consolidation \_\_\_\_\_

If answer is "no," list the owners and tract descriptions which have actually been consolidated. (Use reverse side of this form if necessary.) \_\_\_\_\_

No allowable will be assigned to the well until all interests have been consolidated (by communitization, unitization, forced-pooling, or otherwise) or until a non-standard unit, eliminating such interests, has been approved by the Division.

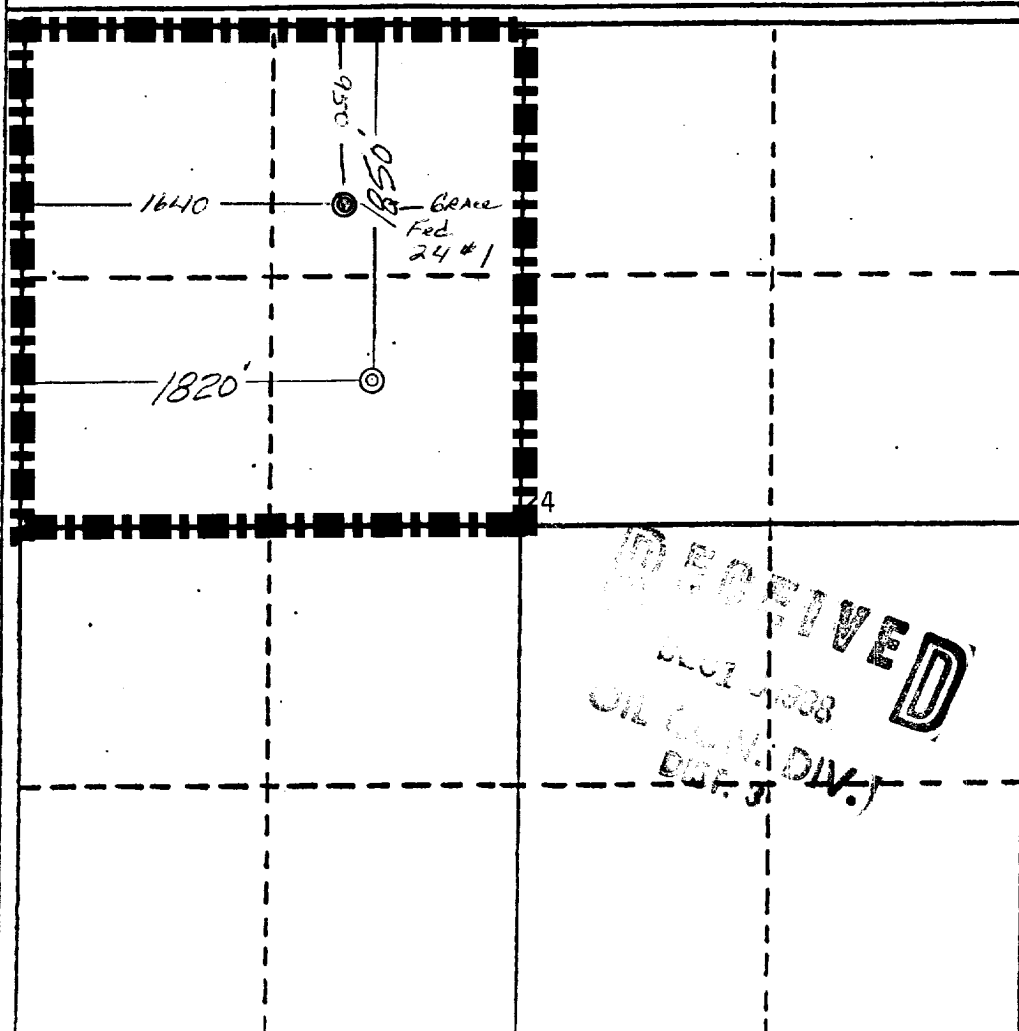

CERTIFICATION

I hereby certify that the information contained herein is true and complete to the best of my knowledge and belief.

Name *Shirley Blanchard* for  
Position BANNON ENERGY

Company  
BANNON ENERGY, INC.

Date  
DECEMBER 14, 1988

I hereby certify that the location shown on this plat was plotted from field notes of actual surveys made by me or under my supervision, and that the same is true and correct to the best of my knowledge and belief.

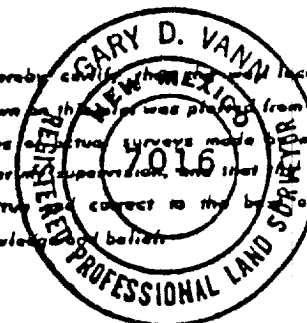

Date Surveyed  
October 10, 1988

Registered Professional Engineer  
and/or Land Surveyor

*Gary D. Vann*  
Gary D. Vann

Certificate No.  
7016

