

DISTRICT I
P.O. Box 1980, Hobbs, NM 88241-1980
DISTRICT II
811 South First St., Artesia, NM 88210-2835
DISTRICT III
1000 Rio Brazos Rd., Aztec, NM 87410-1693

State of New Mexico
Energy, Minerals and Natural Resources Department
OIL CONSERVATION DIVISION
2040 S. Pacheco
Santa Fe, New Mexico 87505-6429

Form C-107-A
New 3-12-96

APPROVAL PROCESS:

☒ Administrative ☐ Hearing

EXISTING WELLBORE

☒ YES ☐ NO

APPLICATION FOR DOWNHOLE COMMINGLING

FOUR STAR OIL AND GAS COMPANY		3300 N. Butler Ave., Suite 100		Farmington	NM	87401
Operator		Address				
C W ROBERTS		17 T25N R03W RIO ARRIBA				
Lease		County				
9		Unit Ltr. - Sec - Twp - Rge				
Well No.		Spacing Unit Lease Types: (check 1 or more)				
OGRID No. 131994		Property Code		API No. 3003924957	Federal <input checked="" type="checkbox"/>	State <input type="checkbox"/> (and/or) Fee <input type="checkbox"/>

The following facts are submitted in support of downhole commingling:	Upper Zone	Intermediate Zone	Lower Zone
1 Pool Name and Pool Code	Basin Fruitland Coal 71629		Blanco PC South 72439
2 Top and Bottom of Pay Section (Perforations)	3662'-3763'		3802'-3846'
3 Type of Production (Oil or Gas)	Gas		Gas
4 Method of Production (Flowing or Artificial Lift)	Flowing		Flowing
5 Bottomhole Pressure Oil Zones - Artificial Lift: Estimated Current Gas Oil - Flowing: Measured Current All Gas Zones: Estimated Or Measured Original	a. (Current) b. (Original) 449.46 psig	a. b.	a. 327 psig (ave. offset well) b. 434.9 psig (from offset well)
6 Oil Gravity (*API) or Gas BTU Content	1153 btu/cu ft		1156 btu/cu ft (from offset well)
7 Producing or Shut-in? Production Marginal? (yes or no)	Producing yes		not yet completed yes
* If Shut-in, give date and oil/gas/ water rates of last production Note: For new zones with no production history applicant shall be required to attach production estimates and supporting data	Date: Rates:	Date: Rates:	Date: Rates:
* If Producing, give date and oil/gas/ water rates of recent test (within 60 days)	Date: 12/15/96 Rates: 16 MCFD 0 BWPD	Date: Rates:	Date: Rates: not yet completed
8 Fixed Percentage Allocation Formula - % for each zone	Oil: % Gas: %	Oil: % Gas: %	Oil: % Gas: %

9. If allocation formula is based upon something other than current or past production, or is based on some other method, submit attachments with supporting data and/or explaining method and providing rate projections or other required data.
10. Are all working, overriding, and royalty interests identical in all commingled zones? ☒ Yes ☐ No
If not, have all working, overriding, and royalty interests been notified by certified mail? ☐ Yes ☐ No
Have all offset operators been given written notice of the proposed downhole commingling ☒ Yes ☐ No
11. Will cross-flow occur? ☐ Yes ☒ No If yes, are fluids compatible, will formations not be damaged, will any c flowed production be recovered, and will the allocation formula be reliable? ☐ Yes ☐ No (If No, attach explanation)
12. Are all produced fluids from all commingled zones compatible with each other ☒ Yes ☐ No
13. Will the value of production be decreased by commingling? ☐ Yes ☒ No (If Yes, attach explanation)
14. If this well is on, or communitized with, state or federal lands, either the Commissioner of Public Lands or the United States Bureau of Land Management has been notified in writing of this application ☒ Yes ☐ No
15. NMOCD Reference Cases for Rule 303(D) Exceptions: ORDER NO(S).
16. ATTACHMENTS:

*C-102 for each zone to be commingled showing its spacing unit and acreage dedication. *Exhibit IA & IB*
*Production curve for each zone for at least one year. (If not available, attach explanation.) *Exhibit II*
*For zones with no production history, estimated production rates and supporting data. *Exhibit IIIA, IIIB, & IIIC*
*Data to support allocation method or formula. *Exhibit IV*
*Notification list of all offset operators. *Exhibit V*
*Notification list of all working, overriding, and royalty interest for uncommon interest cases.
*Any additional statements, data, or documents required to support commingling. *Exhibit VI*

I hereby certify that the information above is true and complete to the best of my knowledge and belief.

Signature Ted A. Tipton Title Operating Unit Manager Date 1-16-97
TYPE OR PRINT NAME Ted A. Tipton Telephone 325-4397

OIL CONSERVATION DIVISION

P.O. Box 2088
Santa Fe, New Mexico 87504-2088

Exhibit 1A

DISTRICT I
P.O. Box 1980, Hobbs, NM 88240

DISTRICT II
P.O. Drawer DD, Artesia, NM 88210

DISTRICT III
1000 Rio Arriba Rd., Aztec, NM 87410

WELL LOCATION AND ACREAGE DEDICATION PLAT

All Distances must be from the outer boundaries of the section

Operator TEXACO			Lease CW Roberts		Well No. 9
Unit Letter G	Section 17	Township 25 North	Range 3 West	County NMEN	Rio Arriba
Actual Footage Location of Well: 1615 feet from the North line and 1590 feet from the East line			Producing Formation Fruitland Coal		
Ground level Elev. 7273'			Pool Basin Fruitland Coal		
			Dedicated Acreage: 320 Acres		

1. Outline the acreage dedicated to the subject well by colored pencil or ballpoint marker on the plat below.
2. If more than one lease is dedicated to the well, outline each and identify the ownership thereof (both as to working interest and royalty).
3. If more than one lease of different ownership is dedicated to the well, have the interest of all owners been consolidated by commutation, unitization, force-pooling, etc.?
☐ Yes ☐ No If answer is "yes" type of consolidation NA
If answer is "no" list the owners and tract descriptions which have actually been consolidated. (Use reverse side of this form if necessary.)
No allowable will be assigned to the well until all interests have been consolidated (by commutation, unitization, force-pooling, or otherwise) or until a non-standard unit, encompassing such interest, has been approved by the Division.



OPERATOR CERTIFICATION

I hereby certify that the information contained herein is true and complete to best of my knowledge and belief.

Signature
Alan A. Kleier
Printed Name
Alan A. Kleier
Position
Area Manager
Company
Texaco, Inc.
Date

SURVEYOR CERTIFICATION

I hereby certify that the well location shown on this plat was plotted from field notes actual surveys made by me or under my supervision, and that the same is true and correct to the best of my knowledge and belief.

Date
11/17/90

Signature
Professional Surveyor



Certification
Noale Edwards

DISTRICT I

P.O. Box 1980, Hobbs, NM 88241-1980

DISTRICT II

P.O. Box Drawer DD, Artesia, NM 88211-071

DISTRICT III

1000 Rio Brazos Rd., Aztec, NM 87410

DISTRICT IV

P.O. Box 2088, Santa Fe, NM 87504-2088

State of New Mexico

Energy, Minerals and Natural Resources Department

OIL CONSERVATION DIVISION

P.O. Box 2088

Santa Fe, New Mexico 87504-2088

Form C-102

Revised February 10, 1999

Instructions on back

Submit to Appropriate District Office

State Lease - 4 Copies

Fee Lease - 3 Copies

☐ AMENDED REPORT

WELL LOCATION AND ACREAGE DEDICATION PLAT

¹ API Number 3003924957	² Pool Code 72439	³ Pool Name BLANCO P. C. SOUTH (PRORATED GAS)
⁴ Property Code 011208	⁵ Property Name C W ROBERTS	⁶ Well No. 9
⁷ OGRID Number 131994	⁸ Operator Name FOUR STAR OIL AND GAS COMPANY	⁹ Elevation 7273

¹⁰ Surface Location

Ul or lot no.	Section	Township	Range	Lot.Idn	Feet From The	North/South Line	Feet From The	East/West Line	County
G	17	T25N	R03W		1615	NORTH	1590	EAST	RIO ARRIBA

¹¹ Bottom Hole Location If Different From Surface

Ul or lot no.	Section	Township	Range	Lot.Idn	Feet From The	North/South Line	Feet From The	East/West Line	County
¹² Dedicated Acre 160	¹³ Joint or Infill No	¹⁴ Consolidation Code	¹⁵ Order No.						

NO ALLOWABLE WILL BE ASSIGNED TO THIS COMPLETION UNTIL ALL INTERESTS HAVE BEEN CONSOLIDATED
OR A NON-STANDARD UNIT HAS BEEN APPROVED BY THE DIVISION

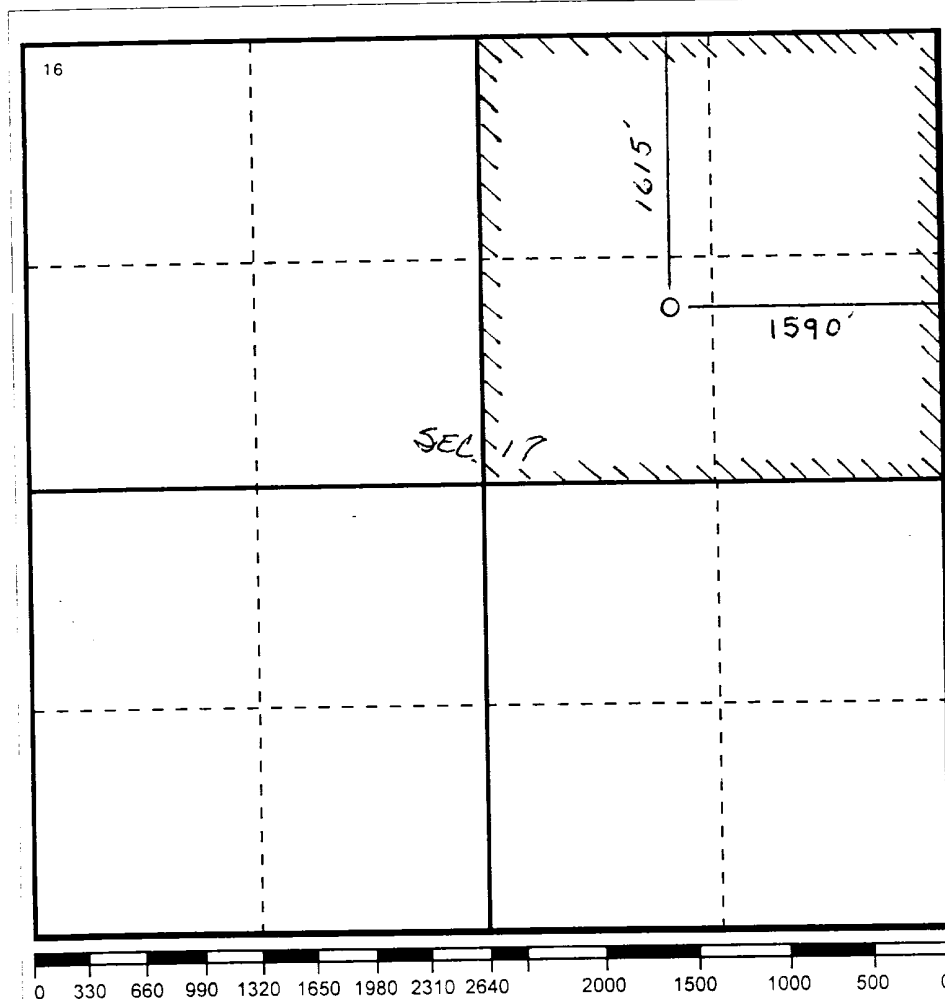
¹⁷ OPERATOR CERTIFICATION

I hereby certify that the information contained herein is true and complete to the best of my knowledge and belief

Signature

Printed Name

Ted A. Tipton

Position

Operating Unit Manager

Date

10/3/95

¹⁸ SURVEYOR CERTIFICATION

I hereby certify that the well location shown on this plat was plotted from field notes of actual surveys made by me or under my supervision, and that the same is true and correct to the best of my knowledge and belief.

Date Surveyed

Signature & Seal of Professional Surveyor

Certificate No.

Exhibit II

ROBERTS, C. W. 9 BASIN FRUITLAND COAL (GAS)
 FSOG FRUITLAND COAL

LEASE DATA
 LSE 017665
 FLD 71629
 OPER FSOG
 ZONE FRTLCO
 --
 COUNTY 039
 STATE 30
 30039249570001
 STATUS 9-96
 CO 0 MBO
 CG 47 MMCF
 CW 0 MBW
 BOPD 0
 BWPD 0
 MCFPD 16
 WELLS 1
 CI 0 MBWI
 BWIPD 0

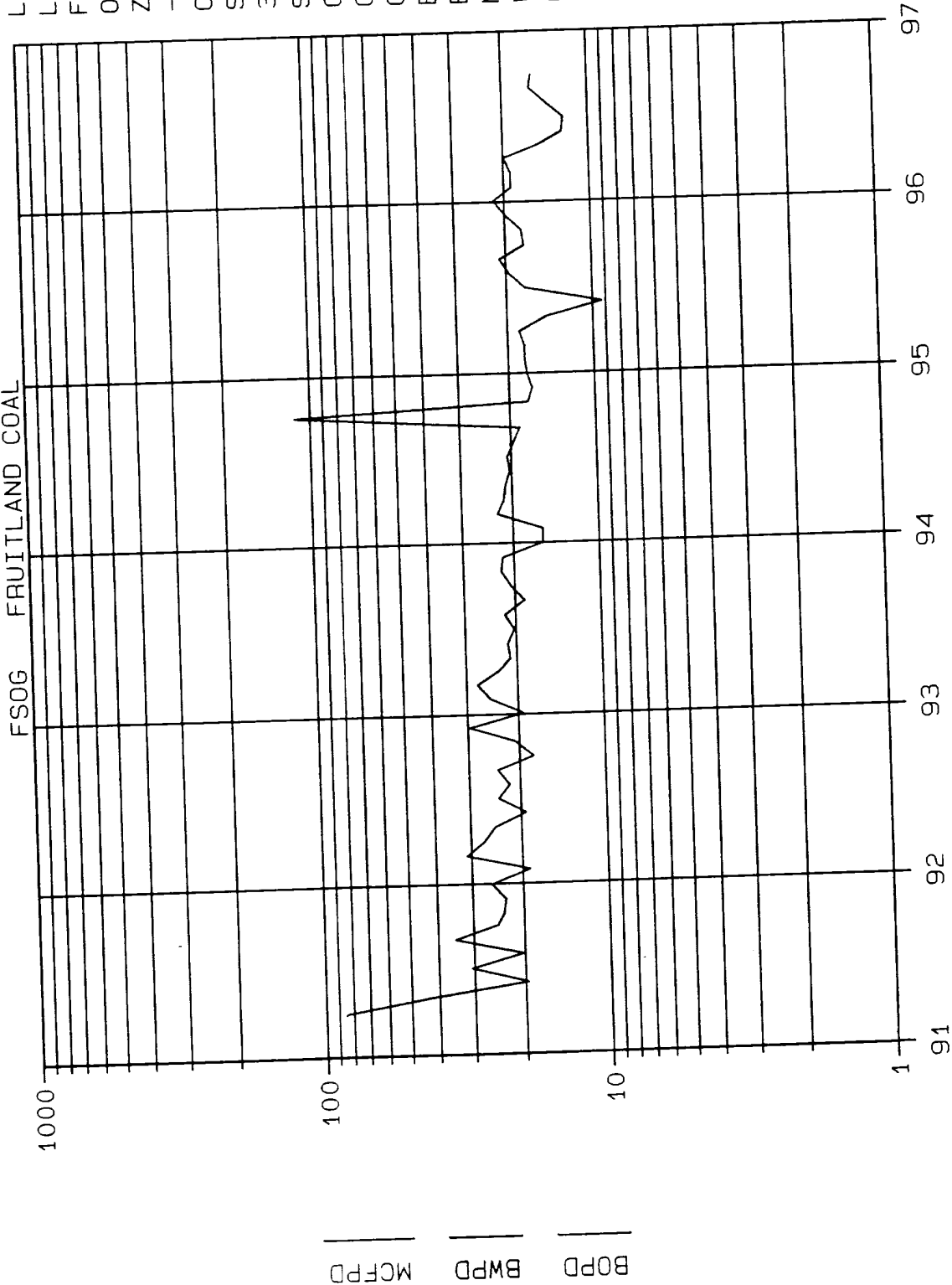

YEARS

Exhibit IIIA

ROBERTS, C. W. 4 BLANCO P.C. SOUTH (PRORATED GAS)

TEPI PICTURED CLIFFS

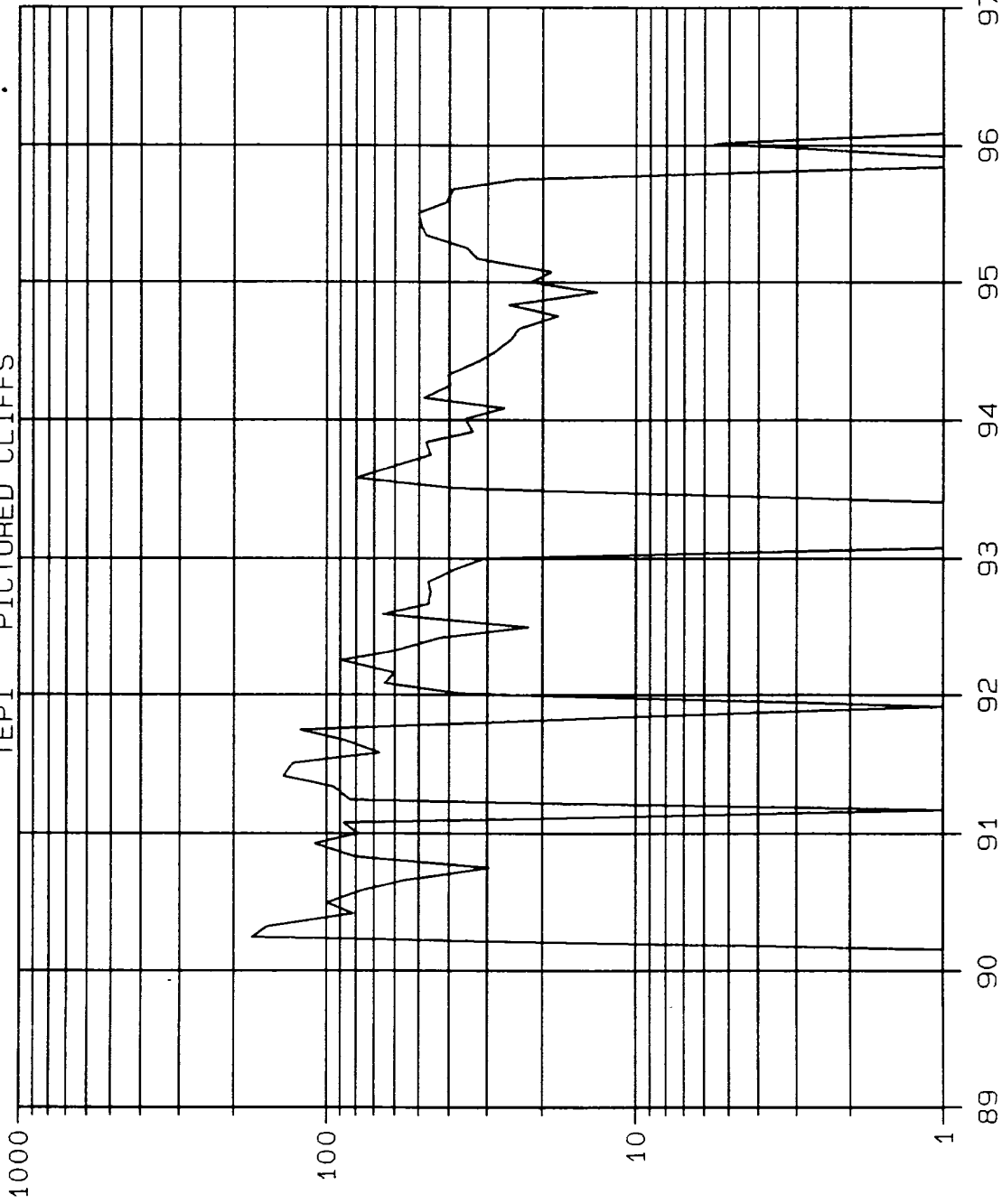

YEARS

LEASE DATA
LSE 017665
FLD 72439
OPER TEPI
ZONE PC
--
COUNTY 039
STATE 30
30039059650003
STATUS 1-96
CO 0 MBO
CG 105 MMCF
CW 0 MBW
BOPD 0
BWPD 0
MCFPD 0
WELLS 1
CI 0 MBWI
BWIPD 0

Exhibit VII

C W ROBERTS 7 BLANCO SOUTH

FOUR STAR OIL & GAS COMPANY PICTURED CLIFFS

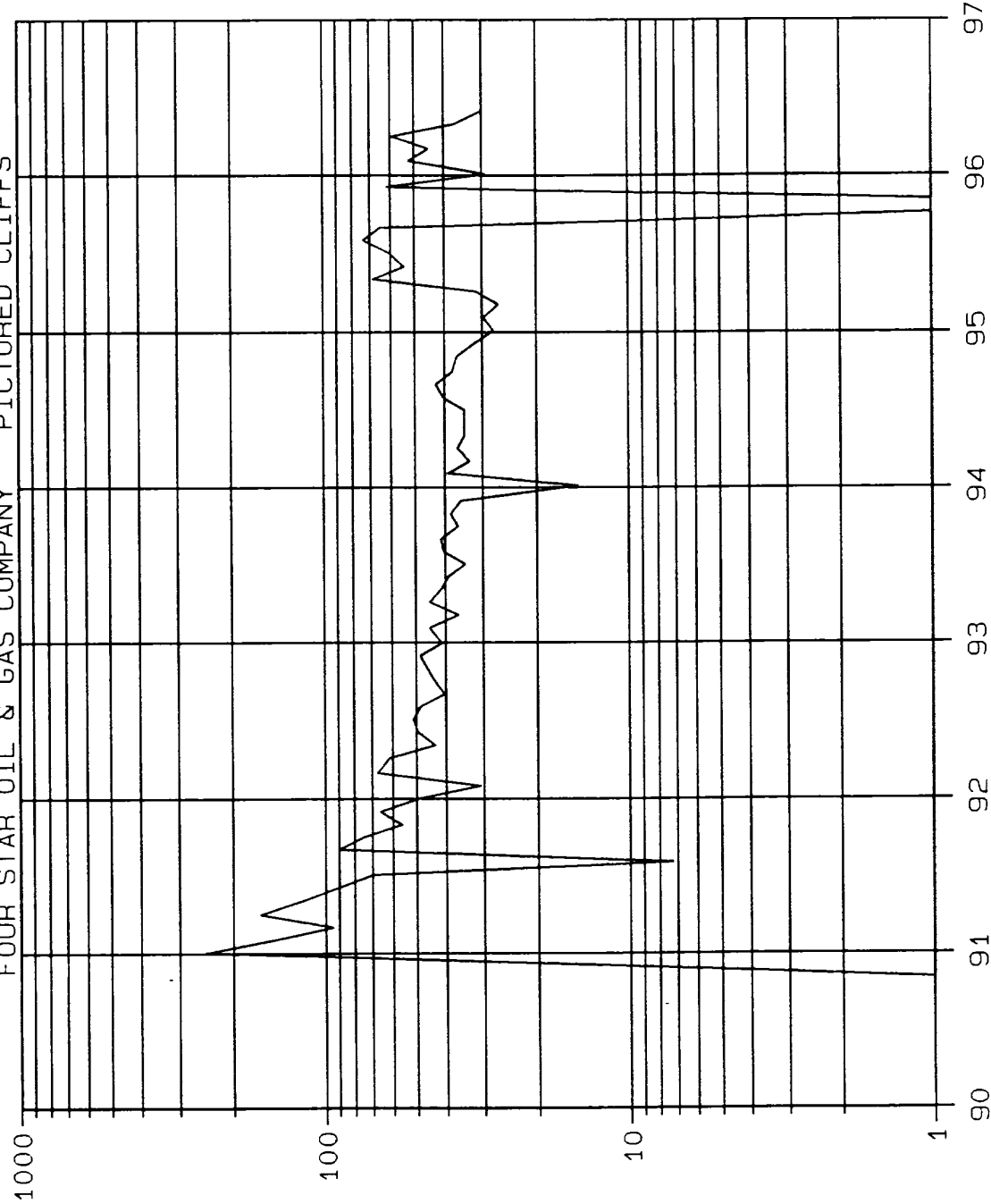

YEARS

LEASE DATA
LSE 017665
FLD 5920
OPER 72673
ZONE 631
25N-3W-17
COUNTY 39
STATE 30
30039231020000
STATUS 5-96
CO 0 MBO
CG 105 MMCF
CW 0 MBW
BOPD 0
BWPD 0
MCFPD 30
WELLS 1
CI 0 MBWI
BWIPD 0

Exhibit III C

ROBERTS, C. W. 8 BLANCO P.C. SOUTH (PRORATED GAS)

TEPI PICTURED CLIFFS

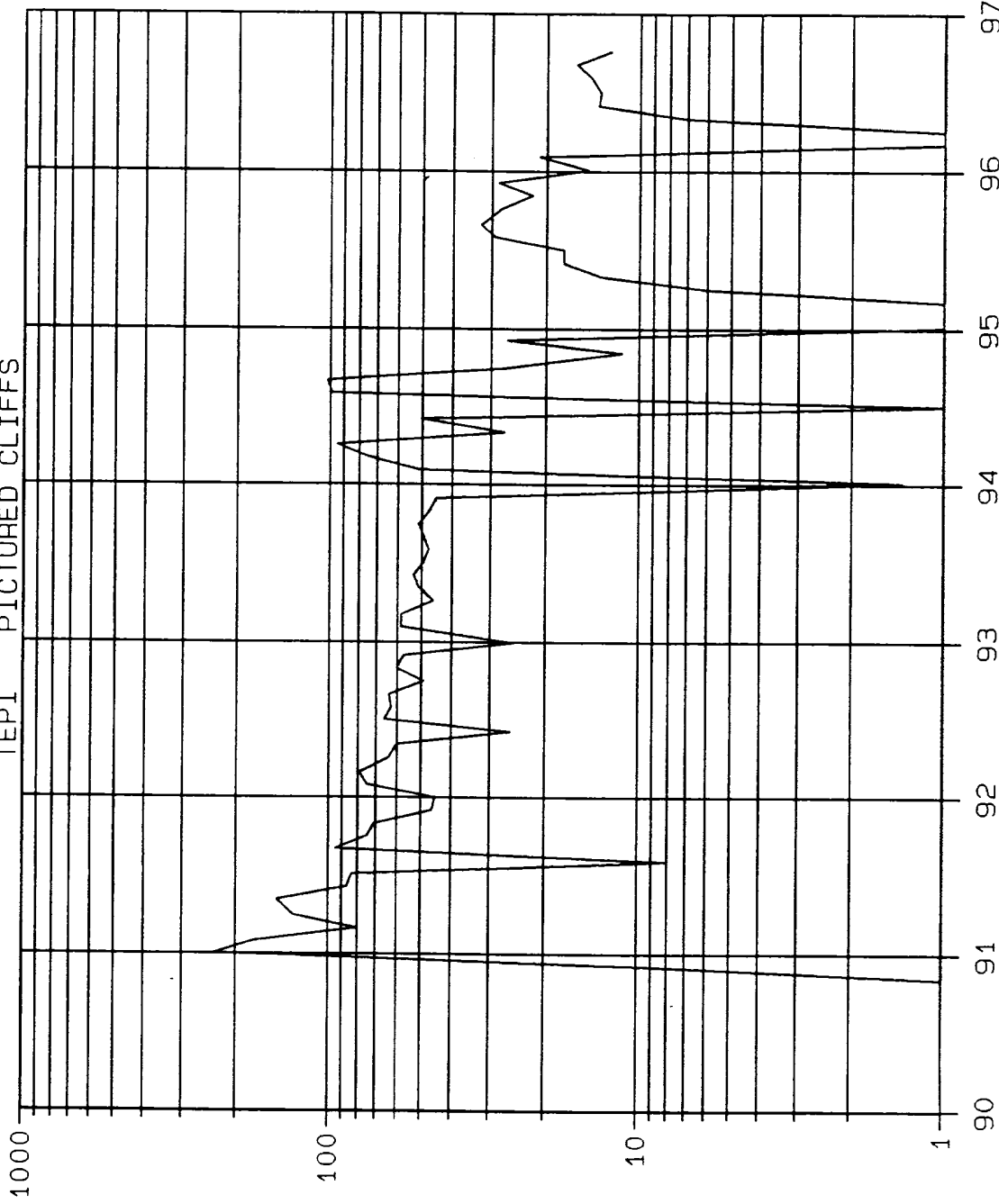

YEARS

LEASE DATA
 LSE 017665
 FLD 72439
 OPER TEPI
 ZONE PC
 --
 COUNTY 039
 STATE 30
 30039231010002
 STATUS 9-96
 CO 0 MBO
 CG 103 MMCF
 CW 0 MBW
 BOPD 0
 BWPD 0
 MCFPD 12
 WELLS 1
 CI 0 MBWI
 BWIPD 0

Exhibit IV

Current Fruitland Coal Production

Oil, BOPD	0
Water, BWPD	0
Gas, MCFD	16

Anticipated Pictured Cliffs Production

Oil, BOPD	0
Water, BWPD	0
Gas, MCFD	100

The combined production from both zones is expected to be 116 MCFD, 0 BOPD and 0 BWPD.

Using out anticipated PC production rate, allocation factors will be calculated as follows:

	<u>Gas</u>	<u>Oil</u>
Fruitland Coal	$16/(16+100) = 14\%$	0
Pictured Cliffs	$100/(16+100) = 86\%$	0

The actual production rate following the commingling process will be presented to the Aztec NMOCD office to arrive at proper allocation factors for splitting the production stream.

Exhibit V

OFFSET OPERATORS
FOR ROBERTS NO. 9
T-25-N, R-3-W
RIO ARriba COUNTY, NM

(1) SW/4-Section 7-25N-3W (Fruitland Coal formation)

Dugan Production Corp.
P.O. Box 420
Farmington, New Mexico 87499-0420

Standard Silver Corp.
309 Washington SE
Albuquerque, New Mexico 87108

(2) SE-Section 7-25N-3W (Fruitland Coal formation)

Minel, Inc.
309 Washington SE
Albuquerque, New Mexico 87108

(3) SW/4-Section 8-25N-3W (Fruitland Coal/Pictured Cliffs formation); SE/4-Section 16-25N-3W (Fruitland Coal formation); SW/4-Section 16-25N-3W (Fruitland Coal/Pictured Cliffs formation)

Schalk Development Co.
P.O. Box 25825
Albuquerque, New Mexico 87125

Martha Rouse Schalk, Trustee
P.O. Box 25825
Albuquerque, New Mexico 87125

John E. Rouse Trust
P.O. Box 408
Cheyenne, Wyoming 82003

(4) SE/4-Section 8-25N-3W (Fruitland Coal/Pictured Cliffs formation); SE/4-Section 9-25N-3W (Fruitland Coal formation); SW/4-Section 9-25N-3W (Fruitland Coal/Pictured Cliffs formation)

Meridian Oil Production, Inc.
P.O. Box 4289
Farmington, New Mexico 87499-4289

(5) NE/4-Section 16-25N-3W (Fruitland Coal formation); NW/4-Section 16-25N-3W (Fruitland Coal/Pictured Cliffs formation)

James E. Rogers
2525 Gateway West
El Paso, Texas 79903

Is your RETURN ADDRESS completed on the reverse side?

SENDER:

- Complete items 1 and/or 2 for additional services.
- Complete items 3, 4a, and 4b.
- Print your name and address on the reverse of this form so that we can return this card to you.
- Attach this form to the front of the mailpiece, or on the back if space does not permit.
- Write "Return Receipt Requested" on the mailpiece below the article number.
- The Return Receipt will show to whom the article was delivered and the date delivered.

I also wish to receive the following services (for an extra fee):

- ☐ Addressee's Address
- ☐ Restricted Delivery

Consult postmaster for fee.

3. Article Addressed to:

DUGAN PRODUCTION CORP.
PO BOX 420
FARMINGTON, NM 87499-0420

4a. Article Number

P 553 379 454

4b. Service Type

- ☐ Registered ☒ Certified
☐ Express Mail ☐ Insured
☒ Return Receipt for Merchandise ☐ COD

7. Date of Delivery

1/15/97

5. Received By: (Print Name)

John Dugan

6. Signature: (Addressee or Agent)

X [Signature]

8. Addressee's Address (Only if requested and fee is paid)

Domestic Return Receipt

PS Form 3811, December 1994

Thank you for using Return Receipt Service.

Is your RETURN ADDRESS completed on the reverse side?

SENDER:

- Complete items 1 and/or 2 for additional services.
- Complete items 3, 4a, and 4b.
- Print your name and address on the reverse of this form so that we can return this card to you.
- Attach this form to the front of the mailpiece, or on the back if space does not permit.
- Write "Return Receipt Requested" on the mailpiece below the article number.
- The Return Receipt will show to whom the article was delivered and the date delivered.

I also wish to receive the following services (for an extra fee):

- ☐ Addressee's Address
- ☐ Restricted Delivery

Consult postmaster for fee.

3. Article Addressed to:

STANDARD SILVER CORP.
309 WASHINGTON SE
ALBUQUERQUE, NM 87108

4a. Article Number

P 553 379 451

4b. Service Type

- ☐ Registered ☒ Certified
☐ Express Mail ☐ Insured
☒ Return Receipt for Merchandise ☐ COD

7. Date of Delivery

1/27

5. Received By: (Print Name)

6. Signature: (Addressee or Agent)

X [Signature]

8. Addressee's Address (Only if requested and fee is paid)

Domestic Return Receipt

PS Form 3811, December 1994

Thank you for using Return Receipt Service.

Is your RETURN ADDRESS completed on the reverse side?

SENDER:

- Complete items 1 and/or 2 for additional services.
- Complete items 3, 4a, and 4b.
- Print your name and address on the reverse of this form so that we can return this card to you.
- Attach this form to the front of the mailpiece, or on the back if space does not permit.
- Write "Return Receipt Requested" on the mailpiece below the article number.
- The Return Receipt will show to whom the article was delivered and the date delivered.

I also wish to receive the following services (for an extra fee):

- ☐ Addressee's Address
- ☐ Restricted Delivery

Consult postmaster for fee.

3. Article Addressed to:

MENEL, INC.
309 WASHINGTON SE
ALBUQUERQUE, NM 87108

4a. Article Number

P 553 379 492

4b. Service Type

- ☐ Registered ☒ Certified
☐ Express Mail ☐ Insured
☒ Return Receipt for Merchandise ☐ COD

7. Date of Delivery

1/27

5. Received By: (Print Name)

6. Signature: (Addressee or Agent)

X [Signature]

8. Addressee's Address (Only if requested and fee is paid)

Domestic Return Receipt

PS Form 3811, December 1994

Thank you for using Return Receipt Service.

Is your RETURN ADDRESS completed on the reverse side?

SENDER:

- Complete items 1 and/or 2 for additional services.
- Complete items 3, 4a, and 4b.
- Print your name and address on the reverse of this form so that we can return this card to you.
- Attach this form to the front of the mailpiece, or on the back if space does not permit.
- Write "Return Receipt Requested" on the mailpiece below the article number.
- The Return Receipt will show to whom the article was delivered and the date delivered.

I also wish to receive the following services (for an extra fee):

- ☐ Addressee's Address
- ☐ Restricted Delivery

Consult postmaster for fee.

3. Article Addressed to:

SCHALK DEVELOPMENT CO.
PO BOX 25825
ALBUQUERQUE, NM 87125



4a. Article Number

P 195 081 729

4b. Service Type

- ☐ Registered ☒ Certified
☐ Express Mail ☐ Insured
☒ Return Receipt for Merchandise ☐ COD

7. Date of Delivery

8. Addressee's Address (Only if requested and fee is paid)

5. Received By: (Print Name)

6. Signature: (Addressee or Agent)

X *[Signature]*
PS Form 3811, December 1994

Domestic Return Receipt

Thank you for using Return Receipt Service.

Is your RETURN ADDRESS completed on the reverse side?

SENDER:

- Complete items 1 and/or 2 for additional services.
- Complete items 3, 4a, and 4b.
- Print your name and address on the reverse of this form so that we can return this card to you.
- Attach this form to the front of the mailpiece, or on the back if space does not permit.
- Write "Return Receipt Requested" on the mailpiece below the article number.
- The Return Receipt will show to whom the article was delivered and the date delivered.

I also wish to receive the following services (for an extra fee):

- ☐ Addressee's Address
- ☐ Restricted Delivery

Consult postmaster for fee.

3. Article Addressed to:

MARTHA ROUSE SCHALK, TRUSTEE
PO BOX 25825
ALBUQUERQUE, NM 87125

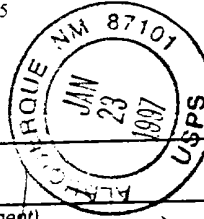

4a. Article Number

P 553 379 453

4b. Service Type

- ☐ Registered ☒ Certified
☐ Express Mail ☐ Insured
☒ Return Receipt for Merchandise ☐ COD

7. Date of Delivery

8. Addressee's Address (Only if requested and fee is paid)

5. Received By: (Print Name)

6. Signature: (Addressee or Agent)

X *[Signature]*
PS Form 3811, December 1994

Domestic Return Receipt

Thank you for using Return Receipt Service.

Is your RETURN ADDRESS completed on the reverse side?

SENDER:

- Complete items 1 and/or 2 for additional services.
- Complete items 3, 4a, and 4b.
- Print your name and address on the reverse of this form so that we can return this card to you.
- Attach this form to the front of the mailpiece, or on the back if space does not permit.
- Write "Return Receipt Requested" on the mailpiece below the article number.
- The Return Receipt will show to whom the article was delivered and the date delivered.

I also wish to receive the following services (for an extra fee):

- ☐ Addressee's Address
- ☐ Restricted Delivery

Consult postmaster for fee.

3. Article Addressed to:

JOHN E ROUSE TRUST
PO BOX 408
ALBUQUERQUE, NM 872003

4a. Article Number

P 553 379 452

4b. Service Type

- ☐ Registered ☒ Certified
☐ Express Mail ☐ Insured
☒ Return Receipt for Merchandise ☐ COD

7. Date of Delivery

8. Addressee's Address (Only if requested and fee is paid)

5. Received By: (Print Name)

6. Signature: (Addressee or Agent)

X

PS Form 3811, December 1994

Domestic Return Receipt

Thank you for using Return Receipt Service.

Is your RETURN ADDRESS completed on the reverse side?

SENDER:

- Complete items 1 and/or 2 for additional services.
- Complete items 3, 4a, and 4b.
- Print your name and address on the reverse of this form so that we can return this card to you.
- Attach this form to the front of the mailpiece, or on the back if space does not permit.
- Write "Return Receipt Requested" on the mailpiece below the article number.
- The Return Receipt will show to whom the article was delivered and the date delivered.

I also wish to receive the following services (for an extra fee):

1. ☐ Addressee's Address
2. ☐ Restricted Delivery

Consult postmaster for fee.

3. Article Addressed to:

MERIDIAN OIL PRODUCTION, INC.
PO BOX 4289
ALBUQUERQUE, NM 87499-4289

4a. Article Number

P 553 379 494

4b. Service Type

- ☐ Registered ☒ Certified
☐ Express Mail ☐ Insured
☒ Return Receipt for Merchandise ☐ COD

7. Date of Delivery

01-24-97

5. Received By: (Print Name)

Judith Dee

8. Addressee's Address (Only if requested and fee is paid)

6. Signature: (Addressee or Agent)

X Judith H. Dee

PS Form 3811, December 1994

Domestic Return Receipt

Thank you for using Return Receipt Service.

Is your RETURN ADDRESS completed on the reverse side?

SENDER:

- Complete items 1 and/or 2 for additional services.
- Complete items 3, 4a, and 4b.
- Print your name and address on the reverse of this form so that we can return this card to you.
- Attach this form to the front of the mailpiece, or on the back if space does not permit.
- Write "Return Receipt Requested" on the mailpiece below the article number.
- The Return Receipt will show to whom the article was delivered and the date delivered.

I also wish to receive the following services (for an extra fee):

1. ☐ Addressee's Address
2. ☐ Restricted Delivery

Consult postmaster for fee.

3. Article Addressed to:

JAMES E ROGERS
2525 GATEWAY WEST
EL PASO, TX 79903

4a. Article Number

P 553 379 493

4b. Service Type

- ☐ Registered ☒ Certified
☐ Express Mail ☐ Insured
☒ Return Receipt for Merchandise ☐ COD

7. Date of Delivery

JAN 2 1997

5. Received By: (Print Name)

8. Addressee's Address (Only if requested and fee is paid)

6. Signature: (Addressee or Agent)

X J. Ambiano

PS Form 3811, December 1994

Domestic Return Receipt

Thank you for using Return Receipt Service.



Texaco Exploration and Production Inc

3300 N Butler
Farmington NM 87401

January 16, 1997

Dugan Production Corp.

P. O. Box 420
Farmington NM 87499-0420
Re: Downhole Commingle
C. W. Roberts No. 9
1615' FNL & 1590' FEL, Sec. 17-T25N-R3W, Unit G
Rio Arriba County, New Mexico

Gentlemen:

As offset operator to the spacing unit for the referenced well, you are being notified of our request for an exception to NMOCD Rule 303-A. Four Star Oil and Gas Company proposes to downhole commingle the Basin Fruitland Coal and the Blanco P. C. South pools within the above referenced well.

If you have no objection to the above application please sign the waiver at the bottom of this letter and return it to this address. If you desire to submit remarks concerning this application, please send them to Mr. William J. LeMay, Director, New Mexico Oil Conservation Division, 2040 S. Pacheco, Santa Fe, New Mexico, 87505-6429. A copy of any remarks to undersigned would be appreciated. If no objection is received within 20 days of receipt of this letter, the Director may approve the proposed application. Your attention to this matter is greatly appreciated.

If you have any questions concerning this matter please contact Mr. Mark R. Reinhold at 505-325-4397 ext. 19.

Sincerely,

Ted A. Tipton
Operations Unit Manager
MRR/s

Attachments
cc: file

FARMINGTON AREA			
TAT		JMY	
RH		MGB	
LNS		REW	
BRH			
JAN 22 1997			
MRR	1-22-97	JLS	
RFS		TLD	
BAB			
RSD		FILE	
TRB		RETURN TO	

Waiver Approval:

Company: DUGAN PRODUCTION CORP.

BY: Thomas A. Dugan
Thomas A. Dugan, President

DATE: 1-26-97



Texaco Exploration and Production Inc

3300 N Butler

Farmington NM 87401

FARMINGTON AREA

TAT		JMY	
RH		MGB	
LNS		RDW	
BRH			

January 16, 1997

FEB - 3 1997

MRR		JLS	
RHS		TLD	
BAB			
RSD		FILE	
TRB		RETURN TO	

Standard Silver Corp.

309 Washington SE

Albuquerque, NM 87108

Re: Downhole Commingle

C. W. Roberts No. 9

1615' FNL & 1590' FEL, Sec. 17-T25N-R3W, Unit

Rio Arriba County, New Mexico

Gentlemen:

As offset operator to the spacing unit for the referenced well, you are being notified of our request for an exception to NMOCD Rule 303-A. Four Star Oil and Gas Company proposes to downhole commingle the Basin Fruitland Coal and the Blanco P. C. South pools within the above referenced well.

If you have no objection to the above application please sign the waiver at the bottom of this letter and return it to this address. If you desire to submit remarks concerning this application, please send them to Mr. William J. LeMay, Director, New Mexico Oil Conservation Division, 2040 S. Pacheco, Santa Fe, New Mexico, 87505-6429. A copy of any remarks to undersigned would be appreciated. If no objection is received within 20 days of receipt of this letter, the Director may approve the proposed application. Your attention to this matter is greatly appreciated.

If you have any questions concerning this matter please contact Mr. Mark R. Reinhold at 505-325-4397 ext. 19.

Sincerely,

Ted A. Tipton

Operations Unit Manager

MRR/s

Attachments

cc: file

Waiver Approval:

Company: Standard Silver Corp

BY: Carl Cooper

DATE: 1/29/97



Texaco Exploration and Production Inc

3300 N Butler
Farmington NM 87401

Minel, Inc.
309 Washington SE
Albuquerque, NM 87108
Re: Downhole Commingle
C. W. Roberts No. 9
1615' FNL & 1590' FEL, Sec. 17-T25N-R3W, Unit G
Rio Arriba County, New Mexico

FARMINGTON AREA				January 16, 1997
TAT		JNY		
RH		MGB		
LNS		REW		
BRH				
FEB - 3 1997				
MRR		JLS		
RFS		TLD		
BAB				
RSD		FILE		
TRE		RETURN TO		

Gentlemen:

As offset operator to the spacing unit for the referenced well, you are being notified of our request for an exception to NMOCD Rule 303-A. Four Star Oil and Gas Company proposes to downhole commingle the Basin Fruitland Coal and the Blanco P. C. South pools within the above referenced well.

If you have no objection to the above application please sign the waiver at the bottom of this letter and return it to this address. If you desire to submit remarks concerning this application, please send them to Mr. William J. LeMay, Director, New Mexico Oil Conservation Division, 2040 S. Pacheco, Santa Fe, New Mexico, 87505-6429. A copy of any remarks to undersigned would be appreciated. If no objection is received within 20 days of receipt of this letter, the Director may approve the proposed application. Your attention to this matter is greatly appreciated.

If you have any questions concerning this matter please contact Mr. Mark R. Reinhold at 505-325-4397 ext. 19.

Sincerely,

Ted A. Tipton
Operations Unit Manager
MRR/s

Attachments
cc: file

Waiver Approval:

Company: Minel, Inc.

BY: Joel Canyon

DATE: 1/30/97



Texaco Exploration and Production Inc

3300 N Butler
Farmington NM 87401

January 16, 1997

James E. Rogers
2525 Gateway West
El Paso, Texas 79903
Re: Downhole Commingle
C. W. Roberts No. 9
1615' FNL & 1590' FEL, Sec. 17-T25N-R3W, Unit G
Rio Arriba County, New Mexico

Gentlemen:

As offset operator to the spacing unit for the referenced well, you are being notified of our request for an exception to NMOCD Rule 303-A. Four Star Oil and Gas Company proposes to downhole commingle the Basin Fruitland Coal and the Blanco P. C. South pools within the above referenced well.

If you have no objection to the above application please sign the waiver at the bottom of this letter and return it to this address. If you desire to submit remarks concerning this application, please send them to Mr. William J. LeMay, Director, New Mexico Oil Conservation Division, 2040 S. Pacheco, Santa Fe, New Mexico, 87505-6429. A copy of any remarks to undersigned would be appreciated. If no objection is received within 20 days of receipt of this letter, the Director may approve the proposed application. Your attention to this matter is greatly appreciated.

If you have any questions concerning this matter please contact Mr. Mark R. Reinhold at 505-325-4397 ext. 19.

Sincerely,

Ted A. Tipton
Operations Unit Manager
MRR/s

Attachments
cc: file

FARMINGTON AREA			
TAT		JMY	
RH		HGB	
LNS		RDW	
BRH			
MAR - 3 1997			
MRR		JLS	
RFS		TLD	
BAB			
RSD		FILE	
TRB		RETURN TO	

Waiver Approval: _____
Company: Little Oil & Gas, Inc
BY: Sylvia Little
DATE: 2-12-97

UNITED STATES
DEPARTMENT OF THE INTERIOR
BUREAU OF LAND MANAGEMENT

FORM APPROVED
Budget Bureau No. 1004-0135
Expires: March 31, 1993

SUNDRY NOTICES AND REPORTS ON WELLS

Do not use this form for proposals to drill or to deepen or reentry to a different reservoir.

Use "APPLICATION FOR PERMIT --" for such proposals

SUBMIT IN TRIPLICATE

1. Type of Well: ☐ OIL WELL ☒ GAS WELL ☐ OTHER

2. Name of Operator
FOUR STAR OIL AND GAS COMPANY

3. Address and Telephone No. 3300 N. Butler Ave., Suite Farmington NM 87401 325-4397

4. Location of Well (Footage, Sec., T., R., M., or Survey Description)
Unit Letter G : 1615 Feet From The NORTH Line and 1590 Feet From The
EAST Line Section 17 Township T25N Range R03W

5. Lease Designation and Serial No.
SF 079600

6. If Indian, Allottee or Tribe Name

7. If Unit or CA, Agreement Designation

8. Well Name and Number
C W ROBERTS
9

9. API Well No.
3003924957

10. Field and Pool, Exploratory Area
BASIN FRUITLAND COAL (GAS)

11. County or Parish, State
RIO ARRIBA, NM

12. Check Appropriate Box(s) To Indicate Nature of Notice, Report, or Other Data

TYPE OF SUBMISSION	TYPE OF ACTION	
<input checked="" type="checkbox"/> Notice of Intent	<input type="checkbox"/> Abandonment	<input type="checkbox"/> Change of Plans
<input type="checkbox"/> Subsequent Report	<input checked="" type="checkbox"/> Recompletion	<input type="checkbox"/> New Construction
<input type="checkbox"/> Final Abandonment Notice	<input type="checkbox"/> Plugging Back	<input type="checkbox"/> Non-Routine Fracturing
	<input type="checkbox"/> Casing Repair	<input type="checkbox"/> Water Shut-Off
	<input type="checkbox"/> Attering Casing	<input type="checkbox"/> Conversion to Injection
	<input checked="" type="checkbox"/> OTHER: ADD P.C.	<input type="checkbox"/> Dispose Water

(Note: Report results of multiple completion on Well Completion or Recompletion Report and Log Form.)

13. Describe Proposed or Completed Operations (Clearly state all pertinent details, and give pertinent dates, including estimated date of starting any proposed work. If well is directionally drilled, give subsurface locations and measured and true vertical depths for all markers and zones pertinent to this work.)*

FOUR STAR OIL & GAS CO. REQUESTS APPROVAL ON THE FOLLOWING:

TO ADDITIONALLY COMPLETE THE PICTURED CLIFFS FORMATION AND DOWNHOLE COMMINGLE WITH EXISTING FRUITLAND PRODUCTION. PLEASE REFER TO ATTACHED PROCEDURE AND WELLBORE DIAGRAM FOR DETAILS. DOWNHOLE COMMINGLE HAS BEEN APPLIED FOR WITH THE N.M.O.C.D., APPLICATION ATTACHED.

14. I hereby certify that the foregoing is true and correct.

SIGNATURE Ted A. Tipton TITLE Operating Unit Manager DATE 1/15/97
TYPE OR PRINT NAME Ted A. Tipton

(This space for Federal or State office use)

APPROVED

CONDITIONS OF APPROVAL, IF ANY: _____ TITLE _____ DATE _____

Title 18 U.S.C. Section 1001, makes it a crime for any person knowingly and willfully to make to any department or agency of the United States any false, fictitious or fraudulent statements or representations as to any matter within its jurisdiction.

Workover Procedure

1. Insure that a BLM Sundry has been approved and any stipulations of approval are adhered to. Inspect and repair rig dead man anchors as needed.
2. MIRU well service unit. NDWH. NUBOP.
3. Retrieve plunger. Kill well with 2% Kcl water if necessary. POOH with 3738' of 2-3/8" production tubing.
4. RU wireline service. Perforate the following Pictured Cliffs intervals with 4 JSPF, Schlumberger HEGS, w/90 degree phasing:

#	Interval	Net ft	# holes
1.	3804'-20'	16'	64
2.	3840'-46'	6'	24

Total = 22' net, 42' gross, 88 holes.

5. RIH with 2-3/8" tbg, Guiberson Uni III and Guiberson Uni VI packers. Straddle Fruitland Coal perforations (3662'-3768') by setting the Uni VI packer at 3780' and the Uni III at 3600'.
6. RU Dowell. Pressure up backside to 500 psi and monitor. Fracture stimulate PC perms down 2-3/8" tbg with 15,800 gals 50 quality stable foamed gel and 52,700 lbs brady sand according to the attached Dowell frac schedule. Under flush by 2-3 barrels. If Nolte plot net pressure is stable, taper down rate during flush to assist tip screenout and minimize fluid momentum at final shut down. Obtain ISIP, then begin immediate flow back at 1 BPM in order to "force close" the fracture. Flow back at 1-2 BPM until gel has broken as per pre-job test then go wide open in order to utilize the nitrogen to help bring back load. Shut-in for the night.
7. Swab/flow using nitrogen to help recover load. Release packers and POOH. RIH with hydrostatic bailer and clean out sand to PBTD at 3895'. Set 2-3/8" production string at 3825' with seating nipple on bottom for receiving a plunger bumper spring. Swab until flow is established. Place well back on line.
8. NDBOP, NUWH, RD well service unit. Notify EA to file subsequent sundry. Evaluate production for automatic plunger lift system.

MRR 1/7/97

Capacities:

Burst:

2-3/8", 4.7#, J-55 tbg	0.1624 gals/ft (0.00387 Bbls/ft)	7,700 psi (80% = 6,120 psi)
2-7/8", 6.5#, J-55 tbg	0.2431 gals/ft (0.00579 Bbls/ft)	7,264 psi (80% = 5,811 psi)
5-1/2", 15.5#, K-55 csg	0.9996 gals/ft (0.0238 Bbls/ft)	4,810 psi (80% = 3,848 psi)
2-3/8" x 5-1/2", 15.5# annulus	0.7686 gals/ft (0.0183 Bbls/ft)	

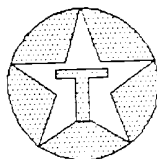

C. W. ROBERTS No. 9

PROPOSED COMPLETION

LOCATION:

1615' FNL & 1590' FEL, Unit G
SW/4, NE/4, Sec. 17, T25N, R3W
Rio Arriba County

SPUD DATE: 1/03/91

COMPL. DATE: 1/31/91

ELEVATION: 7286' KB
7273' GR

FORMATION TOPS:

B/Ojo Alamo 3492'
T/Fruitland 3594'
Fruitland Coals 3662'
Pictured Cliffs 3768'

FRUITLAND COAL PERFS:

3662' - 3666'
3668' - 3673'
3678' - 3689'
3697' - 3702'
3704' - 3707'
3762' - 3768'

PROPOSED PERFS PICTURED CLIFFS:

3804' - 3820'
3840' - 3846'

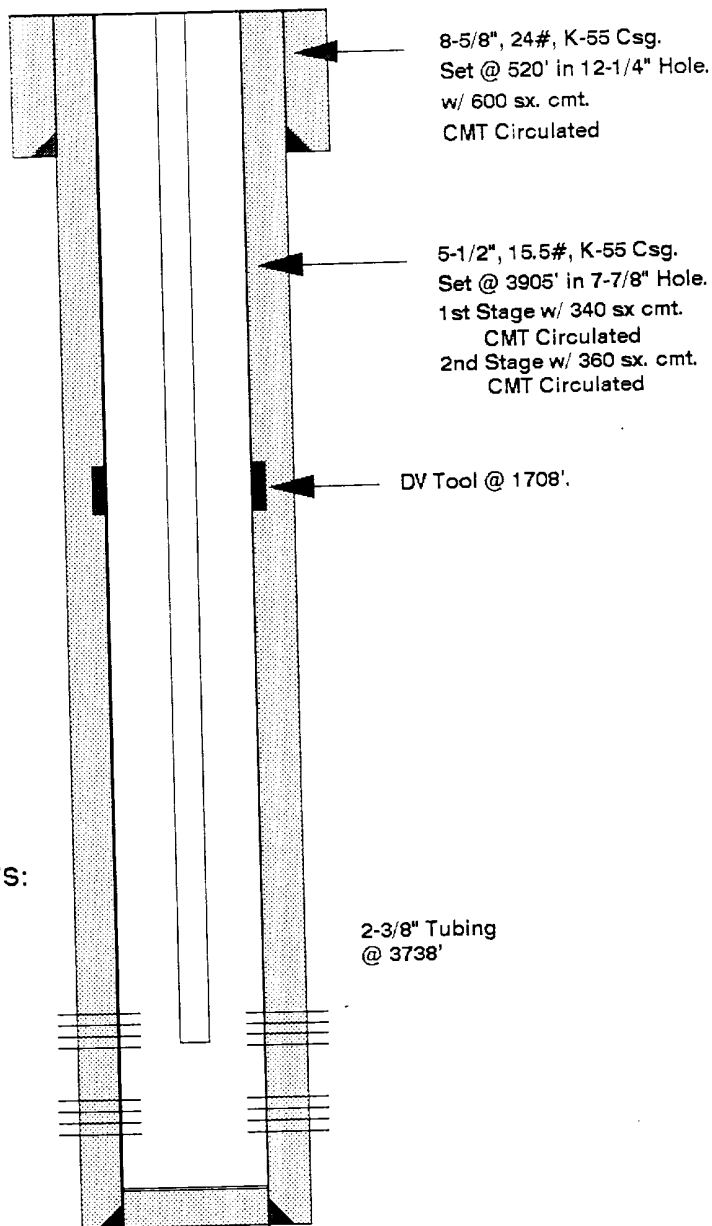

PBTD - 3895'
TD - 3905'

TEAACO EXPLORATION & PRODUCTION
3701 E. MAIN FARMINGTON, NM. 87409
(505) 326-2657

Source: METER RUN	Report Date: 04/08/1996
Station #: 191-135	Sample Date: 4/5/96
Station Name: C. W. ROBERTS #9	Flowing Pressure: 47 psig
Field: FRUITLAND	Flowing Temp.: 63 F

Method: c:\ezchrom\methods\cqmwet.met
File: c:\ezchrom\chrom\135.2

Gas Analysis by Chromatograph

Name	Mole %	BTU	SG	GPM
Nitrogen	0.357	0.000	0.003	
Methane	88.519	896.110	0.490	
CO2	0.128	0.000	0.002	
Ethane	5.929	105.162	0.062	1.586
propane	3.123	78.760	0.048	0.861
i-Butane	0.602	19.622	0.012	0.197
n-Butane	0.680	22.235	0.014	0.214
i-Pentane	0.262	10.507	0.007	0.096
n-Pentane	0.170	6.831	0.004	0.062
Hexanes	0.086	4.100	0.003	0.035
Heptanes	0.068	3.750	0.002	0.031
Octanes	0.048	3.366	0.002	0.027
	0.000	0.000	0.000	

Ideal Total	100.000	1150.621	0.649	3.109
-------------	---------	----------	-------	-------

Gross BTU/Real Cu. Ft.
(@ 60 deg F, 14.730)
Dry = 1153.888
Sat. = 1135.088
Actual = 1153.888
(0.000 lbs. water/MMCF)

Gasoline Content
Propane GPM = 0.861
Butane GPM = 0.411
Gasoline GPM = 0.251
26# Gasoline GPM = 0.466
Total GPM = 1.523

Real Specific Gravity Calculated = 0.6502
On-Site Specific Gravity = 0.0000

Gas Compressability = 0.9972

Remarks: FLOW RATE 51 MCF/D

TEXACO EXPLORATION & PRODUCTION
3701 E. MAIN FARMINGTON, NM. 87409
(505) 326-2657

Source: METER RUN	Report Date: 04/06/1996
Station #: 191-127	Sample Date: 4/5/96
Station Name: C. W. ROBERTS #7	Flowing Pressure: 61 psig
Field: PICTURE CLIFF	Flowing Temp.: 75 F

Method: c:\ezchrom\methods\cqmwet.met
File: c:\ezchrom\chrom\127.2

Gas Analysis by Chromatograph

Name	Mole %	BTU	SG	GPM
Nitrogen	0.331	0.000	0.003	
Methane	88.298	893.873	0.489	
CO2	0.131	0.000	0.002	
Ethane	6.037	107.078	0.063	1.615
H2S	0.050	0.319	0.001	
propane	3.191	80.475	0.049	0.879
i-Butane	0.603	19.654	0.012	0.197
n-Butane	0.719	23.510	0.014	0.227
i-Pentane	0.277	11.108	0.007	0.101
n-Pentane	0.187	7.514	0.005	0.068
Hexanes	0.094	4.481	0.003	0.039
Heptanes	0.058	3.199	0.002	0.027
Octanes	0.024	1.683	0.001	0.014
	0.000	0.000	0.000	

Ideal Total	100.000	1152.894	0.650	3.166
-------------	---------	----------	-------	-------

Gross BTU/Real Cu. Ft. (@ 60 deg F, 14.730)	Gasoline Content
Dry = 1156.183	Propane GPM = 0.879
Sat. = 1137.345	Butane GPM = 0.424
Actual = 1156.183	Gasoline GPM = 0.248
(0.000 lbs. water/MMCF)	26# Gasoline GPM = 0.475
	Total GPM = 1.551

Real Specific Gravity Calculated = 0.6517
On-Site Specific Gravity = 0.0000

Gas Compressability = 0.9972

Remarks: FLOW RATE 56 MCF/D

Calculated Bottomhole Pressure from Surface Pressure					
Well	Date	P _s	S. G.	D	P _B
C. W. Roberts #4	5/22/94	432	0.633	3690	468
C. W. Roberts #7	10/9/95	251	0.6517	3809	274
C. W. Roberts #8	9/15/94	220	0.6855	3672	240
Average		301	0.6567	3724	327

2600 E. Bloomfield Hwy, Farmington, New Mexico 87401
Phone (505)327-0491 FAX# (505)327-4333

BOTTOM HOLE PRESSURE REPORT

CUSTOMER: Texaco

WELL NAME & NUMBER: C. W. Roberts #4

ELEMENT NUMBER: 51376

ELEMENT RANGE: 0-2000

DATE RAN: 06-20-92

DATE PULLED: 06-27-92

REMARKS: Instrument set at 3685'

DATE/TIME	PRESSURE	COMMENTS
06-20-92		
1218	299.5	Instrument on btm
		Well flowing
1300	299.5	Shut in well
1315	318.1	15 min. readings
1330	331.6	
1345	336.8	
1400	340.9	
1415	345.1	
1430	348.2	
1445	351.3	
1500	353.4	
1515	354.4	
1530	355.4	
1600	358.5	30 min. readings
1630	361.7	
1700	364.8	
1730	367.9	
1800	369.9	
1830	372	
1900	374.1	
1930	375.1	
2000	377.2	
2100	380.3	1 hr. readings
2200	382.4	
2300	384.5	
2400	385.5	
06-21-92		
0100	387.6	
0200	388.6	
0300	390.7	
0400	391.7	
0500	392.7	
0600	393.8	
0800	395.9	2 hr. readings

BOTTOM HOLE PRESSURE REPORT

DATE/TIME	PRESSURE	COMMENTS
06-21-92		
1000	397.9	2 hr. readings
1200	400	
1400	401	
1600	403.1	
1800	404.1	
2000	405.1	
2200	406.2	
2400	407.2	
06-22-92		
0400	409.2	4 hr. readings
0800	411.3	
1200	413.3	
1600	414.4	
2000	415.4	
2400	416.4	
06-23-92		
0400	417.4	
0800	418.5	
1200	419.5	
1600	420.5	
2000	421.5	
2400	422.6	
06-24-92		
0800	423.6	8 hr. readings
1600	424.6	
2400	425.6	
26-25-92		
0800	426.7	
1600	427.7	
2400	429.7	
06-26-92		
0800	431.8	
1600	432.8	
2400	433.8	
06-27-92		
0800	434.9	END OF TEST Start out of hole TBG 400#
1020	434.9	

 *
 * EVENT SUMMARY *
 *

COMPANY : TEXACO EXPLORATION & PRODUCTION INC.

WELL NAME : C.W. ROBERTS #9

WELL LOCATION : RIO ARriba COUNTY, NEW MEXICO

PAGE : B

DATE : 05/21/91

FILE REF: F126521.DAT

Date MM/DD	Time hh:mm:ss	Test Time hhhh.hhhh	Key Event	Pressure Psig	Temp Deg F
5/14	11:52: 0	1.1667	INSTRUMENT @ 3730'	417.95	88.88
5/14	13: 0: 0	2.3000	SHUT IN 240 HOURS	420.95	107.19
5/14	23: 0: 0	12.3000	SHUT IN 250 HOURS	425.90	108.85
5/15	9: 0: 0	22.3000	SHUT IN 260 HOURS	430.31	108.97
5/15	19: 0: 0	32.3000	SHUT IN 270 HOURS	434.71	109.01
5/16	5: 0: 0	42.3000	SHUT IN 280 HOURS	438.87	108.94
5/16	15: 0: 0	52.3000	SHUT IN 290 HOURS	442.81	108.85
5/17	1: 0: 0	62.3000	SHUT IN 300 HOURS	446.88	108.84
5/17	7: 0: 0	68.3000	SHUT IN 306 HOURS	449.28	108.86
5/17	7:16: 0	68.5667	INSTRUMENT OFF BOTTOM	449.46	108.86

NORTHWEST NEW MEXICO PACKER-LEAKAGE TEST

Operator TEXACO E & P INC. Lease C.W.ROBERTS Well No. 8Location of Well: Unit E Sec. 17 Twp. 25N Rge. 3W County RICARRIBA

	NAME OF RESERVOIR OR POOL	TYPE OF PROD. (OIL OR GAS)	METHOD OF PROD. (Flow or Art. Lift)	PROD. MEDIUM (Tbg. or Csg.)
Upper Completion	BLANCO PICTURED CLIFFS	GAS	FLOW	CSG.
Lower Completion	BLANCO MESAVERDE	GAS	FLOW	TBG.

PRE-FLOW SHUT-IN PRESSURE DATA

Upper Completion	Hour, Date shut-in	Length of time shut-in	Si press. psig	Stabilized (Yes or No)
Lower Completion	Hour, Date shut-in	Length of time shut-in	Si press. psig	Stabilized (Yes or No)

FLOW TEST NO. 1

Commenced at (hour, date)*				Zone producing (Upper or Lower)	
TIME (hour, date)	LAPSED TIME SINCE*	PRESSURE		PROD. ZONE TEMP.	REMARKS
		Upper Completion	Lower completion		
9-8-94					
9-9-94	24 HRS.	150	740		BOTH ZONES SHUTIN
9-10-94	48 HRS.	152	744		
9-11-94	72 HRS.	162	746		
9-12-94	96 HRS.	180	748		
9-13-94	120 HRS.	202	424		UPPER SHUTIN LOWER FLOW 24 HRS.
9-14-94	144 HRS.	215	399		UPPER SHUTIN LOWER FLOW 24 HRS.
9-15-94	168 HRS.	220	408		UPPER SHUTIN LOWER FLOW 24 HRS.

Production rate during test

Oil _____ BOPD based on _____ Bbls. in _____ Hours _____ Grav _____ GOR _____

Gas _____ MCFPD; Tested thru (Orifice or Meter): _____

MID-FLOW SHUT-IN PRESSURE DATA

Upper Completion	Hour, Date shut-in	Length of time shut-in	Si press. psig	Stabilized (Yes or No)
Lower Completion	Hour, Date shut-in	Length of time shut-in	Si press. psig	Stabilized (Yes or No)

NORTHWEST NEW MEXICO PACKER-LEAKAGE TEST

Operator TEXACO E & P INC. Lease C.W.ROBERTS Well No. 7Location of Well: Unit J Sec. 17 Twp. 25N Rge. 3W County RICARRIBA

	NAME OF RESERVOIR OR POOL	TYPE OF PROD. (OIL OR GAS)	METHOD OF PROD. (Flow or Art. Lift)	PROD. MEDIUM (Tbg. or Csg.)
Upper Completion	BLANCO PICTURED CLIFFS	GAS	FLOW	CSG.
Lower Completion	BLANCO MESAVERDE	GAS	FLCW	TBG.

PRE-FLOW SHUT-IN PRESSURE DATA

Upper Completion	Hour, Date shut-in	Length of time shut-in	St press. psig	Stabilized (Yes or No)
Lower Completion	Hour, Date shut-in	Length of time shut-in	St press. psig	Stabilized (Yes or No)

FLOW TEST NO. 1

Commenced at (hour, date)*				Zone producing (Upper or Lower) LOWER	
TIME (hour, date)	LAPSED TIME SINCE*	PRESSURE		PROD. ZONE TEMP.	REMARKS
		Upper Completion	Lower completion		
10-5-95	24 HRS.	190	0		BOTH ZONES SHUTIN LOWER LOGGED OFF
6	48 HRS.	195	0		.
7	72 HRS.	199	0		.
8	96 HRS.	218	0		.
	120 HRS.	228			
9	144 HRS.	244	0		.
	168 HRS.	251			
10	192 HRS.	158	0		UPPER FLOW 24HRS; LOWER ZONE LOGGED OFF
11	240 HRS.	147	0		UPPER FLOW 24 HRS. LOWER ZONE LOGGED OFF

Production rate during test

Oil _____ BOPD based on _____ Bbls. in _____ Hours _____ Grav _____ GOR _____

Gas _____ MCFPD; Tested thru (Orifice or Meter): _____

MID-FLOW SHUT-IN PRESSURE DATA

Upper Completion	Hour, Date shut-in	Length of time shut-in	St press. psig	Stabilized (Yes or No)
Lower Completion	Hour, Date shut-in	Length of time shut-in	St press. psig	Stabilized (Yes or No)

WELL DELIVERABILITY TEST REPORT FOR 1994

POOL NAME BLANCO SO.	POOL SLOPE n= 0.05	FORMATION FRACTURED CLIFFS	COUNTY RIO ARRIBA
-------------------------	-----------------------	-------------------------------	----------------------

COMPANY TEXACO E & P INC.			WELL NAME AND NUMBER C.W.ROBERTS # 4		
UNIT LETTER M	SECTION 17	TOWNSHIP 25N	RANGE 3W	PURCHASING PIPELINE EPNG	
CSG O.D. - INCHES 5.5	CSG I.D. - INCHES 4.892	SETTING DEPTH - FEET 8201	TBG O.D. - INCHES 2.375	TBG I.D. - INCHES 1.995	TOP TBG PERF - FT 3696
GAS PAY ZONE FROM 3680 TO 3700		WELL PRODUCING THROUGH CASING TUBING X	GAS GRAVITY 0.663	GRAVITY X LENGTH 2450	
DATE OF FLOW TEST FROM 5-16-94 TO 5-22-94			DATE SHUT-IN PRESSURE MEASURED 9-15-94		

PRESSURE DATA - ALL PRESSURES IN PSIA

(a) Flowing Csg Pressure (Dwt) 0	(b) Flowing Tbg Pressure (Dwt) 142	(c) Flowing Meter Pressure (Dwt) 120	(d) Flow Chart Static Reading 121	(e) Meter Error (Item c-Item d) -1	(f) Friction Loss (a-c) or (b-c) 22	(g) Avg. Meter Pressure (Intgr.) 120
(h) Corr. Meter Pressure (g+e) 119	(i) Avg. Wellhead Press. Pt=(h+f) 141	(j) Shut-in Csg. Pressure (Dwt) 0	(k) Shut-in Tbg. Pressure (Dwt) 432	(l) Pc=high value of (j) or (k) 432	(m) Del. Pressure Pd=% of Pc 60 259	(n) Sep/Dehy Pr. (Dwt)if Crit. Flw

FLOW RATE CORRECTION (METER ERROR)

Integrated Volume - MCF/D 74	(Item c/Item d) 0.992	(Item c/Item d)^0.5 0.996	Corrected Volume Q= 73.7 MCF/D
---------------------------------	--------------------------	------------------------------	-----------------------------------

WORKING PRESSURE CALCULATION

(1-e^(-s)) 0.163	1000*(Fc*Qm)^2 480.08	R^2 = (1-e^(-s))*1000*(Fc*Qm)^2 78.36	Pt^2 19881	Pw^2 = Pt^2 + R^2 19959	Pw = (Pw^2)^0.5 141.3
---------------------	--------------------------	--	---------------	----------------------------	--------------------------

DELIVERABILITY CALCULATION

$D = Q * [(Pc^2 - Pd^2) / (Pc^2 - Pw^2)]^n = 73.69358 * [(119439 / 166665)^n] = (0.717)^n = (0.753) = 56 \text{ MCF/D}$					
---	--	--	--	--	--

REMARKS:

SUMMARY

Item h	119	Psia
Pc	432	Psia
Q	74	MCF/D
Pw	141	Psia
Pd	259	Psia
D	56	MCF/D

Company

TEXACO E & P INC.

By

David D. Berke

Title

ENGINEER ASSISTANT

Witnessed By

Company