

(SUBMIT IN TRIPLICATE)

Land Office **Santa Fe**
Lease No. **080232**
Unit **USA A. W. Rutter**

X			

UNITED STATES
DEPARTMENT OF THE INTERIOR
GEOLOGICAL SURVEY

Verbal Approval received 4/21/58 from U.S.G.S.

SUNDRY NOTICES AND REPORTS ON WELLS

NOTICE OF INTENTION TO DRILL	<input checked="" type="checkbox"/>	SUBSEQUENT REPORT OF WATER SHUT-OFF	
NOTICE OF INTENTION TO CHANGE PLANS		SUBSEQUENT REPORT OF SHOOTING OR ACIDIZING	
NOTICE OF INTENTION TO TEST WATER SHUT-OFF		SUBSEQUENT REPORT OF ALTERING CASING	
NOTICE OF INTENTION TO RE-DRILL OR REPAIR WELL		SUBSEQUENT REPORT OF RE-DRILLING OR REPAIR	
NOTICE OF INTENTION TO SHOOT OR ACIDIZE		SUBSEQUENT REPORT OF ABANDONMENT	
NOTICE OF INTENTION TO PULL OR ALTER CASING		SUPPLEMENTARY WELL HISTORY	
NOTICE OF INTENTION TO ABANDON WELL			

RECEIVED
APR 23 1958
U. S. GEOLOGICAL SURVEY
FARMINGTON NEW MEXICO

(INDICATE ABOVE BY CHECK MARK NATURE OF REPORT, NOTICE, OR OTHER DATA)

USA A. W. Rutter

Farmington, New Mexico April 21, 1958

Well No. 1 is located 660 ft. from N line and 660 ft. from E line of sec. 10
SW/4 of Section 10 T-24-N R-10-W N.M.P.M.
(1/4 Sec. and Sec. No.) (Twp.) (Range) (Meridian)
East-Lower Gallup(Ext) San Juan New Mexico
(Field) (County or Subdivision) (State or Territory)

RECEIVED
APR 24 1958
OIL COMPANY

The elevation of the derrick floor above sea level is _____ ft. (To be reported later.)

DETAILS OF WORK

(State names of and expected depths to objective sands; show sizes, weights, and lengths of proposed casings; indicate mudding jobs, cementing points, and all other important proposed work)

We propose to drill the above well to a depth of approximately 5500' and complete in the Gallup formation. Stimulation will be contingent upon natural tests of this zone. Rotary tools will be used to total depth.

Casing program will be as follows:

SIZE	DEPTH	CEMENT	REMARKS
8-5/8"	400'		Test--circulate
5-1/2"	5500'		150% theoretical amount to bring top of cement 3000' or 300-500' above top of Gallup.

Copies of location plat are attached. A copy of any survey taken will be submitted upon completion of well.

I understand that this plan of work must receive approval in writing by the Geological Survey before operations may be commenced.

Company Pan American Petroleum Corporation

Address Box 487

Farmington, New Mexico

By

Title Field Clerk

NEW MEXICO OIL CONSERVATION COMMISSION

Well Location and Acreage Dedication Plat

Section A.

Date April 10, 1958

Operator Pan American Petroleum Corporation Lease USA A. W. RUTHER
Well No. 1 Unit Letter B Section 10 Township 24 North Range 10 West NMPM
Located 660 Feet From North Line, 660 Feet From West Line
County San Juan G. L. Elevation 5 Dedicated Acreage 80 Acres
Name of Producing Formation Gallop Pool Bisti Lower Gallop

1. Is the Operator the only owner* in the dedicated acreage outlined on the plat below?
Yes X No * To be reported later
2. If the answer to question one is "no," have the interests of all the owners been consolidated by communitization agreement or otherwise? Yes No . If answer is "yes,"
Type of Consolidation
3. If the answer to question two is "no," list all the owners and their respective interests below:

Owner

Land Description

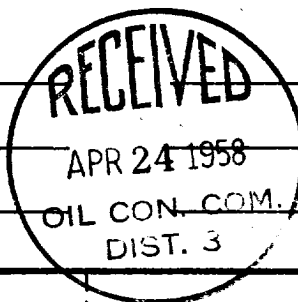

RECEIVED

APR 23 1958

U. S. GEOLOGICAL SURVEY
FARMINGTON, NEW MEXICO

Section B

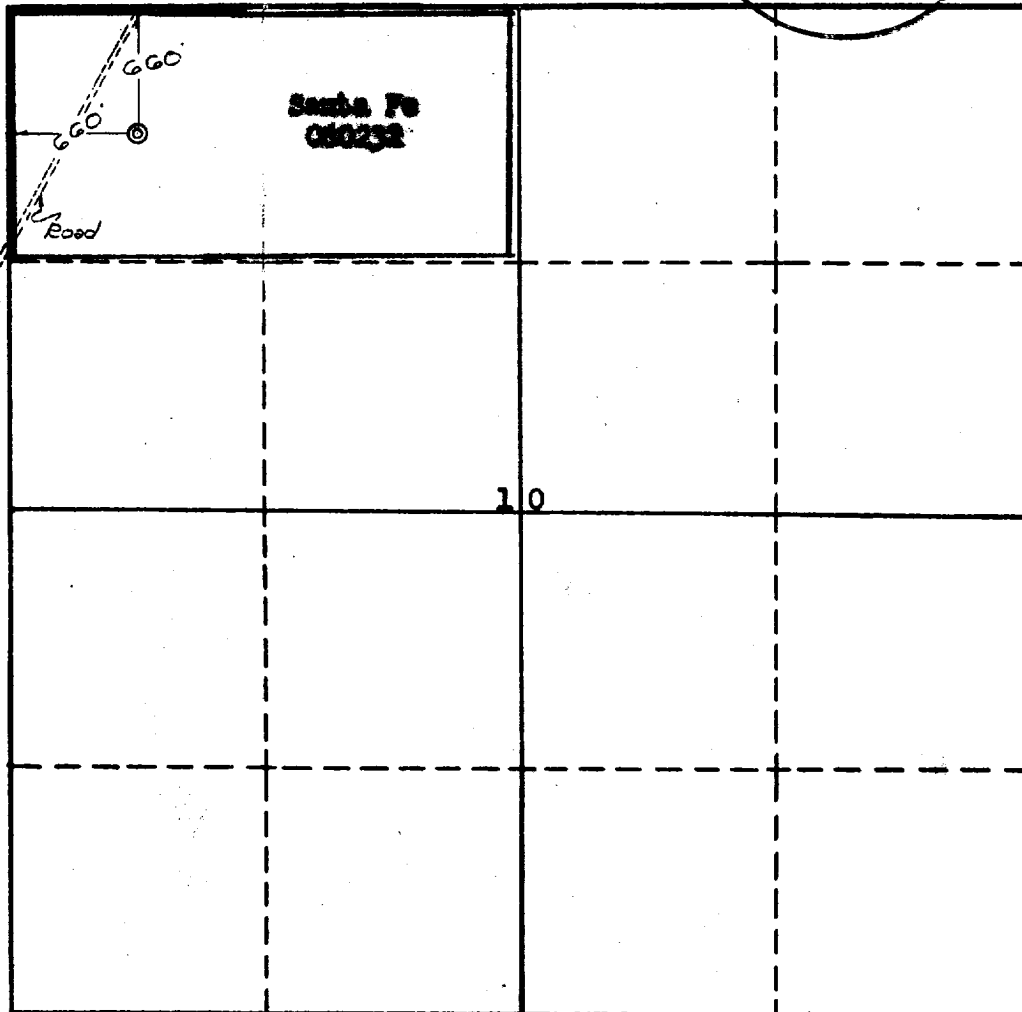

This is to certify that the information in Section A above is true and complete to the best of my knowledge and belief.

PAN AMERICAN PETROLEUM CORP.

(Operator)

R. M. BAUER, JR. *R. M. Bauer, Jr.*

(Representative)

BOX 487, FARMINGTON, NEW MEXICO

Address

This is to certify that the well location on the plat in Section A was obtained from field notes of actual surveys made by me or under my supervision and that the same is true to the best of my knowledge and belief.

Date Surveyed April 8, 1958

Ernest V. Echohawk
Ernest V. Echohawk
Registered Land Surveyor.

Certificate No. 1545

