

UNITED STATES
DEPARTMENT OF THE INTERIOR
GEOLOGICAL SURVEY

30-045-21645

APPLICATION FOR PERMIT TO DRILL, DEEPEN, OR PLUG BACK

1a. TYPE OF WORK

DRILL ☒DEEPEN ☐PLUG BACK ☐

b. TYPE OF WELL

OIL
WELL ☒GAS
WELL ☐OTHER ☐SINGLE
ZONE ☐MULTIPLE
ZONE ☒

2. NAME OF OPERATOR

BCO, Inc.

3. ADDRESS OF OPERATOR

P. O. Box 669 Santa Fe, New Mexico 87501

4. LOCATION OF WELL (Report location clearly and in accordance with any State requirements.)*

At surface

1900' FNL 1710' FWL Sec 13 T24N R8W NMPM

At proposed prod. zone

Same

14. DISTANCE IN MILES AND DIRECTION FROM NEAREST TOWN OR POST OFFICE*

15. DISTANCE FROM PROPOSED*

LOCATION TO NEAREST
PROPERTY OR LEASE LINE, FT.
(Also to nearest drlg. unit line, if any)

930'

16. NO. OF ACRES IN LEASE

640

17. NO. OF ACRES ASSIGNED
TO THIS WELL

80

18. DISTANCE FROM PROPOSED LOCATION*

TO NEAREST WELL, DRILLING, COMPLETED,
OR APPLIED FOR, ON THIS LEASE, FT.

1st well on lease

19. PROPOSED DEPTH

7200

20. ROTARY OR CABLE TOOLS

Rotary

21. ELEVATIONS (Show whether DF, RT, GR, etc.)

7038 GR

22. APPROX. DATE WORK WILL START*

See Below

23.

PROPOSED CASING AND CEMENTING PROGRAM

SIZE OF HOLE	SIZE OF CASING	WEIGHT PER FOOT	SETTING DEPTH	QUANTITY OF CEMENT
12 1/4	8 5/8	24#	120	Circulate
7 7/8	4 1/2 or 5 1/2	10.5 or 15.5	7250	3 Stage details below

PROPOSED WORK

Drill 12 1/4 hole to approximately 120'. Circulate cement. Drill 7 7/8" hole to bottom of Dakota Formation & approximately 7200. Set 4 1/2 or 5 1/2 casing whichever is available, and three stage cement with 125 sack from Dakota to Gallup, 125 sacks over Gallup and recommended Halliburton volume to try and cement from top of Gallup to as near the surface as possible. Perforate and complete Dakota zone. If commercial a request to co-mingle with Gallup will probably be made. Proposed completion for Gallup will be made at that time.

DATE OF PROPOSED WORK

Surface casing will be set as soon as approval obtained.

Hole will be drilled as soon as casing and drilling contractor obtained.

We expect this to be the 1st quarter of 1975.

IN ABOVE SPACE DESCRIBE PROPOSED PROGRAM: If proposal is to deepen or plug back, give data on present productive zone and proposed new productive zone. If proposal is to drill or deepen directionally, give pertinent data on subsurface locations and measured and true vertical depths. Give blowout preventer program, if any.

24.

SIGNED

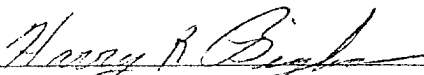

TITLE

President

DATE

11-18-74

(This space for Federal or State office use)

PERMIT NO.

APPROVAL DATE

APPROVED BY



TITLE

DATE

12-27-74

CONDITIONS OF APPROVAL, IF ANY:

NEW MEXICO OIL CONSERVATION COMMISSION
WELL LOCATION AND ACREAGE DEDICATION PLAT

Form C-102
Supersedes C-128
Effective 1-1-65

All distances must be from the outer boundaries of the Section.

NM-1409

Operator BCO, Inc.		Lease Smith		Well No. 4	
Unit Letter F	Section 13	Township 24 North	Range 8 West	County San Juan	
Actual Footage Location of Well: 1900 feet from the North line and 1710 feet from the West line					
Ground Level Elev. 7038	Producing Formation Gallup		Pool Escrito Gallup Undesignated Dakota		Dedicated Acreage: 80 Acres

1. Outline the acreage dedicated to the subject well by colored pencil or hatchure marks on the plat below.
2. If more than one lease is dedicated to the well, outline each and identify the ownership thereof (both as to working interest and royalty).
3. If more than one lease of different ownership is dedicated to the well, have the interests of all owners been consolidated by communitization, unitization, force-pooling, etc?

☐ Yes ☐ No If answer is "yes," type of consolidation N/A

If answer is "no," list the owners and tract descriptions which have actually been consolidated. (Use reverse side of this form if necessary.)

No allowable will be assigned to the well until all interests have been consolidated (by communitization, unitization, forced-pooling, or otherwise) or until a non-standard unit, eliminating such interests, has been approved by the Commission.

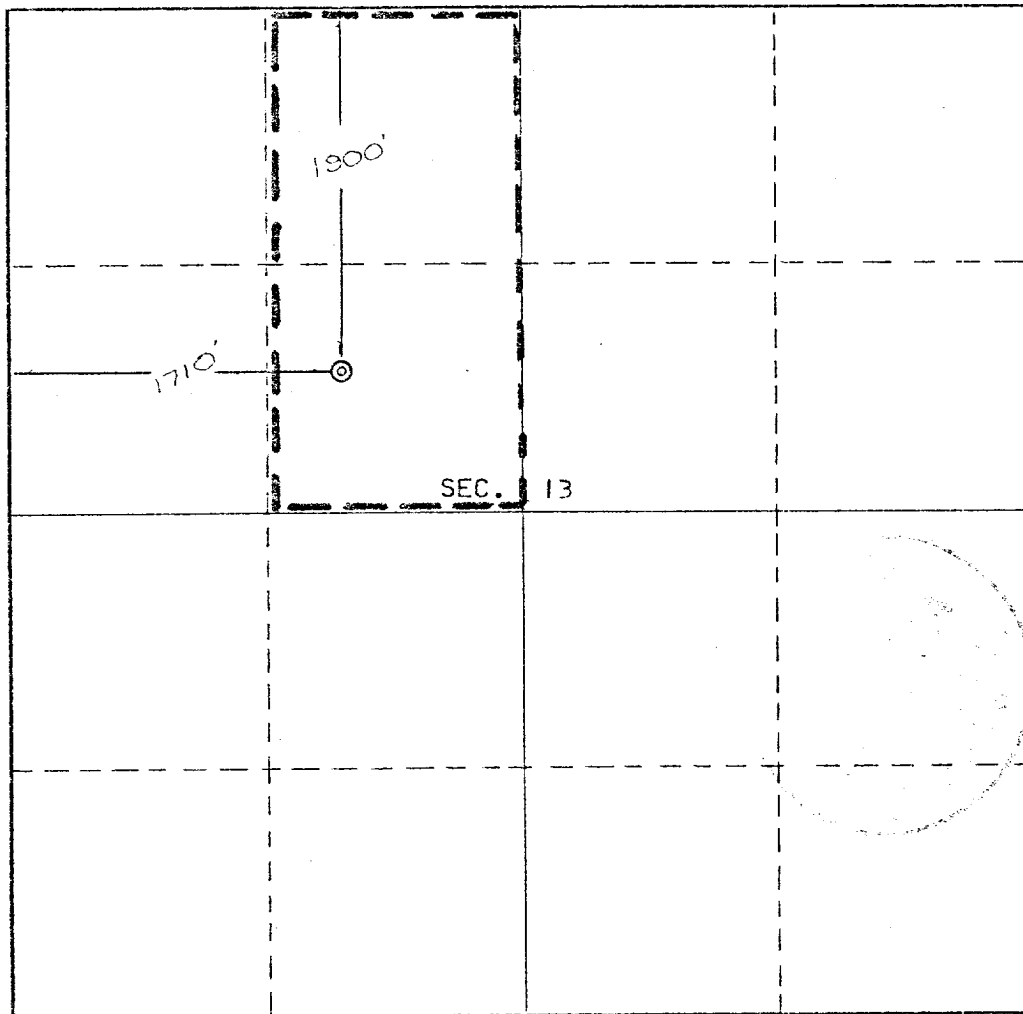

CERTIFICATION

I hereby certify that the information contained herein is true and complete to the best of my knowledge and belief.

Harry R. Bigbee
Name

Harry R. Bigbee

Position

President

Company

BCO, Inc.

Date

11-18-74

I hereby certify that the well location shown on this plat was plotted from field notes of actual surveys made by me or under my supervision, and that the same is true and correct to the best of my knowledge and belief.

Date Surveyed

November 9, 1974

Registered Professional Engineer and/or Land Surveyor

E.V. Echhawk

Certificate No. 3602

E.V. Echhawk LS

0 330 660 990 1320 1650 1980 2310 2640 2000 1500 1000 500 0