

NEW MEXICO OIL CONSERVATION COMMISSION
WELL LOCATION AND ACREAGE DEDICATION PLAT

Okal

Form C-102
Supersedes C-128
Effective 1-1-65

All distances must be from the outer boundaries of the Section.

Operator Dugan Production Corp.			Lease Blanco Wash			Well No. 2		
Unit Letter F	Section 2	Township 24 North		Range 9 West	County San Juan			
Actual Footage Location of Well: 1820 feet from the North line and 1520 feet from the West line								
Ground Level Elev. 6537'	Producing Formations S and and Pools Undesignated Mancos and Undesignated Greenhorn					Dedicated Acreage: 40 Acres		

1. Outline the acreage dedicated to the subject well by colored pencil or hachure marks on the plat below.
2. If more than one lease is dedicated to the well, outline each and identify the ownership thereof (both as to working interest and royalty).
3. If more than one lease of different ownership is dedicated to the well, have the interests of all owners been consolidated by communitization, unitization, force-pooling, etc?

☐ Yes ☐ No If answer is "yes," type of consolidation _____

If answer is "no," list the owners and tract descriptions which have actually been consolidated. (Use reverse side of this form if necessary.) _____

No allowable will be assigned to the well until all interests have been consolidated (by communitization, unitization, forced-pooling, or otherwise) or until a non-standard unit, eliminating such interests, has been approved by the Commission.

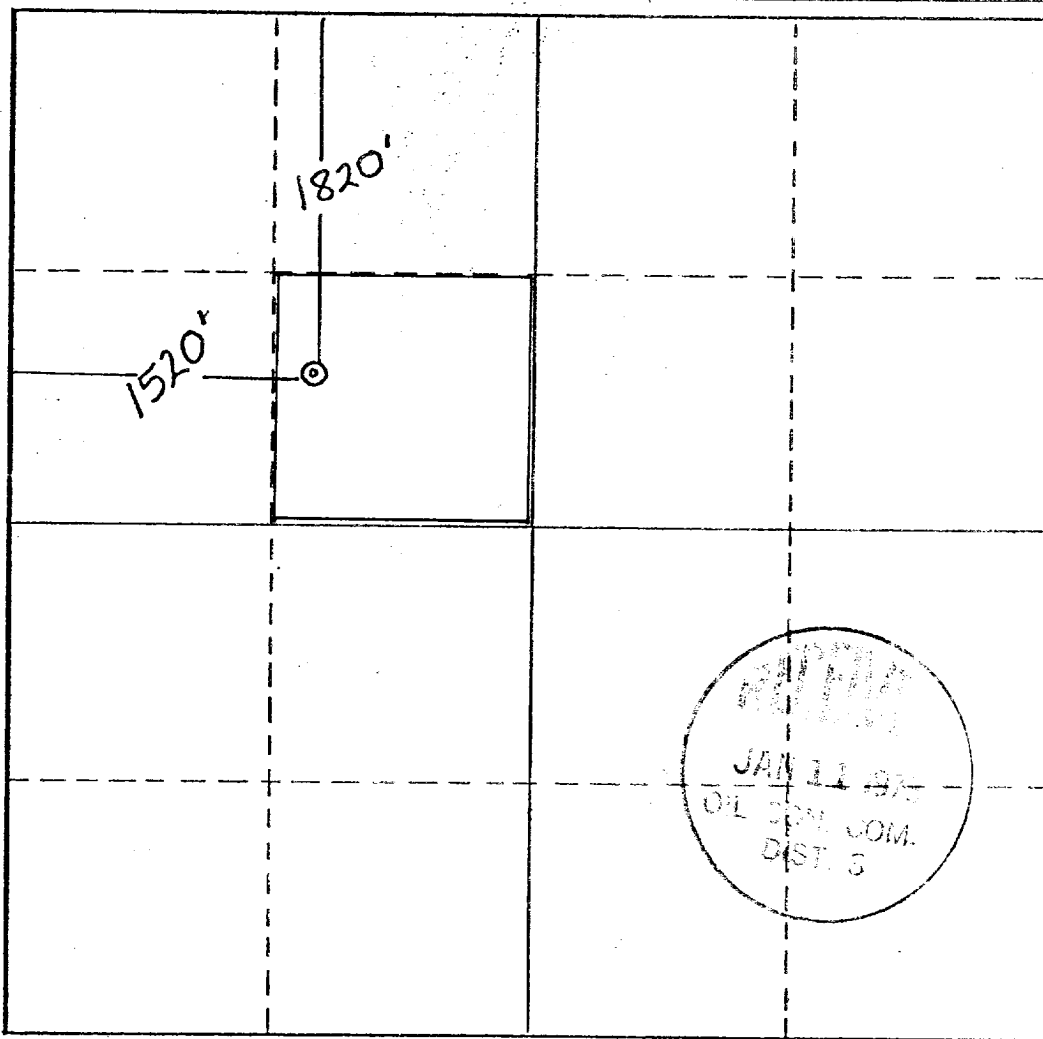

CERTIFICATION

I hereby certify that the information contained herein is true and complete to the best of my knowledge and belief.

Richard Tully

Name
Richard Tully
Position
Landman
Company
Dugan Production Corp.

Date
1-10-78

ENTERED LAND SURVEYOR
I hereby certify that the location shown on this plat was plotted from field notes of actual surveys made by me or under my supervision and that the same are true and correct to the best of my knowledge and belief.
3802
ERNEST V. ECHOHAWK

Date Surveyed
March 16, 1977
Registered Professional Engineer and/or Land Surveyor

E.V. Echohawk
Certificate No. **3602**
E.V. Echohawk LS

