

UNITED STATES  
DEPARTMENT OF THE INTERIOR  
BUREAU OF LAND MANAGEMENT

APPLICATION FOR PERMIT TO DRILL, DEEPEN, OR PLUG BACK

1a. TYPE OF WORK

DRILL ☒

DEEPEN ☐

PLUG BACK ☐

b. TYPE OF WELL

OIL  
WELL ☒

GAS  
WELL ☐

OTHER

SINGLE  
ZONE ☒

MULTIPLE  
ZONE ☐

2. NAME OF OPERATOR

Coleman Oil & Gas, Inc.

3. ADDRESS OF OPERATOR

P.O. Drawer 3337, Farmington, New Mexico 87499

4. LOCATION OF WELL (Report location clearly and in accordance with any State requirements.)\*  
At surface 1740' FSL & 1980' FWL

At proposed prod. zone  
Same

14. DISTANCE IN MILES AND DIRECTION FROM NEAREST TOWN OR POST OFFICE\*

15. DISTANCE FROM PROPOSED\*

LOCATION TO NEAREST  
PROPERTY OR LEASE LINE, FT.  
(Also to nearest drlg. unit line, if any)

16. NO. OF ACRES IN LEASE

160

17. NO. OF ACRES ASSIGNED  
TO THIS WELL

40

18. DISTANCE FROM PROPOSED LOCATION\*  
TO NEAREST WELL, DRILLING, COMPLETED,  
OR APPLIED FOR, ON THIS LEASE, FT.

19. PROPOSED DEPTH

5572'

20. ROTARY OR CABLE TOOLS

Rotary

21. ELEVATIONS (Show whether DF, RT, GR, etc.)

6825' GR

DRILLING OPERATIONS AUTHORIZED ARE  
SUBJECT TO COMPLIANCE WITH ATTACHED

22. APPROX. DATE WORK WILL START\*

Sept. 15, 1987

23.

"GENERAL REQUIREMENTS"  
PROPOSED CASING AND CEMENTING PROGRAM

This action is subject to technical and  
procedural review pursuant to 43 CFR 3165.3  
and appeal pursuant to 43 CFR 3165.4.

SIZE OF HOLE	SIZE OF CASING	WEIGHT PER FOOT	SETTING DEPTH
12-1/4"	8-5/8" New & Used	24 lbs.	200'
7-7/8"	4-1/2" New	10.5 lbs.	5572'

150 sks C/A neat cem. 177 cu. ft.  
1st stage 100 sks C/A & 270 sk lit.  
575 cu. ft.  
2nd stage (3100') 425 sks lite 718  
cu. ft.

It is proposed to drill this well to test the Gallup formation.

Onshore Oil and Gas Order No. 1 required information is attached.

RECEIVED  
SEP 10 1987  
OIL CON. DIV.  
DIST. 3

IN ABOVE SPACE DESCRIBE PROPOSED PROGRAM: If proposal is to deepen or plug back, give data on present productive zone and proposed new productive zone. If proposal is to drill or deepen directionally, give pertinent data on subsurface locations and measured and true vertical depths. Give blowout preventer program, if any.

24.

SIGNED

TITLE

DATE

(This space for Federal or State office use)

PERMIT NO.

APPROVAL DATE

APPROVED BY

TITLE

DATE

CONDITIONS OF APPROVAL, IF ANY:

NMOGS

\*See Instructions On Reverse Side

All distances must be from the outer boundaries of the Section.

Operator Coleman Oil and Gas, Inc.		Lease Anderson		Well No. 1
Unit Letter K	Section 22	Township 24 North	Range 8 West	County San Juan
Actual Footage Location of Well: 1740 feet from the South line and 1980 feet from the West line				
Ground Level Elev. 6825	Producing Formation Gallup	Pool Lybrook Gallup	Dedicated Acreage: 40 Acres	

1. Outline the acreage dedicated to the subject well by colored pencil or hachure marks on the plat below.
2. If more than one lease is dedicated to the well, outline each and identify the ownership thereof (both as to working interest and royalty).
3. If more than one lease of different ownership is dedicated to the well, have the interests of all owners been consolidated by communitization, unitization, force-pooling, etc?

☐ Yes ☐ No If answer is "yes," type of consolidation \_\_\_\_\_

If answer is "no," list the owners and tract descriptions which have actually been consolidated. (Use reverse side of this form if necessary.) \_\_\_\_\_

No allowable will be assigned to the well until all interests have been consolidated (by communitization, unitization, forced-pooling, or otherwise) or until a non-standard unit, eliminating such interests, has been approved by the Division.

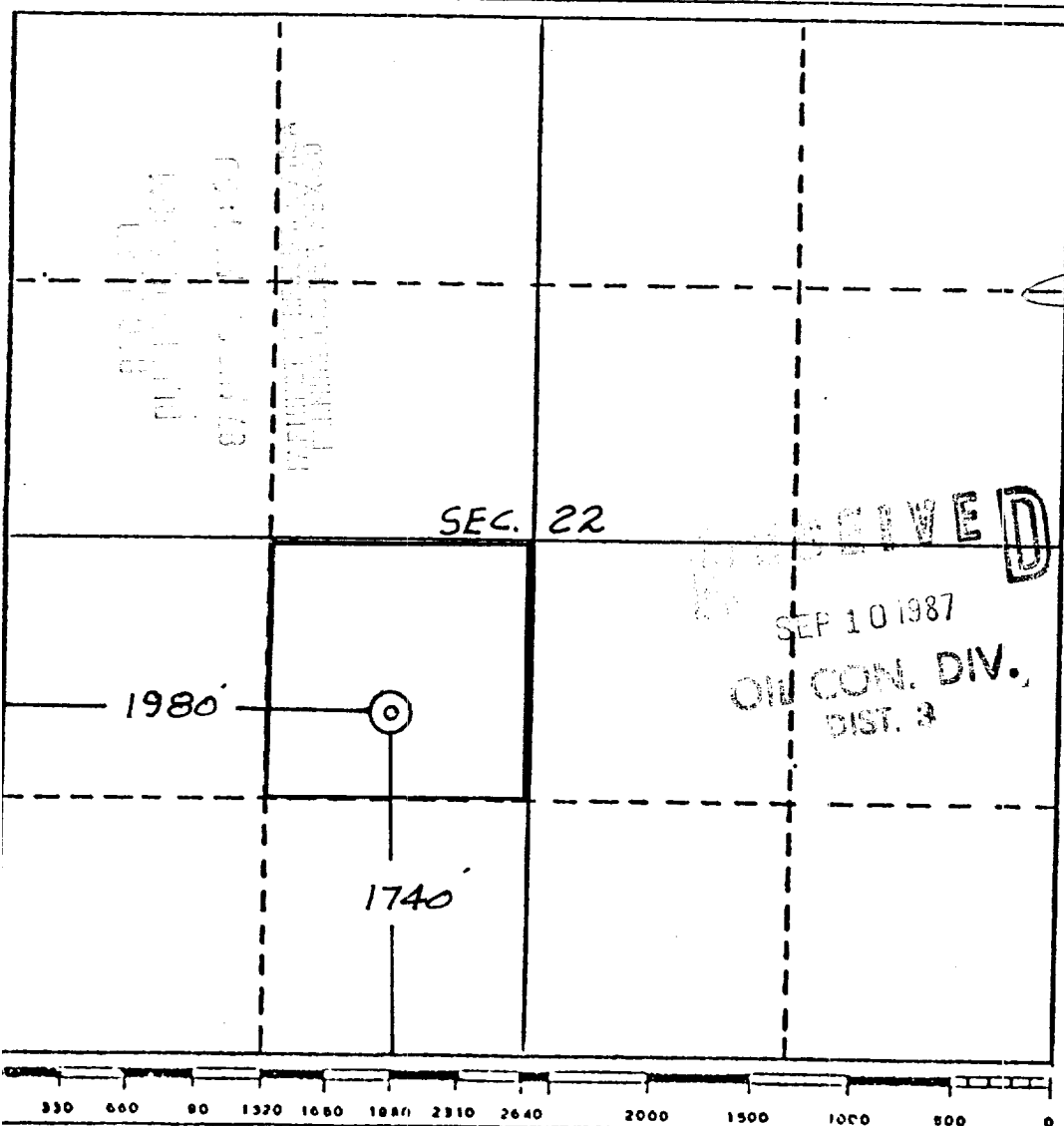

CERTIFICATION

I hereby certify that the information contained herein is true and complete to the best of my knowledge and belief.

Name Edgar L. Risenhoover  
Position  
President  
Company  
Coleman Oil & Gas, Inc.  
Date  
8-19-87

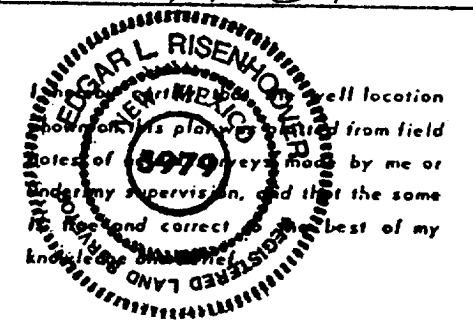

Date Surveyed  
July 30, 1987  
Registered Professional Engineer  
and/or Land Surveyor  
Edgar L. Risenhoover  
Certificate No. 5979  
Edgar L. Risenhoover, L.S.

COLEMAN OIL & GAS INC.

Anderson No. 1

1740'F/SL 1980'F/WL

Sec. 22, T-24-N,  
R-8-W, San Juan Co., NM

Map #1

New Road

Blanco

Highway 44

Wash

SAND

Blanco

90000' FEE