

# NEW MEXICO OIL CONSERVATION COMMISSION

## Well Location and Acreage Dedication Plat

### SECTION A.

Date **June 25, 1962**  
 Operator **Bolack-Greer et al** Lease **Bolack**  
 Well No. **1** Unit Letter **0** Section **9** Township **26 North** Range **1 West** NMPM  
 Located **1080** Feet From **South** Line, **1920** Feet From **East** Line  
 County **Rio Arriba** G. L. Elevation **7750** Dedicated Acreage **40** Acres  
 Name of Producing Formation **Santa Fe** Pool **Wildcat**

1. Is the Operator the only owner\* in the dedicated acreage outlined on the plat below? Yes ☒ No ☐
2. If the answer to question One is "No," have the interests of all the owners been consolidated by communitization agreement or otherwise? Yes ☐ No ☐ If answer is "Yes," Type of Consolidation \_\_\_\_\_
3. If the answer to question Two is "No," list all the owners and their respective interests below:

OWNER

LAND DESCRIPTION

### SECTION B.

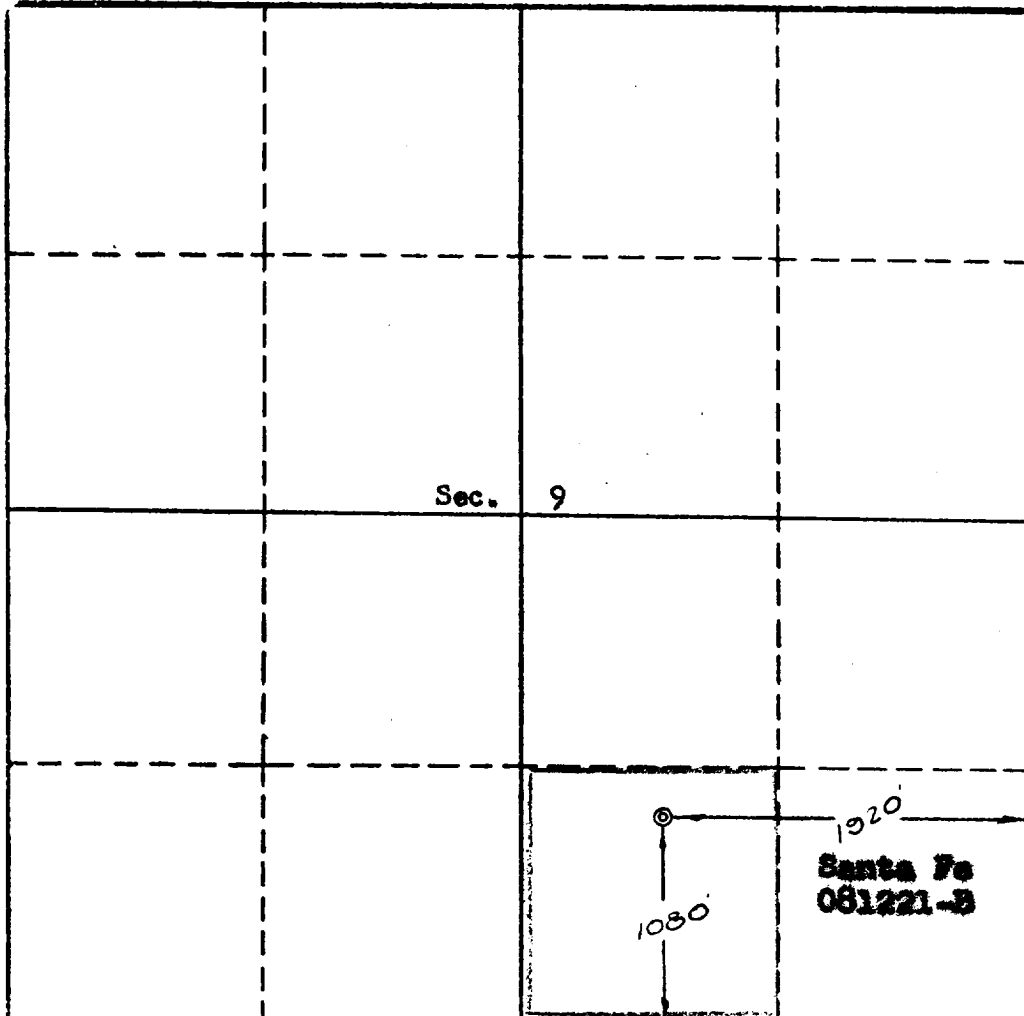

This is to certify that the information in Section A above is true and complete to the best of my knowledge and belief.

**BOLACK, GREER ET AL**

(OPERATOR)

*Albert Greer*  
(REPRESENTATIVE)

**158 Petroleum Center Building  
Farmington, New Mexico**  
(ADDRESS)

This is to certify that the well location shown on the plat in Section B was plotted from field notes of actual surveys made by me or under my supervision and that the same is true and correct to the best of my knowledge and belief.

Date Surveyed **June 2, 1962**

**Four States Engineering Co.,  
FARMINGTON, NEW MEXICO**

*Emmett C. Karp*  
REGISTERED ENGINEER OR  
LAND SURVEYOR

Certificate No. **3602**

